

PENNSYLVANIA HISTORIC RESOURCE SURVEY FORM
 BUREAU FOR HISTORIC PRESERVATION Box 1026
 PA HISTORICAL & MUSEUM COMMISSION Harrisburg, PA 17120

7. Local survey organization
 Philadelphia Historical Commission

1. County Philadelphia
 5. present name George W. Nebinger School

8. property owners name and address
 School District of Philadelphia
 21st & Winter Streets
 Philadelphia, Pennsylvania 19103

9. tax parcel number / other number
 886103000

10. U.T.M. zone 18 easting 4868210
 1.5 acres
 47412105210 northing
 usgs sheet: Philadelphia

12. classification
 site () structure () object ()
 building () Thematic
 in N.R. district yes () no ()

13. date(s) (how determined)
 1924-1925

14. period
 1924-1925

15. style, design or folk type
 Other:
 Art Deco/Utilitarian

19. original use School
 20. present use School

16. architect or engineer
 Irwin T. Catharine

17. contractor or builder
 Unknown

18. primary building mat./construction
 Brick with limestone
 trimmings

21. condition Good
 22. integrity Good

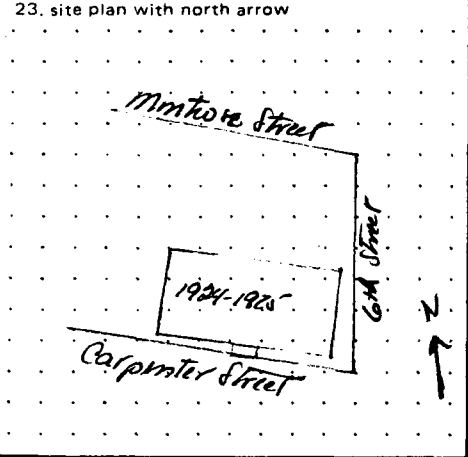

BLACK AND WHITE PRINT(S)
 3 1/2" x 5" enlargement or medium format contact
 note location of negative in block 24.

2. municipality Philadelphia
 6. other name (historic name if any) N/A

24. photo notation

25. file/location

3. street address or specific location
 601-627 Carpenter Street

26. brief description (note unusual features, integrity, environment, threats and associated buildings)

See reverse side

(continue on back if necessary)

27. history, significance and/or background

See reverse side

(continue on back if necessary)

28. sources of information
 See reverse side

29. prepared by:
 Jefferson M. Moak

30. date 5-21-87
 revision(s)

4. survey code

3. ADDRESS: Carpenter Street, 601-627

5. NAME: Nebinger, George W., School

6. FORMER NAME:

13. DATES: 1924-1925

ADDITIONS:

DESCRIPTION: A 4-story, 9-register, brick school set upon a raised brick basement with a limestone dripcourse, stone sills, brick jack lintels, tripartite sash within each opening, a flat roof and a entrance portico with Doric columns supporting an entablature in the ground floor center register. The sides are highlighted by several panels of diapered brick in the first register closest to the front. Crosses set within a diamond appear at the parapet level above each register on the front and sides.

HISTORY/SIGN.: The George W. Nebinger and the Thomas Jefferson Schools are similar to the Kennedy Crossan School in their representation of intermediate styles which Catharine developed while distancing himself from the Colonial Revival and Utilitarian styles espoused by his predecessor, H. deCourcy Richards. From this style, School Board Type Number 142, and others, Catharine soon developed the Art Deco and Academic Gothic forms which characterize much of his work of the middle years.

National Register Criteria: C, Architecture

Boundary Justification: The nominated property contains the contributing building and all historically associated land.

28. SOURCES: Edmunds, Chronological List of Public School Buildings, 1818-1934 School Board, "New School Buildings Under Contract"

EVALUATION: This building warrants inclusion onto the National Register as part of the Philadelphia Public Schools Thematic Resource nomination.

There is one contributing building on the nominated property.

Verbal boundary: the nominated property is tax parcel #886103000.

EVALUATION

EVALUATOR(S)



Philadelphia County
Zone 18
UTM 18/489100/4424500

Philadelphia Public Schools
Thematic Nomination
James Ludlow School
Philadelphia County
Zone 18
UTM 18/487500/4424480

Philadelphia Lead

Philadelphia Public Schools
Thematic Nomination
Thomas Durham School
Philadelphia County
Zone 18
UTM 18/485520/4421420

Philadelphia Public Schools
Thematic Nomination
Edwin Stanton School
Philadelphia County
Zone 18
UTM 18/485380/4420920

Philadelphia Public Schools
Thematic Nomination
Norris S. Barrat School
Philadelphia County
Zone 18
UTM 18/485380/4421320

Philadelphia Public Schools
Thematic Nomination
George Nebinger School
Philadelphia County
Zone 18
UTM 18/486820/4420520

Philadelphia Public Schools
Thematic Nomination
James Wilson School
Philadelphia County