

UNITED STATES DEPARTMENT OF THE INTERIOR
NATIONAL PARK SERVICE

FOR NPS USE ONLY

RECEIVED

DATE ENTERED

**NATIONAL REGISTER OF HISTORIC PLACES
INVENTORY -- NOMINATION FORM**

SEE INSTRUCTIONS IN HOW TO COMPLETE NATIONAL REGISTER FORMS
TYPE ALL ENTRIES -- COMPLETE APPLICABLE SECTIONS

1 NAME

HISTORIC
MILLMONT FARM

AND/OR COMMON

2 LOCATION

STREET & NUMBER
junction of Pa. Routes 16 and 416

CITY, TOWN
Montgomery Township

STATE
Pennsylvania

VICINITY OF

COUNTY
Franklin

CONGRESSIONAL DISTRICT
9

CODE
42

CODE
055

NOT FOR PUBLICATION

3 CLASSIFICATION

CATEGORY	OWNERSHIP	STATUS	PRESENT USE
<input type="checkbox"/> DISTRICT	<input type="checkbox"/> PUBLIC	<input checked="" type="checkbox"/> OCCUPIED	<input checked="" type="checkbox"/> AGRICULTURE
<input checked="" type="checkbox"/> BUILDING(S)	<input checked="" type="checkbox"/> PRIVATE	<input type="checkbox"/> UNOCCUPIED	<input type="checkbox"/> MUSEUM
<input type="checkbox"/> STRUCTURE	<input type="checkbox"/> BOTH	<input type="checkbox"/> WORK IN PROGRESS	<input type="checkbox"/> COMMERCIAL
<input checked="" type="checkbox"/> SITE	PUBLIC ACQUISITION	ACCESSIBLE	<input type="checkbox"/> EDUCATIONAL
<input type="checkbox"/> OBJECT	<input type="checkbox"/> IN PROCESS	<input type="checkbox"/> YES: RESTRICTED	<input checked="" type="checkbox"/> PRIVATE RESIDENCE
	<input type="checkbox"/> BEING CONSIDERED	<input type="checkbox"/> YES: UNRESTRICTED	<input type="checkbox"/> ENTERTAINMENT
		<input checked="" type="checkbox"/> NO	<input type="checkbox"/> GOVERNMENT
			<input type="checkbox"/> INDUSTRIAL
			<input type="checkbox"/> MILITARY
			<input type="checkbox"/> PARK
			<input type="checkbox"/> RELIGIOUS
			<input type="checkbox"/> SCIENTIFIC
			<input type="checkbox"/> TRANSPORTATION
			<input type="checkbox"/> OTHER:

4 OWNER OF PROPERTY

NAME
Mr. & Mrs. Kirby Reese

STREET & NUMBER
P. O. Box 298

CITY, TOWN
Mercersburg

STATE
Pennsylvania

VICINITY OF

5 LOCATION OF LEGAL DESCRIPTION

COURTHOUSE,
REGISTRY OF DEEDS, ETC.
Franklin County Courthouse

STREET & NUMBER
Memorial Square

CITY, TOWN
Chambersburg

STATE
Pennsylvania

6 REPRESENTATION IN EXISTING SURVEYS

TITLE
Pennsylvania Inventory of Historic Places

DATE
11/20/78

DEPOSITORY FOR
SURVEY RECORDS
Pennsylvania Historical & Museum Commission

CITY, TOWN
Harrisburg

STATE
Pennsylvania

FEDERAL STATE COUNTY LOCAL

DESCRIPTION

CONDITION		CHECK ONE	CHECK ONE
<input checked="" type="checkbox"/> EXCELLENT	<input type="checkbox"/> DETERIORATED	<input type="checkbox"/> UNALTERED	<input checked="" type="checkbox"/> ORIGINAL SITE
<input type="checkbox"/> GOOD	<input type="checkbox"/> RUINS	<input checked="" type="checkbox"/> ALTERED	<input type="checkbox"/> MOVED DATE _____
<input type="checkbox"/> FAIR	<input type="checkbox"/> UNEXPOSED		

DESCRIBE THE PRESENT AND ORIGINAL (IF KNOWN) PHYSICAL APPEARANCE

The Millmont Farm complex is located along the west branch of the Conococheague Creek and Pennsylvania Route 16 at its junction with Route 416 about two miles southeast of Mercersburg in Montgomery Township, Franklin County, Pennsylvania. The farmstead includes a large stone house, a double log house, a stone and frame secondary dwelling, a large frame bank barn and a grist mill site.

The main house is situated on the south side of Pennsylvania Route 16 and faces north. It is a two story, five bay stone structure with a one and a half story shed roofed, two bay stone wing extending to the rear or south.

Particularly fine masonry is associated with the front elevation where the limestones have a chiseled surface. The stones are large with narrow joints. Flat arches of angle cut stones are present above the windows. At the first story level prominent keystones are centered above the window openings. Resting on the keystones are larger trapezoidal stones. A semicircular arch of cut stones forms the top of the main entrance. Other elevations have hammer faced stone walls with more randomly spaced rocks. Beneath an overhanging porch roof which extends out beyond the east wall of the south wing, the stone surface shows evidence of old whitewash. There is also evidence of the lower front of the house having been painted white and then brown to about three feet above ground level.

Windows at the first story level have nine over six pane sashes while those above have six over six pane sashes. Although most of the window sashes are not original, it is believed that they follow the form of those that they replaced. At the first story level of the front of the house, windows have pairs of shutters with three raised panels. They appear to be original to the house or at least date from its early history. Second story and attic windows have pairs of louvered shutters.

The main entrance is located in the central bay of the front elevation. A semicircular fanlight, present over the door is glazed with a central half round pane from which extend ray muntins. Trimming the opening is an architrave with reeded and ogee moldings.

At the front door is a broad one bay, one story entrance porch. It is supported by closely placed pairs of doric columns and has a flat roof with a low wooden balustrade.

The roof is sheathed with modern asphalt shingles. Brick chimneys are located inside the end walls of the main section and the kitchen wing.

UNITED STATES DEPARTMENT OF THE INTERIOR
NATIONAL PARK SERVICE

FOR NPS USE ONLY

RECEIVED

DATE ENTERED

**NATIONAL REGISTER OF HISTORIC PLACES
INVENTORY -- NOMINATION FORM**

MILLMONT FARM, Franklin County

CONTINUATION SHEET

ITEM NUMBER 7 PAGE 2

Exterior additions to the house include the installation of dormers in the south slope of the attic roof and in the shed roof of the kitchen wing to allow more space in its upper level.

The interior of the main section of the house is divided by a central stair hall, with two rooms on either side. The stair has turned newels and balusters. The ends of the risers have applied decorative trim and the appearance of the whole staircase is delicate.

The second story rooms follow approximately the same floor plan.

Barn - On the opposite side of Pennsylvania Route 416 from the house is a large frame bank barn, painted red with white trim. Facing south, it rests on stone foundations and appears to date from the early 20th century. Wooden louvered openings are present in the end walls and ornate round metal ventilators extend from the roof ridge.

Log House - West of barn is a one and a half story, four bay, two part log house. It is attached by a covered walkway to a frame, board and batten sheathed kitchen. The house is divided approximately midway in its length into two parts. Its more easterly section was built onto the rest of the building as evidenced where the two parts join at an addition post. Corner joints on both sections show inverted "V" notches. The logs are hewn, exposed and painted. At the west end wall is an exterior stone chimney topped with a small brick flue. An 18th century style door with six raised panels is located at the south elevation of the west section. Door and window architraves are plain.

Secondary Dwelling - On the opposite side of Route 16 from the main house stands a one story 4 bay stone secondary dwelling with a modern frame second story added. The building is constructed of roughly coursed local limestone with more carefully cut stones evident at the front or south elevation. Large flat stones span the tops of the window openings forming lintels.

Site of Grist and Saw Mill - On the west side of the Conococheague Creek, north of Route 16, is the site of a grist and sawmill which was of stone construction. This building is not longer standing.

UNITED STATES DEPARTMENT OF THE INTERIOR
NATIONAL PARK SERVICE

FOR NPS USE ONLY

RECEIVED

DATE ENTERED

**NATIONAL REGISTER OF HISTORIC PLACES
INVENTORY -- NOMINATION FORM**

MILLMONT FARM, Franklin County

CONTINUATION SHEET

ITEM NUMBER 7 PAGE 3

Millmont is a large farm property still being used for agricultural purposes. This nomination includes only the farmstead and its immediate environment. Also on the property is a cemetery and church site located near the northwest corner of the farm. The Associate Reformed Presbyterian Church of West Conococheague was there during the last quarter of the 18th and the early 19th centuries. Several Revolutionary soldiers are buried in the cemetery.

The farmstead is in excellent condition.

PERIOD		AREAS OF SIGNIFICANCE -- CHECK AND JUSTIFY BELOW				
<input type="checkbox"/> PREHISTORIC	<input type="checkbox"/> ARCHEOLOGY-PREHISTORIC	<input type="checkbox"/> COMMUNITY PLANNING	<input type="checkbox"/> LANDSCAPE ARCHITECTURE	<input type="checkbox"/> RELIGION		
<input type="checkbox"/> 400-1499	<input checked="" type="checkbox"/> ARCHEOLOGY-HISTORIC	<input type="checkbox"/> CONSERVATION	<input type="checkbox"/> LAW	<input type="checkbox"/> SCIENCE		
<input type="checkbox"/> 1500-1599	<input checked="" type="checkbox"/> AGRICULTURE	<input type="checkbox"/> ECONOMICS	<input type="checkbox"/> LITERATURE	<input type="checkbox"/> SCULPTURE		
<input type="checkbox"/> 1600-1699	<input checked="" type="checkbox"/> ARCHITECTURE	<input type="checkbox"/> EDUCATION	<input type="checkbox"/> MILITARY	<input type="checkbox"/> SOCIAL/HUMANITARIAN		
<input type="checkbox"/> 1700-1799	<input type="checkbox"/> ART	<input type="checkbox"/> ENGINEERING	<input type="checkbox"/> MUSIC	<input type="checkbox"/> THEATER		
<input checked="" type="checkbox"/> 1800-1899	<input checked="" type="checkbox"/> COMMERCE	<input type="checkbox"/> EXPLORATION/SETTLEMENT	<input type="checkbox"/> PHILOSOPHY	<input type="checkbox"/> TRANSPORTATION		
<input type="checkbox"/> 1900-	<input type="checkbox"/> COMMUNICATIONS	<input type="checkbox"/> INDUSTRY	<input type="checkbox"/> POLITICS/GOVERNMENT	<input type="checkbox"/> OTHER (SPECIFY)		
		<input type="checkbox"/> INVENTION				

SPECIFIC DATES

BUILDER/ARCHITECT

STATEMENT OF SIGNIFICANCE

Millmont Farm, an early 19th century complex, is significant for its contribution to the County's economic history as a mill site and for its association with prominent people in national, state and local history.

The complex is an excellent example of regional architecture illustrating several important building types. The main house, a stone structure built sometime between 1798 and 1821, shows Federal inspired detail combined with a basic rural Georgian exterior plan. It is not listed in the U. S. Direct tax of 1798, but a deed for the property dated November 1, 1821, records the improvements and includes a stone house, presumably this one. Important exterior architectural elements include the precise masonry of the facade with prominent keystones above the windows. This type of decorative stonework is associated with the 1800-1815 period in Franklin County. The first story shutters with their raised panels are also typical of the c. 1800 period as are the raised panel doors. The arched entranceway with its semicircular fanlight is a refinement unusual among the farmhouses of the Cumberland Valley. Another rare occurrence is the decorated eaves work and the pent roof across the west gable end. While pent roofs are frequently seen in southeastern Pennsylvania, few examples are to be seen west of the Susquehanna River. The front porch at least in part probably dates from the early 20th century.

The barn on the Millmont property would appear to date from the early 20th century. It seems to have been the third such structure to have been built there. An 1877 deed for the property mentions a stone bank barn among the improvements and an 1821 deed indicates that the barn at that time was of log construction.

Part of the log secondary dwelling could date from the late 18th or early 19th century and is an example of an important regional vernacular type.

The secondary stone dwelling is an example of regional vernacular construction from the first half of the 19th century and was presumably associated with the milling complex. In front of it stands a large old elm tree which has been photographed and published as an exemplary representative elm in the Encyclopedia Americana.

UNITED STATES DEPARTMENT OF THE INTERIOR
NATIONAL PARK SERVICE

FOR NPS USE ONLY

RECEIVED

DATE ENTERED

**NATIONAL REGISTER OF HISTORIC PLACES
INVENTORY -- NOMINATION FORM**

MILLMONT FARM, Franklin County

CONTINUATION SHEET

ITEM NUMBER 8 PAGE 2

No obvious physical evidence of the mill remains although its presence was recorded as far back as 1798. It is described as a large two story stone gristmill. A sawmill was also in the complex. Milling was an important part of the local economy in 18th and 19th century Franklin County.

The Ramsey family was prominent in local history. One of James Ramsey's children, Mary, married Archibald Irwin. Her daughters, Jane and Elizabeth Irwin married William Henry Harrison, Jr. and John Scott Harrison respectively. Jane became mistress of the White House and Elizabeth was the mother of Benjamin Harrison, President of the United States.

Millmont was purchased by the family of the present owner in 1957.

Franklin County Records
 Miscellaneous estate papers concerning Maria M. Heister, 1922-29
 U.S. Direct Tax of 1798

10 GEOGRAPHICAL DATA

ACREAGE OF NOMINATED PROPERTY 28.7

QUADRANGLE NAME _____

QUADRANGLE SCALE 1:24,000

UTM REFERENCES

A 18 25,42,6,0 44,0,9,8,6,0

B 18 25,41,4,0 44,0,9,6,0,0

ZONE EASTING NORTHING
 C 18 25,31,4,0 44,0,9,7,0,0

ZONE EASTING NORTHING
 D 18 25,31,2,0 44,0,9,9,7,0

E _____

F _____

G _____

H _____

VERBAL BOUNDARY DESCRIPTION Starting at a point on southside of Route 16 moving south for 625 feet along West Branch then NW for 875 ft. then N for 1,000 ft. then E for 1250 ft. to West Branch then S crossing Route 16 for 375 feet to starting point.

LIST ALL STATES AND COUNTIES FOR PROPERTIES OVERLAPPING STATE OR COUNTY BOUNDARIES

STATE	CODE	COUNTY	CODE
STATE	CODE	COUNTY	CODE

11 FORM PREPARED BY

NAME / TITLE

Paula Stoner, Architectural Historian

ORGANIZATION

Preservation Associates, Inc.

DATE

STREET & NUMBER

Box 202, 109 West Main Street

TELEPHONE

301-432-5466

CITY OR TOWN

Sharpsburg

STATE

Maryland

12 STATE HISTORIC PRESERVATION OFFICER CERTIFICATION

THE EVALUATED SIGNIFICANCE OF THIS PROPERTY WITHIN THE STATE IS:

NATIONAL

STATE

LOCAL

As the designated State Historic Preservation Officer for the National Historic Preservation Act of 1966 (Public Law 89-665), I hereby nominate this property for inclusion in the National Register and certify that it has been evaluated according to the criteria and procedures set forth by the National Park Service.

STATE HISTORIC PRESERVATION OFFICER SIGNATURE

Paula Stoner

TITLE

DATE

FOR NPS USE ONLY

I HEREBY CERTIFY THAT THIS PROPERTY IS INCLUDED IN THE NATIONAL REGISTER

DATE

ATTEST: KEEPER OF THE NATIONAL REGISTER

DATE

CHIEF OF REGISTRATION

9 MAJOR BIBLIOGRAPHICAL REFERENCES

Franklin County Land Records
 Miscellaneous estate papers concerning Maria M. Heister, 1922-29
 U.S. Direct Tax of 1798

10 GEOGRAPHICAL DATA

ACREAGE OF NOMINATED PROPERTY 28.7

QUADRANGLE NAME _____

QUADRANGLE SCALE 1:24,000

UTM REFERENCES

A 1,8 | 25,4 | 2,6,0 | 4,4 | 0,9 | 8,6,0

B 1,8 | 25,4 | 1,4,0 | 4,4 | 0,9 | 6,0,0

C 1,8 | 25,3 | 1,4,0 | 4,4 | 0,9 | 7,0,0

D 1,8 | 25,3 | 1,2,0 | 4,4 | 0,9 | 9,7,0

E | | | | | | | | | | | | | | | |

F | | | | | | | | | | | | | | | |

G | | | | | | | | | | | | | | | |

H | | | | | | | | | | | | | | | |

VERBAL BOUNDARY DESCRIPTION Starting at a point on southside of Route 16 moving south for 625 feet along West Branch then NW for 875 ft. then N for 1,000 ft. then E for 1250 ft. to West Branch then S crossing Route 16 for 375 feet to starting point.

LIST ALL STATES AND COUNTIES FOR PROPERTIES OVERLAPPING STATE OR COUNTY BOUNDARIES

STATE	CODE	COUNTY	CODE
STATE	CODE	COUNTY	CODE

11 FORM PREPARED BY

NAME / TITLE

Paula Stoner, Architectural Historian

DATE

ORGANIZATION

Preservation Associates, Inc.

TELEPHONE

STREET & NUMBER

Box 202, 109 West Main Street

301-432-5466

CITY OR TOWN

Sharpsburg

STATE

Maryland

12 STATE HISTORIC PRESERVATION OFFICER CERTIFICATION

THE EVALUATED SIGNIFICANCE OF THIS PROPERTY WITHIN THE STATE IS:

NATIONAL

STATE

LOCAL

As the designated State Historic Preservation Officer for the National Historic Preservation Act of 1966 (Public Law 89-665), I hereby nominate this property for inclusion in the National Register and certify that it has been evaluated according to the criteria and procedures set forth by the National Park Service.

STATE HISTORIC PRESERVATION OFFICER SIGNATURE

TITLE

DATE

FOR NPS USE ONLY

I HEREBY CERTIFY THAT THIS PROPERTY IS INCLUDED IN THE NATIONAL REGISTER

DATE

KEEPER OF THE NATIONAL REGISTER

DATE

ATTEST:

CHIEF OF REGISTRATION

4412
4411
4409
4408
4407
160 000
FEET

5463 IV SW
(MERCERSBURG)
MERCERSBURG 2 MI.

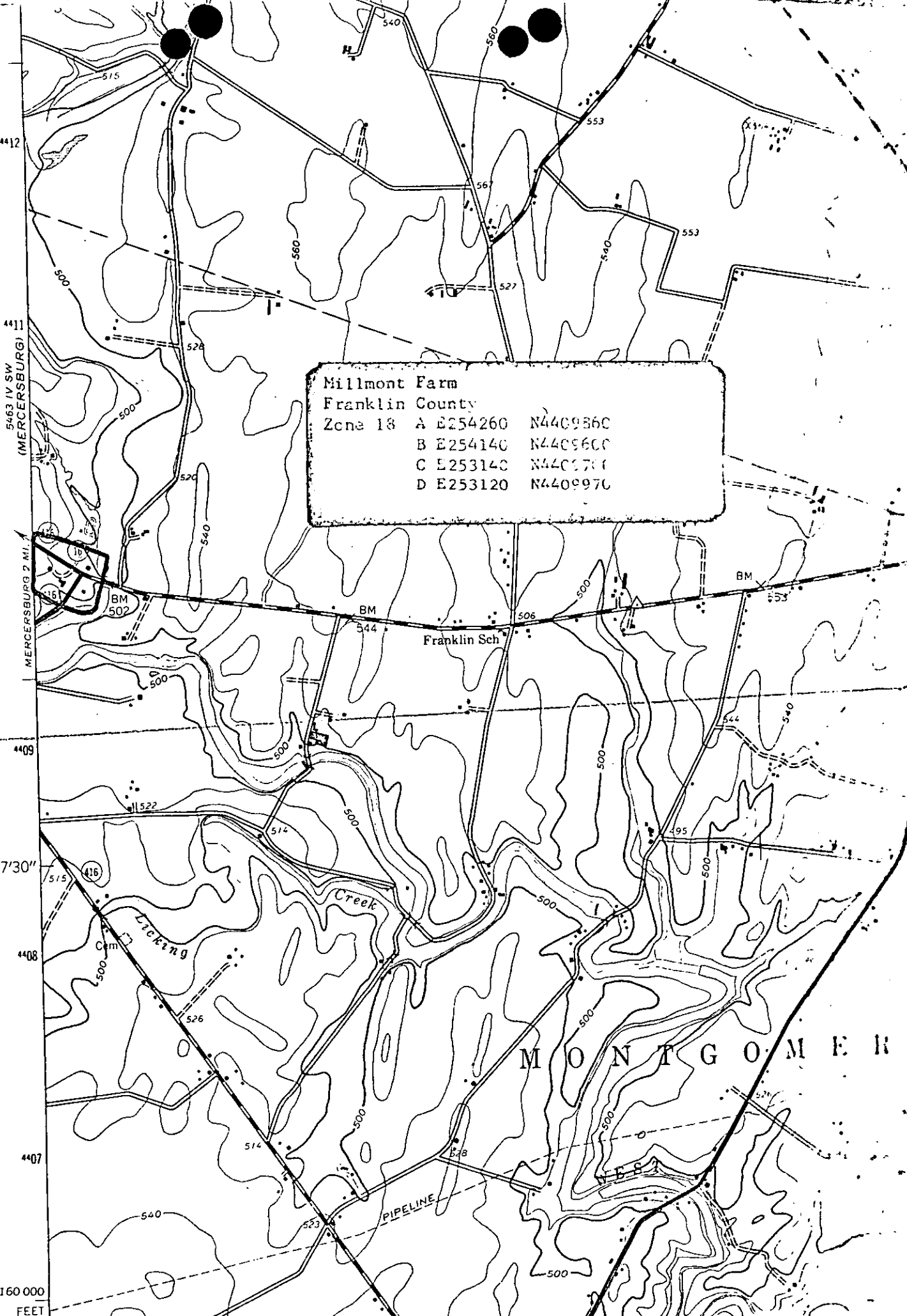

Millmont Farm
Franklin County
Zone 18 A E254260 N440986C
B E254140 N440960C
C E253140 N440970C
D E253120 N440997C

M O N T G O M E R