

TOTAL MILES	
Borough Road System	2.27
State Highway System	0.59
Total	2.86

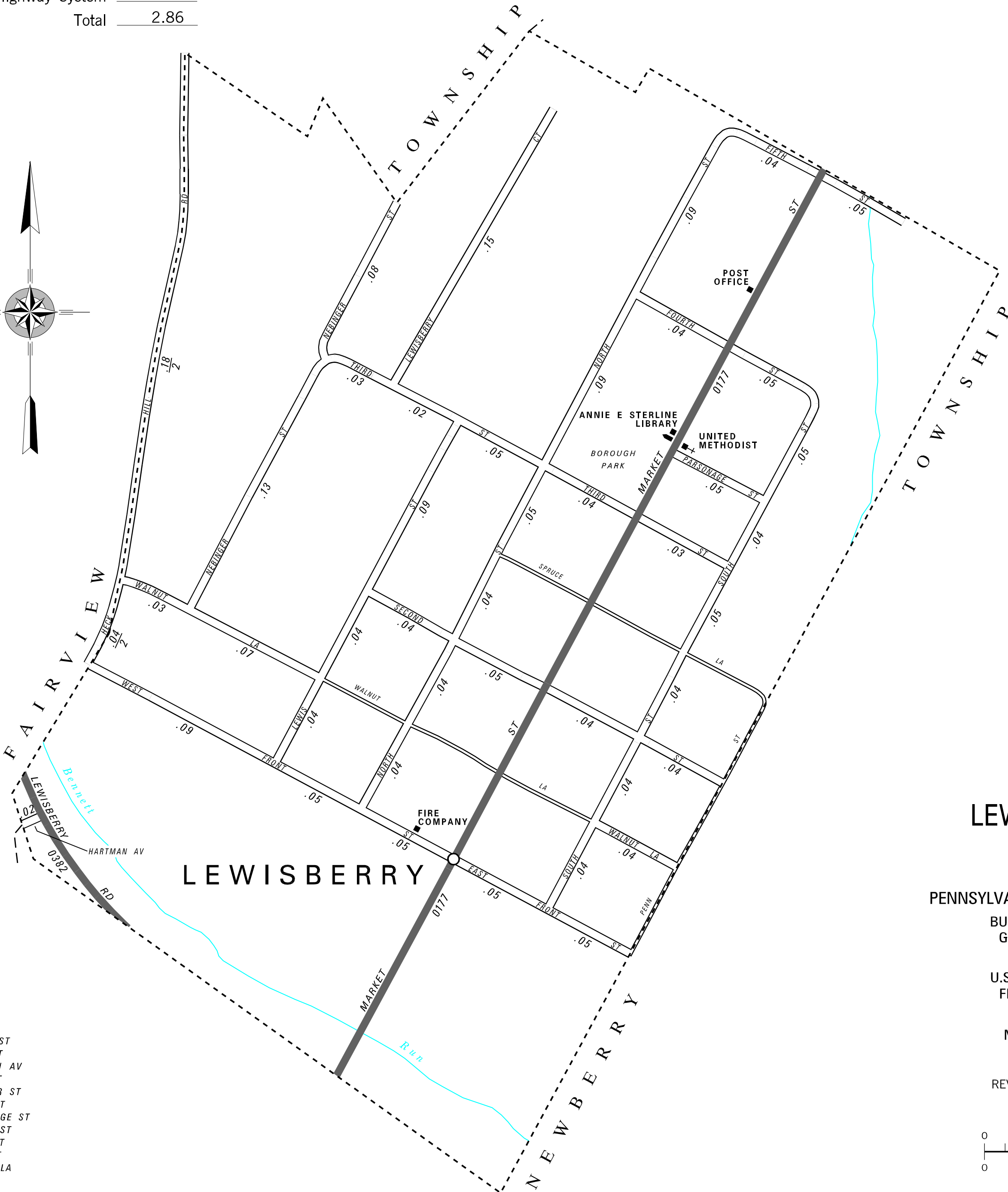
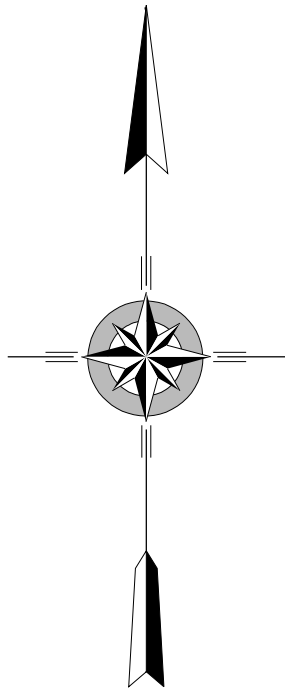

LEGEND

- LIMITED ACCESS HIGHWAY
- STATE ROUTE AND NUMBER
- STATE MAINTAINED BRIDGE ON BOROUGH STREET
- BOROUGH STREET NAME AND SEGMENT LENGTH IN MILES
- TURNBACK BOROUGH STREET
- BOROUGH ALLEY
- OTHER ROAD
- RAILROAD
- STATE BOUNDARY
- COUNTY BOUNDARY
- TOWNSHIP BOUNDARY
- CITY BOUNDARY
- BOROUGH BOUNDARY
- MUNICIPAL BUILDING
- SPLIT MILEAGE BETWEEN MUNICIPALITIES
- SCHOOL, COLLEGE OR UNIVERSITY
- POINT OF INTEREST

POPULATION 362
(2010 Census)

LEWISBERRY BOROUGH

YORK COUNTY

PREPARED BY THE
PENNSYLVANIA DEPARTMENT OF TRANSPORTATION
BUREAU OF PLANNING AND RESEARCH
GEOGRAPHIC INFORMATION DIVISION
IN COOPERATION WITH THE
U.S. DEPARTMENT OF TRANSPORTATION
FEDERAL HIGHWAY ADMINISTRATION
AND
MUNICIPAL SERVICES DISTRICT 8-0
MUNICIPAL CODE 66 416
REVISED PER FORM 990 DATED 9-18-08

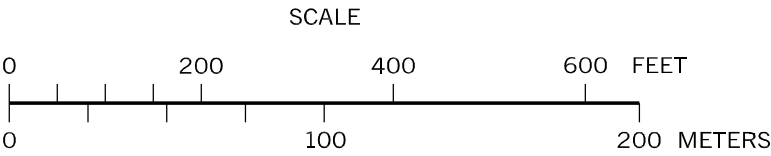

FIFTH ST
FOURTH ST
FRONT ST
HARTMAN AV
LEWIS ST
NEBINGER ST
NORTH ST
PARSONAGE ST
SECOND ST
SOUTH ST
THIRD ST
WALNUT LA