

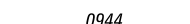









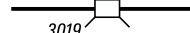

**LEGEND**

-  LIMITED ACCESS HIGHWAY
-  STATE ROUTE AND NUMBER
-  STATE MAINTAINED BRIDGE ON TOWNSHIP ROAD
-  TOWNSHIP ROAD, NUMBER AND SEGMENT LENGTH IN MILES
-  IMPASSABLE TOWNSHIP ROAD
-  TURNBACK TOWNSHIP ROAD
-  OTHER ROAD
-  RAILROAD (IN SERVICE)
-  RAILROAD ABANDONED (TRACK RETAINED)
-  STATE BOUNDARY
-  COUNTY BOUNDARY
-  TOWNSHIP BOUNDARY
-  CITY OR BOROUGH BOUNDARY
-  MUNICIPAL BUILDING
-  SPLIT MILEAGE BETWEEN MUNICIPALITIES

TOTAL MILES	
Township Road System	58.22*
State Highway System	45.12
Total	103.34

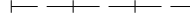
\* Includes ACT 32 Turnback Mileage of 0.93

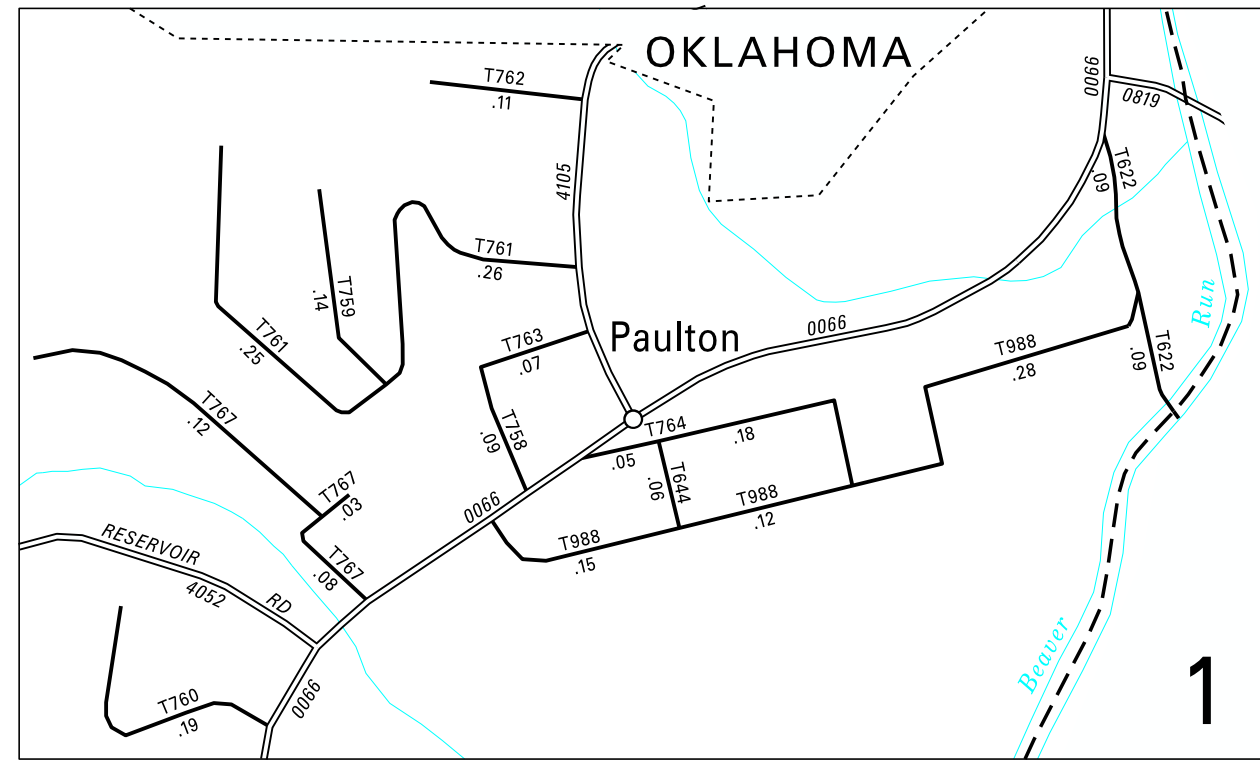

3:1

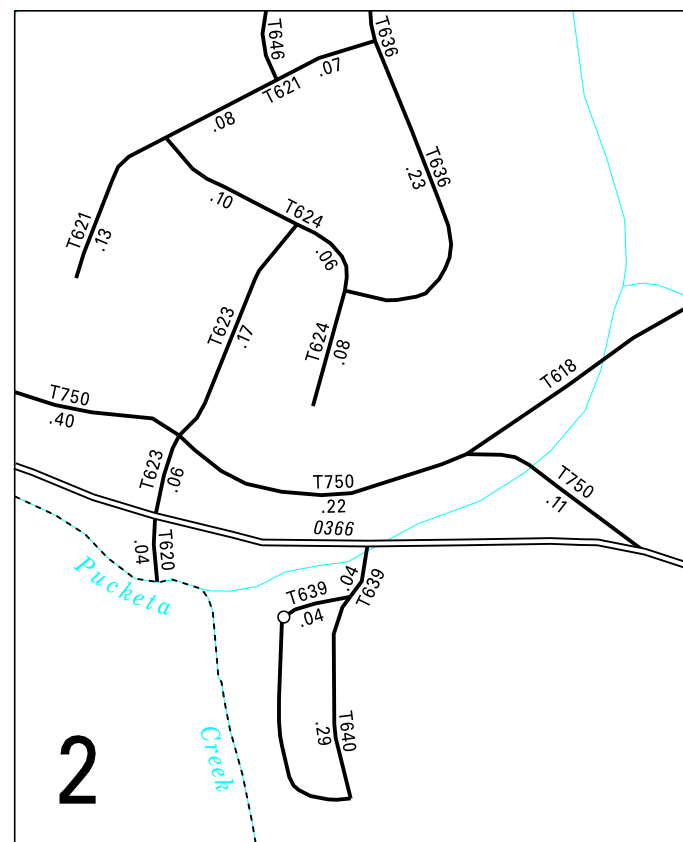
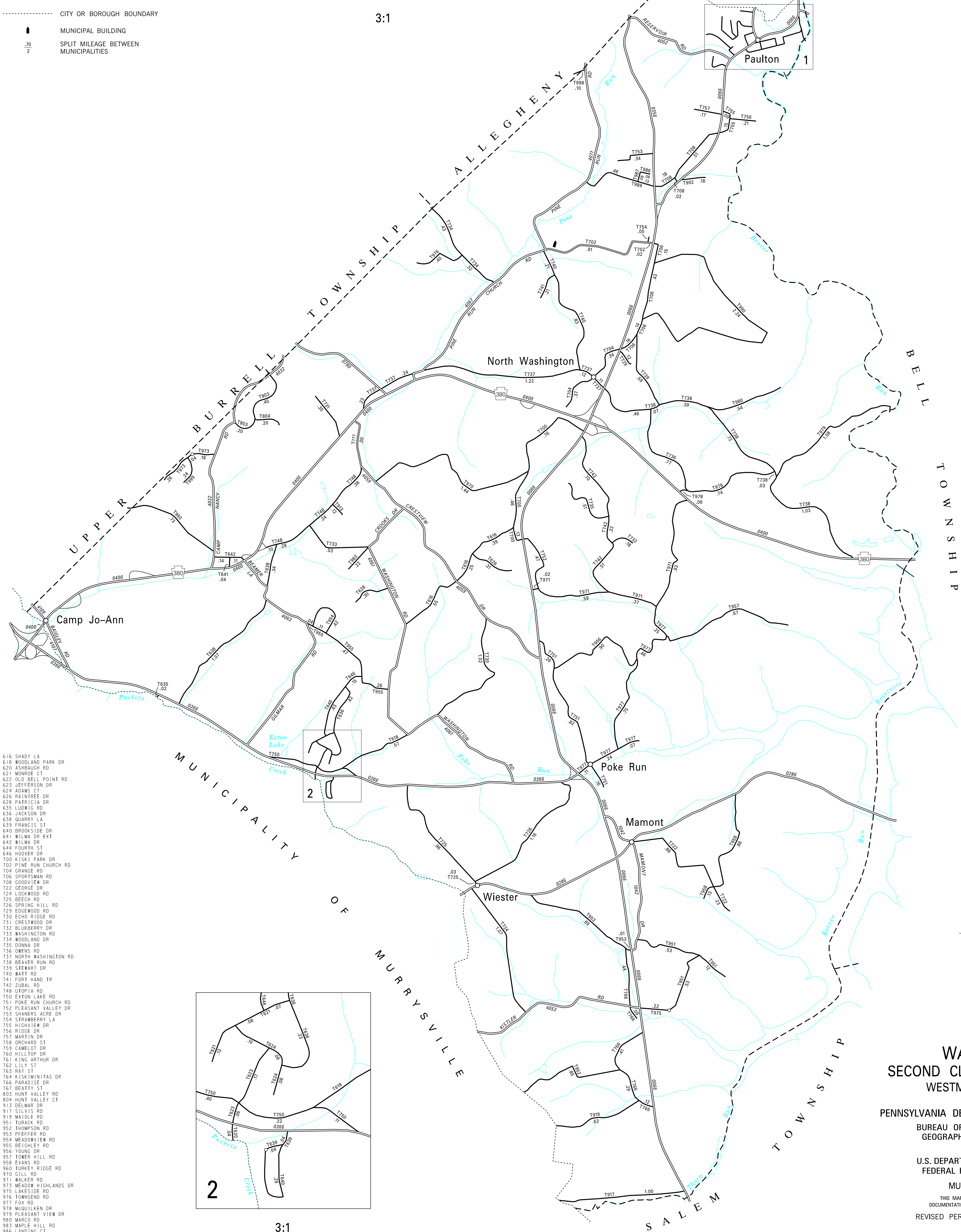

3:1

- 616 SHADY LA
- 618 WOODLAND PARK DR
- 620 ASHBAUGH RD
- 621 MONROE CT
- 622 OLD BELL POINT RD
- 623 JEFFERSON DR
- 624 ADAMS CT
- 626 RAINBOW DR
- 628 PATRICIA DR
- 635 LUDWIG RD
- 636 JACKSON DR
- 638 QUARRY LA
- 639 FRANCIS ST
- 640 BROOKSIDE DR
- 641 WILMA DR EXT
- 642 WILMA DR
- 644 FOURTH ST
- 646 HOOVER DR
- 700 KISAKI PARK DR
- 702 PINE RUN CHURCH RD
- 704 GRANGE RD
- 706 SPORTSMAN RD
- 708 GOODVIEW DR
- 722 GEORGE DR
- 724 LOCKWOOD RD
- 725 BEECH RD
- 726 SPRING HILL RD
- 729 EDGEWOOD RD
- 730 ECHO RIDGE DR
- 731 CRESTWOOD DR
- 732 BLUEBERRY DR
- 733 WASHINGTON RD
- 734 WOODLAND DR
- 735 DONNA DR
- 736 OWENS RD
- 737 NORTH WASHINGTON RD
- 738 BEAVER RUN RD
- 739 STEWART DR
- 740 BAIT RD
- 741 FOOT HAND TR
- 742 ZUBAL RD
- 748 UTOPIA RD
- 750 EXTON LAKE RD
- 751 POKE RUN CHURCH DR
- 752 PLEASANT VALLEY DR
- 753 SHANERS ACRE DR
- 754 STRAWBERRY LA
- 755 HIGHVIEW DR
- 756 RIDGE DR
- 757 MARTIN DR
- 758 ORCHARD ST
- 759 CAMELOT DR
- 760 HILL TOP DR
- 761 KING ARTHUR DR
- 762 LILY ST
- 763 BAY ST
- 764 KISKIMINUTAS DR
- 766 PARADISE DR
- 767 BEATTY ST
- 803 HUNT VALLEY DR
- 804 HUNT VALLEY CT
- 913 DELMAR DR
- 917 SILVIS DR
- 919 MAJOLE RD
- 921 TURACK RD
- 922 THOMPSON RD
- 923 PFEFFER RD
- 924 MEADOWVIEW DR
- 925 BEIGHLEY DR
- 926 YOUNG DR
- 927 TORER HILL DR
- 928 EVANS DR
- 930 TURKEY RIDGE DR
- 970 GILL RD
- 971 WALKER RD
- 973 MEADOW HIGHLANDS DR
- 975 LAKESIDE DR
- 976 TOWNSEND DR
- 977 FOX RD
- 978 MCQUILKEN DR
- 979 PLEASANT VIEW DR
- 980 MARCO RD
- 983 MAPLE HILL RD
- 986 LANDING CT
- 987 ORENDALE DR
- 988 OLD MILL RD
- 989 TUCKER RD
- 990 LANTIER TR
- 992 MUFFLEY DR
- 998 WATSON RD
- 999 SKYARK DR

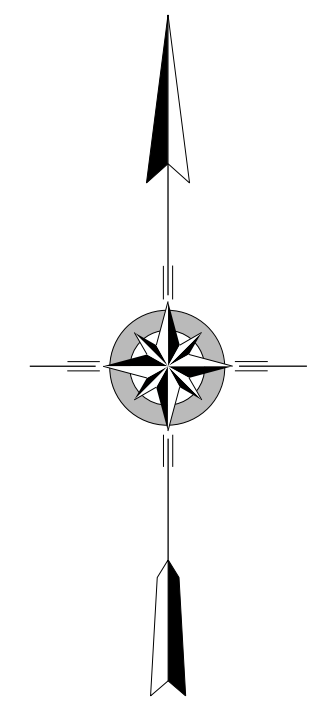

**WASHINGTON  
SECOND CLASS TOWNSHIP MAP  
WESTMORELAND COUNTY**

PREPARED BY THE  
PENNSYLVANIA DEPARTMENT OF TRANSPORTATION  
BUREAU OF PLANNING AND RESEARCH  
GEOGRAPHIC INFORMATION DIVISION  
IN COOPERATION WITH THE  
U.S. DEPARTMENT OF TRANSPORTATION  
FEDERAL HIGHWAY ADMINISTRATION  
MUNICIPAL CODE 64 219  
THIS MAP IS PUBLISHED AS A SUPPLEMENTAL  
DOCUMENTATION OF LIQUID FUELS TAX FUND MILEAGES  
REVISED PER FORM 990 DATED 12-4-19

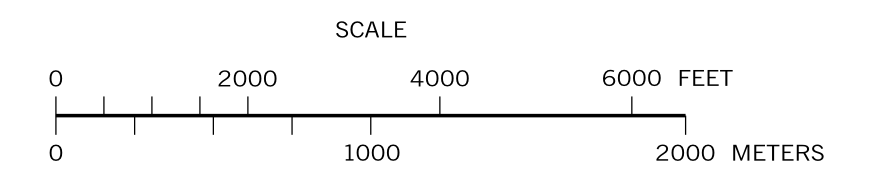

COPIES OF THIS MAP ARE AVAILABLE AT NOMINAL COST  
CONTACT:  
PENNSYLVANIA DEPARTMENT OF TRANSPORTATION  
SALES STORE  
P.O. BOX 3451  
HARRISBURG, PENNSYLVANIA 17105-3451  
TELEPHONE: (717) 783-4746