

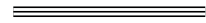











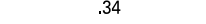

LEGEND

-  LIMITED ACCESS HIGHWAY
-  STATE ROUTE AND NUMBER
-  STATE MAINTAINED BRIDGE ON TOWNSHIP ROAD
-  TOWNSHIP ROAD, NUMBER AND SEGMENT LENGTH IN MILES
-  IMPASSABLE TOWNSHIP ROAD
-  OTHER ROAD
-  RAILROAD (IN SERVICE)
-  RAILROAD ABANDONED (TRACK RETAINED)
-  STATE BOUNDARY
-  COUNTY BOUNDARY
-  TOWNSHIP BOUNDARY
-  CITY OR BOROUGH BOUNDARY
-  MUNICIPAL BUILDING
-  SPLIT MILEAGE BETWEEN MUNICIPALITIES

TOTAL MILES	
Township Road System	54.59*
State Highway System	45.84
Total	100.43

* Includes ACT 32 Turnback Mileage of 5.63

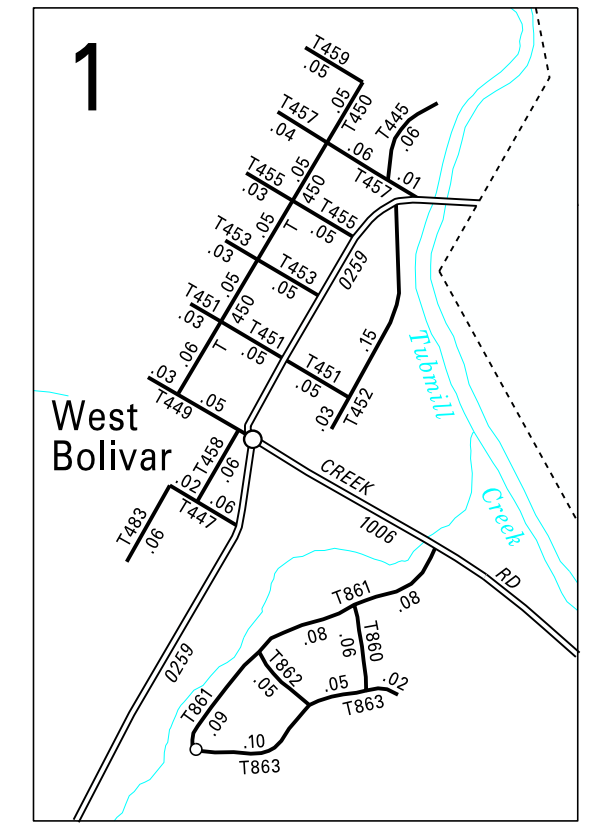
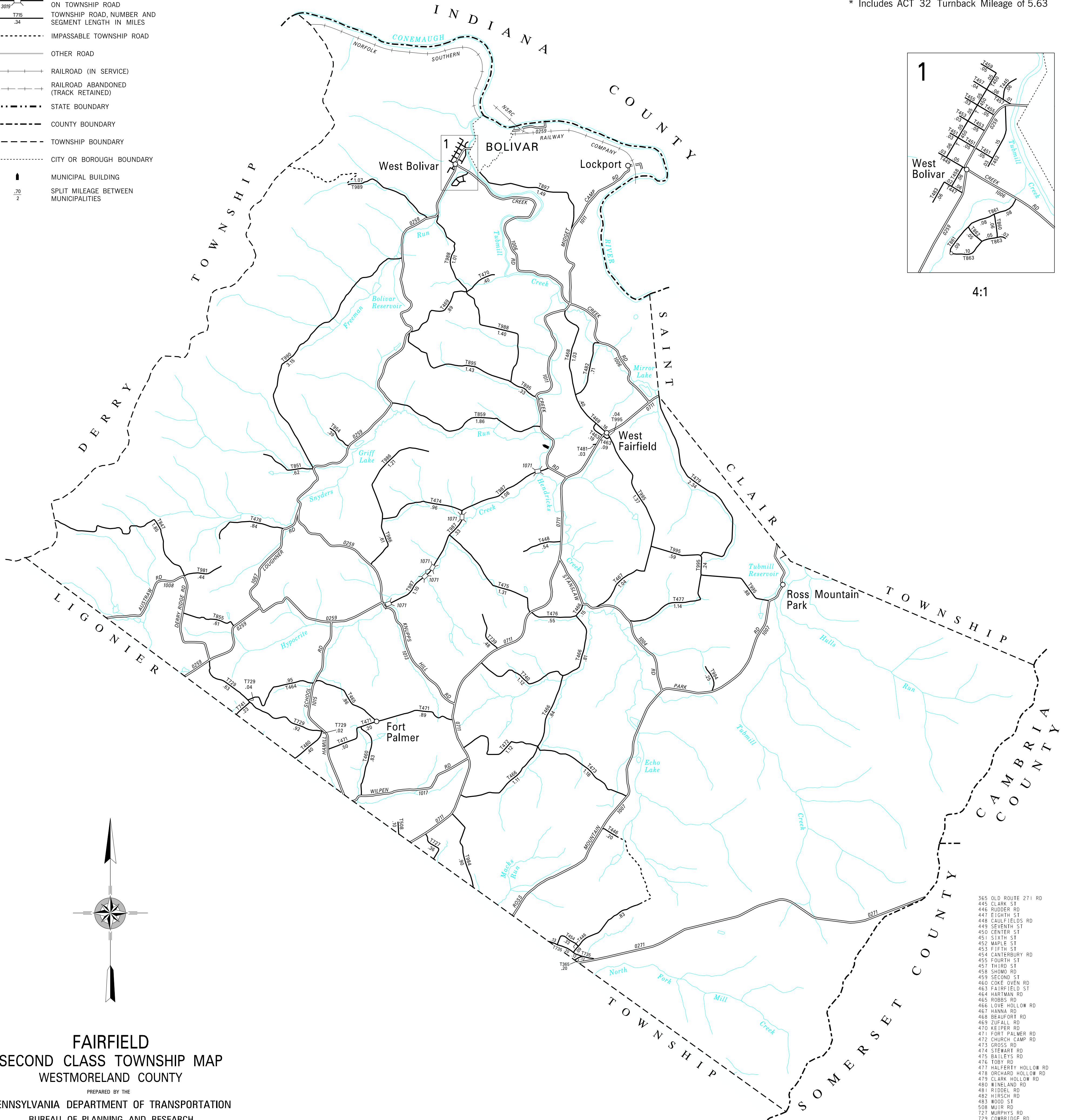

4:1

**FAIRFIELD
SECOND CLASS TOWNSHIP MAP
WESTMORELAND COUNTY**

PREPARED BY THE
PENNSYLVANIA DEPARTMENT OF TRANSPORTATION
BUREAU OF PLANNING AND RESEARCH
GEOGRAPHIC INFORMATION DIVISION
IN COOPERATION WITH THE
U.S. DEPARTMENT OF TRANSPORTATION
FEDERAL HIGHWAY ADMINISTRATION
MUNICIPAL CODE 64 207

REVISED PER FORM 990 DATED 8-10-10

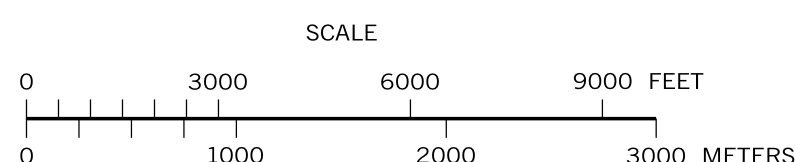

- 365 OLD ROUTE 271 RD
- 445 CLARK ST
- 446 RUDDER RD
- 447 EIGHTH ST
- 448 CAUL FIELDS RD
- 449 SEVENTH ST
- 450 CENTER ST
- 451 SIXTH ST
- 452 MAPLE ST
- 453 FIFTH ST
- 454 CANTERBURY RD
- 455 FOURTH ST
- 457 THIRD ST
- 458 SHOMO RD
- 459 SECOND ST
- 460 COKE OWEN RD
- 463 FAIRFIELD ST
- 464 HARTMAN RD
- 465 ROBBS RD
- 466 LOVE HOLLOW RD
- 467 HANNA RD
- 468 BEAUFORT RD
- 469 ZUFALL RD
- 470 KEIPER RD
- 471 FORT PALMER RD
- 472 CHURCH CAMP RD
- 473 GROSS RD
- 474 STEWART RD
- 475 BAILEYS RD
- 476 TOBY RD
- 477 HALBERTY HOLLOW RD
- 478 ORCHARD HOLLOW RD
- 479 CLARK HOLLOW RD
- 480 WINDLAND RD
- 481 RIDDEL RD
- 482 HIRSCH RD
- 483 WOOD ST
- 508 MUIR RD
- 727 MURPHYS RD
- 729 COMBRIDGE RD
- 730 TURKEY INN RD
- 739 PLUMMER RD
- 740 BERKEYS RD
- 741 CLAYCOMB RD
- 847 FIRETOWER RD
- 851 SHIRLEY HOLLOW RD
- 855 SHIREY RD
- 859 GIRL SCOUT CAMP RD
- 860 SHORT ST
- 861 CORVI RD
- 862 MIDDLE ST
- 863 JOHNSTON ST
- 895 LANTLINGER HOLLOW RD
- 897 GRAVEYARD HILL RD
- 899 FOUNDRY RD
- 954 THOMAS RD
- 981 PLUTO RD
- 984 UMHEYS RD
- 986 BRIDGES RD
- 987 HYPOCRITE RD
- 988 STIFFLER RD
- 989 TEAGER HOLLOW RD
- 990 PATTERSON RD
- 994 WHERRY RD
- 995 MOUNTAIN VIEW RD