

TOTAL MILES
 Township Road System 58.33*
 State Highway System 40.18
 Total 98.51

* Includes ACT 32 Turnback Mileage of 2.35

- | | |
|-------------------------|---------------------------|
| 303 TARA ST | 800 CONCORD DR |
| 304 CASPIAN DR | 801 VERMONT ST |
| 305 RURAL AV | 802 LARCH ST |
| 306 KINGSWOOD CT | 803 CREST AV |
| 308 CONSTITUTION CT | 805 WILBERT AV |
| 310 WASHINGTON WOODS DR | 807 SHIRLEY ANN DR |
| 311 INDEPENDENCE BLVD | 901 MORRIS ST |
| 312 POTOMAC DR | 902 HOMER AV |
| 313 GEORGETOWN CT | 906 BEECH ST |
| 417 WENERS RD | 908 ORCHARD LA |
| 478 ROBERTS RD | 910 HILLCREST AV |
| 479 SIMMONS RD | 911 CRILE RD |
| 481 MCCOY ST | 912 SHADYSIDE AV |
| 483 MANSE ST | 914 FAIRVIEW AV |
| 484 HAWTHORNE DR | 915 EVERGREEN DR |
| 485 WOODLAN DR | 916 ORACLE RD |
| 487 SARA DR | 918 MOGER DR |
| 489 CRESTVIEW DR | 919 CLARE DR |
| 490 ANCHOR DR | 920 ASHMORE SUMMIT ST |
| 491 VERONA RD | 924 GLENN ST |
| 492 NEVADA ST | 925 ASH DR |
| 493 KISH AV | 926 DONNAN AV |
| 494 IDAHO ST | 928 PRESTON RD |
| 495 WOODSIDE DR | 930 FRANKLIN ST |
| 496 STONEHENGE DR | 932 CEDAR LA |
| 500 EIGHTY FOUR RD | 934 MAGNOLA DR |
| 501 EIGHTFOUR RD | 936 PATTERNS AV |
| 502 HILL TOP ACRES DR | 938 ELM WOOD DR |
| 504 KEAVER SPUR RD | 940 HARTHORNE ST |
| 505 SANITARIUM RD | 941 JOHN ST |
| 506 SWARTZ SPUR RD | 942 NO NAME RD |
| 507 LACOCK HILL RD | 943 ENTERPRISE RD |
| 508 WALTER SPUR RD | 944 NASER AV |
| 509 TANNHILL RD | 946 STATEMENT AV |
| 510 PAUL DR | 951 ANDERSON RD |
| 511 SAMUEL DR | 953 SUNSET BLVD |
| 512 ACRE DR | 967 AMY DR |
| 514 STONE MARKER DR | 968 MCCLANE AV |
| 515 PLEASANT HILLS DR | 969 HIGH ST |
| 516 NO NAME RD | 971 NO NAME RD |
| 517 KELLY DR | 973 BROWNLEE LA |
| 518 LEE AV | 975 PIERCE DR |
| 519 JANEY ST | 977 STREATOR DR |
| 520 BUD ST | 979 COLONIAL HEIGHTS BLVD |
| 521 KDA RD | 981 ORCHARD TER |
| 522 PRALL LA | 983 HUMBERT LA |
| 523 NO NAME RD | 985 MICHIGAN ST |
| 524 NO NAME RD | 986 ASPEN DR |
| 526 MUNLEY RIDGE DR | 987 ELBERTA DR |
| 527 MANOR DR | 989 SHERRARD DR |
| 533 PONDOR RD | 990 DODD DR |
| 534 CEDAR DR | 991 SANDERS DR |
| 538 WREN WAY | 992 WUM DR |
| 569 MAPLE AV | 993 LISA DR |
| 571 SMITH DR | 994 BALSAM DR |
| 572 CAMERON RD | 995 FOX DR |
| 573 FLORENCE HILL RD | 996 BIRCH DR |
| 574 WILSON RD | 997 ROBIN DR |
| 575 ROUPE RD | 998 GINA DR |
| 580 WILLOWBROOK DR | 999 CRABAPPLE DR |
| 581 RIGGS DR | |
| 582 MAPLEWOOD CIR | |
| 583 LOMBARD CIR | |
| 611 CANOE DR | |
| 612 SHANNEE DR | |
| 613 MOCCASIN DR | |
| 614 FLINT DR | |
| 615 ARROWHEAD DR | |
| 616 TOMAHAWK CT | |
| 617 MEADOWVIEW RD | |
| 618 STONE AV | |
| 619 PHILLIPS DR | |
| 620 BERRY DR | |
| 621 WARWICK DR | |
| 622 HUDAK HILL RD | |
| 623 DEER DR | |
| 625 IHOM RD | |
| 627 MUNCE RIDGE RD | |
| 628 WOOD CLIFF DR | |
| 629 FISCHER RD | |
| 630 HANNON DR | |
| 631 OAK HILL DR | |
| 632 EMERALD DR | |
| 633 GREEN CRESCENT DR | |
| 634 PARKVIEW DR | |
| 635 FERNWOOD CT | |
| 636 NORTHVIEW CT | |
| 637 PARK TER | |
| 638 ZEDIKER STATION RD | |
| 640 LYMAN AV | |
| 641 VANCE STATION RD | |
| 644 BODD RD | |
| 645 NANNIE ST | |
| 646 EASTWOOD DR | |
| 647 LAKEVIEW DR | |
| 670 TANGER BLVD | |
| 681 SCOUT DR | |
| 682 QUARRY RD | |
| 684 KOPPER KETTLE RD | |
| 694 PARKVIEW DR | |
| 720 MITCHELL RD | |
| 724 STRABANE DR | |
| 725 BEAGLE CLUB RD | |
| 726 CARRIER RD | |
| 727 PANORAMA DR | |
| 728 HORNOR DR | |
| 730 FARLEY AV | |

- LEGEND**
- LIMITED ACCESS HIGHWAY
 - STATE ROUTE AND NUMBER
 - STATE MAINTAINED BRIDGE ON TOWNSHIP ROAD
 - TOWNSHIP ROAD, NUMBER AND SEGMENT LENGTH IN MILES
 - - - - - IMPASSABLE TOWNSHIP ROAD
 - - - - - TURNBACK TOWNSHIP ROAD
 - - - - - OTHER ROAD
 - RAILROAD (IN SERVICE)
 - - - - - RAILROAD ABANDONED (TRACK RETAINED)
 - - - - - STATE BOUNDARY
 - - - - - COUNTY BOUNDARY
 - - - - - TOWNSHIP BOUNDARY
 - - - - - CITY OR BOROUGH BOUNDARY
 - MUNICIPAL BUILDING
 - SPLIT MILEAGE BETWEEN MUNICIPALITIES

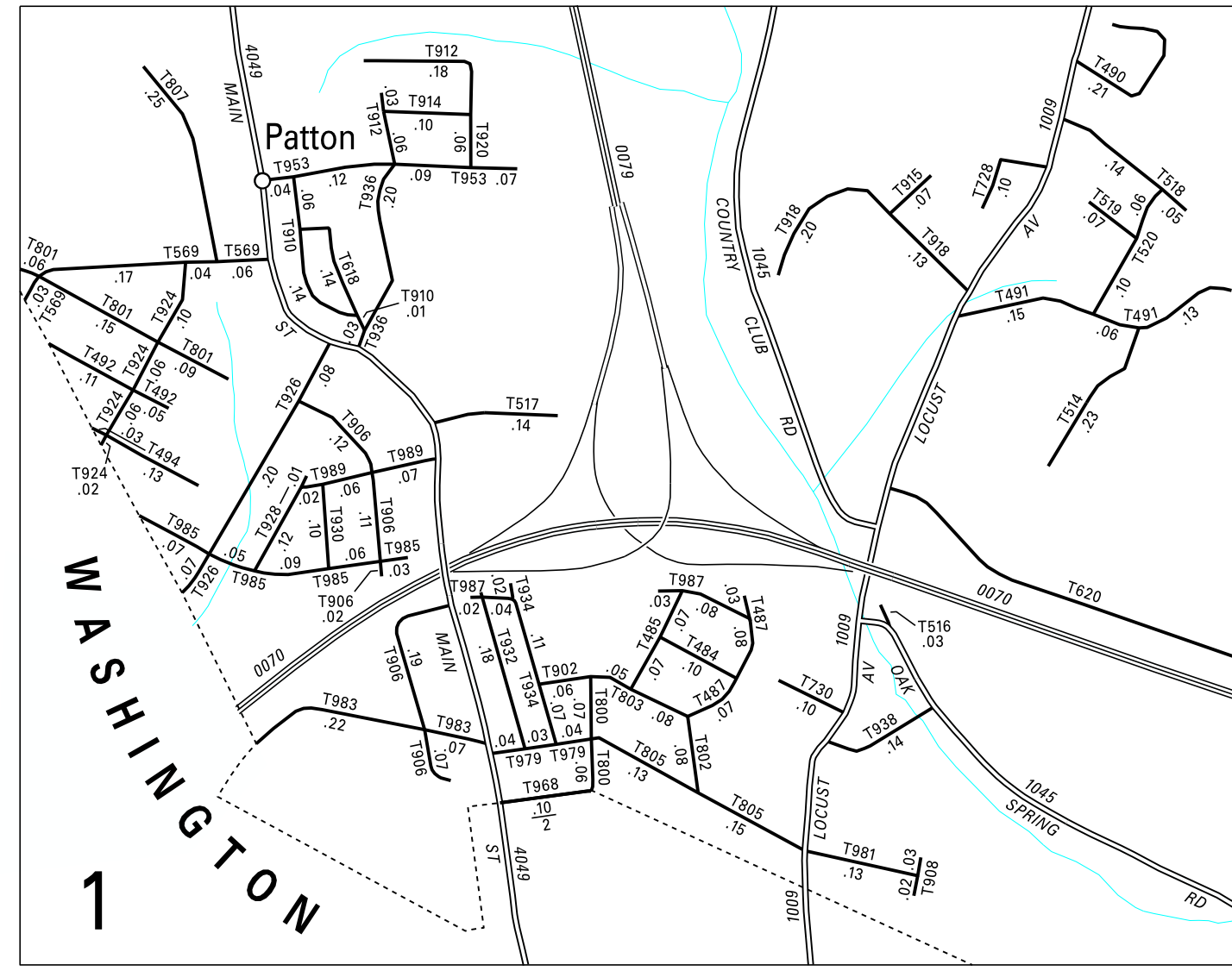

2:1

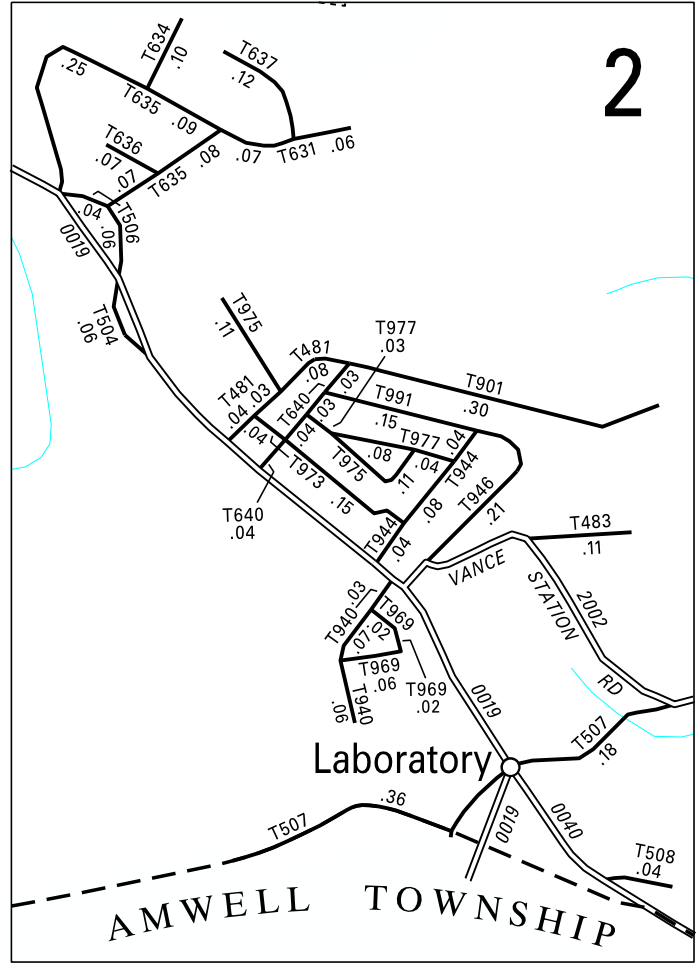

2:1

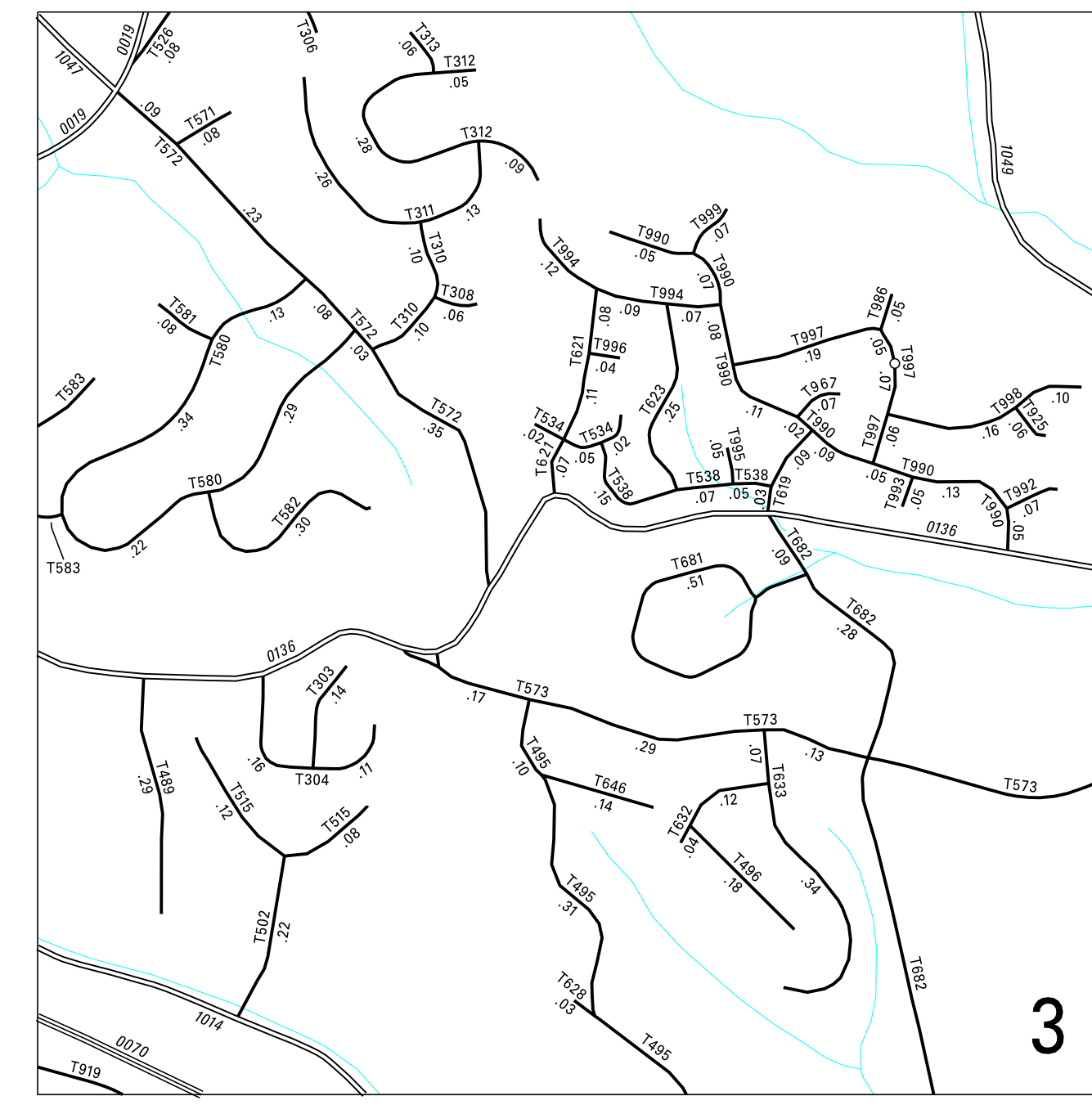

2:1

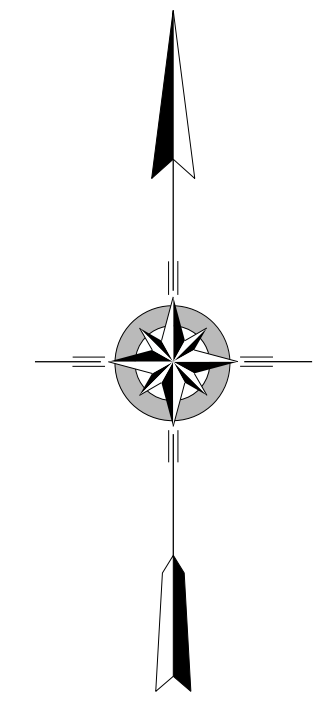
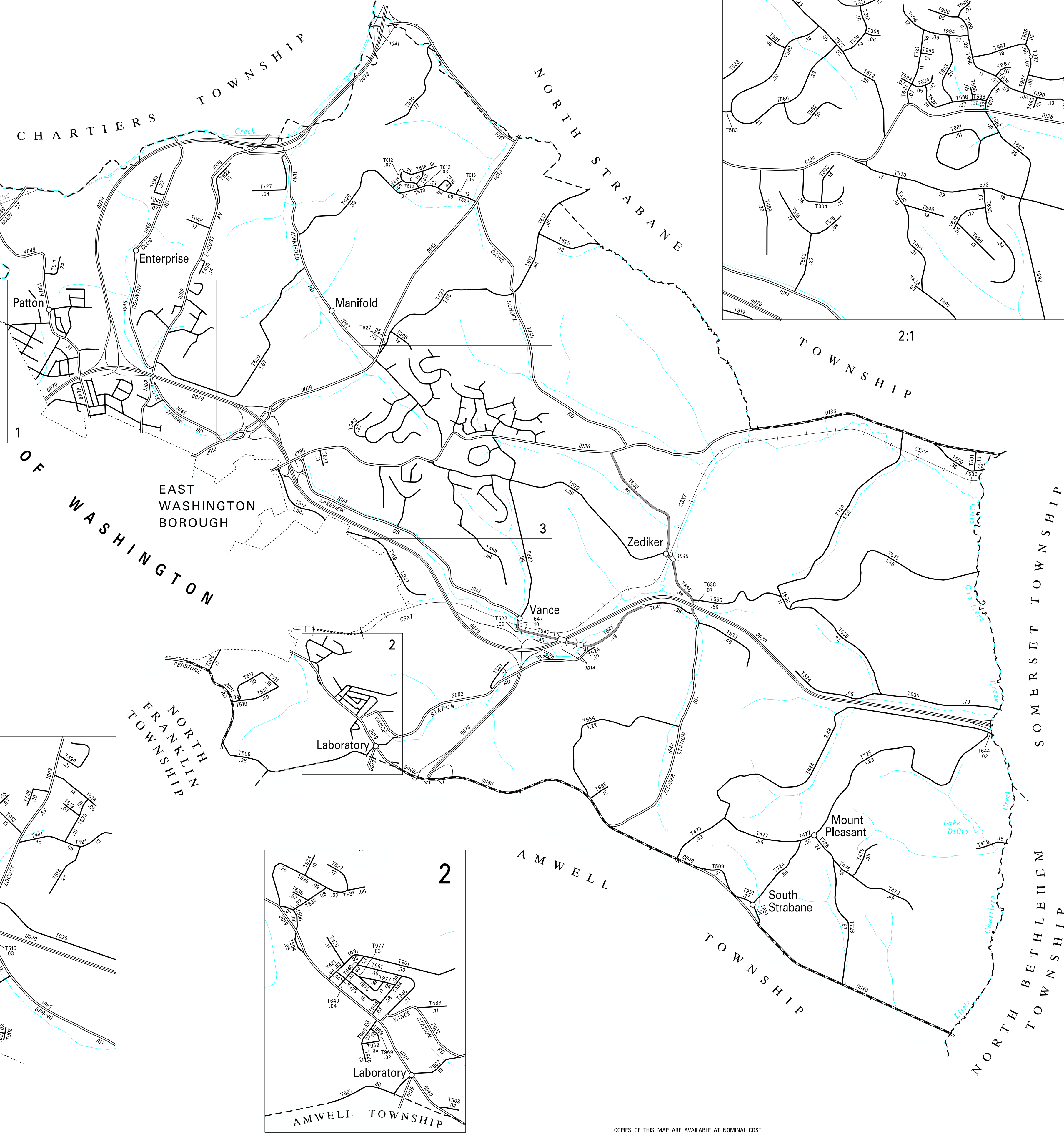

**SOUTH STRABANE
 SECOND CLASS TOWNSHIP MAP
 WASHINGTON COUNTY**

PREPARED BY THE
 PENNSYLVANIA DEPARTMENT OF TRANSPORTATION
 BUREAU OF PLANNING AND RESEARCH
 GEOGRAPHIC INFORMATION DIVISION
 IN COOPERATION WITH THE
 U.S. DEPARTMENT OF TRANSPORTATION
 FEDERAL HIGHWAY ADMINISTRATION
 MUNICIPAL CODE 62 227
 THIS MAP IS PUBLISHED AS A SUPPLEMENTAL
 DOCUMENTATION OF LIQUID FUELS TAX FUND MILEAGES
 REVISED PER FORM 990 DATED 11-16-21

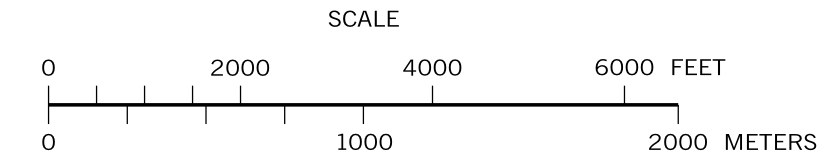

COPIES OF THIS MAP ARE AVAILABLE AT NOMINAL COST
 CONTACT:
 PENNSYLVANIA DEPARTMENT OF TRANSPORTATION
 SALES STORE
 P.O. BOX 3451
 HARRISBURG, PENNSYLVANIA 17105-3451
 TELEPHONE: (717) 787-6746