

TOTAL MILES	
Township Road System	34.45
State Highway System	22.19
Total	56.64

LEGEND

- LIMITED ACCESS HIGHWAY
- STATE ROUTE AND NUMBER
- STATE MAINTAINED BRIDGE ON TOWNSHIP ROAD
- TOWNSHIP ROAD, NUMBER AND SEGMENT LENGTH IN MILES
- IMPASSABLE TOWNSHIP ROAD
- OTHER ROAD
- RAILROAD (IN SERVICE)
- RAILROAD ABANDONED (TRACK RETAINED)
- STATE BOUNDARY
- COUNTY BOUNDARY
- TOWNSHIP BOUNDARY
- CITY OR BOROUGH BOUNDARY
- MUNICIPAL BUILDING
- SPLIT MILEAGE BETWEEN MUNICIPALITIES

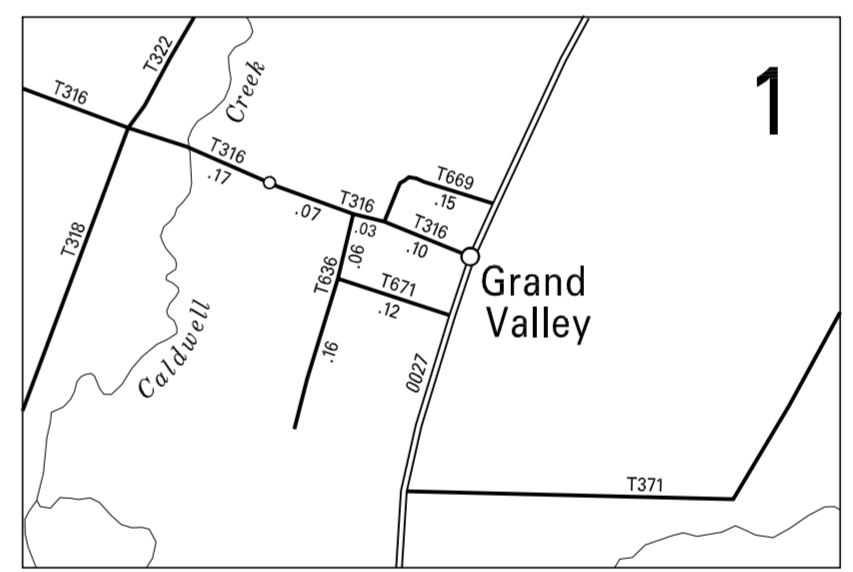
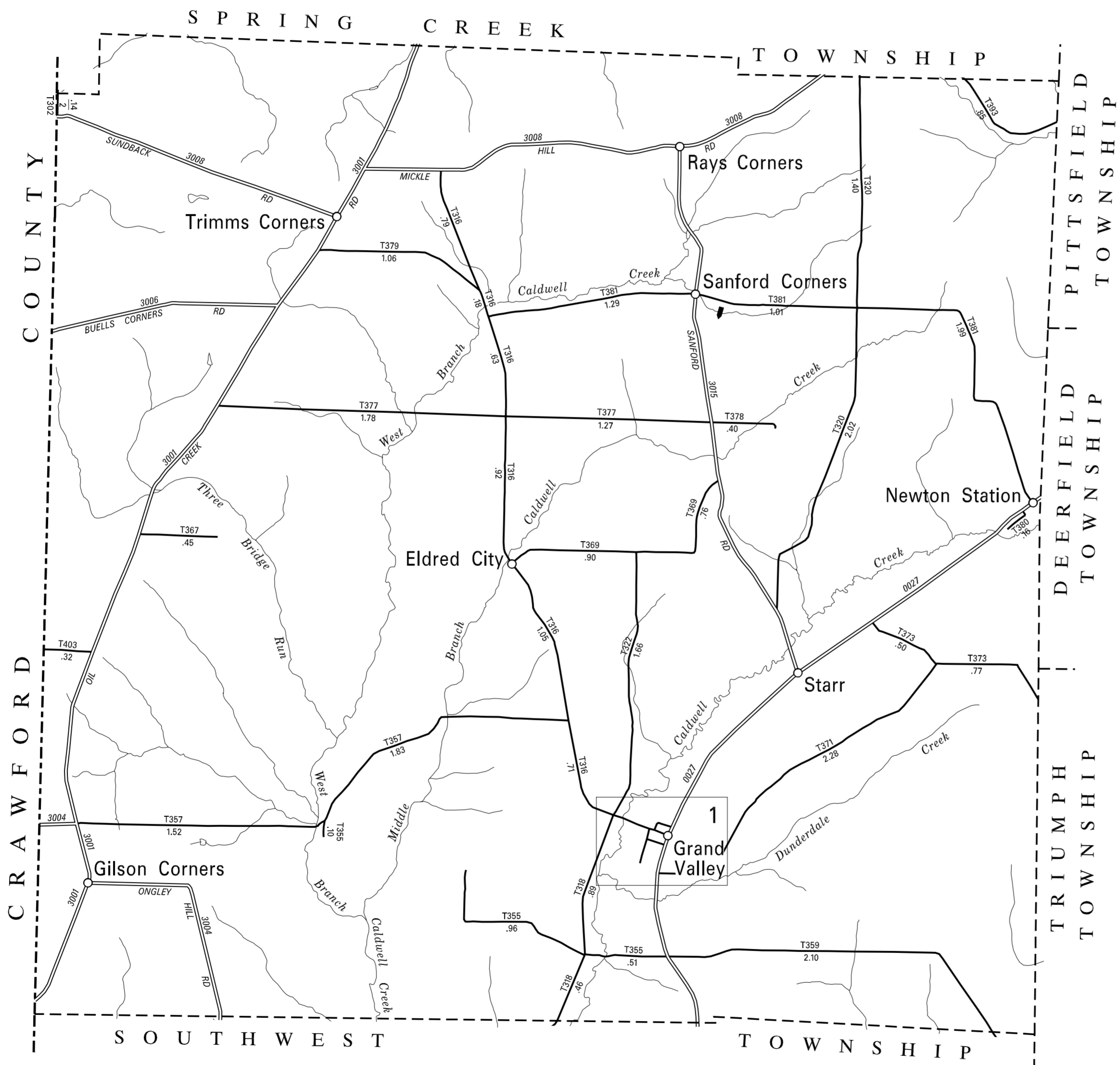
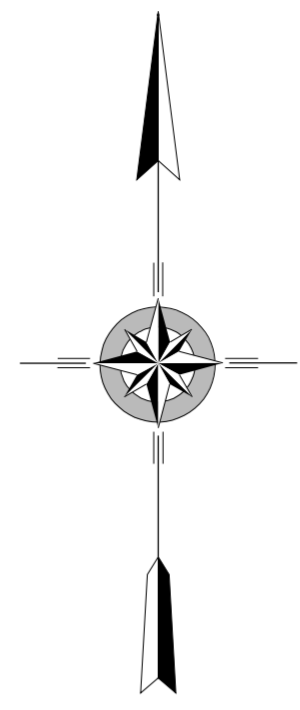

3:1

**ELDRED
SECOND CLASS TOWNSHIP MAP
WARREN COUNTY**

PREPARED BY THE
PENNSYLVANIA DEPARTMENT OF TRANSPORTATION
BUREAU OF PLANNING AND RESEARCH
GEOGRAPHIC INFORMATION DIVISION
IN COOPERATION WITH THE
U.S. DEPARTMENT OF TRANSPORTATION
FEDERAL HIGHWAY ADMINISTRATION
MUNICIPAL CODE 61 207

REVISED PER FORM 990 DATED 3-24-00

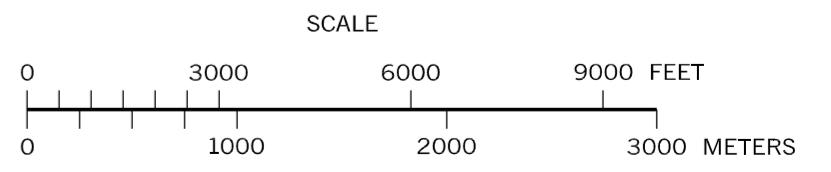

TYPE 5 MAP ELDRED TOWNSHIP WARREN COUNTY PENNSYLVANIA

- 302 COLD SPRING RD
- 316 ELDRED CENTER RD
- 318 FLAT RD
- 320 HUNT RD
- 322 HOOVER RD
- 355 CHAPPEL HILL RD
- 357 GOSSVILLE RD
- 359 EMERSON RD
- 367 LAMB RD
- 369 FIDDLERS GREEN RD
- 371 CHURCH HILL RD
- 373 BUCKLEY RD
- 377 EUREKA RD
- 378 REYNOLDS RD
- 379 DEVILSLIDE RD
- 380 BROWN RD
- 381 NEWTON RD
- 393 TORPEDO RD
- 403 HARRISON RD
- 636 WOOD ST
- 669 MILL ST
- 671 GOODWILL ST