

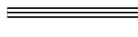

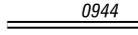

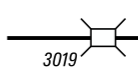

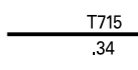
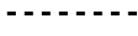

TOTAL MILES	
Township Road System	36.91
State Highway System	18.35
Total	55.26

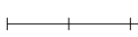
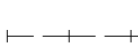
LEGEND

-  LIMITED ACCESS HIGHWAY
-  STATE ROUTE AND NUMBER
-  STATE MAINTAINED BRIDGE ON TOWNSHIP ROAD
-  TOWNSHIP ROAD, NUMBER AND SEGMENT LENGTH IN MILES
-  IMPASSABLE TOWNSHIP ROAD
-  OTHER ROAD
-  RAILROAD (IN SERVICE)
-  RAILROAD ABANDONED (TRACK RETAINED)
-  STATE BOUNDARY
-  COUNTY BOUNDARY
-  TOWNSHIP BOUNDARY
-  CITY OR BOROUGH BOUNDARY
-  MUNICIPAL BUILDING
-  SPLIT MILEAGE BETWEEN MUNICIPALITIES

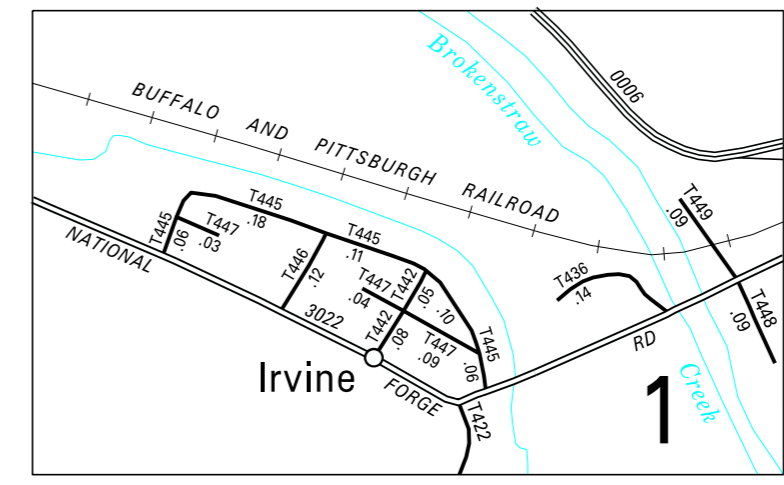
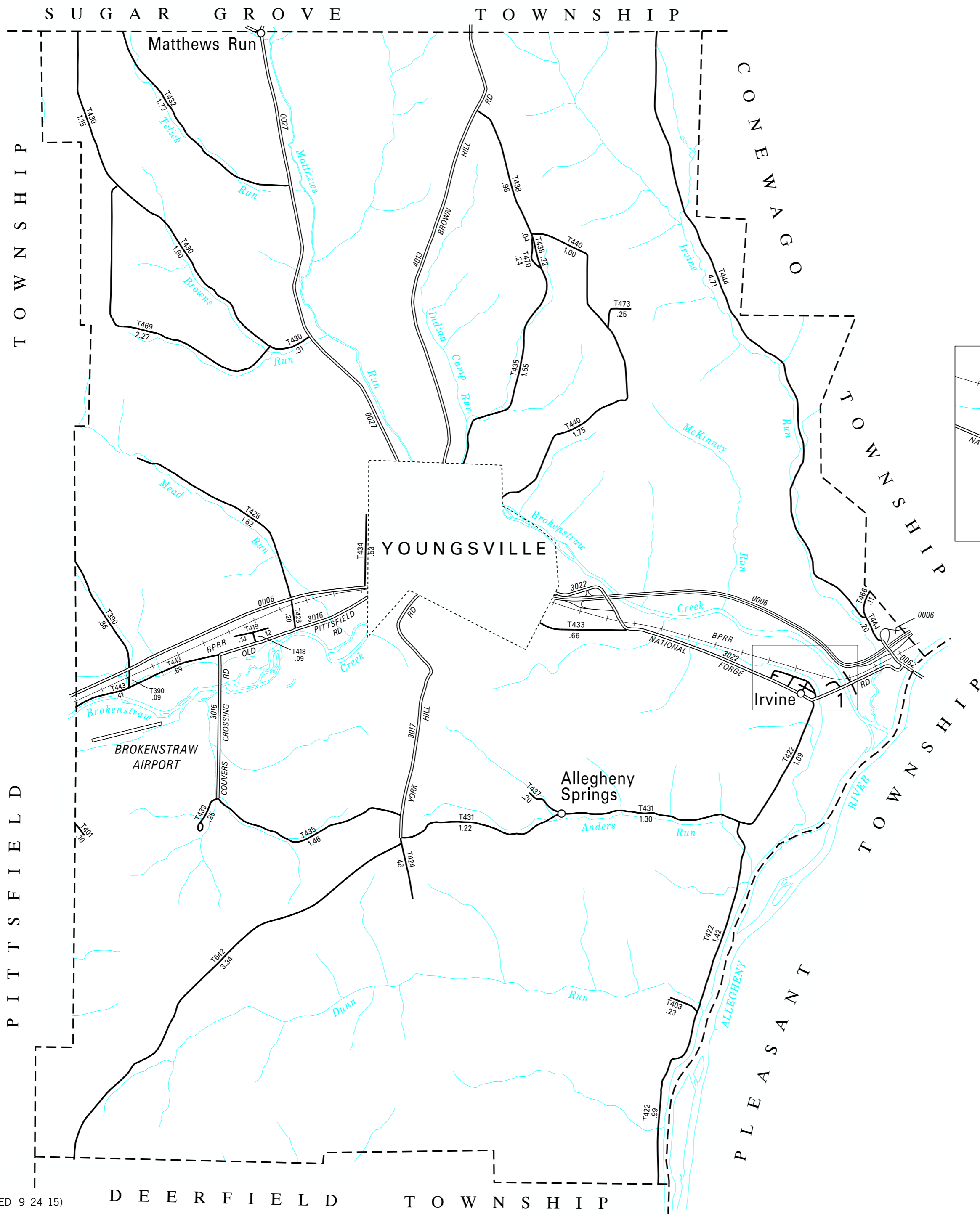

3:1

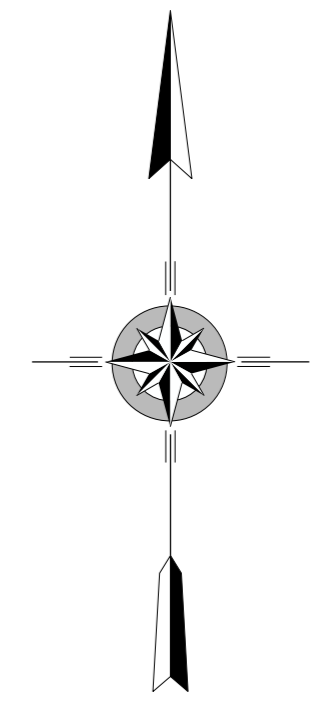

**BROKENSTRAW
SECOND CLASS TOWNSHIP MAP
WARREN COUNTY**

PREPARED BY THE
PENNSYLVANIA DEPARTMENT OF TRANSPORTATION
BUREAU OF PLANNING AND RESEARCH
GEOGRAPHIC INFORMATION DIVISION

IN COOPERATION WITH THE
U.S. DEPARTMENT OF TRANSPORTATION
FEDERAL HIGHWAY ADMINISTRATION
MUNICIPAL CODE 61 201

REVISED PER FORM 990 DATED 6-6-05

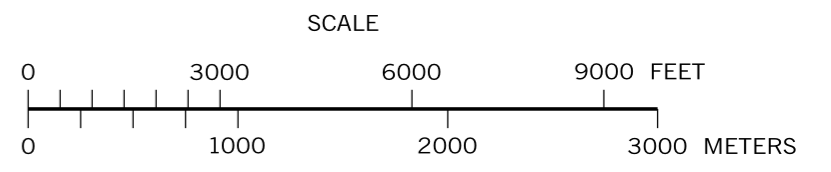

- 390 ABRAHAM HOLLOW RD
- 401 PULFER HILL RD
- 403 DAILEY RD
- 418 WILLIAMS ST
- 419 PATTI LA
- 422 DUNNS EDDY RD
- 424 YORK HILL RD
- 428 MEAD RUN RD
- 430 MURRAY HILL RD
- 431 ALLEGHENY SPRING RD
- 432 TELIC RUN RD
- 433 ROUSE AV
- 434 THATCHER LA
- 435 CRIPPEN HILL RD
- 436 CIRCLE DR
- 437 SULPHER SPRINGS RD
- 438 INDIAN CAMP RN
- 439 MAYNARD RD
- 440 HULL HILL RD
- 442 DEPOT ST
- 443 OLD PITTSFIELD RD
- 444 IRVINE RUN RD
- 445 ERIE AV
- 446 JOHNSON ST
- 447 HAZEL ST
- 448 BOSKO ST
- 449 MCKINNEY RUN RD
- 466 KELLER RD
- 469 LAUGER RD
- 470 GORTONS RD
- 473 TOM CARROL RD
- 642 ROCKY RIDGE RD