

POPULATION 5,294
(2010 Census)

TOTAL MILES
Borough Road System 48.98*
State Highway System 36.70
Total 85.68

* Includes ACT 32 Turnback Mileage of 1.19

ALLENBAUGH RD
BAKER ST
BEATTY RUN RD
BELL AV
CAMPBELL AL
CAUSEWAY DR
CEDAR ST
CHERRYTREE RD
CHESTNUT ST
CIRCLE ST
CRESTVIEW DR
DUKE ST
EGBERT ST
EIGHTH ST
ELM ST
FERN AV
FIFTH ST
FIRST AV
FIRST ST
FOSTER RD
FOURTH ST
FOX ST
FRONT ST
GIBB RD
GILFILLAN ST
GRIMM ST
HAZEL ST
HICKORY ST
INDEPENDENT RD
JAMES ST
KARNS ST
KEELY RD
KENNERDELL ST
KENNETH ST
KISTLER ST
LAMBERTON RD
LAMBERTON ST
MANOR DR
MAPLE DR
MAPLE ST
MARSHALL ST
MARTIN HILL RD
McCALMONT ST
McCLEERY RD
McQUAID ST
MILLER ST
MONG WAY
MURDOCK ST
NESBIT ST
NINTH ST
OAK AV
OAK ST
OBSERVATION ST
OLD ROUTE 322
PALMER AV
PARK AV
PARK ST

PARKER AV
PENNELL ST
PHILLIPS DR
PHIPPS ST
PINE RD
PROSPECT AV
ROCCA WAY
RUSSELL ST
SALTICK DR
SECOND AV
SECOND ST
SEVENTH ST
SEYSLER RD
SHAFFER RUN RD
SHUFFSTALL ST
SIXTH ST
SLEEPY HOLLOW DR
SPRUCE ST
SUGARCREEK DR
TAKITEZY RD
TENTH ST
THIRD ST
THIRD ST
TRANSIT ST
VENANGO ST
VINCENT RD
WALNUT DR
WALNUT ST
WARREN RD
WEAVER ST
WHITMAN RD
WILSON ST
WILEY WAY
WILEY AV
WILSON AV
WILSON ST

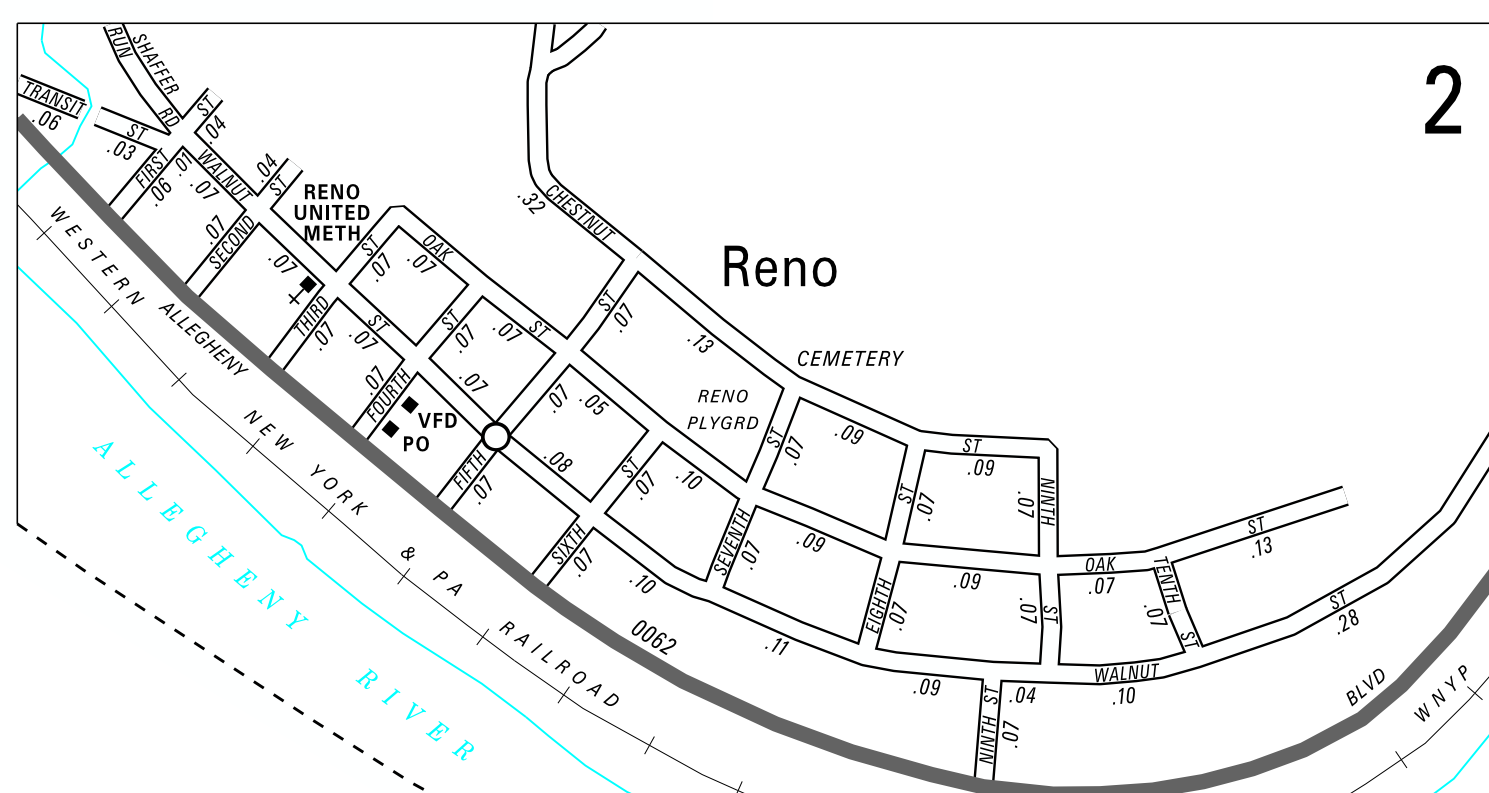
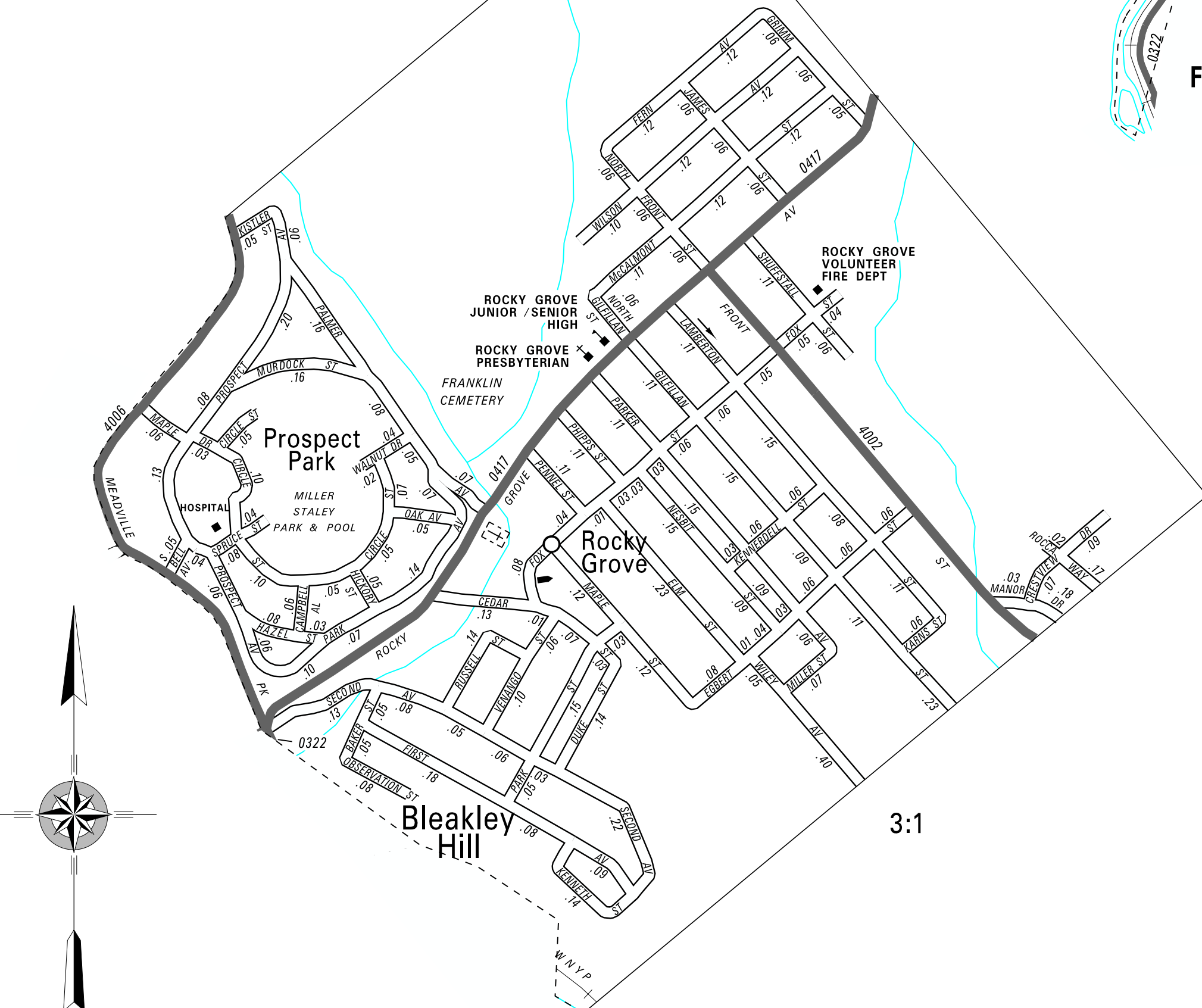
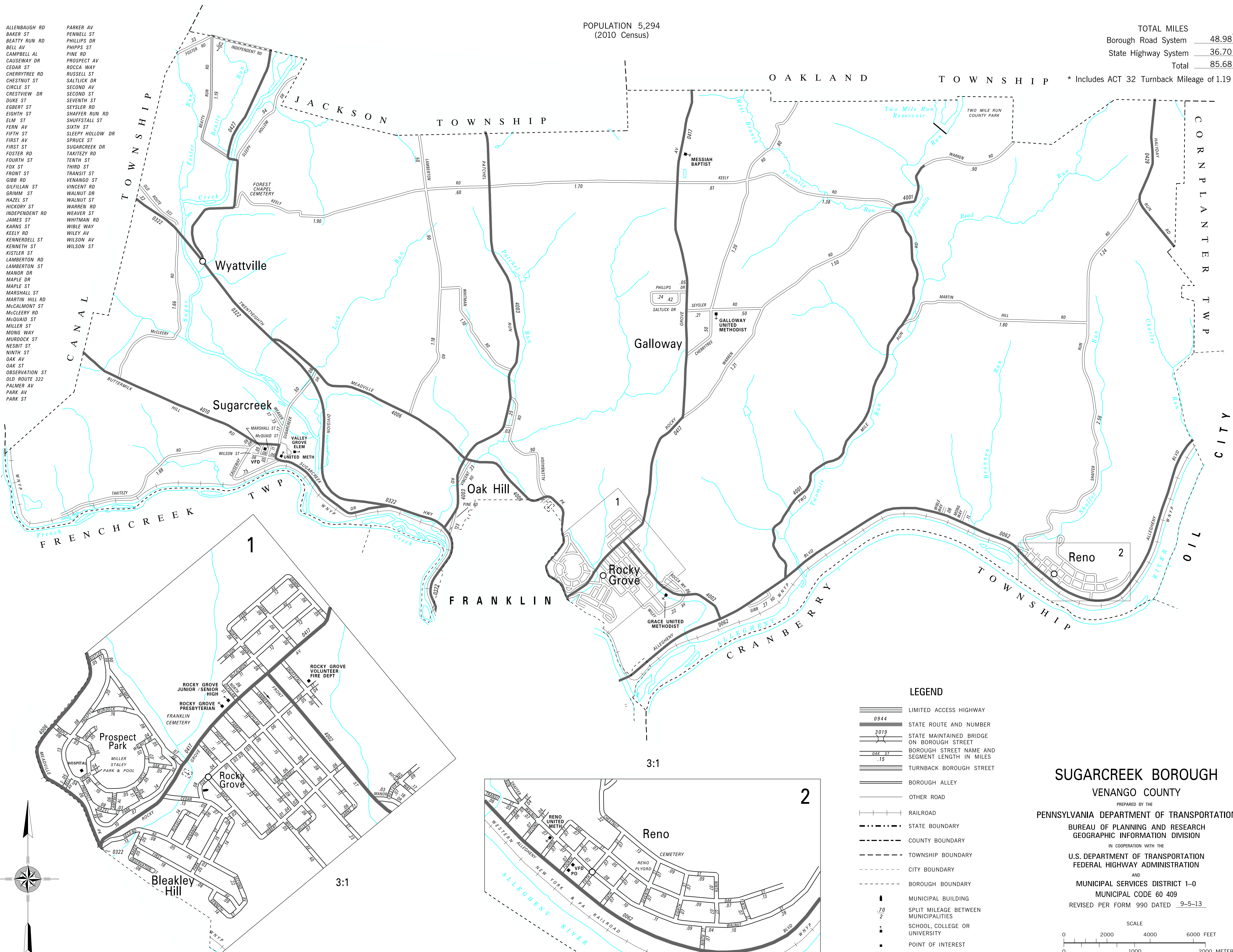

LEGEND

	LIMITED ACCESS HIGHWAY
	STATE ROUTE AND NUMBER
	STATE MAINTAINED BRIDGE ON BOROUGH STREET
	BOROUGH STREET NAME AND SEGMENT LENGTH IN MILES
	TURNBACK BOROUGH STREET
	BOROUGH ALLEY
	OTHER ROAD
	RAILROAD
	COUNTY BOUNDARY
	TOWNSHIP BOUNDARY
	CITY BOUNDARY
	BOROUGH BOUNDARY
	MUNICIPAL BUILDING
	SPLIT MILEAGE BETWEEN MUNICIPALITIES
	SCHOOL, COLLEGE OR UNIVERSITY
	POINT OF INTEREST

SUGARCREEK BOROUGH
VENANGO COUNTY
PREPARED BY THE
PENNSYLVANIA DEPARTMENT OF TRANSPORTATION
BUREAU OF PLANNING AND RESEARCH
GEOGRAPHIC INFORMATION DIVISION
IN COOPERATION WITH THE
U.S. DEPARTMENT OF TRANSPORTATION
FEDERAL HIGHWAY ADMINISTRATION
AND
MUNICIPAL SERVICES DISTRICT 1-0
MUNICIPAL CODE 60 409
REVISED PER FORM 990 DATED 9-5-13

