

TOTAL MILES	
Township Road System	18.56
State Highway System	13.65
Total	32.21

COPIES OF THIS MAP ARE AVAILABLE AT NOMINAL COST  
CONTACT:  
PENNSYLVANIA DEPARTMENT OF TRANSPORTATION  
SALES STORE  
P.O. BOX 3451  
HARRISBURG, PENNSYLVANIA 17105-3451  
TELEPHONE: (717)787-6746

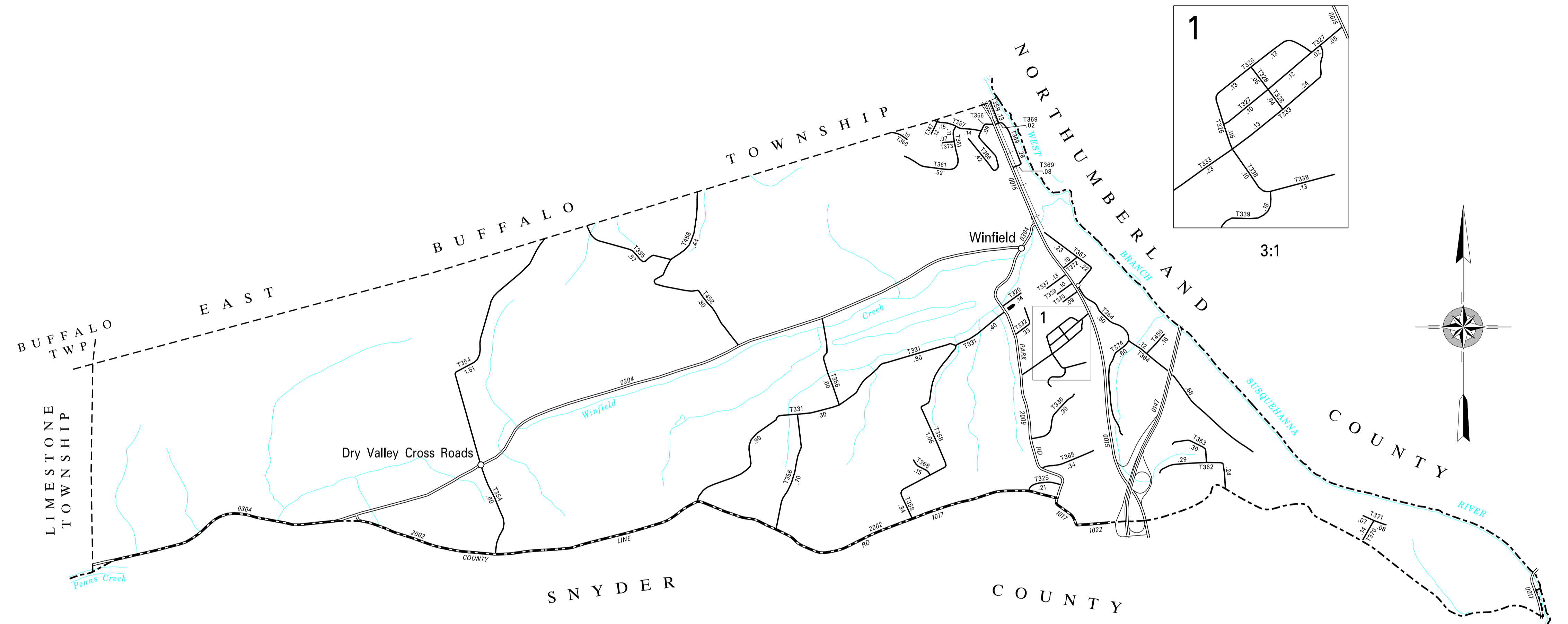

- 320 MUNICIPAL LA
- 325 PANORAMA DR
- 326 MARGARET TER
- 327 ALBERT BLVD
- 328 HOPE AV
- 329 WILLIAM ST
- 330 ROHLAND ST
- 331 FELMEY RD
- 332 SHIRLEY DR
- 333 SANDEL RD
- 335 FRUIT FARM RD
- 336 BLUEBIRD LA
- 337 MURRAY ST
- 338 EVERGREEN DR
- 339 CREST VIEW DR
- 347 MARCH CIR
- 354 STEIN LA
- 356 AMISH RD
- 357 TIMBERWOOD DR
- 358 TRUITT RD
- 359 MAPLEWOOD DR
- 360 OAKWOOD DR
- 361 FOX RIDGE LA
- 362 MULLS HOLLOW RD
- 363 GREGORY DR
- 364 SEVEN KITCHENS RD
- 365 RIDGE RD
- 366 GROOVER DR
- 367 REITZ AV
- 368 WOODSEDGE DR
- 369 RIVER BREEZE AV
- 370 HEIDI DR
- 371 MASON LA
- 372 NELSON RD
- 373 COTTONWOOD LA
- 374 GOBBLER RD
- 458 SUPPLEE MILL RD
- 459 SILO LA

**LEGEND**

	LIMITED ACCESS HIGHWAY
	STATE ROUTE AND NUMBER
	STATE MAINTAINED BRIDGE ON TOWNSHIP ROAD
	TOWNSHIP ROAD, NUMBER AND SEGMENT LENGTH IN MILES
	IMPASSABLE TOWNSHIP ROAD
	TURNBACK TOWNSHIP ROAD
	OTHER ROAD
	RAILROAD (IN SERVICE)
	RAILROAD ABANDONED (TRACK RETAINED)
	STATE BOUNDARY
	COUNTY BOUNDARY
	TOWNSHIP BOUNDARY
	CITY OR BOROUGH BOUNDARY
	MUNICIPAL BUILDING
	SPLIT MILEAGE BETWEEN MUNICIPALITIES

**UNION  
SECOND CLASS TOWNSHIP MAP  
UNION COUNTY**

PREPARED BY THE  
**PENNSYLVANIA DEPARTMENT OF TRANSPORTATION**  
BUREAU OF PLANNING AND RESEARCH  
GEOGRAPHIC INFORMATION DIVISION  
IN COOPERATION WITH THE  
**U.S. DEPARTMENT OF TRANSPORTATION**  
FEDERAL HIGHWAY ADMINISTRATION  
MUNICIPAL CODE 59 208  
THIS MAP IS PUBLISHED AS A SUPPLEMENTAL  
DOCUMENTATION OF LIQUID FUELS TAX FUND MILEAGES  
REVISED PER FORM 990 DATED 8-12-21

