

TOTAL MILES	
Township Road System	11.00 *
State Highway System	11.13
Total	22.13

* Includes ACT 32 Turnback Mileage of .34

LEGEND

- LIMITED ACCESS HIGHWAY
- STATE ROUTE AND NUMBER
- STATE MAINTAINED BRIDGE ON TOWNSHIP ROAD
- TOWNSHIP ROAD, NUMBER AND SEGMENT LENGTH IN MILES
- IMPASSABLE TOWNSHIP ROAD
- TURNBACK TOWNSHIP ROAD
- OTHER ROAD
- RAILROAD (IN SERVICE)
- RAILROAD ABANDONED (TRACK RETAINED)
- STATE BOUNDARY
- COUNTY BOUNDARY
- TOWNSHIP BOUNDARY
- CITY OR BOROUGH BOUNDARY
- MUNICIPAL BUILDING
- SPLIT MILEAGE BETWEEN MUNICIPALITIES

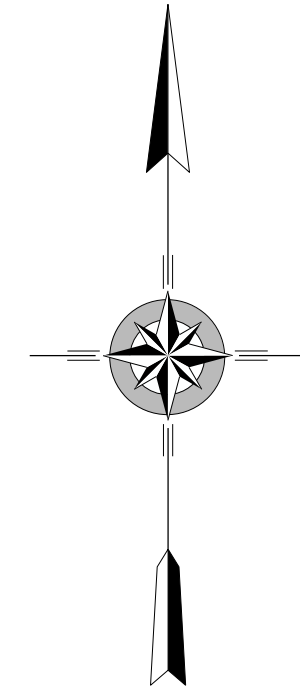
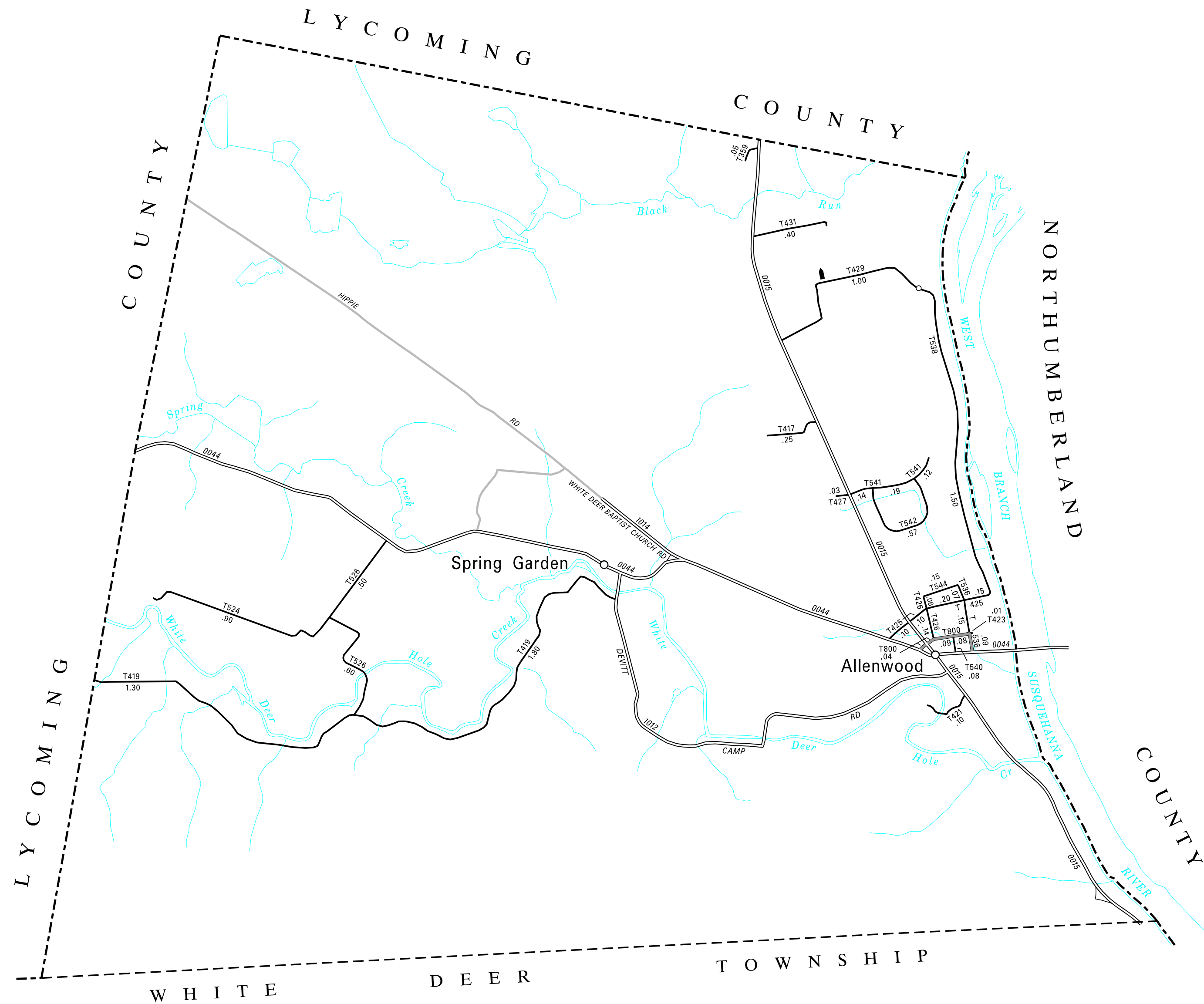

**GREGG
SECOND CLASS TOWNSHIP MAP
UNION COUNTY**

PREPARED BY THE
PENNSYLVANIA DEPARTMENT OF TRANSPORTATION
BUREAU OF PLANNING AND RESEARCH
GEOGRAPHIC INFORMATION DIVISION
IN COOPERATION WITH THE
U.S. DEPARTMENT OF TRANSPORTATION
FEDERAL HIGHWAY ADMINISTRATION
MUNICIPAL CODE 59 203

REVISED PER FORM 990 DATED 6-22-17

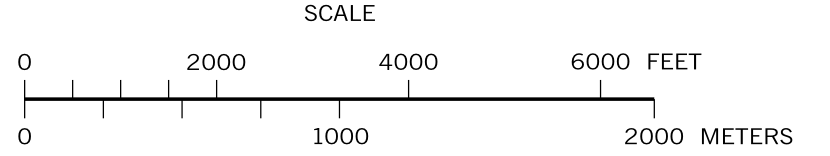

- 359 BRYSON RD
- 417 POPLAR AV
- 419 SOUTH CREEK RD
- 421 OLD MILL RD
- 423 RAILROAD ST
- 425 COLUMBIA AV
- 426 CULBERTSON AV
- 427 BECK RD
- 429 RUSSELL RD
- 431 BARTLOW RD
- 524 MCCARTY RD
- 526 MASSER RD
- 536 FIRST ST
- 538 RIVER RD
- 540 SECOND ST
- 541 COMMERCE DR
- 542 ENTERPRISE BLVD
- 544 SLIFER ST
- 800 WHITE DEER AV