

| | |
|----------------------|--------|
| TOTAL MILES | |
| Township Road System | 37.37* |
| State Highway System | 24.90 |
| Total | 62.27 |

* Includes ACT 32 Turnback Mileage of 1.99

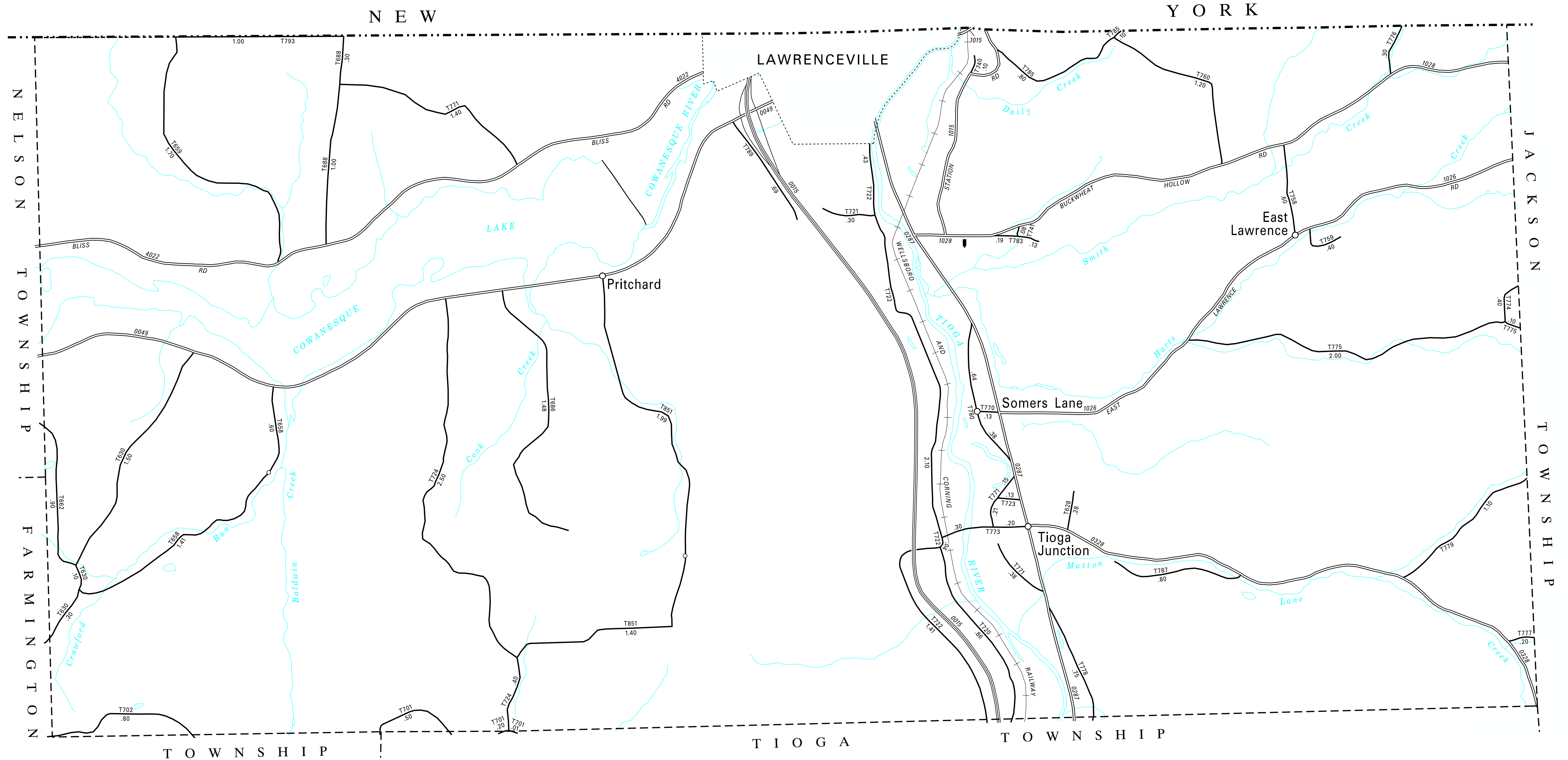

LEGEND

- LIMITED ACCESS HIGHWAY
 - STATE ROUTE AND NUMBER
 - STATE MAINTAINED BRIDGE ON TOWNSHIP ROAD
 - TOWNSHIP ROAD, NUMBER AND SEGMENT LENGTH IN MILES
 - IMPASSABLE TOWNSHIP ROAD
 - OTHER ROAD
 - RAILROAD (IN SERVICE)
 - RAILROAD ABANDONED (TRACK RETAINED)
 - STATE BOUNDARY
 - COUNTY BOUNDARY
 - TOWNSHIP BOUNDARY
 - CITY OR BOROUGH BOUNDARY
 - MUNICIPAL BUILDING
 - SPLIT MILEAGE BETWEEN MUNICIPALITIES
- | |
|-------------------------|
| 628 HILLSIDE TERRACE RD |
| 630 CROFT HILL RD |
| 658 GEE HOLLOW RD |
| 659 HEFFNER HOLLOW RD |
| 662 BAILEY HILL RD |
| 686 ERICKSON RD |
| 688 BUTTON HILL RD |
| 701 BEAR CREEK RD |
| 702 COLEGROVE RD |
| 720 CUMMING RD |
| 721 BEERS RD |
| 722 TIOGA RIVER RD |
| 723 FOSTER RD |
| 724 BIRCH HILL RD |
| 740 STATION RD |
| 741 PUTNAMS RD |
| 758 CROSS RD |
| 759 SHOEMAKER HILL RD |
| 760 DOUD RD |
| 770 EAST LAWRENCE RD |
| 771 HEATER HILL RD |
| 773 JUNCTION CROSS RD |
| 774 WOODFORD RD |
| 775 COLLUM RD |
| 776 HACKETT RD |
| 777 LYMAN STONE RD |
| 778 BRADSHAW RD |
| 779 BURROWS HOLLOW RD |
| 780 TREMAINE RD |
| 781 SCHOOL RD |
| 783 COOK RD |
| 785 DEPOT HILL RD |
| 787 WHEELER RD |
| 789 WATER TOWER RD |
| 793 STATE LINE RD |
| 851 BOOM STATION RD |

LAWRENCE
SECOND CLASS TOWNSHIP MAP
 TIOGA COUNTY

PREPARED BY THE
 PENNSYLVANIA DEPARTMENT OF TRANSPORTATION
 BUREAU OF PLANNING AND RESEARCH
 GEOGRAPHIC INFORMATION DIVISION

IN COOPERATION WITH THE
 U.S. DEPARTMENT OF TRANSPORTATION
 FEDERAL HIGHWAY ADMINISTRATION

MUNICIPAL CODE 58 216

REVISED PER FORM 990 DATED 6-16-16

SCALE

0 2000 4000 6000 FEET
 0 1000 2000 METERS

TYPE 5 MAP LAWRENCE TOWNSHIP TIOGA COUNTY PENNSYLVANIA