

TOTAL MILES	
Township Road System	55.09*
State Highway System	36.86
Total	91.95

* Includes ACT 32 Turnback Mileage of 3.61

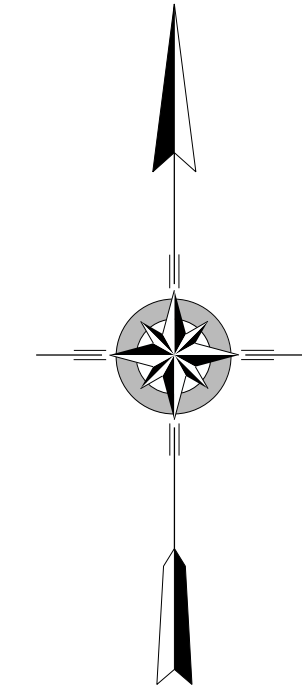

JACKSON SECOND CLASS TOWNSHIP MAP TIOGA COUNTY

PREPARED BY THE
PENNSYLVANIA DEPARTMENT OF TRANSPORTATION

BUREAU OF PLANNING AND RESEARCH
GEOGRAPHIC INFORMATION DIVISION

IN COOPERATION WITH THE
U.S. DEPARTMENT OF TRANSPORTATION
FEDERAL HIGHWAY ADMINISTRATION

MUNICIPAL CODE 58 215

REVISED PER FORM 990 DATED 8-14-17

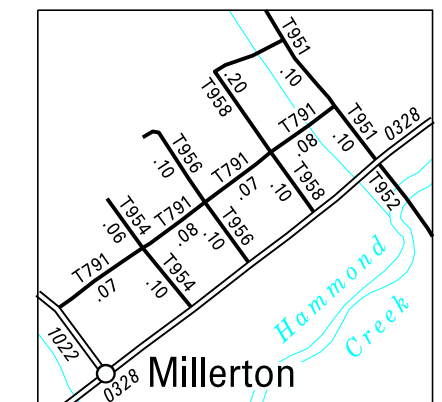
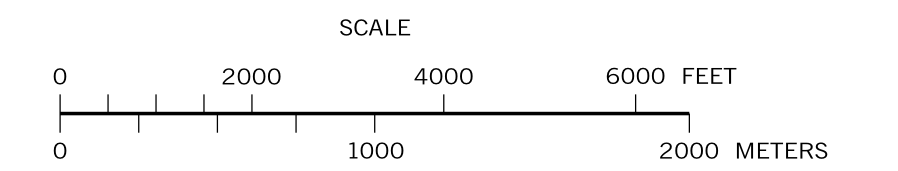

2:1

LEGEND

- LIMITED ACCESS HIGHWAY
- STATE ROUTE AND NUMBER
- STATE MAINTAINED BRIDGE ON TOWNSHIP ROAD
- TOWNSHIP ROAD, NUMBER AND SEGMENT LENGTH IN MILES
- IMPASSABLE TOWNSHIP ROAD
- TURNBACK TOWNSHIP ROAD
- OTHER ROAD
- RAILROAD (IN SERVICE)
- RAILROAD ABANDONED (TRACK RETAINED)
- STATE BOUNDARY
- COUNTY BOUNDARY
- TOWNSHIP BOUNDARY
- CITY OR BOROUGH BOUNDARY
- MUNICIPAL BUILDING
- SPLIT MILEAGE BETWEEN MUNICIPALITIES

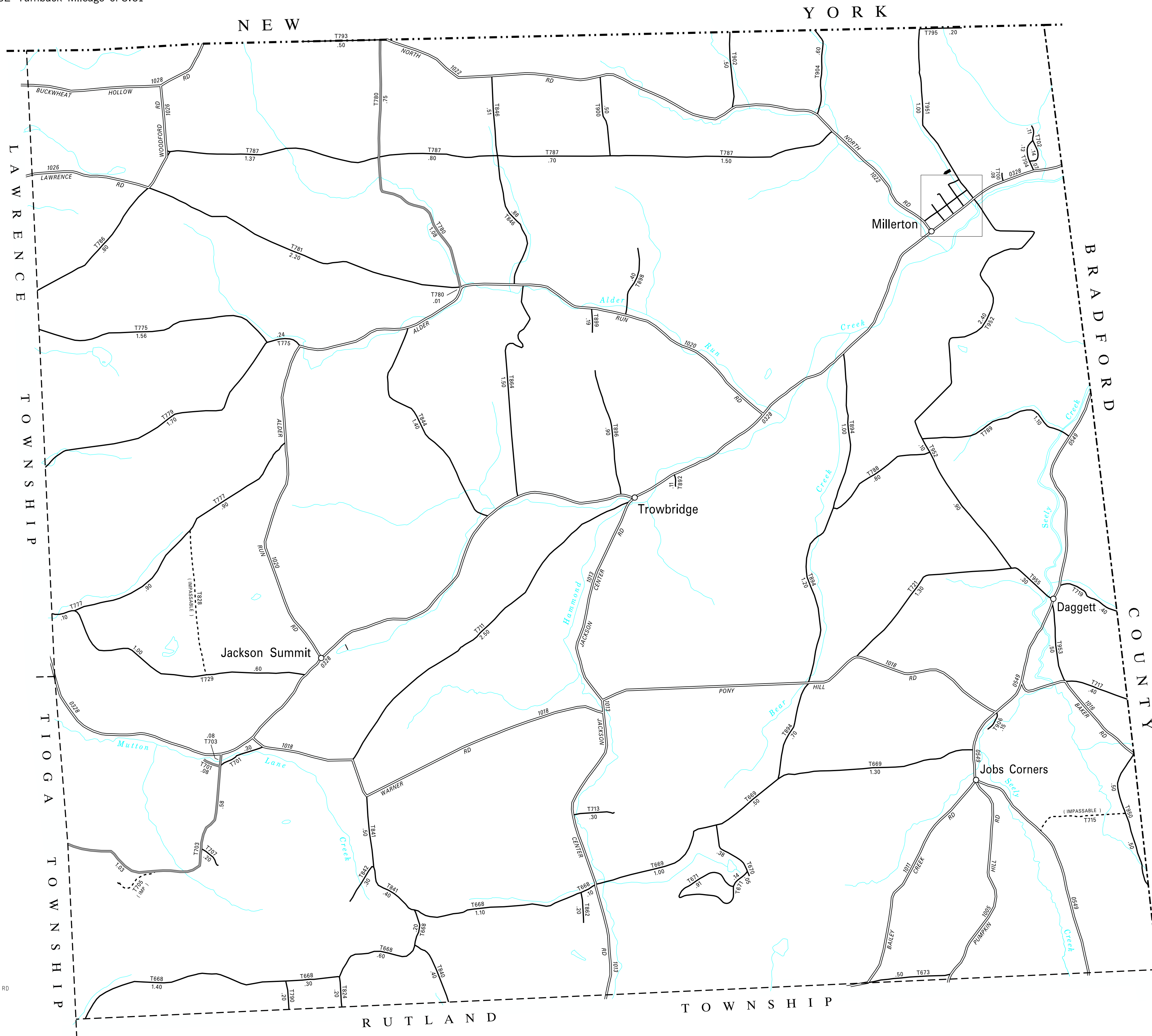

- 668 TOWER HILL RD
- 669 LAKE RD
- 670 BUCK LAKE RD
- 671 BUCK LAKE RD
- 673 PUMPKIN HILL RD
- 700 WISTERIA WY
- 701 MUTTON CREEK RD
- 702 PINE HILL DR
- 703 BUTTON HILL RD
- 704 DRAPERS CIR
- 707 INSCHO CIR
- 711 MIDDLE RD
- 713 EVERITT RD
- 717 HILL RD
- 719 GARRISON RD
- 721 RUNKSEY RD
- 729 WALES RD
- 775 COLLUM RD
- 777 LYMAN STONE RD
- 779 BURROWS HOLLOW RD
- 780 FISHER RD
- 781 EAST LAWRENCE RD
- 786 WOODFORD RD
- 787 SKYLINE DR
- 788 PARMETER RD
- 789 EIGHNEY RD
- 790 PAINTER RUN RD
- 791 BACK ST
- 793 STATELINE RD
- 795 STROCK RD
- 824 HARDCRABBLE RD
- 840 WEST BRANCH RD
- 841 MAPLE RIDGE RD
- 842 SPENCER RD
- 844 HUDSON HILL RD
- 846 PICNIC GROVE RD
- 862 HURD RD
- 864 WHITE RD
- 892 TOWNSHIP DR
- 894 BEAR CREEK RD
- 896 TROWBRIDGE STATION RD
- 898 COOK RD
- 899 PEBBL RD
- 900 SEELYE RD
- 902 WIDGER HILL RD
- 904 MILLER RD
- 906 OLD STATE RD
- 950 JENNINGS RD
- 951 BLY RD
- 952 SWITCHBACK RD
- 953 BAKER RD
- 954 FIRST ST
- 955 CHURCH ST
- 956 SECOND ST
- 958 THIRD ST