

TOTAL MILES

Township Road System	56.35*
State Highway System	37.55
Total	93.90

* Includes ACT 32 Turnback Mileage of 13.19

POPULATION 1,254
(2020 Census)

LEGEND

- LIMITED ACCESS HIGHWAY
- STATE ROUTE AND NUMBER
- STATE MAINTAINED BRIDGE ON TOWNSHIP ROAD
- TOWNSHIP ROAD, NUMBER AND SEGMENT LENGTH IN MILES
- IMPASSABLE TOWNSHIP ROAD
- TURNBACK TOWNSHIP ROAD
- OTHER ROAD
- RAILROAD (IN SERVICE)
- RAILROAD ABANDONED (TRACK RETAINED)
- STATE BOUNDARY
- COUNTY BOUNDARY
- TOWNSHIP BOUNDARY
- CITY OR BOROUGH BOUNDARY
- MUNICIPAL BUILDING
- SPLIT MILEAGE BETWEEN MUNICIPALITIES

- 420 SCHOOL ST
- 430 RUSSELL RD
- 432 BARTHOLOMEW RD
- 448 SOUTH HARMONY RD
- 449 STOCKINGER RD
- 450 NORTH HARMONY RD
- 463 TRIPP RD
- 471 WILKINS RD
- 473 APPLEMAN RIDGE RD
- 475 WOLF LAKE RD
- 476 NINE PARTNERS RD
- 477 STILL HILL RD
- 479 TYLER LAKE RD
- 480 MILLER RD
- 482 STEARNS RD
- 483 ED ALLEN RD
- 485 SHERWOOD HILL RD
- 486 MARKET ST
- 487 WHITE RD
- 489 WILCOX RD
- 490 RICHARDSON RD
- 546 UPPER PODUNK RD
- 548 PODUNK RD
- 552 HOULIHAN RD
- 554 THREE LAKES RD
- 555 BEAVER MEADOW RD
- 556 OSBORNE RD
- 558 TYLER RD
- 560 OLIVER RD
- 562 BLANDING LAKE RD
- 563 UNKNOWN NAME RD
- 564 DEVILS ELBOW RD
- 565 SHOUP RD
- 567 BYPASS RD
- 568 ORPHANS SCHOOL RD
- 569 DEER TRAIL RD
- 570 CHARLES RD
- 571 GOFF RD
- 572 FOULTZ RD
- 573 MILL ST
- 574 GRINNELL RD
- 575 COBB RD
- 576 RESERVOIR LA
- 577 WESCOTT RD
- 578 TINGLEY RD
- 579 OAKLEY CROSSING RD
- 580 STEPHENS RD
- 581 PLANK RD
- 582 PENNAY HILL RD
- 583 LAUREL HILL RD
- 584 ADAMS ST
- 600 MONUMENT RD
- 601 TANNERY ST
- 602 PAYNE RD

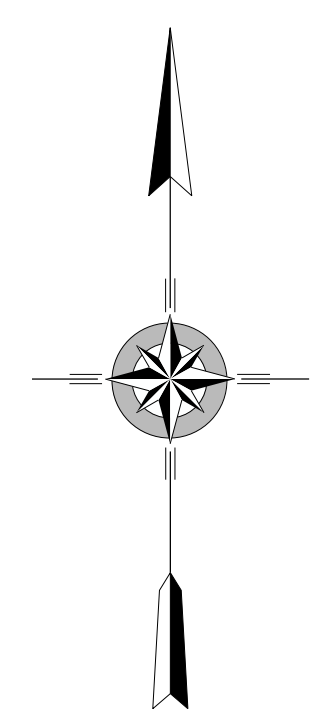
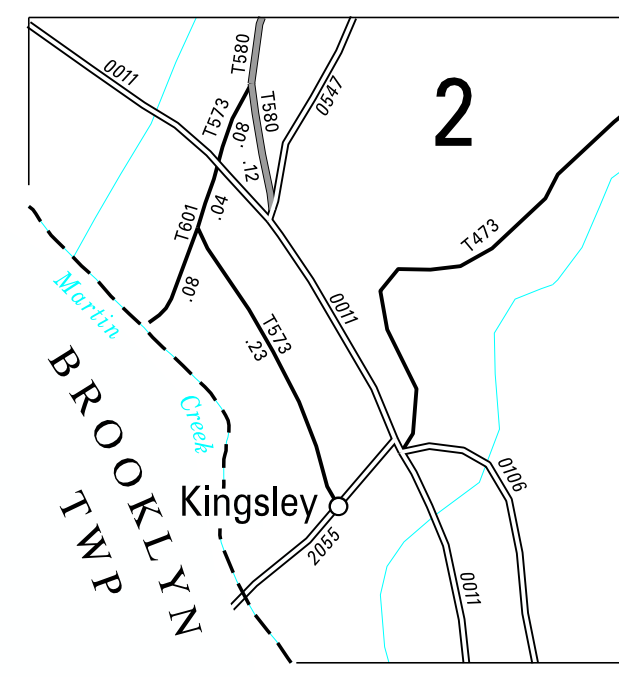
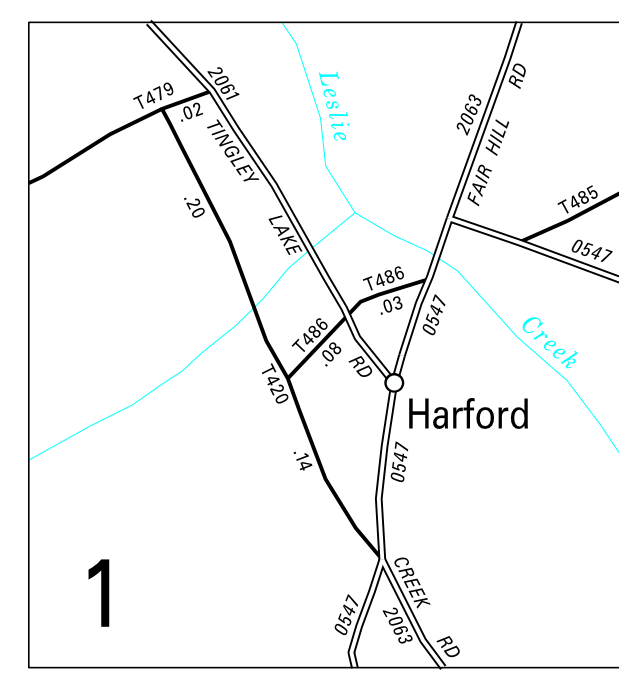
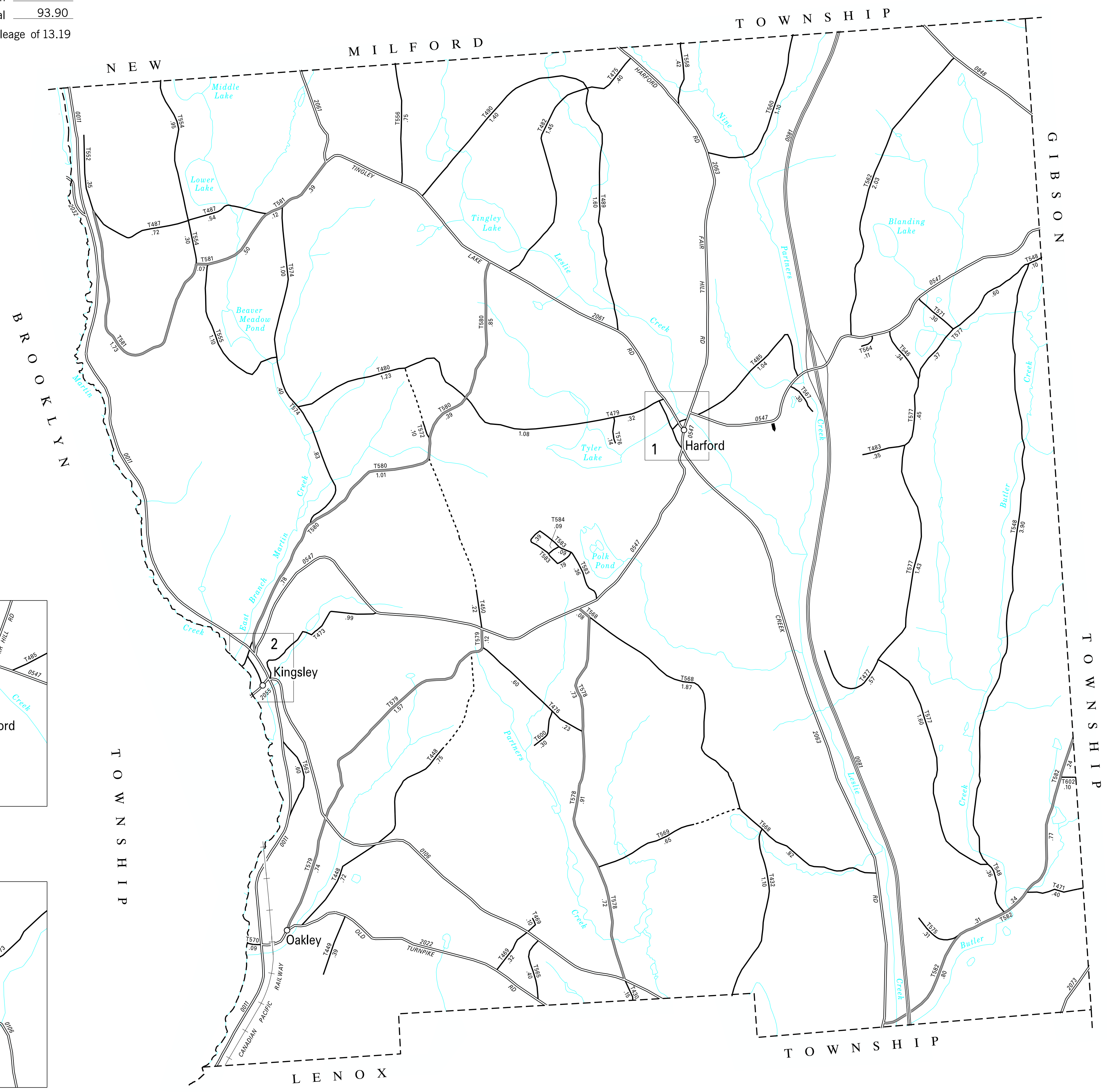

HARFORD
SECOND CLASS TOWNSHIP MAP
SUSQUEHANNA COUNTY

PREPARED BY THE
PENNSYLVANIA DEPARTMENT OF TRANSPORTATION
BUREAU OF PLANNING AND RESEARCH
GEOGRAPHIC INFORMATION DIVISION
IN COOPERATION WITH THE
U.S. DEPARTMENT OF TRANSPORTATION
FEDERAL HIGHWAY ADMINISTRATION
MUNICIPAL CODE 57 213

THIS MAP IS PUBLISHED AS A SUPPLEMENTAL
DOCUMENTATION OF LIQUID FUELS TAX FUND MILEAGES
REVISED PER FORM 990 DATED 6-28-23

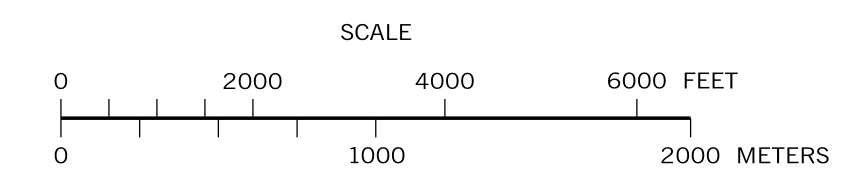

COPIES OF THIS MAP ARE AVAILABLE AT NOMINAL COST
CONTACT:
PENNSYLVANIA DEPARTMENT OF TRANSPORTATION
SALES STORE
P.O. BOX 3451
HARRISBURG, PENNSYLVANIA 17105-3451
TELEPHONE: (717)787-6746