

**LEGEND**

- LIMITED ACCESS HIGHWAY
- STATE ROUTE AND NUMBER
- STATE MAINTAINED BRIDGE ON TOWNSHIP ROAD
- TOWNSHIP ROAD, NUMBER AND SEGMENT LENGTH IN MILES
- IMPASSABLE TOWNSHIP ROAD
- OTHER ROAD
- RAILROAD (IN SERVICE)
- RAILROAD ABANDONED (TRACK RETAINED)
- STATE BOUNDARY
- COUNTY BOUNDARY
- TOWNSHIP BOUNDARY
- CITY OR BOROUGH BOUNDARY
- MUNICIPAL BUILDING
- SPLIT MILEAGE BETWEEN MUNICIPALITIES

TOTAL MILES	
Township Road System	53.05*
State Highway System	43.25
Total	96.30

\* Includes ACT 32 Turnback Mileage of 0.83

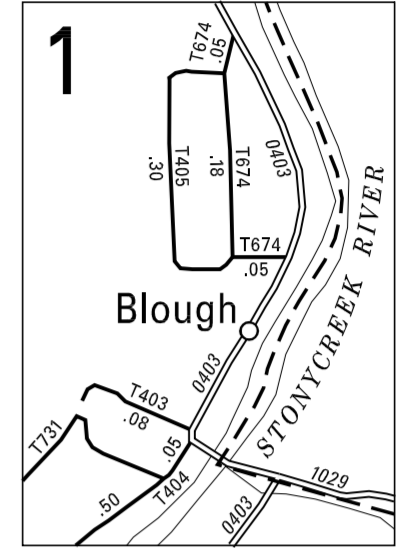

3:1

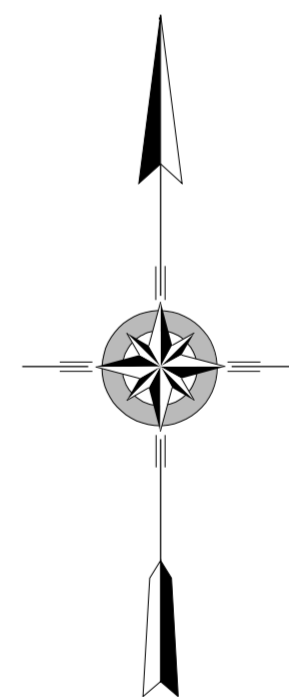
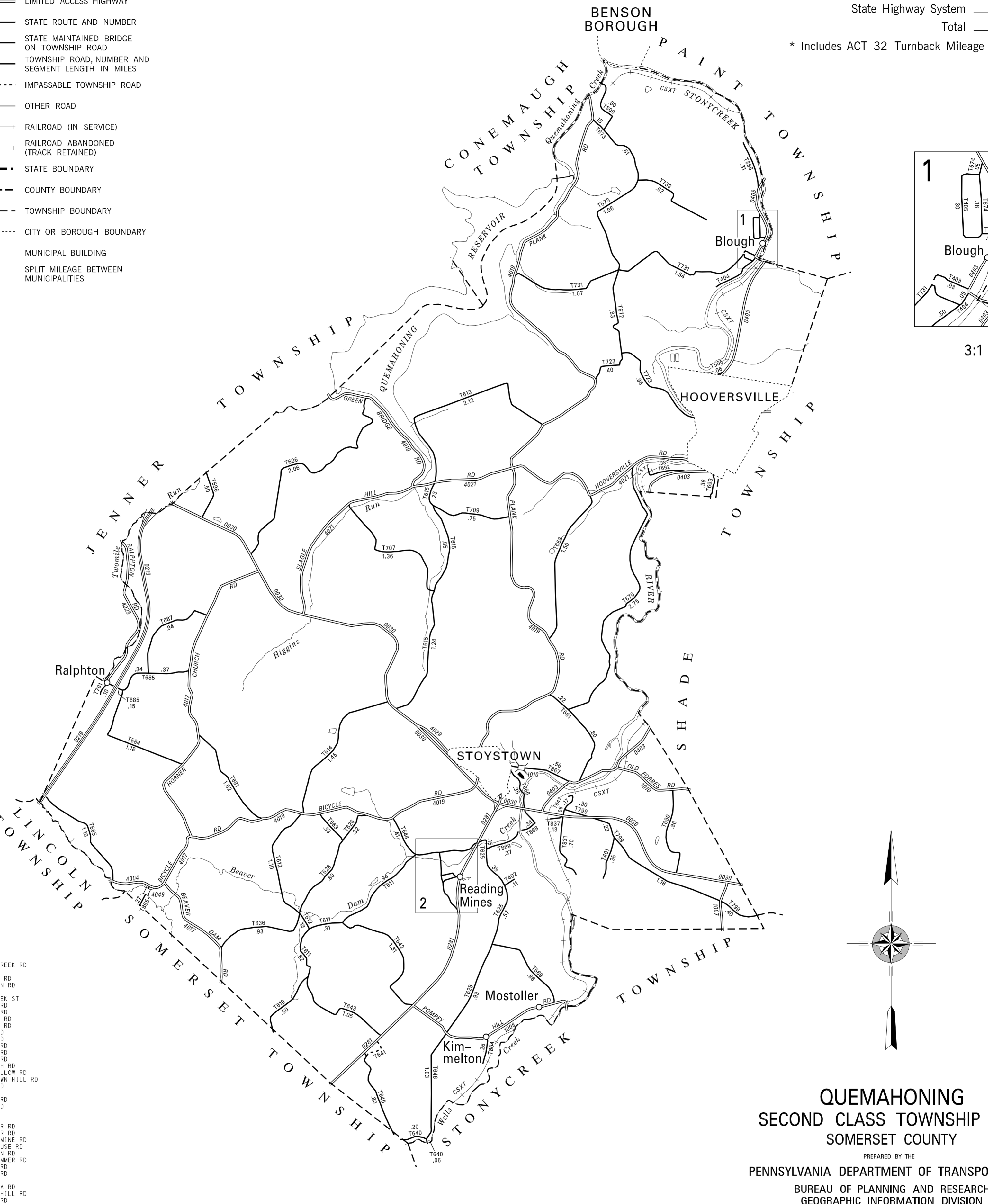

**QUEMAHONING  
SECOND CLASS TOWNSHIP MAP  
SOMERSET COUNTY**

PREPARED BY THE  
PENNSYLVANIA DEPARTMENT OF TRANSPORTATION  
BUREAU OF PLANNING AND RESEARCH  
GEOGRAPHIC INFORMATION DIVISION  
IN COOPERATION WITH THE  
U.S. DEPARTMENT OF TRANSPORTATION  
FEDERAL HIGHWAY ADMINISTRATION  
MUNICIPAL CODE 55 219

REVISED PER FORM 990 DATED 4-5-10



- 401 YELLOW CREEK RD
- 402 SHORT ST
- 403 ASHBROOK RD
- 404 SPORTSMAN RD
- 405 BACK ST
- 505 STONYCREEK ST
- 506 R UPPER RD
- 507 R LOWER RD
- 584 McVICKER RD
- 596 RANDOLPH RD
- 606 HAINES RD
- 610 TAYLOR RD
- 611 DUNMYER RD
- 612 GARDNER RD
- 613 BIRDMAN RD
- 614 GOLDSWITH RD
- 615 SKUNK HOLLOW RD
- 625 BROWNSTOWN HILL RD
- 626 TEDROW RD
- 636 DARK RD
- 640 REFFNER RD
- 642 WALKER RD
- 643 MARTS RD
- 644 LEASE RD
- 646 MOSTOLLER RD
- 647 STRASISER RD
- 648 READING MINE RD
- 661 SCHOOLHOUSE RD
- 663 ZIMMERMAN RD
- 665 MILOW KIMMER RD
- 666 LENHART RD
- 668 BASSETT RD
- 669 FRITZ RD
- 670 PONDEROSA RD
- 672 UPHOUSE HILL RD
- 673 JANIDLO RD
- 674 FRONT ST
- 681 GROVE RD
- 685 MILLER RD
- 687 HYASOTA FUEL RD
- 690 ROSENBAUM RD
- 692 NUMBER THREE RD
- 693 WEIGLE RD
- 701 TWO MILE RUN RD
- 707 ZIPPEL RD
- 709 HORNER RD
- 723 BLOOM RD
- 731 KOONITZ RD
- 733 NAUGLE RD
- 799 OLD LINCOLN HWY
- 800 ABEY RD
- 831 KENNEDY RD
- 837 TROSTLETOWN RD
- 864 KIMMELTON EXT
- 865 GEIGER RD
- 867 FORBES RD
- 868 NORTH CLUB RD
- 869 S CLUB RD
- 886 LAND ST

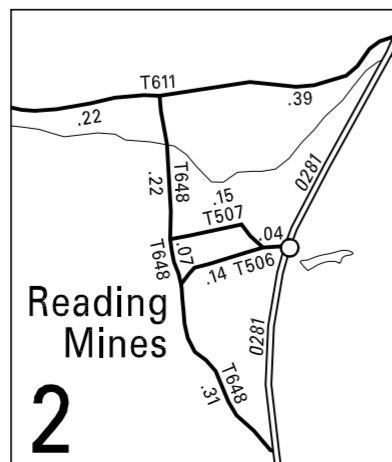

2:1