

**LEGEND**

- LIMITED ACCESS HIGHWAY
- STATE ROUTE AND NUMBER
- STATE MAINTAINED BRIDGE ON BOROUGH STREET
- BOROUGH STREET NAME AND SEGMENT LENGTH IN MILES
- TURNBACK BOROUGH STREET
- BOROUGH ALLEY
- OTHER ROAD
- RAILROAD
- STATE BOUNDARY
- COUNTY BOUNDARY
- TOWNSHIP BOUNDARY
- CITY BOUNDARY
- BOROUGH BOUNDARY
- MUNICIPAL BUILDING
- SPLIT MILEAGE BETWEEN MUNICIPALITIES
- SCHOOL, COLLEGE OR UNIVERSITY
- POINT OF INTEREST

POPULATION 2,281  
(2010 Census)

TOTAL MILES  
Borough Road System 9.05  
State Highway System 2.31  
Total 11.36

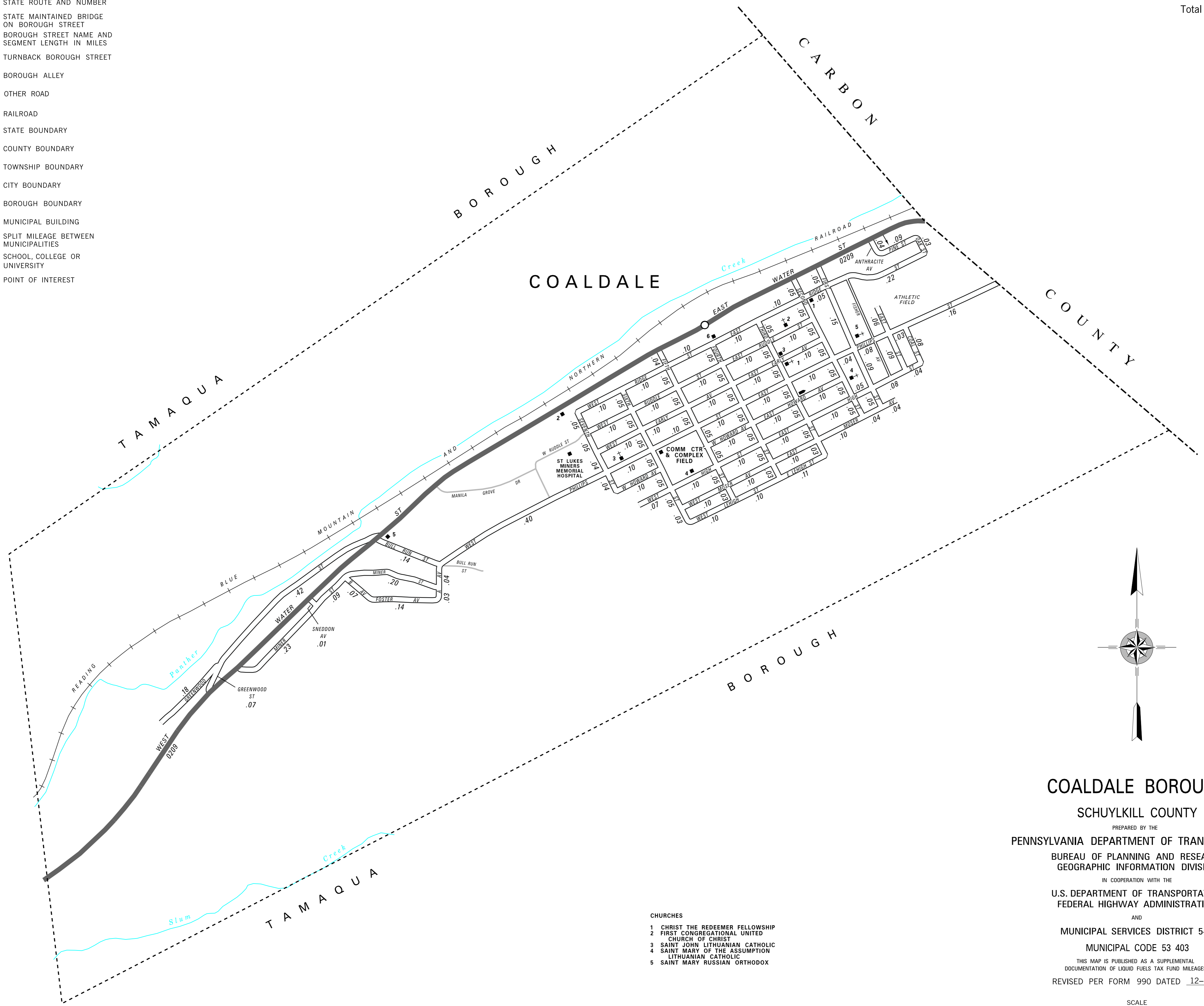

- A AV
- ANTHRACITE AV
- B AV
- BULL RUN ST
- COAL ST
- EARLY AV
- EAST ST
- FIFTH ST
- FIRST ST
- FOSTER AV
- FOURTH ST
- GREENWOOD ST
- HIGH ST
- HOWARD AV
- LEHIGH ST
- MINER ST
- MOSER AV
- OAK ST
- PHILLIPS ST
- PINE ST
- RIDGE ST
- RUDDLE ST
- SECOND ST
- SEVENTH ST
- SIXTH ST
- SNEDDON AV
- THIRD ST

COPIES OF THIS MAP ARE AVAILABLE AT NOMINAL COST  
CONTACT:  
PENNSYLVANIA DEPARTMENT OF TRANSPORTATION  
SALES STORE  
P.O. BOX 3451  
HARRISBURG, PENNSYLVANIA 17105-3451  
TELEPHONE: (717) 787-6746

- CHURCHES**
- 1 CHRIST THE REDEEMER FELLOWSHIP
  - 2 FIRST CONGREGATIONAL UNITED CHURCH OF CHRIST
  - 3 SAINT JOHN LITHUANIAN CATHOLIC
  - 4 SAINT MARY OF THE ASSUMPTION LITHUANIAN CATHOLIC
  - 5 SAINT MARY RUSSIAN ORTHODOX

- POINTS OF INTEREST**
- 1 AMERICAN LEGION POST 170
  - 2 COMMUNITY AMBULANCE
  - 3 POST OFFICE
  - 4 VOLUNTEER FIRE COMPANY #1
  - 5 VETERANS MEMORIAL
  - 6 VFW POST 6982

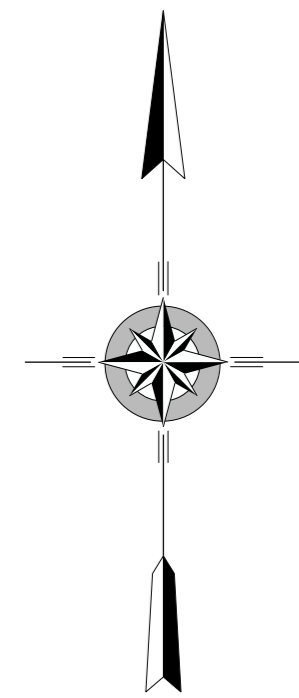

**COALDALE BOROUGH**  
SCHUYLKILL COUNTY

PREPARED BY THE  
PENNSYLVANIA DEPARTMENT OF TRANSPORTATION  
BUREAU OF PLANNING AND RESEARCH  
GEOGRAPHIC INFORMATION DIVISION  
IN COOPERATION WITH THE  
U.S. DEPARTMENT OF TRANSPORTATION  
FEDERAL HIGHWAY ADMINISTRATION  
AND

MUNICIPAL SERVICES DISTRICT 5-0  
MUNICIPAL CODE 53 403

THIS MAP IS PUBLISHED AS A SUPPLEMENTAL  
DOCUMENTATION OF LIQUID FUELS TAX FUND MILEAGES  
REVISED PER FORM 990 DATED 12-6-17

