

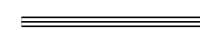

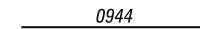

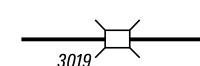

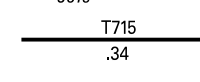

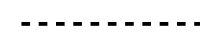

**LEGEND**

-  LIMITED ACCESS HIGHWAY
-  STATE ROUTE AND NUMBER
-  STATE MAINTAINED BRIDGE ON TOWNSHIP ROAD
-  TOWNSHIP ROAD, NUMBER AND SEGMENT LENGTH IN MILES
-  IMPASSABLE TOWNSHIP ROAD
-  TURNBACK TOWNSHIP ROAD
-  OTHER ROAD
-  RAILROAD (IN SERVICE)
-  RAILROAD ABANDONED (TRACK RETAINED)
-  STATE BOUNDARY
-  COUNTY BOUNDARY
-  TOWNSHIP BOUNDARY
-  CITY OR BOROUGH BOUNDARY
-  MUNICIPAL BUILDING
-  SPLIT MILEAGE BETWEEN MUNICIPALITIES

- 103 PIERSON ST
- 162 OLD ROUTE 209 RD
- 505 WALNUT ST
- 506 SANDERSON ST
- 508 CHERRY ST
- 509 LEHIGH ST
- 511 CHESTNUT ST
- 512 VALLEY ST
- 513 KENTUCKY AV
- 514 CLAY ST
- 515 PORTER ST
- 516 NEWBOLD ST
- 517 NO NAME
- 518 STRAWBERRY ST
- 519 WYOMING ST
- 520 SENECA ST
- 521 TIOGA ST
- 522 ORE ST
- 523 COAL ST
- 524 MULBERRY ST
- 525 CHESTNUT ST
- 526 LOCUST ST
- 527 CHURCH ST
- 528 NO NAME
- 529 MAIN ST
- 530 HILLTOP DR
- 531 SCHOOL ST
- 532 HOLLOW AV
- 533 SUNNY DR
- 534 LOCUST AV
- 535 MARCELLA RD
- 536 BACK ST
- 537 LAUREL AV
- 538 OAK LA
- 539 DODSON ST
- 542 EMERICK ST
- 543 UNION ST
- 544 MINE ST
- 545 FRANKLIN ST
- 546 GREEN ST
- 547 WASHINGTON ST
- 548 LEWIS ST
- 549 FIREHOUSE RD
- 550 FOREST LA
- 551 WOODLAND ST
- 552 TOBACK RD
- 772 CEMETERY RD
- 974 BROAD ST

TOTAL MILES	
Township Road System	13.29
State Highway System	8.79
Total	22.08

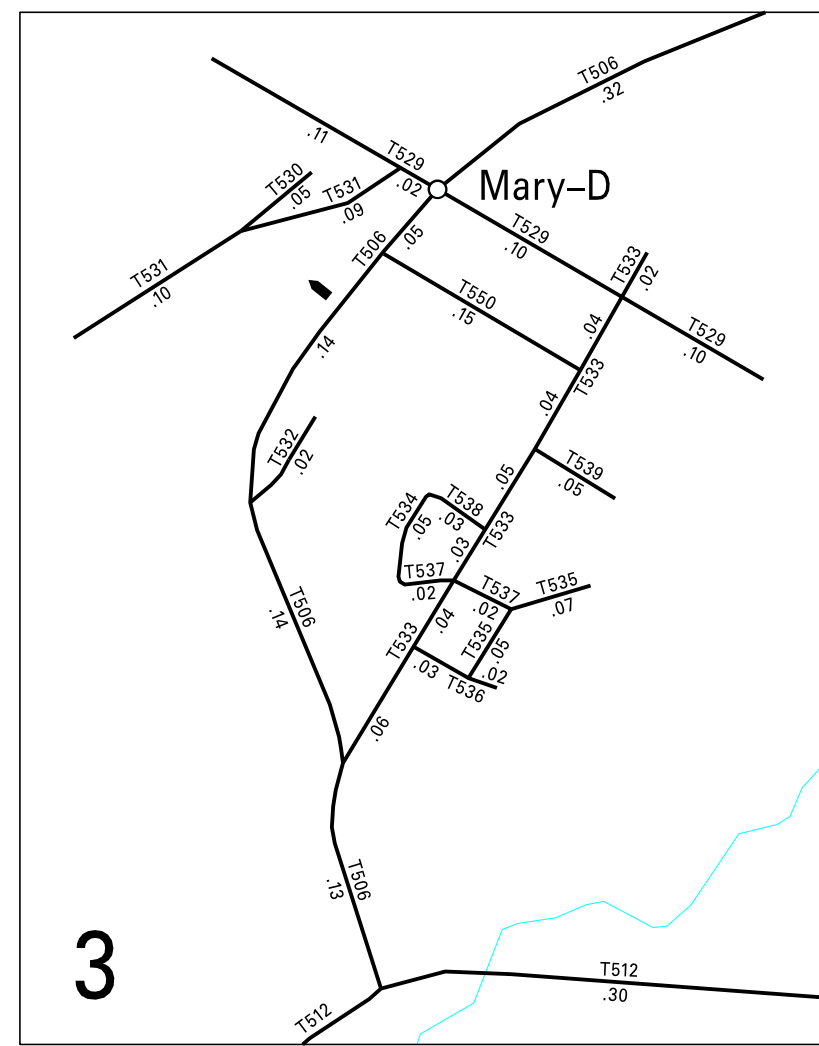

3  
4:1

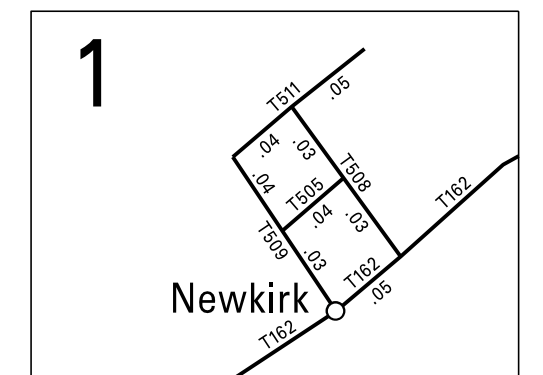

1  
4:1

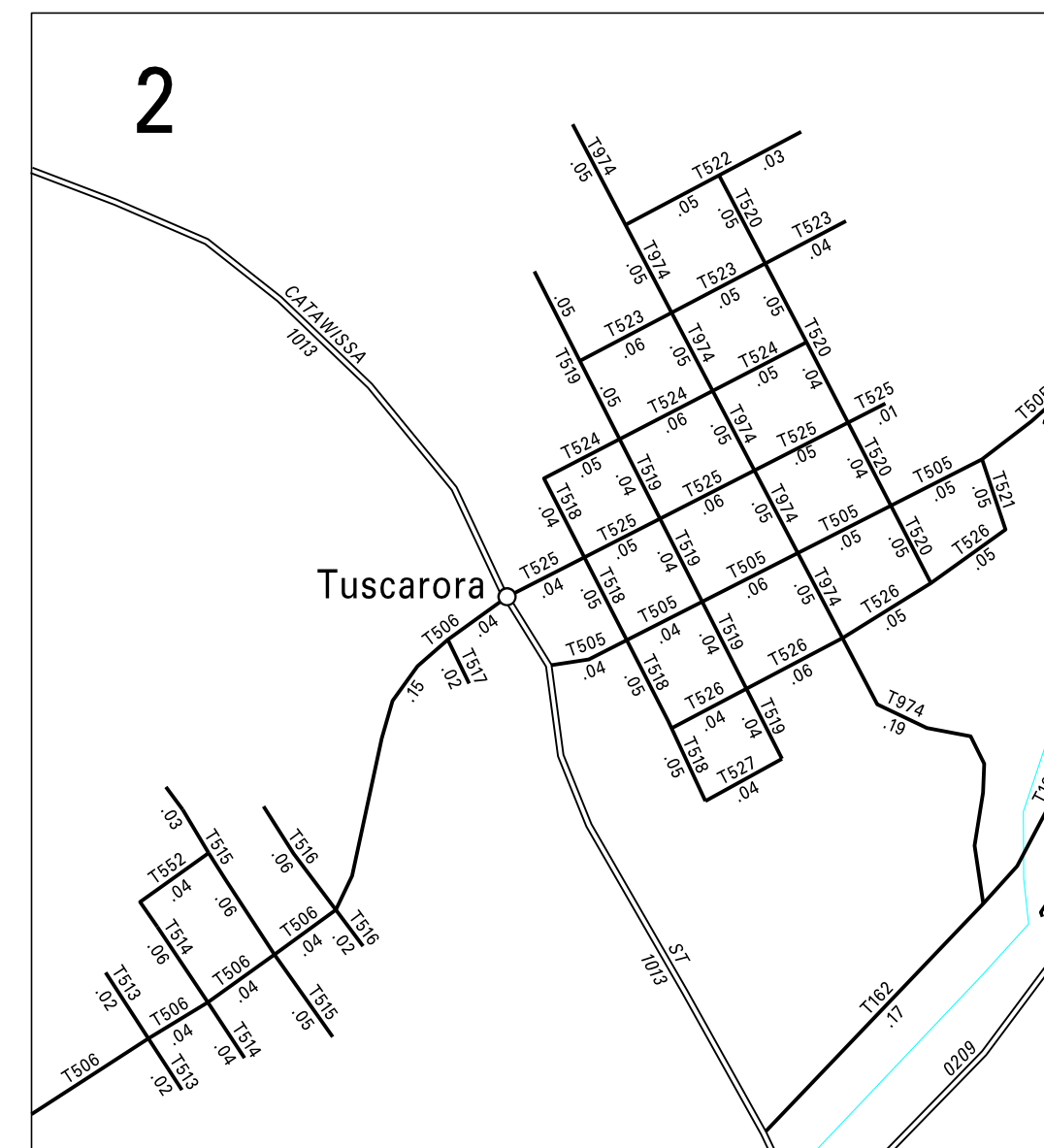

2  
4:1

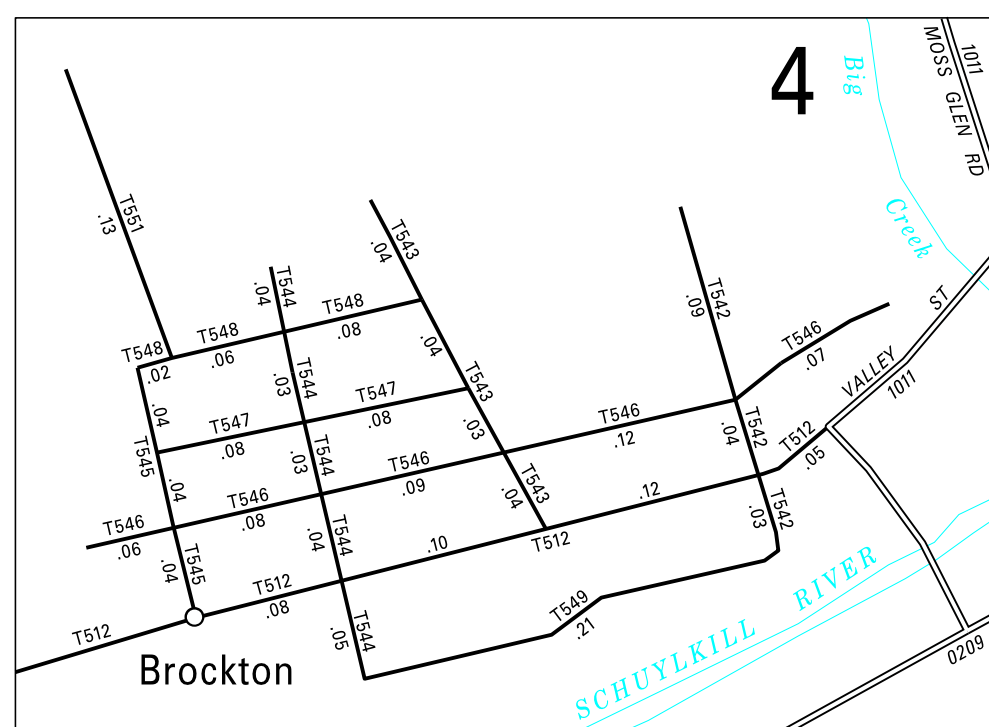

4  
4:1

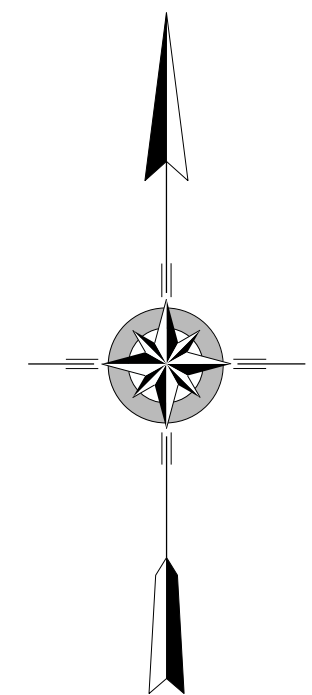
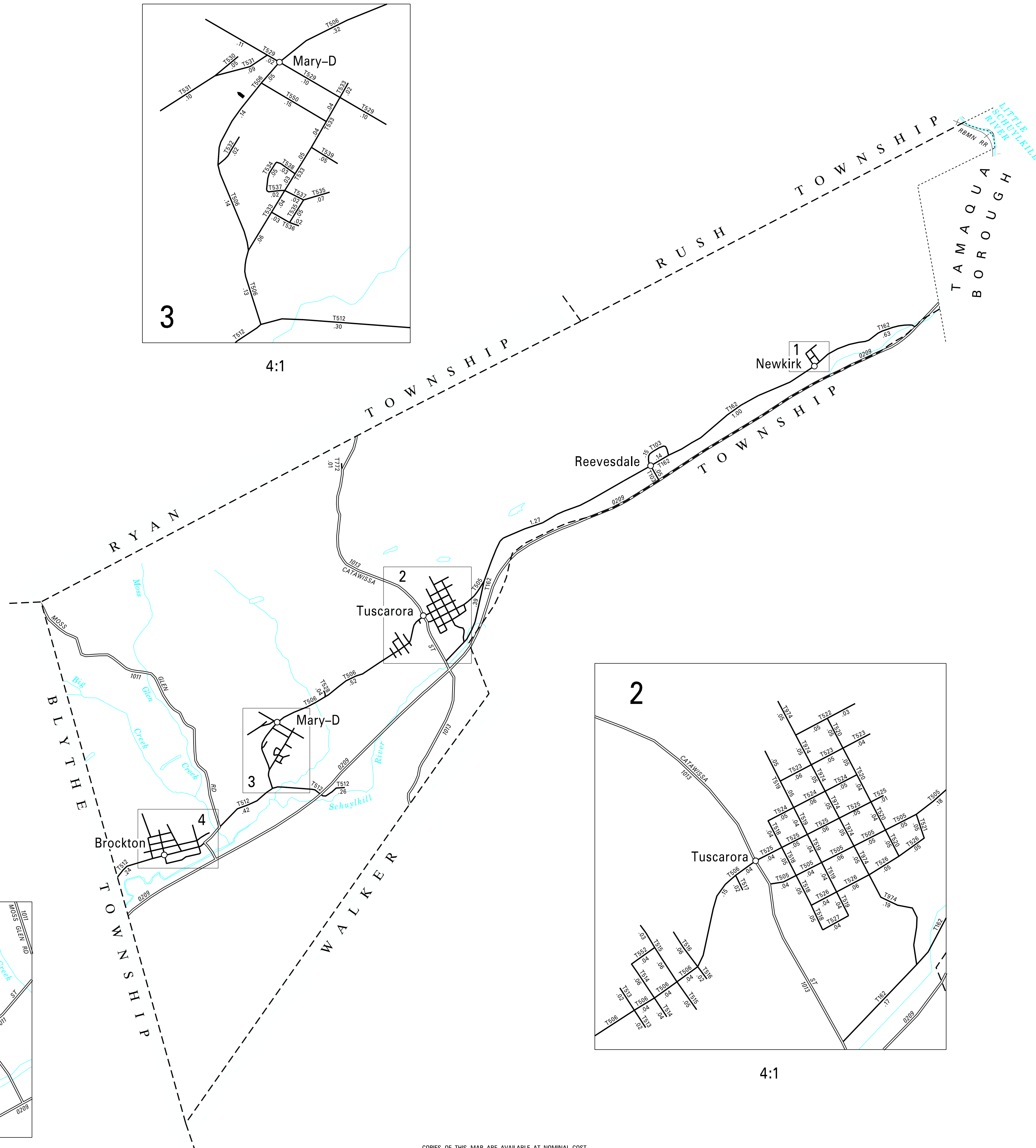

**SCHUYLKILL  
SECOND CLASS TOWNSHIP MAP  
SCHUYLKILL COUNTY**

PREPARED BY THE  
PENNSYLVANIA DEPARTMENT OF TRANSPORTATION  
BUREAU OF PLANNING AND RESEARCH  
GEOGRAPHIC INFORMATION DIVISION  
IN COOPERATION WITH THE  
U.S. DEPARTMENT OF TRANSPORTATION  
FEDERAL HIGHWAY ADMINISTRATION  
MUNICIPAL CODE 53 227  
THIS MAP IS PUBLISHED AS A SUPPLEMENTAL  
DOCUMENTATION OF LIQUID FUELS TAX FUND MILEAGES  
REVISED PER FORM 990 DATED 8-15-97

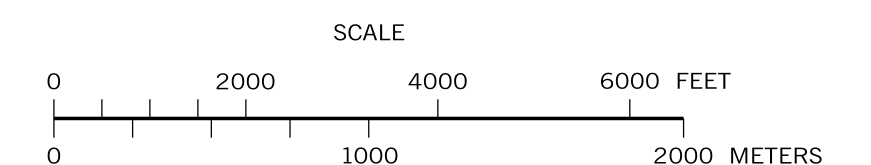

COPIES OF THIS MAP ARE AVAILABLE AT NOMINAL COST  
CONTACT:  
PENNSYLVANIA DEPARTMENT OF TRANSPORTATION  
SALES STORE  
P.O. BOX 3451  
HARRISBURG, PENNSYLVANIA 17105-3451  
TELEPHONE: (717)787-6746