

TOTAL MILES	
Township Road System	5.93
State Highway System	7.62
Total	13.55

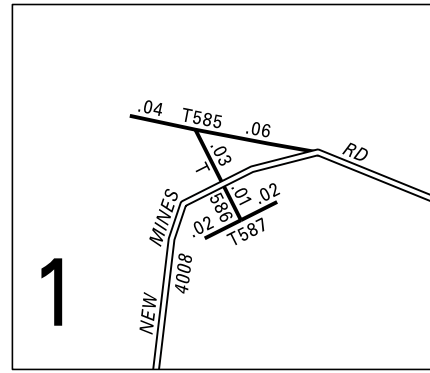

1
4:1

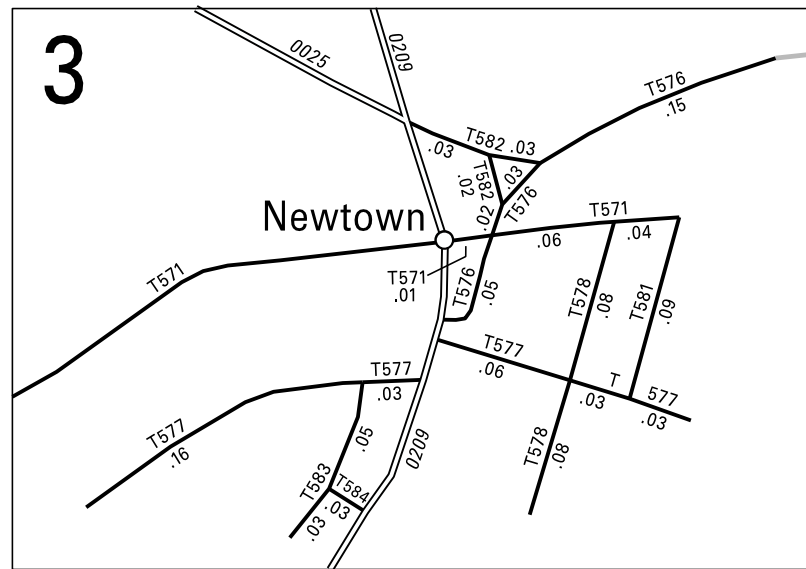

3
4:1

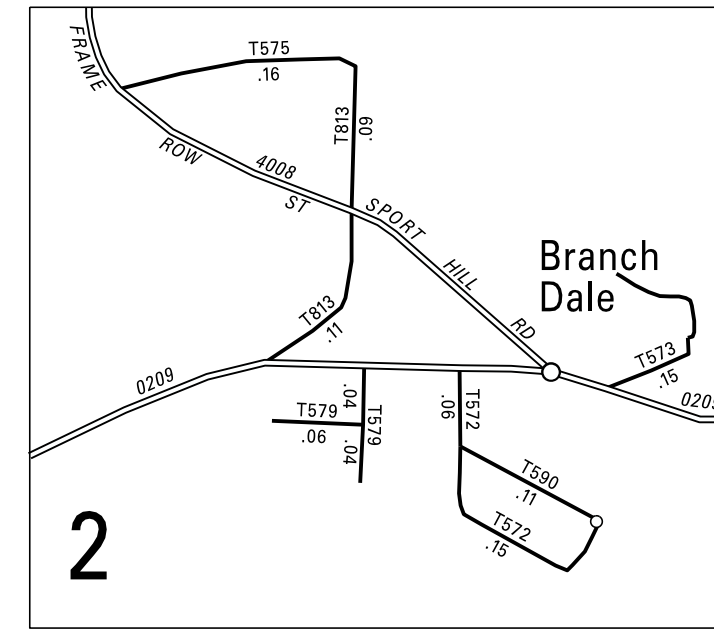

2
3:1

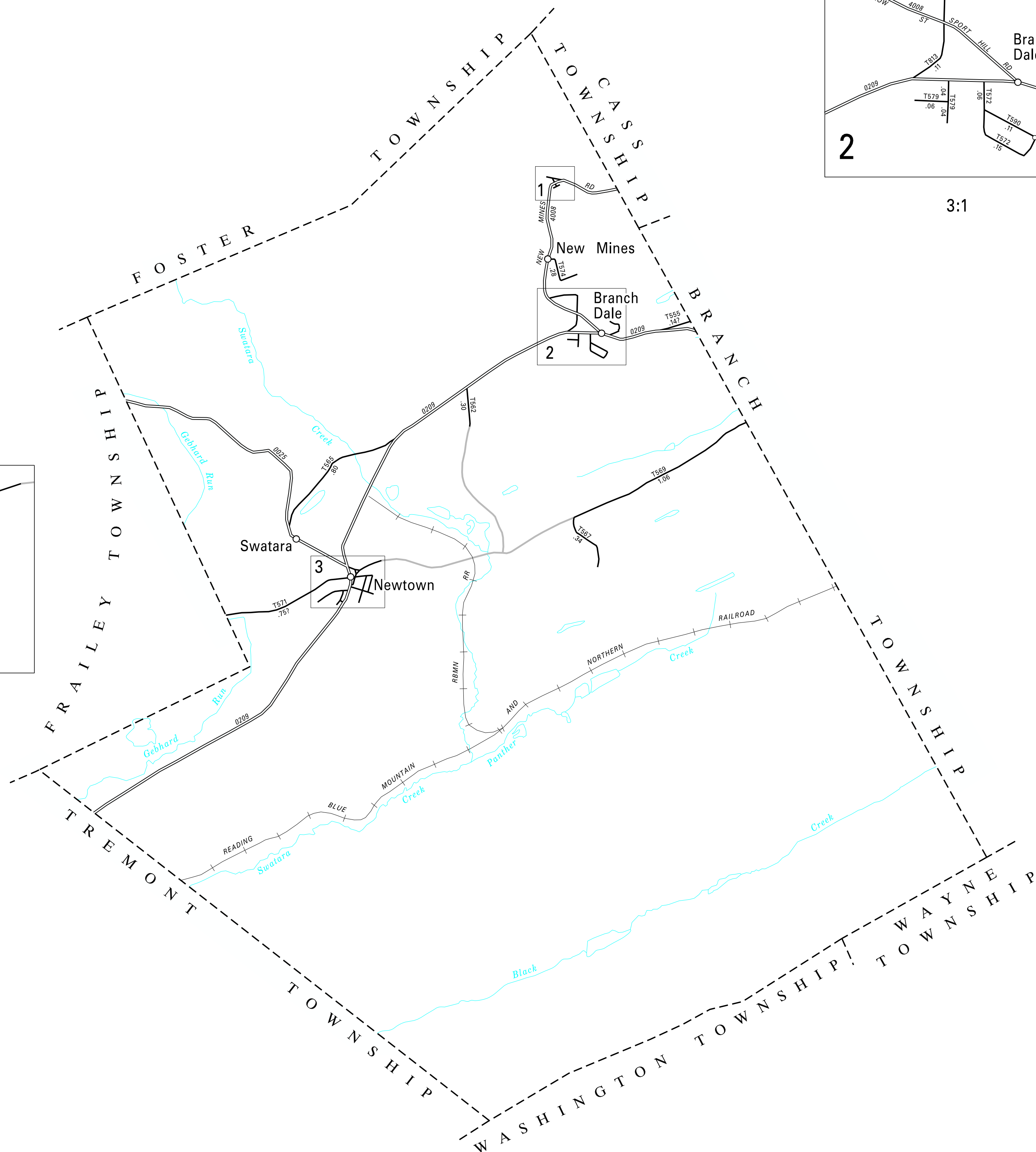

LEGEND

- LIMITED ACCESS HIGHWAY
- STATE ROUTE AND NUMBER
- STATE MAINTAINED BRIDGE ON TOWNSHIP ROAD
- TOWNSHIP ROAD, NUMBER AND SEGMENT LENGTH IN MILES
- IMPASSABLE TOWNSHIP ROAD
- TURNBACK TOWNSHIP ROAD
- OTHER ROAD
- RAILROAD (IN SERVICE)
- RAILROAD ABANDONED (TRACK RETAINED)
- STATE BOUNDARY
- COUNTY BOUNDARY
- TOWNSHIP BOUNDARY
- CITY OR BOROUGH BOUNDARY
- MUNICIPAL BUILDING
- SPLIT MILEAGE BETWEEN MUNICIPALITIES

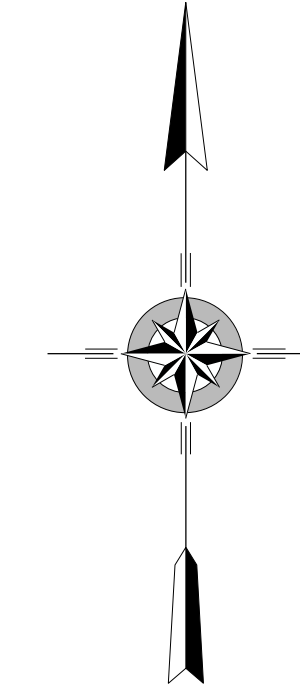

REILLY
SECOND CLASS TOWNSHIP MAP
SCHUYLKILL COUNTY

PREPARED BY THE
PENNSYLVANIA DEPARTMENT OF TRANSPORTATION
BUREAU OF PLANNING AND RESEARCH
GEOGRAPHIC INFORMATION DIVISION
IN COOPERATION WITH THE
U.S. DEPARTMENT OF TRANSPORTATION
FEDERAL HIGHWAY ADMINISTRATION
MUNICIPAL CODE 53 224
THIS MAP IS PUBLISHED AS A SUPPLEMENTAL
DOCUMENTATION OF LIQUID FUELS TAX FUND MILEAGES
REVISED PER FORM 990 DATED 12-15-16

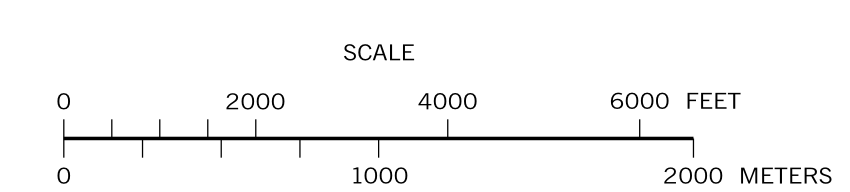

- 555 MILL ST
- 562 FLICKER RD
- 565 SWATARA RD
- 567 BLACKWOOD RD
- 569 BLACK DIAMOND RD
- 571 DONALDSON ST
- 572 SPRUCE ST
- 573 HILLCREST RD
- 574 NEW HILL RD
- 575 STONE ROW ST
- 576 CHURCH ST
- 577 MEADOW ST
- 578 WOOD ST
- 579 SAINT MARYS AV
- 581 STEIN AV
- 582 PINE ST
- 583 WILLOW AV
- 584 WILLOW ST
- 585 SCHOOL ROW
- 586 NO NAME
- 587 NO NAME
- 590 PINE ST
- 813 SPORT HILL ST

COPIES OF THIS MAP ARE AVAILABLE AT NOMINAL COST
CONTACT:
PENNSYLVANIA DEPARTMENT OF TRANSPORTATION
SALES STORE
P.O. BOX 3451
HARRISBURG, PENNSYLVANIA 17105-3451
TELEPHONE: (717)787-6746