

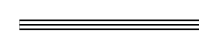

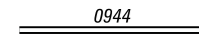

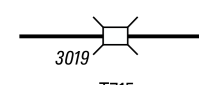

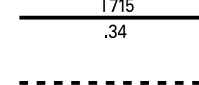

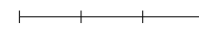
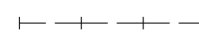

LEGEND

-  LIMITED ACCESS HIGHWAY
-  STATE ROUTE AND NUMBER
-  STATE MAINTAINED BRIDGE ON TOWNSHIP ROAD
-  TOWNSHIP ROAD, NUMBER AND SEGMENT LENGTH IN MILES
-  IMPASSABLE TOWNSHIP ROAD
-  TURNBACK TOWNSHIP ROAD
-  OTHER ROAD
-  RAILROAD (IN SERVICE)
-  RAILROAD ABANDONED (TRACK RETAINED)
-  STATE BOUNDARY
-  COUNTY BOUNDARY
-  TOWNSHIP BOUNDARY
-  CITY OR BOROUGH BOUNDARY
-  MUNICIPAL BUILDING
-  SPLIT MILEAGE BETWEEN MUNICIPALITIES

POPULATION 4,059
(2020 Census)

| | |
|----------------------|-------|
| TOTAL MILES | |
| Township Road System | 29.48 |
| State Highway System | 29.54 |
| Total | 59.02 |

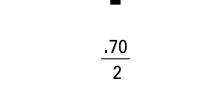
COPIES OF THIS MAP ARE AVAILABLE AT NOMINAL COST CONTACT:
PENNSYLVANIA DEPARTMENT OF TRANSPORTATION
SALES STORE
P.O. BOX 3451
HARRISBURG, PENNSYLVANIA 17105-3451
TELEPHONE: (717)787-6746

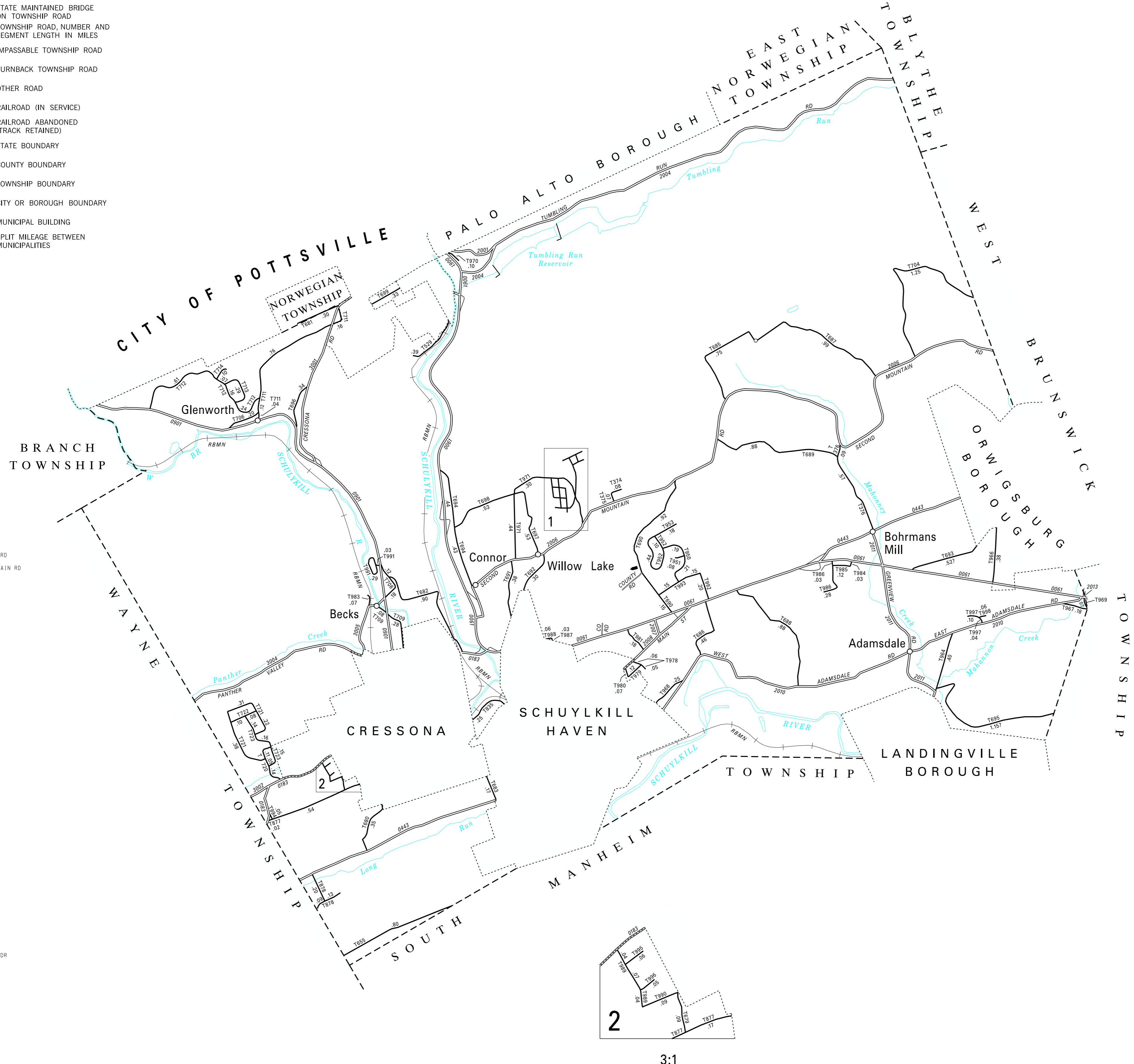

- 374 ROBYN RD
- 375 MARCIE RD
- 376 NORTH GREENVIEW RD
- 529 BAKERY RD
- 655 SCHUYLKILL MOUNTAIN RD
- 679 ASH ST
- 680 SHADY LANE RD
- 681 HILLSIDE RD
- 682 OLD MILL RD
- 683 GULDIN RD
- 685 DEER TRAIL DR
- 686 MEMORIAL DR
- 687 BERRY RD
- 688 BRIAR RD
- 689 HEMLOCK DR
- 690 MANHEIM RD
- 691 ARGO RD
- 692 GARFIELD AV
- 693 RIDGE RD
- 694 SEVEN STARS RD
- 695 GREEN TREE DR
- 696 SPCA RD
- 697 NORTH LAKE DR
- 698 NEAVERS RD
- 699 MAIN ST
- 702 VERNON AV
- 704 RANCH RD
- 705 PEGGY RD
- 706 GRACY RD
- 708 MENGLE ST
- 709 RIVER ST
- 711 GLENWORTH RD
- 712 RED HORSE RD
- 713 SAUER RD
- 714 JACKSON RD
- 720 CROSS CREEK DR
- 721 STONEY RUN RD
- 722 CENTERFIELD DR
- 723 FOX HOLLOW RD
- 835 RAILROAD ST
- 877 MORNINGSIDE DR
- 878 BENSINGER RD
- 879 JACKS LA
- 950 JACK AND JILL DR
- 951 QUASAR AV
- 952 KELSEY DR
- 953 OAK LEDGE AV
- 964 MEADOW DR
- 966 RARING DR
- 967 ANTIQUE LA
- 968 ALMOND ST
- 969 SOUTH LIBERTY ST
- 970 RICHARD ST
- 971 ALBERT BLVD
- 972 WILBERT DR
- 973 MARGARET TER
- 974 BETTY RD
- 975 CRESSWELL AV
- 976 GERALD AV
- 977 RONALD AV
- 978 RANDEL ST
- 979 HILLCREST AV
- 980 MOYER DR
- 981 EARL ST
- 982 HAVEN FAIR LAWN DR
- 983 GAME CLUB RD
- 984 PETE ANN ST
- 985 FIRST ST
- 986 CRESTVIEW DR
- 987 SPRING ST
- 988 FIDLER AV
- 989 ELMER AV
- 990 DONALD AV
- 991 WOODLAND DR
- 992 DOGWOOD DR
- 993 SUNNYSIDE DR
- 994 SUNNY LANE RD
- 995 DONNA CIR
- 996 FLORENCE CIR
- 997 MOUNTAIN VIEW DR
- 998 PINE VIEW DR

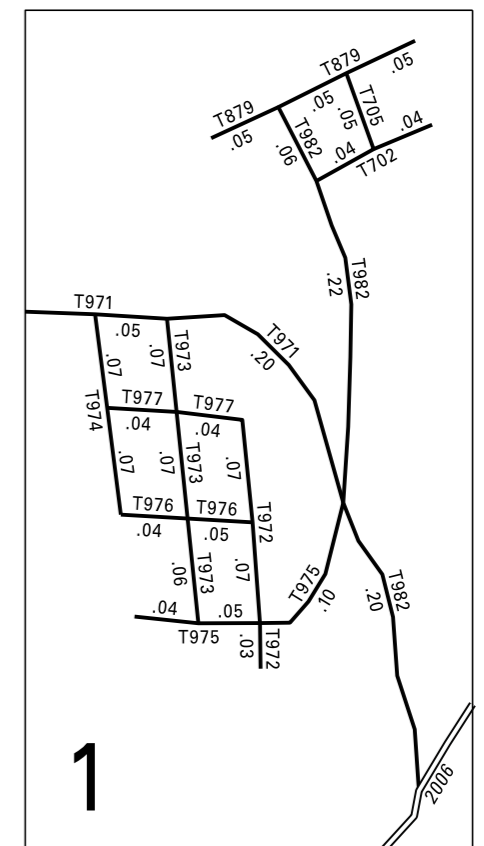

3:1

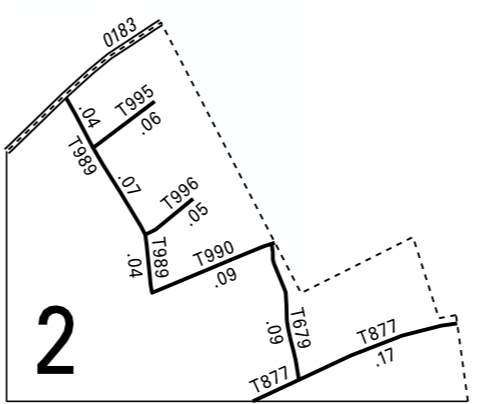

3:1

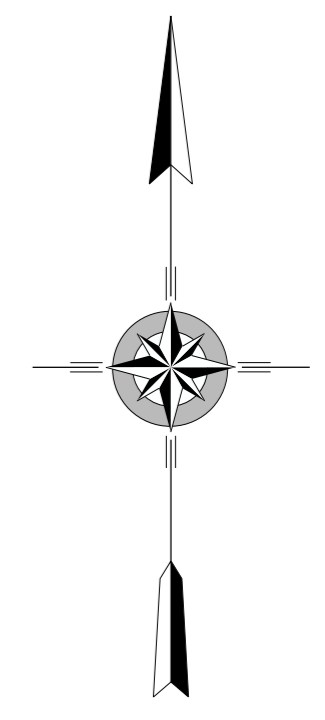

**NORTH MANHEIM
SECOND CLASS TOWNSHIP MAP
SCHUYLKILL COUNTY**

PREPARED BY THE
PENNSYLVANIA DEPARTMENT OF TRANSPORTATION
BUREAU OF PLANNING AND RESEARCH
GEOGRAPHIC INFORMATION DIVISION
IN COOPERATION WITH THE
U.S. DEPARTMENT OF TRANSPORTATION
FEDERAL HIGHWAY ADMINISTRATION
MUNICIPAL CODE 53 218
THIS MAP IS PUBLISHED AS A SUPPLEMENTAL
DOCUMENTATION OF LIQUID FUELS TAX FUND MILEAGES
REVISED PER FORM 990 DATED 12-12-13

