















TOTAL MILES	
Township Road System	61.14*
State Highway System	14.24
Total	75.38

* Includes ACT 32 Turnback Mileage of 5.69

LEGEND

-  LIMITED ACCESS HIGHWAY
-  STATE ROUTE AND NUMBER
-  STATE MAINTAINED BRIDGE ON TOWNSHIP ROAD
-  TOWNSHIP ROAD, NUMBER AND SEGMENT LENGTH IN MILES
-  IMPASSABLE TOWNSHIP ROAD
-  OTHER ROAD
-  RAILROAD (IN SERVICE)
-  RAILROAD ABANDONED (TRACK RETAINED)
-  STATE BOUNDARY
-  COUNTY BOUNDARY
-  TOWNSHIP BOUNDARY
-  CITY OR BOROUGH BOUNDARY
-  MUNICIPAL BUILDING
-  SPLIT MILEAGE BETWEEN MUNICIPALITIES

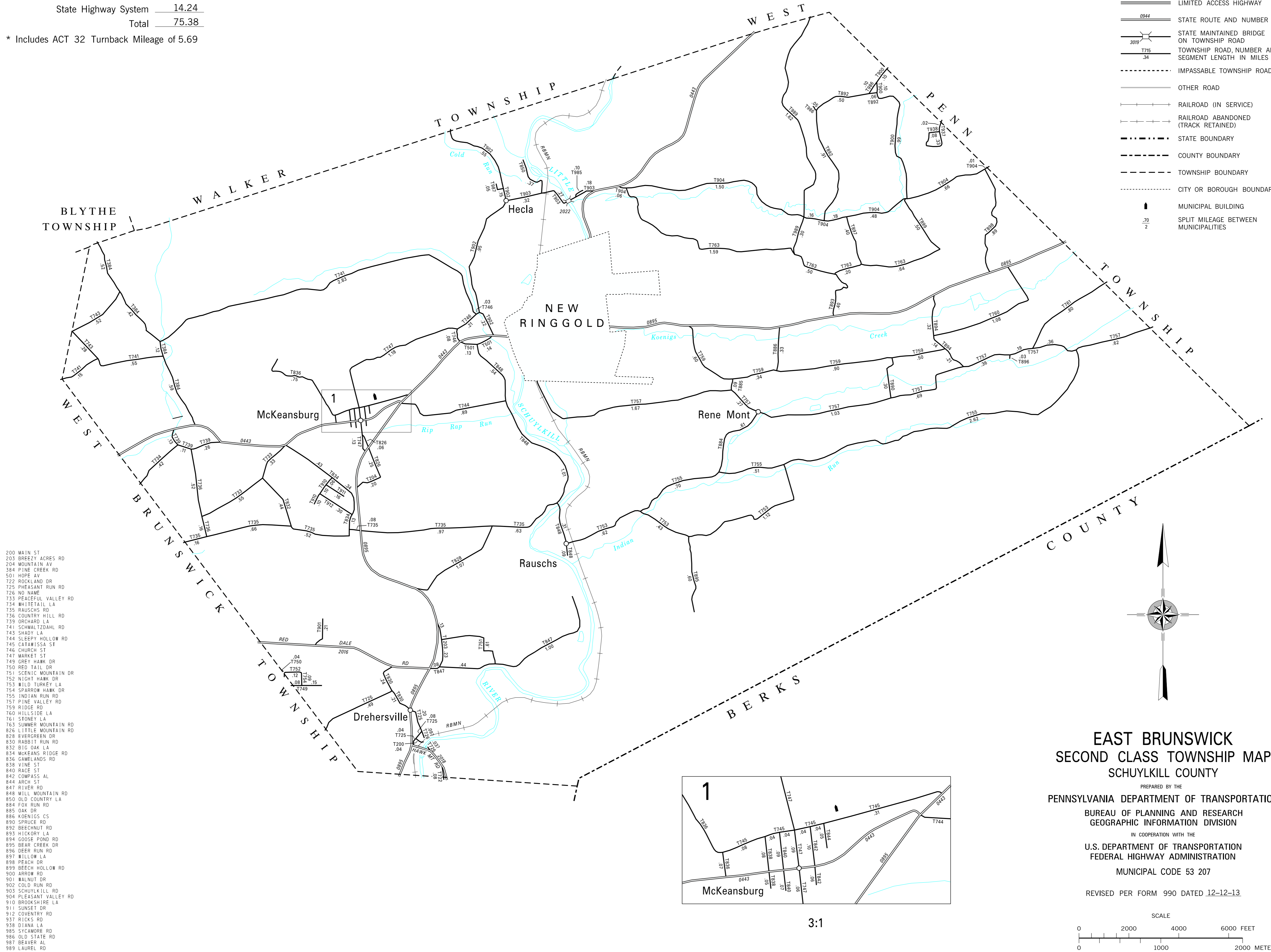

- 200 MAIN ST
- 203 BREEZY ACRES RD
- 204 MOUNTAIN AV
- 384 PINE CREEK RD
- 501 HOPE AV
- 722 ROCKLAND DR
- 725 PHEASANT RUN RD
- 726 NO NAME
- 733 PEACEFUL VALLEY RD
- 734 WHITETAIL LA
- 735 RAUSCHS RD
- 736 COUNTRY HILL RD
- 739 ORCHARD LA
- 741 SCHMALZDAHL RD
- 743 SHADY LA
- 744 SLEEPY HOLLOW RD
- 745 CATANISSA ST
- 746 CHURCH ST
- 747 MARKET ST
- 749 GREY HAWK DR
- 750 RED TAIL DR
- 751 SCENIC MOUNTAIN DR
- 752 NIGHT HAWK DR
- 753 WILD TURKEY LA
- 754 SPARROW HAWK DR
- 755 INDIAN RUN RD
- 757 PINE VALLEY RD
- 759 RIDGE RD
- 760 HILLSIDE LA
- 761 STONEY LA
- 763 SUMMER MOUNTAIN RD
- 826 LITTLE MOUNTAIN RD
- 828 EVERGREEN DR
- 830 RABBIT RUN RD
- 832 BIG OAK LA
- 834 MCKEANS RIDGE RD
- 836 GAMELANDS RD
- 838 VINE ST
- 840 RACE ST
- 842 COMPASS AL
- 844 ARCH ST
- 847 RIVER RD
- 848 MILL MOUNTAIN RD
- 850 OLD COUNTRY LA
- 854 FOX RUN RD
- 855 OAK DR
- 886 KOENIGS CS
- 890 SPRUCE RD
- 892 BEECHNUT RD
- 893 HICKORY LA
- 894 GOOSE POND RD
- 895 BEAR CREEK DR
- 896 DEER RUN RD
- 897 WILLOW LA
- 898 PEACH DR
- 899 BEECH HOLLOW RD
- 900 ARROW RD
- 901 WALNUT DR
- 902 COLD RUN DR
- 903 SCHUYLKILL RD
- 904 PLEASANT VALLEY RD
- 910 BROOKSHIRE LA
- 911 SUNSET DR
- 912 COVENTRY RD
- 937 RICKS RD
- 938 DIANA LA
- 985 SYCAMORE RD
- 986 OLD STATE RD
- 987 BEAVER AL
- 989 LAUREL RD

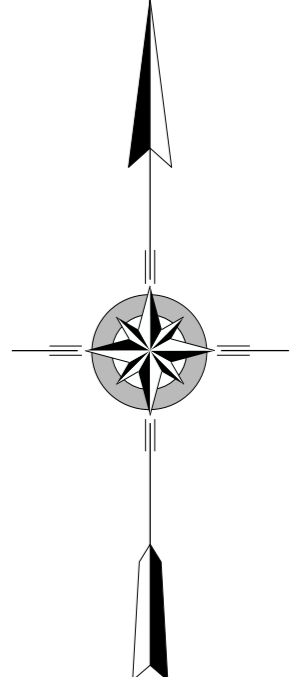

**EAST BRUNSWICK
SECOND CLASS TOWNSHIP MAP
SCHUYLKILL COUNTY**

PREPARED BY THE
PENNSYLVANIA DEPARTMENT OF TRANSPORTATION
BUREAU OF PLANNING AND RESEARCH
GEOGRAPHIC INFORMATION DIVISION
IN COOPERATION WITH THE
U.S. DEPARTMENT OF TRANSPORTATION
FEDERAL HIGHWAY ADMINISTRATION
MUNICIPAL CODE 53 207

REVISED PER FORM 990 DATED 12-12-13

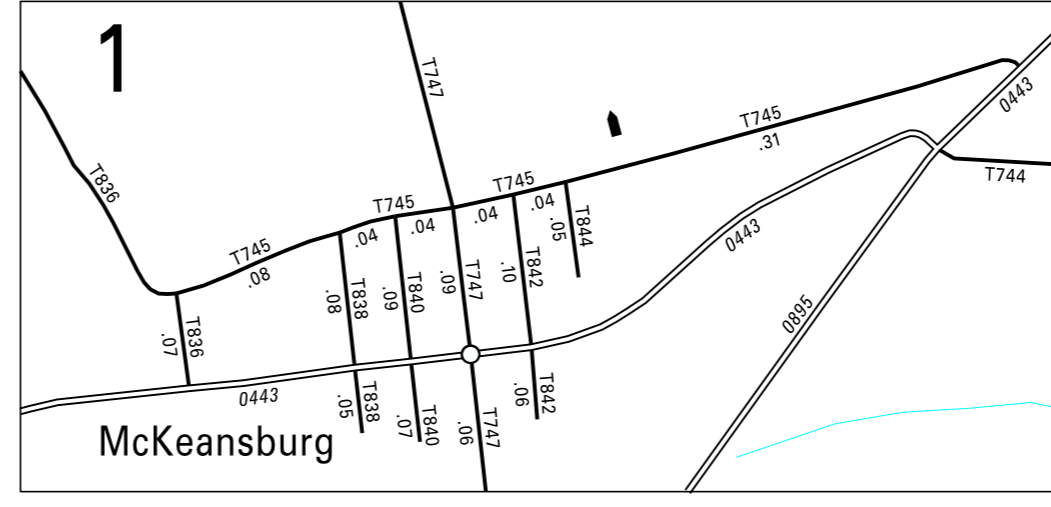
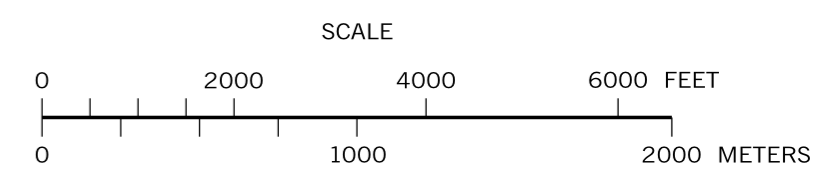

3:1