

TOTAL MILES	
Township Road System	16.77*
State Highway System	6.18
Total	22.95

\* Includes ACT 32 Turnback Mileage of 0.02

- 551 SHOBER ST
- 552 SILVERTON RD
- 553 LEWELLYN RD
- 554 THIRD ST
- 555 CHURCH RD
- 557 MAIN ST
- 564 DIAMOND ST
- 565 BLACK DIAMOND RD
- 566 GUN BOOT RD
- 568 PHOENIX PARK RD
- 569 HIGH ST
- 570 BRICKEY ST
- 571 RAILROAD ST
- 572 MILLING ST
- 600 MILL ST
- 601 STEINS MILL RD
- 602 LAWN RD
- 603 OAK ST
- 604 PINE RD
- 605 THIRD AV
- 606 SECOND AV
- 607 FIRST AV
- 608 HILL TERRACE DR
- 610 MAPLE ST
- 611 SPRING ST
- 612 WONDERLAND DR
- 613 SPRINGWOOD AV
- 614 ELM ST
- 615 PINE ST
- 616 WOODLAND DR
- 700 PINE HILL ST
- 701 C ST
- 702 HICKORY ST
- 703 POTTSVILLE ST
- 704 WASHINGTON ST
- 706 KING ST
- 707 COAL ST
- 708 QUEEN ST
- 709 LINE ST
- 710 SNYDER ST
- 711 SPRING ST
- 814 RAMTOWN RD
- 815 BASSININSKY LA
- 895 BOSSES LA
- 976 DORRINGTON RD
- 977 LYTLE ST
- 978 B ST
- 979 MAPLE ST
- 980 A ST
- 981 TAYLOR ST
- 982 CLAY ST
- 983 CHESTNUT ST
- 984 CORNISH ST
- 987 SUNSET DR
- 988 WEST AV
- 989 SUNDAY DR
- 990 LAUDEMANS LA
- 991 LIBERTY DR
- 992 SPRUCE ST
- 993 BARNHART RD
- 994 PEAR ST
- 995 CHERRY LA
- 997 FOURTH AV
- 998 RAMP RD

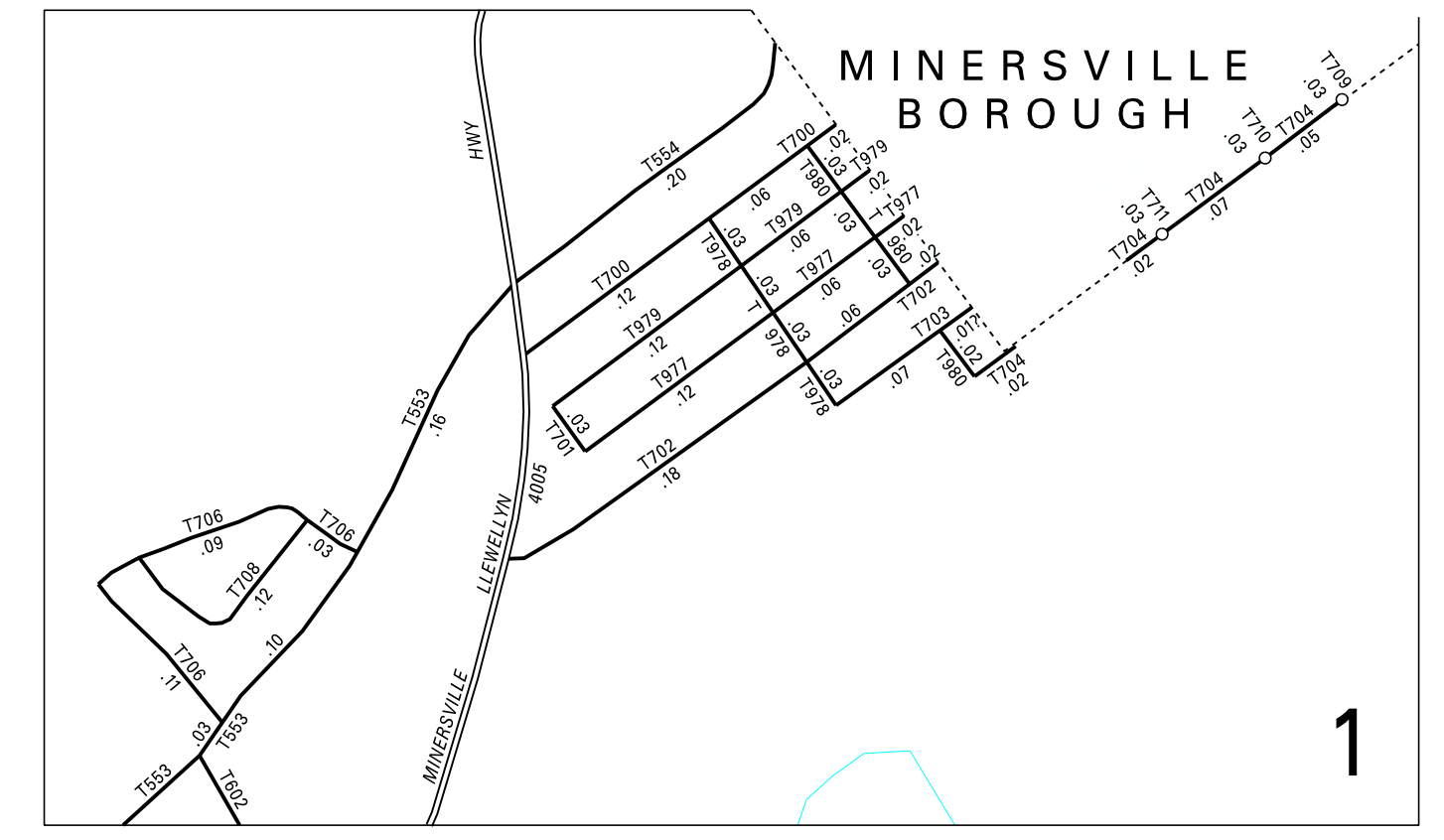
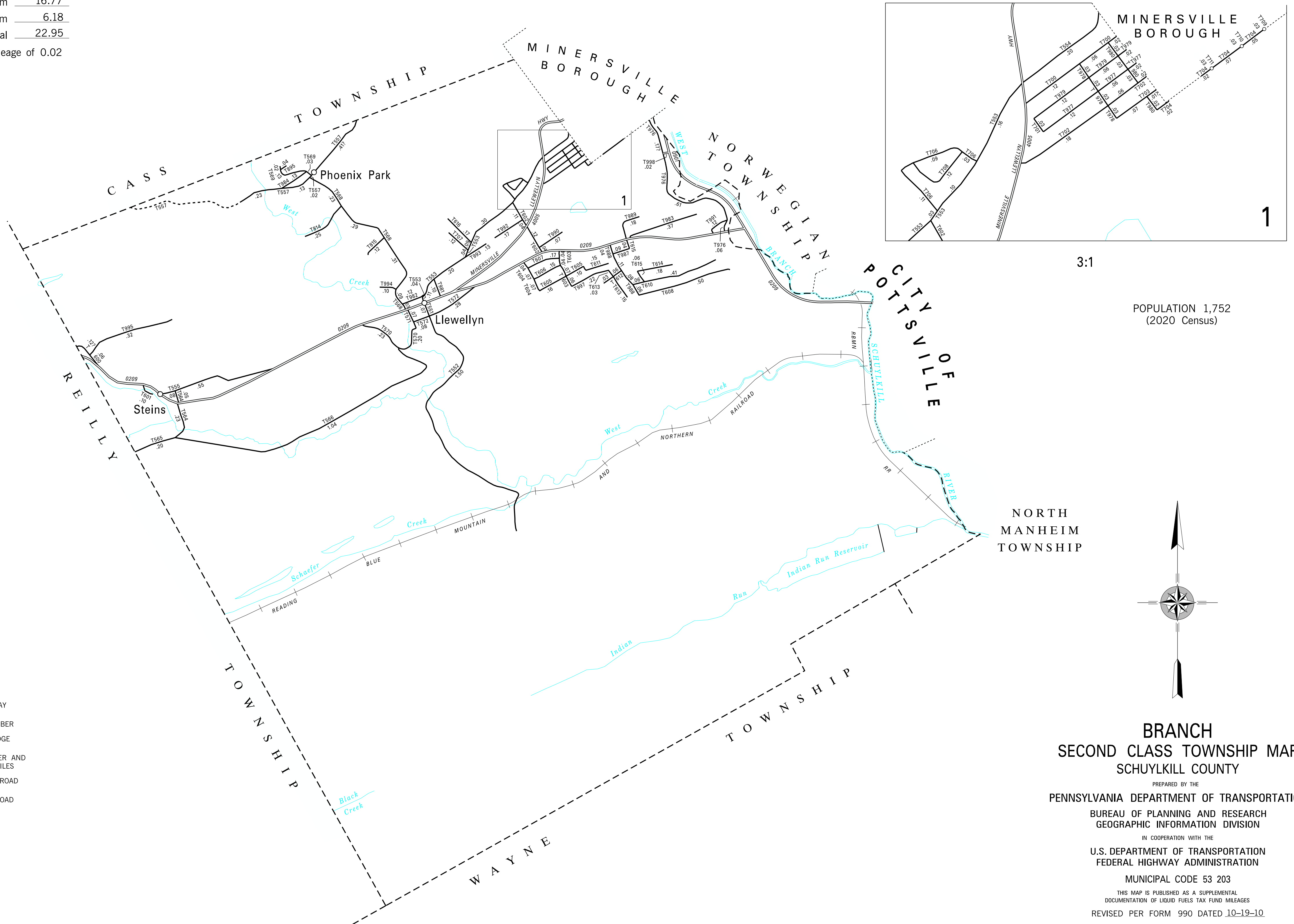

POPULATION 1,752  
(2020 Census)

**LEGEND**

- LIMITED ACCESS HIGHWAY
- STATE ROUTE AND NUMBER
- STATE MAINTAINED BRIDGE ON TOWNSHIP ROAD
- TOWNSHIP ROAD, NUMBER AND SEGMENT LENGTH IN MILES
- IMPASSABLE TOWNSHIP ROAD
- TURNBACK TOWNSHIP ROAD
- OTHER ROAD
- RAILROAD (IN SERVICE)
- RAILROAD ABANDONED (TRACK RETAINED)
- STATE BOUNDARY
- COUNTY BOUNDARY
- TOWNSHIP BOUNDARY
- CITY OR BOROUGH BOUNDARY
- MUNICIPAL BUILDING
- SPLIT MILEAGE BETWEEN MUNICIPALITIES

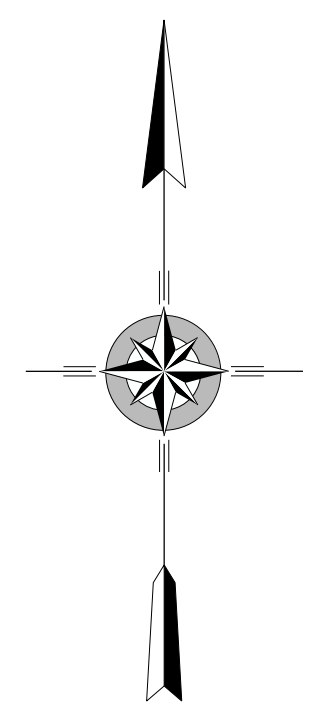

**BRANCH  
SECOND CLASS TOWNSHIP MAP  
SCHUYLKILL COUNTY**

PREPARED BY THE  
PENNSYLVANIA DEPARTMENT OF TRANSPORTATION  
BUREAU OF PLANNING AND RESEARCH  
GEOGRAPHIC INFORMATION DIVISION  
IN COOPERATION WITH THE  
U.S. DEPARTMENT OF TRANSPORTATION  
FEDERAL HIGHWAY ADMINISTRATION  
MUNICIPAL CODE 53 203  
THIS MAP IS PUBLISHED AS A SUPPLEMENTAL  
DOCUMENTATION OF LIQUID FUELS TAX FUND MILEAGES  
REVISED PER FORM 990 DATED 10-19-10

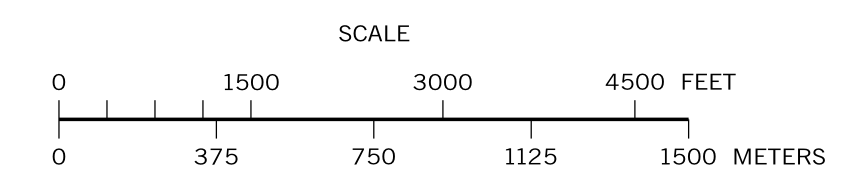

COPIES OF THIS MAP ARE AVAILABLE AT NOMINAL COST  
CONTACT:  
PENNSYLVANIA DEPARTMENT OF TRANSPORTATION  
SALES STORE  
P.O. BOX 3451  
HARRISBURG, PENNSYLVANIA 17105-3451  
TELEPHONE: (717) 787-6746