

TOTAL MILES
 Township Road System 13.38
 State Highway System 15.53
 Total 28.91

LEGEND

- LIMITED ACCESS HIGHWAY
- STATE ROUTE AND NUMBER
- STATE MAINTAINED BRIDGE ON TOWNSHIP ROAD
- TOWNSHIP ROAD, NUMBER AND SEGMENT LENGTH IN MILES
- IMPASSABLE TOWNSHIP ROAD
- TURNBACK TOWNSHIP ROAD
- OTHER ROAD
- RAILROAD (IN SERVICE)
- RAILROAD ABANDONED (TRACK RETAINED)
- STATE BOUNDARY
- COUNTY BOUNDARY
- TOWNSHIP BOUNDARY
- CITY OR BOROUGH BOUNDARY
- MUNICIPAL BUILDING
- SPLIT MILEAGE BETWEEN MUNICIPALITIES

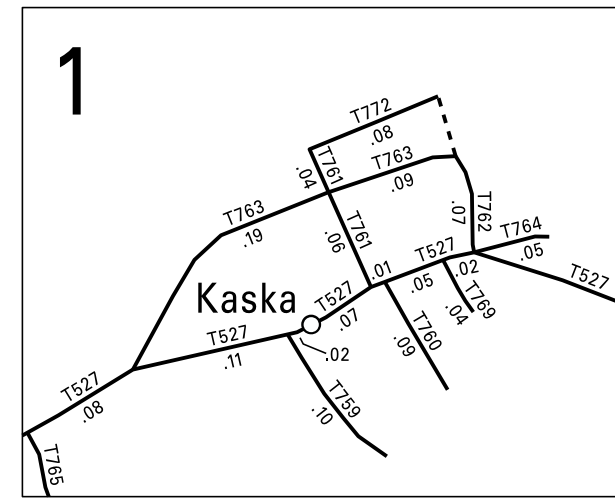
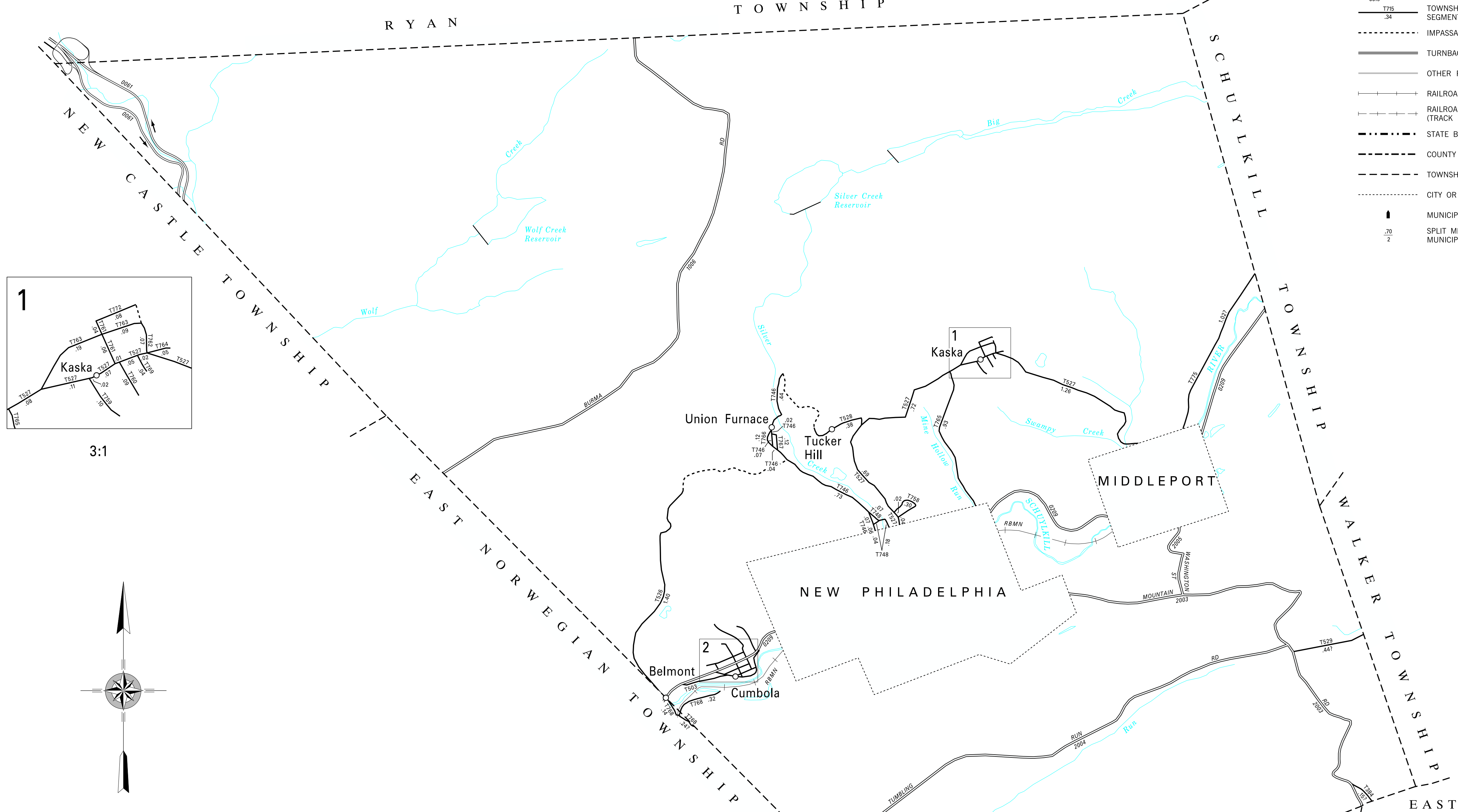

3:1

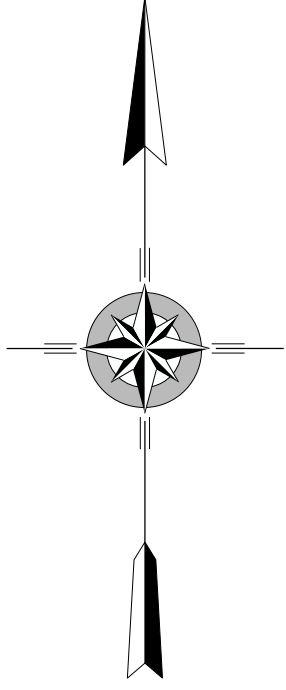

**BLYTHE
 SECOND CLASS TOWNSHIP MAP
 SCHUYLKILL COUNTY**

PREPARED BY THE
PENNSYLVANIA DEPARTMENT OF TRANSPORTATION
 BUREAU OF PLANNING AND RESEARCH
 GEOGRAPHIC INFORMATION DIVISION
 IN COOPERATION WITH THE
 U.S. DEPARTMENT OF TRANSPORTATION
 FEDERAL HIGHWAY ADMINISTRATION
 MUNICIPAL CODE 53 202
 THIS MAP IS PUBLISHED AS A SUPPLEMENTAL
 DOCUMENTATION OF LIQUID FUELS TAX FUND MILEAGES
 REVISED PER FORM 990 DATED 7-24-13

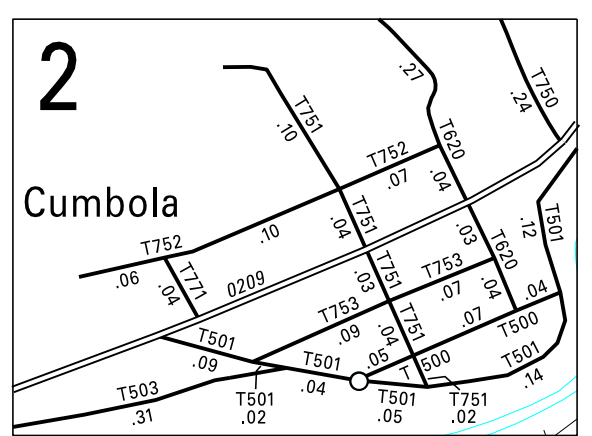

3:1

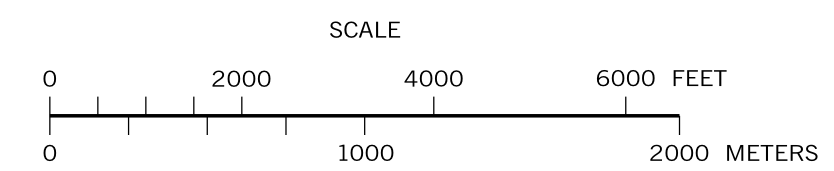

- 384 PINE CREEK RD
- 500 COAL ST
- 501 WATER ST
- 503 TROLLEY ST
- 506 EAGLE HILL RD
- 527 NEW PHILADELPHIA RD
- 528 TUCKER HILL RD
- 529 VALLEY RD
- 620 PINE ST
- 746 SILVER CREEK RD
- 748 FURNACE RD
- 750 PONDEROSA RD
- 751 WOOD ST
- 752 LEHIGH ST
- 753 BOBB AL
- 758 SUNSET LA
- 759 OAK ST
- 760 MAPLE ST
- 761 CENTER ST
- 762 HEMLOCK ST
- 763 MAIN ST
- 764 MONUMENT RD
- 765 JAMES ST
- 766 HIGHLAND ST
- 767 EASTSIDE DR
- 768 RIDGE RD
- 769 HILLSIDE LA
- 771 MAPLE ST
- 772 CHESTNUT ST
- 775 WINFIELD DR

COPIES OF THIS MAP ARE AVAILABLE AT NOMINAL COST
 CONTACT:
 PENNSYLVANIA DEPARTMENT OF TRANSPORTATION
 SALES STORE
 P.O. BOX 3451
 HARRISBURG, PENNSYLVANIA 17105-3451
 TELEPHONE: (717) 783-6746