

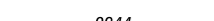









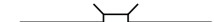

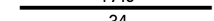

TOTAL MILES
 Township Road System 31.71
 State Highway System 11.47
 Total 43.18

LEGEND

-  LIMITED ACCESS HIGHWAY
-  STATE ROUTE AND NUMBER
-  STATE MAINTAINED BRIDGE ON TOWNSHIP ROAD
-  TOWNSHIP ROAD, NUMBER AND SEGMENT LENGTH IN MILES
-  IMPASSABLE TOWNSHIP ROAD
-  TURNBACK TOWNSHIP ROAD
-  OTHER ROAD
-  RAILROAD (IN SERVICE)
-  RAILROAD ABANDONED (TRACK RETAINED)
-  STATE BOUNDARY
-  COUNTY BOUNDARY
-  TOWNSHIP BOUNDARY
-  CITY OR BOROUGH BOUNDARY
-  MUNICIPAL BUILDING
-  SPLIT MILEAGE BETWEEN MUNICIPALITIES

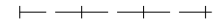

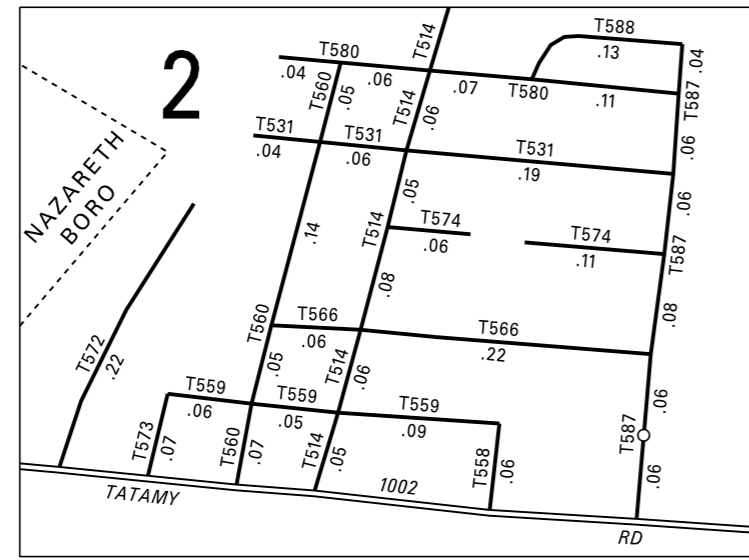
2:1

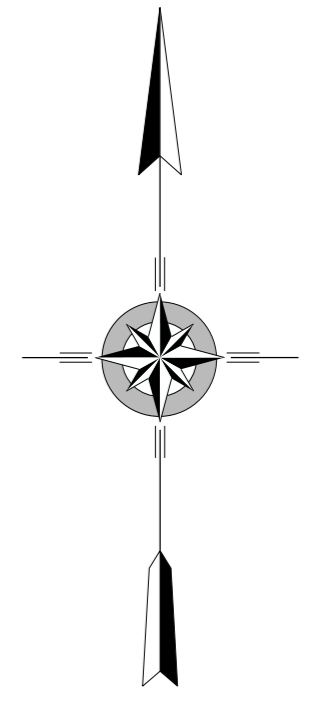
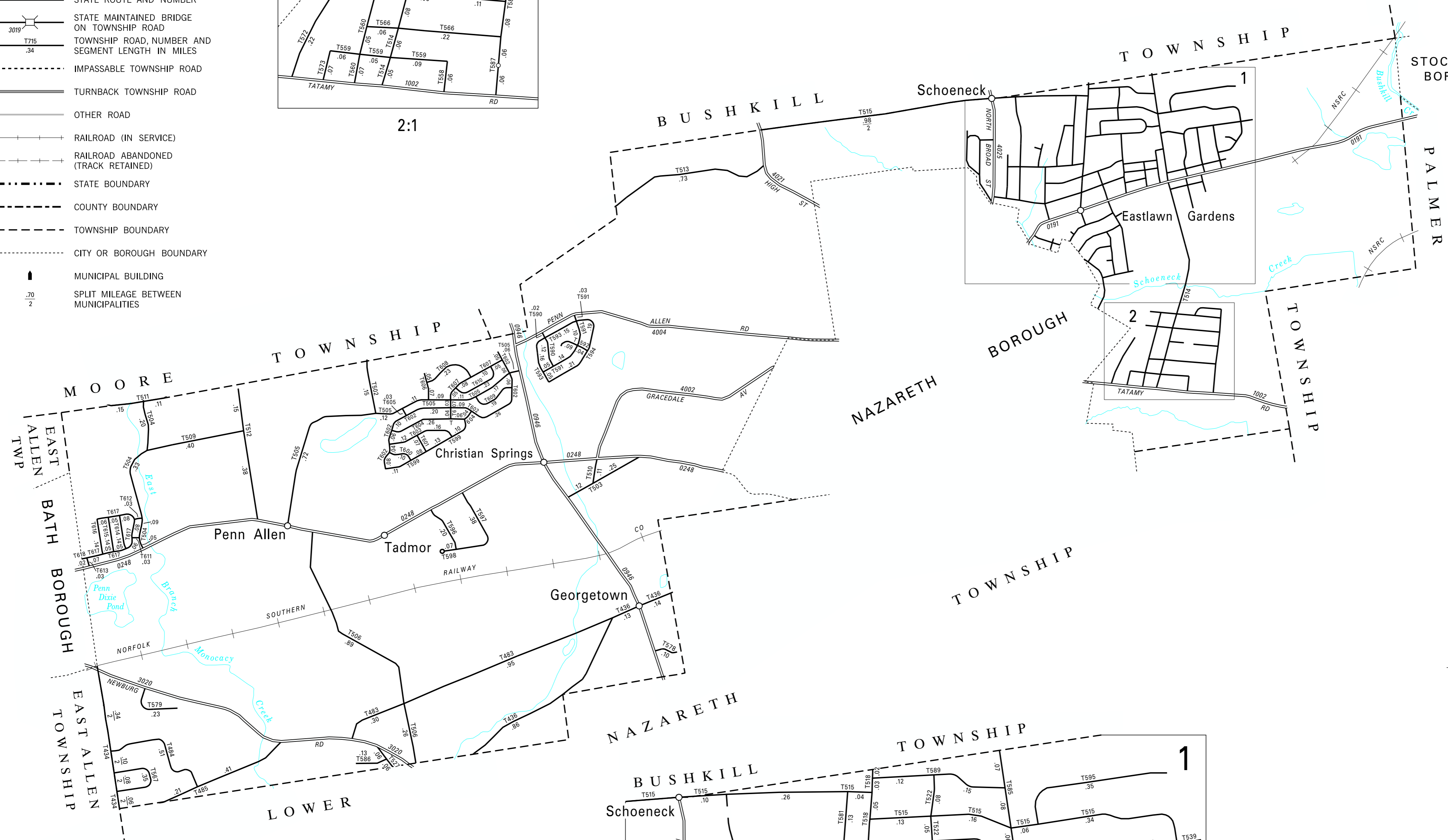

- | | | | | |
|--------------------------|-------------------|-----------------------|-------------------------|---------------------|
| 434 TOWNSHIP LINE RD | 531 FOURTH ST | 562 PORTER ST | 587 FAIRVIEW RD | 611 BROADWOOD WAY |
| 436 GEORGETOWN RD | 532 ELBOW CT | 563 HILL AV | 588 SILO CIR | 612 HEATHERWOOD WAY |
| 483 BLOSSOM HILL RD | 533 EL RENO AV | 564 MORRIS ST | 589 KURT DR | 613 MAYFAIR PL |
| 484 NATHANIEL DR | 534 CAMERON ST | 565 SARAH LA | 590 LYNNWOOD DR | 614 NEVILLE WAY |
| 485 SILVERCREST RD | 535 HOCH ST | 566 SECOND ST | 591 BRIARWOOD LA | 615 PENFIELD WAY |
| 502 LONGLEY RD | 536 WAYNE ST | 567 WHITE FENCE LA | 592 MALLARD CT | 616 WINDSOR CT |
| 503 CHRISTIAN SPRINGS RD | 537 KESSLER ST | 568 ST ELMO ST | 593 FIELDVIEW DR | 617 WESTMINSTER WAY |
| 504 PENN DIXIE RD | 538 HOLLY ST | 569 SYCAMORE ST | 594 BLUE JAY DR | 618 EASTER TER |
| 505 PENN ALLEN RD | 539 DEERFIELD DR | 570 GUM ST | 595 CITY VIEW DR | |
| 506 GUN CLUB RD | 540 HOPEWELL DR | 571 WEST HIGHLAND ST | 596 LEHIGH LA | |
| 509 STERNER RD | 541 LONGVIEW DR | 572 INDUSTRIAL DR | 597 NEW ENGLAND DR | |
| 510 ALMS HOUSE RD | 543 ALLEN ST | 573 WEST ST | 598 NEW ENGLAND CT | |
| 511 FOX RD | 546 RUNNY CT | 574 THIRD ST | 599 EAGLES NEST LA | |
| 512 MICHAELS SCHOOL RD | 550 HENRY AV | 575 WILLOWDALE AV | 600 GRAY COTTAGE LA | |
| 513 LEVIS RD | 551 FAIRVIEW ST | 576 BIRCHWOOD DR | 601 AMERICAN HEMLOCK LA | |
| 514 FRIEDENSTAHL AV | 552 CHARLES AV | 577 WEST HIGHLAND TER | 602 EAGLES LANDING DR | |
| 515 BELL AV | 553 LIBERTY ST | 578 CHASE CT | 603 MONACACY RD | |
| 518 ROSE INN AV | 554 GEORGE AV | 579 RISING SUN CT | 604 ENGLISH IVY RD | |
| 520 IGGY CT | 555 MITCHELL AV | 580 FIFTH ST | 605 BLUE EAGLE LA | |
| 522 NEWPORT AV | 556 SEYFRIED AV | 581 ASTER ST | 606 EAGLE VIEW CT | |
| 523 WEYERS ST | 557 RIDGE LA | 582 CREEKSIDE DR | 607 EVENING SUN RD | |
| 524 ELEY ST | 558 CENTRAL AV | 583 TEWKSBRURY CT | 608 BLUE MOUNTAIN LA | |
| 525 MONROE ST | 560 MT VERNON ST | 584 KINGSBURY CT | 609 MARTIN ST | |
| 527 WERNER RD | 561 STONYBROOK RD | 585 SCHOENECK AV | 610 OLD TOWNE RD | |
| 528 CHRISTMAN AV | | 586 LYNN LA | | |

COPIES OF THIS MAP ARE AVAILABLE AT NOMINAL COST
 CONTACT:
 PENNSYLVANIA DEPARTMENT OF TRANSPORTATION
 SALES STORE
 P.O. BOX 3451
 HARRISBURG, PENNSYLVANIA 17105-3451
 TELEPHONE: (717)787-5746

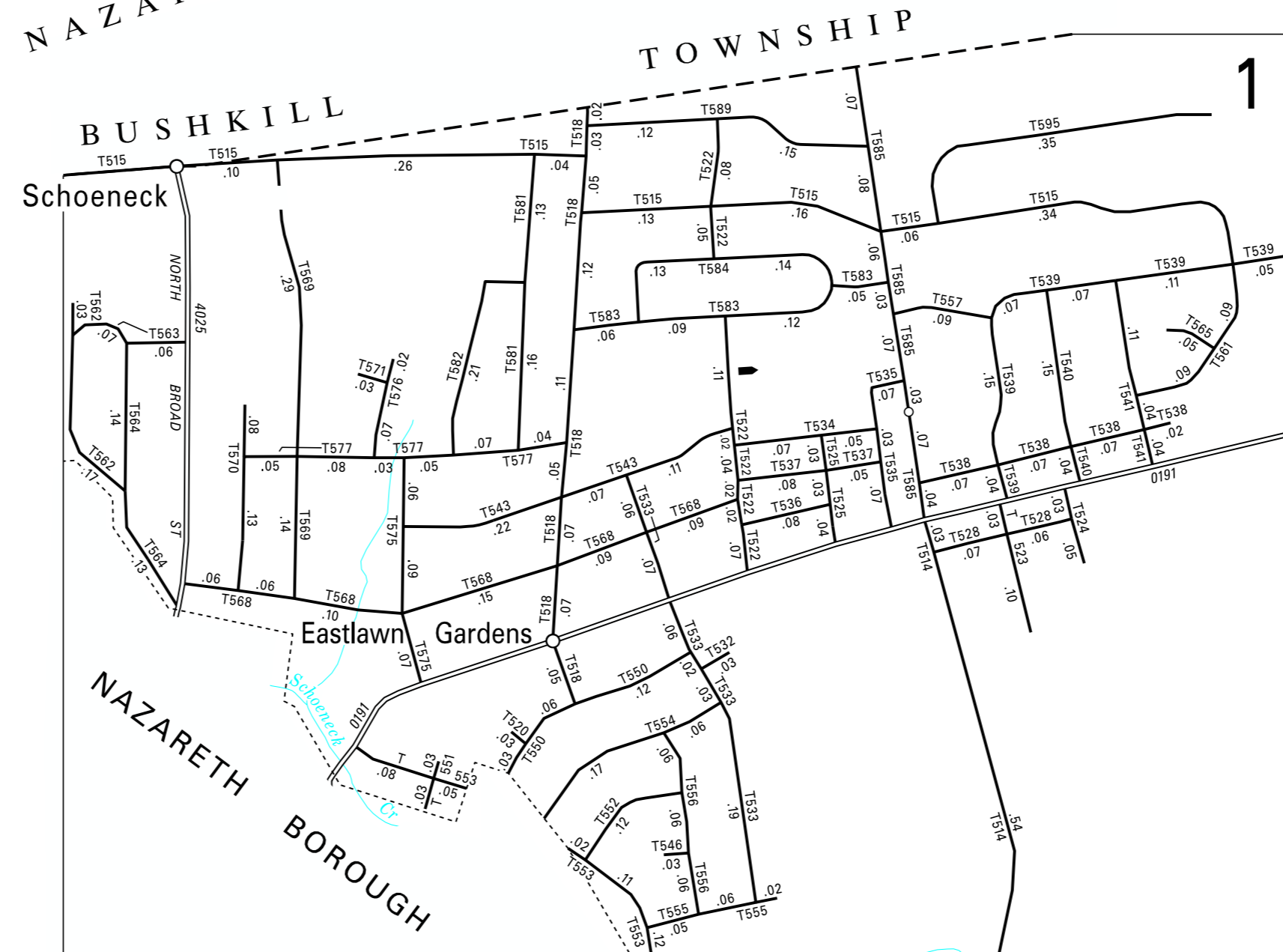

2:1

**UPPER NAZARETH
 SECOND CLASS TOWNSHIP MAP
 NORTHAMPTON COUNTY**

PREPARED BY THE
 PENNSYLVANIA DEPARTMENT OF TRANSPORTATION
 BUREAU OF PLANNING AND RESEARCH
 GEOGRAPHIC INFORMATION DIVISION
 IN COOPERATION WITH THE
 U.S. DEPARTMENT OF TRANSPORTATION
 FEDERAL HIGHWAY ADMINISTRATION
 MUNICIPAL CODE 48 215

THIS MAP IS PUBLISHED AS A SUPPLEMENTAL
 DOCUMENTATION OF LIQUID FUELS TAX FUND MILEAGES
 REVISED PER FORM 990 DATED 10-5-17

