

LEGEND

- LIMITED ACCESS HIGHWAY
- STATE ROUTE AND NUMBER
- STATE MAINTAINED BRIDGE ON TOWNSHIP ROAD
- TOWNSHIP ROAD, NUMBER AND SEGMENT LENGTH IN MILES
- IMPASSABLE TOWNSHIP ROAD
- TURNBACK TOWNSHIP ROAD
- OTHER ROAD
- RAILROAD (IN SERVICE)
- RAILROAD ABANDONED (TRACK RETAINED)
- STATE BOUNDARY
- COUNTY BOUNDARY
- TOWNSHIP BOUNDARY
- CITY OR BOROUGH BOUNDARY
- MUNICIPAL BUILDING
- SPLIT MILEAGE BETWEEN MUNICIPALITIES

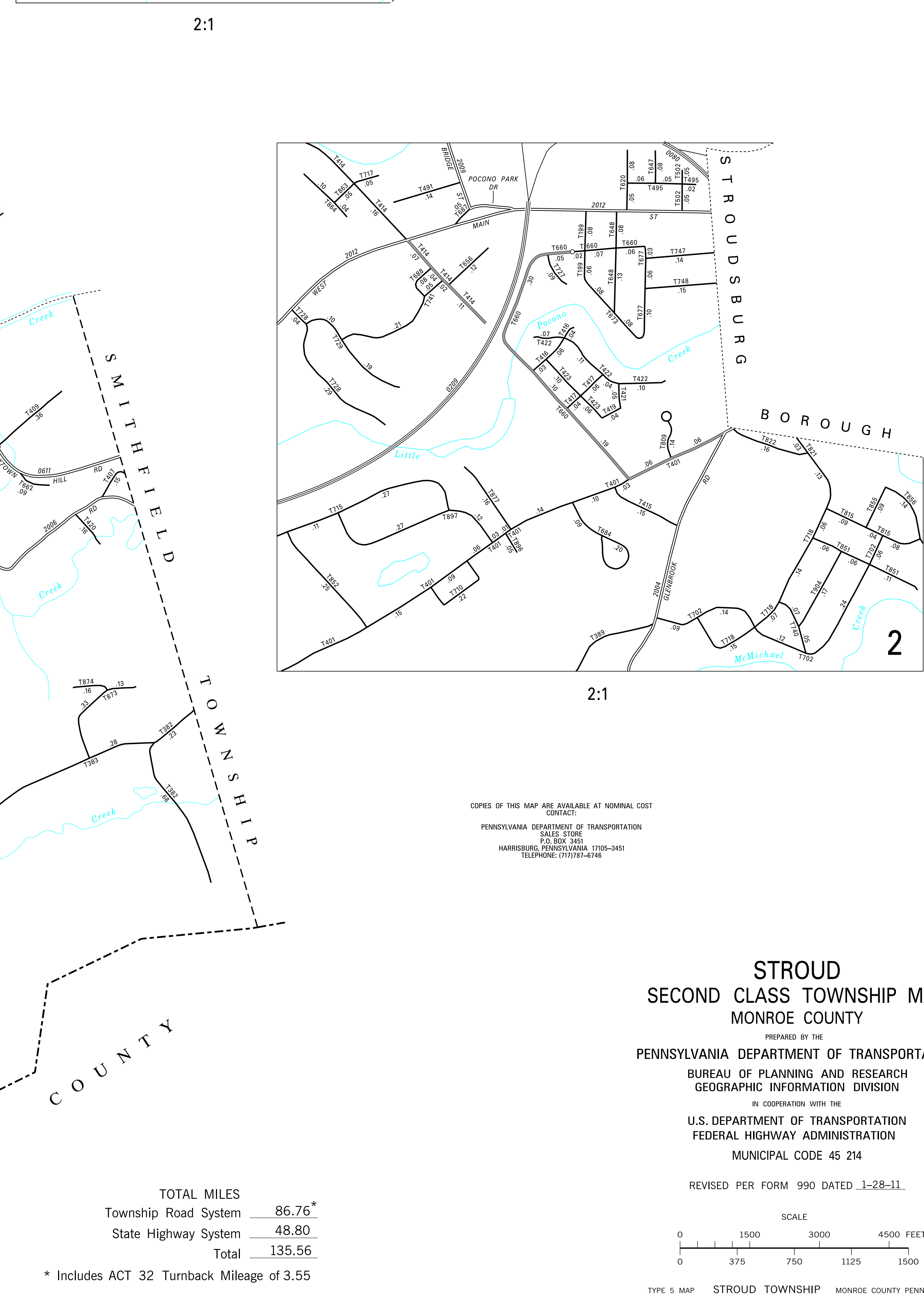
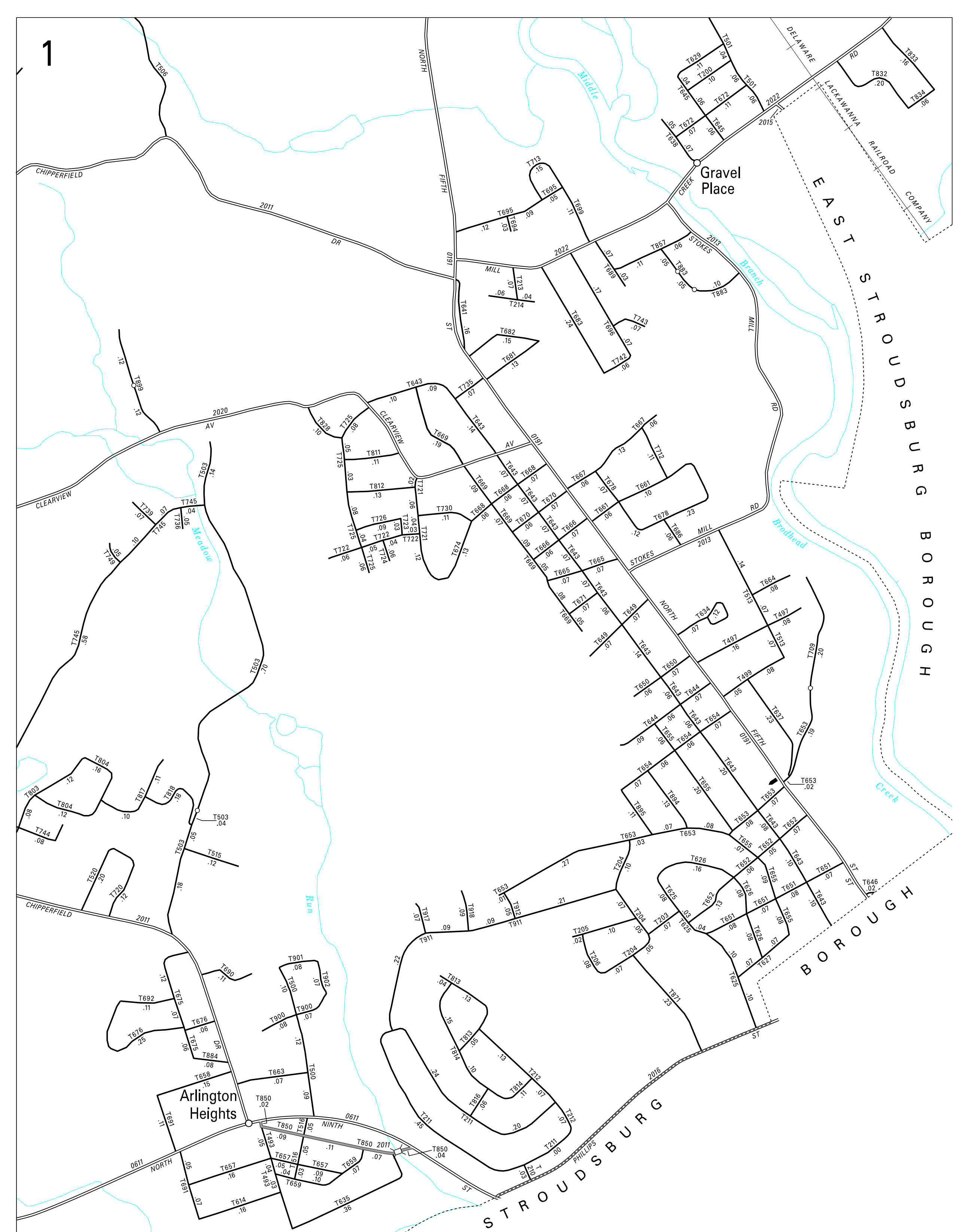
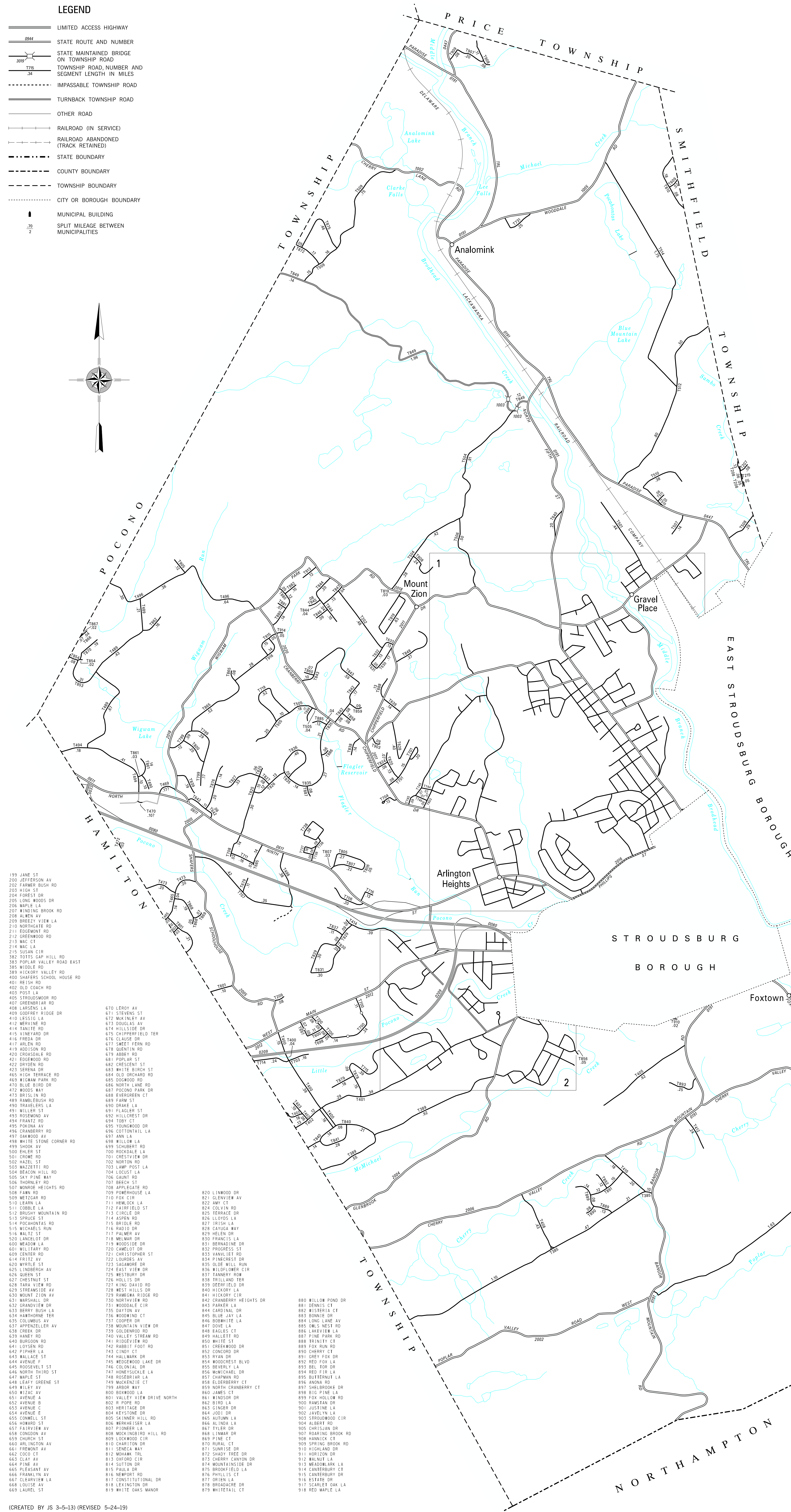
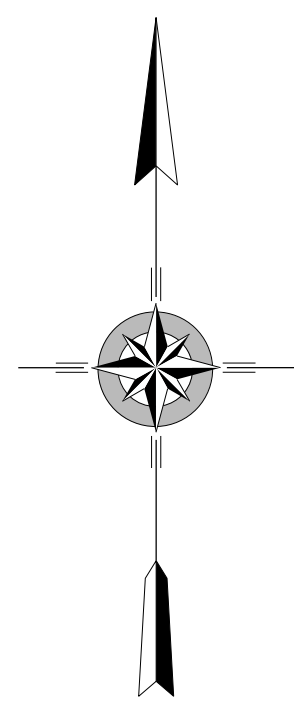

- 199 JANE ST
- 200 SEFERSON AV
- 202 FARWER BUSH RD
- 203 WILSON ST
- 204 FOREST DR
- 209 LONG WOODS DR
- 206 MAPLE LA
- 207 WINDING BROOK RD
- 208 ALVEN AV
- 209 BREEZY VIEW LA
- 210 NORTHGATE RD
- 211 EDGEWATER RD
- 212 GREENWOOD RD
- 213 WAC CT
- 214 WAC LA
- 215 SUSAN CIR
- 280 TOTES CAP HILL RD
- 383 POPLAR VALLEY ROAD EAST
- 389 HICKORY VALLEY RD
- 400 SHARPS SCHOOL HOUSE RD
- 401 REISA RD
- 402 BUCKLEBUSH RD
- 403 POPS LA
- 405 STRUODSWOOD RD
- 407 GREENBUSH RD
- 408 LARSENS LA
- 409 COBBERS RIDGE DR
- 410 LESSIG LA
- 412 WILSON RD
- 414 TANTIE DR
- 416 WINEFORD DR
- 417 FREGA DR
- 419 ADDISON RD
- 420 GARDNER RD
- 421 EDGEWOOD RD
- 422 SHIPEN RD
- 423 SERENA DR
- 425 HIGH TERRACE RD
- 426 WICAM PARK RD
- 430 BLUE BIRD DR
- 432 WOOD AVE
- 433 BRISLIN RD
- 438 HAMBLEDON RD
- 490 TRAVELERS LA
- 491 MILLER ST
- 493 ROSEWOOD AV
- 494 FRANK RD
- 495 POKONA AV
- 496 CANTON RD
- 497 OAKWOOD AV
- 498 WHITE STONE CORNER RD
- 499 SHOOK AV
- 500 FLEET ST
- 501 SHOOK RD
- 502 MAZEL ST
- 503 WALCOTT RD
- 504 BEACON HILL RD
- 505 SAK FINE WAY
- 506 THORNLEY RD
- 507 MONROE HEIGHTS DR
- 508 LAWN RD
- 509 WETZLAR RD
- 510 LEARN LA
- 511 GORLE LA
- 512 BRUSHY MOUNTAIN RD
- 513 SPRUCE ST
- 514 PICAMONTAS RD
- 515 MICHAEL RUN
- 516 WALT ST
- 520 LANCLOT DR
- 600 MEADOW LA
- 601 WILFARY RD
- 602 CENTER RD
- 614 FRITZ AV
- 620 WHELE ST
- 625 LINDBERGH AV
- 627 CHESTNUT ST
- 628 BARN VIEW RD
- 629 STREAMSIDE AV
- 630 WOOD ZION AV
- 631 MARSHALL DR
- 632 GRANVIEW DR
- 633 BERRY BUSH LA
- 634 HAWTHORNE TER
- 635 COLUMBUS AV
- 637 APPENZELER AV
- 638 CREEK DR
- 639 HANEY RD
- 640 BURTON RD
- 641 LOYSEN RD
- 642 WILSON LA
- 643 MALLALE ST
- 644 WILSON RD
- 645 ROOSEVELT ST
- 646 NORTH BRIND ST
- 647 MAPLE ST
- 648 LEAF GREEN ST
- 649 FLEET AV
- 650 WIZAC AV
- 652 AVENUE D
- 653 AVENUE C
- 654 AVENUE E
- 655 CONNELL ST
- 656 HOWARD ST
- 658 CONCORD AV
- 659 CHURCH ST
- 660 ARLINGTON AV
- 661 FREWENT AV
- 662 OAK CT
- 663 CLAY AV
- 664 FINE AV
- 665 PLEASANT AV
- 667 CLEARVIEW AV
- 668 LOUISE AV
- 669 LAUREL ST
- 670 LEROY AV
- 671 STEVENS ST
- 672 MURKINLEY AV
- 673 COUGLAS AV
- 674 HILLSIDE DR
- 675 COPPERFIELD TER
- 676 CLAUDE DR
- 677 LAMBERT FERN RD
- 678 QUENTIN RD
- 681 POPLAR ST
- 682 CRESCENT ST
- 683 WHITE BIRCH ST
- 684 OLD ORCHARD RD
- 685 CEDARWOOD RD
- 686 NORTH LAKE RD
- 687 POCONO PARK DR
- 688 EVERGREEN CT
- 689 FARM ST
- 690 DRAKE LA
- 691 BRADLER ST
- 692 HILLCREST DR
- 693 YOUNGWOOD DR
- 694 TONY CT
- 695 ANN LA
- 696 WILLOW LA
- 697 SCHUBERT RD
- 700 ROCKDALE LA
- 701 CRESTVIEW DR
- 702 NORTH RD
- 703 LAMP POST LA
- 704 LOCUST LA
- 706 GARDY RD
- 707 BEECH ST
- 709 POWERSHOUSE LA
- 710 FOX CIR
- 711 PEMROCK LA
- 712 HUNTINGFIELD ST
- 713 CIRCLE DR
- 714 SPRING RD
- 715 BRIDLE RD
- 716 RADIO DR
- 717 PALMER AV
- 718 MELMAR DR
- 719 WOODSIDE DR
- 720 CAMELOT DR
- 721 CHRISTOPHER ST
- 722 LAURELS AV
- 723 LAGANOR DR
- 724 EAST VIEW DR
- 725 WESTVIEW DR
- 726 HOLLIS DR
- 727 KING DAVID RD
- 728 WEST HILLS DR
- 729 HAMBURG RIDGE RD
- 730 NORTHVIEW RD
- 731 WOODALE CIR
- 732 BRANTON AV
- 733 WOODRIND CT
- 737 COPPER DR
- 738 MOUNTAIN VIEW DR
- 739 GOLDENWOOD RD
- 740 VALLEY STREAM RD
- 741 RIDGEVIEW DR
- 742 BABBIT FOOT RD
- 743 CINDY CT
- 744 HALLMARK DR
- 745 WEDGWOOD LAKE DR
- 746 COLONIAL DR
- 747 HUNTINGWOOD LA
- 748 ROSEBRIAR LA
- 749 MACKENZIE CT
- 799 BRIDG WAY
- 800 BOXWOOD LA
- 801 VALLEY VIEW DRIVE NORTH
- 802 W POPE RD
- 803 HERITAGE DR
- 804 KEYSTONE DR
- 805 SWANER HILL RD
- 806 WERKHEISER LA
- 807 STONERS LA
- 808 MCKINGHUR HILL RD
- 809 LOCKWOOD CIR
- 810 CHARLTON DR
- 811 GENEVA WAY
- 812 MOHAM TRL
- 813 OXFORD DR
- 814 SUTTON DR
- 815 PAULA DR
- 816 NEWPORT AV
- 817 CONSTITUTIONAL DR
- 818 BRIDGWADE DR
- 819 WHITE OAKS MANOR
- 820 LINWOOD DR
- 821 OLIVEVIEW AV
- 822 AMY CT
- 824 COLVIN DR
- 825 TERRACE DR
- 826 LLOYDS LA
- 827 IRIS LA
- 828 CAYUGA WAY
- 829 ERIEN DR
- 830 FRANCIS LA
- 831 BERNARDINE DR
- 832 PROGRESS DR
- 833 HANLEY RD
- 834 FINCHREST DR
- 835 OLIVE MILL RUN
- 836 HILFLOWER CIR
- 837 SANDER HORN
- 838 TRILLIARD TER
- 839 SEER FELD DR
- 840 HICKORY LA
- 841 HICKORY CTR
- 842 DRANGBERRY HEIGHTS DR
- 843 PARKER LA
- 844 CAROL DR
- 845 BLUE JAY LA
- 846 ROBERTA LA
- 847 DOVE LA
- 848 SAGES CT
- 849 HALLETT DR
- 851 CREEKWOOD DR
- 852 CONCORD DR
- 853 WYAN DR
- 854 WOODCHURCH BLVD
- 855 BEVERLY LA
- 856 WOODCHURCH DR
- 857 CHARMAN RD
- 858 BLUFFERVIEW CT
- 859 NORTH CRANBERRY CT
- 860 JAMES CT
- 861 KINGSDOR DR
- 862 IRID LA
- 863 LINDOR DR
- 864 JODI DR
- 865 ALINDA LA
- 866 ELLEN DR
- 868 LINBAR DR
- 869 HINE CT
- 870 RURAL LA
- 871 SUNNY DR
- 872 SHADY TREE DR
- 873 CHERRY CANYON DR
- 874 MOUNTAIN DR
- 875 BROOKFIELD LA
- 876 PAVILLIS CT
- 877 ORLEN LA
- 878 BRIDGWADE DR
- 879 WHITEFALL CT
- 880 RILLON POND DR
- 881 DENNIS CT
- 882 ALICEBIA CT
- 883 BONNIE DR
- 884 LONG LAKE AV
- 885 OWLS NEST AV
- 886 LAKESHIRE LA
- 887 PINE PARK RD
- 888 PINNACLY CT
- 889 FOX RUN RD
- 890 CHERRY CT
- 891 GREY FOX DR
- 892 RED FOX LA
- 893 BELL FOR DR
- 894 RED FOX LA
- 895 BELTVIEW LA
- 896 ANONA RD
- 897 FOX HOLLOW RD
- 898 BIG FINE LA
- 900 JUSTICE LA
- 902 JAVELYN LA
- 903 STROUDWOOD CIR
- 904 ALBERT DR
- 905 HIGHLAND DR
- 907 ROARING BROOK RD
- 908 HANCOCK DR
- 909 SPRING BROOK DR
- 910 HIGHLAND DR
- 911 HORIZON DR
- 912 ALINDA LA
- 913 WARDLAW LA
- 914 CENTERBURY CT
- 915 CENTERBURY DR
- 916 ESTATE DR
- 917 SCARLET OAK LA
- 918 RED MAPLE LA

TOTAL MILES	
Township Road System	86.76*
State Highway System	48.80
Total	135.56

* Includes ACT 32 Turnback Mileage of 3.55

STROUD
SECOND CLASS TOWNSHIP MAP
MONROE COUNTY

PREPARED BY THE
PENNSYLVANIA DEPARTMENT OF TRANSPORTATION
BUREAU OF PLANNING AND RESEARCH
GEOGRAPHIC INFORMATION DIVISION

IN COOPERATION WITH THE
U.S. DEPARTMENT OF TRANSPORTATION
FEDERAL HIGHWAY ADMINISTRATION
MUNICIPAL CODE 45 214

