

| | |
|----------------------|------|
| TOTAL MILES | |
| Borough Road System | 5.67 |
| State Highway System | 1.70 |
| Total | 7.37 |

POPULATION 1,695
(2000 Census)

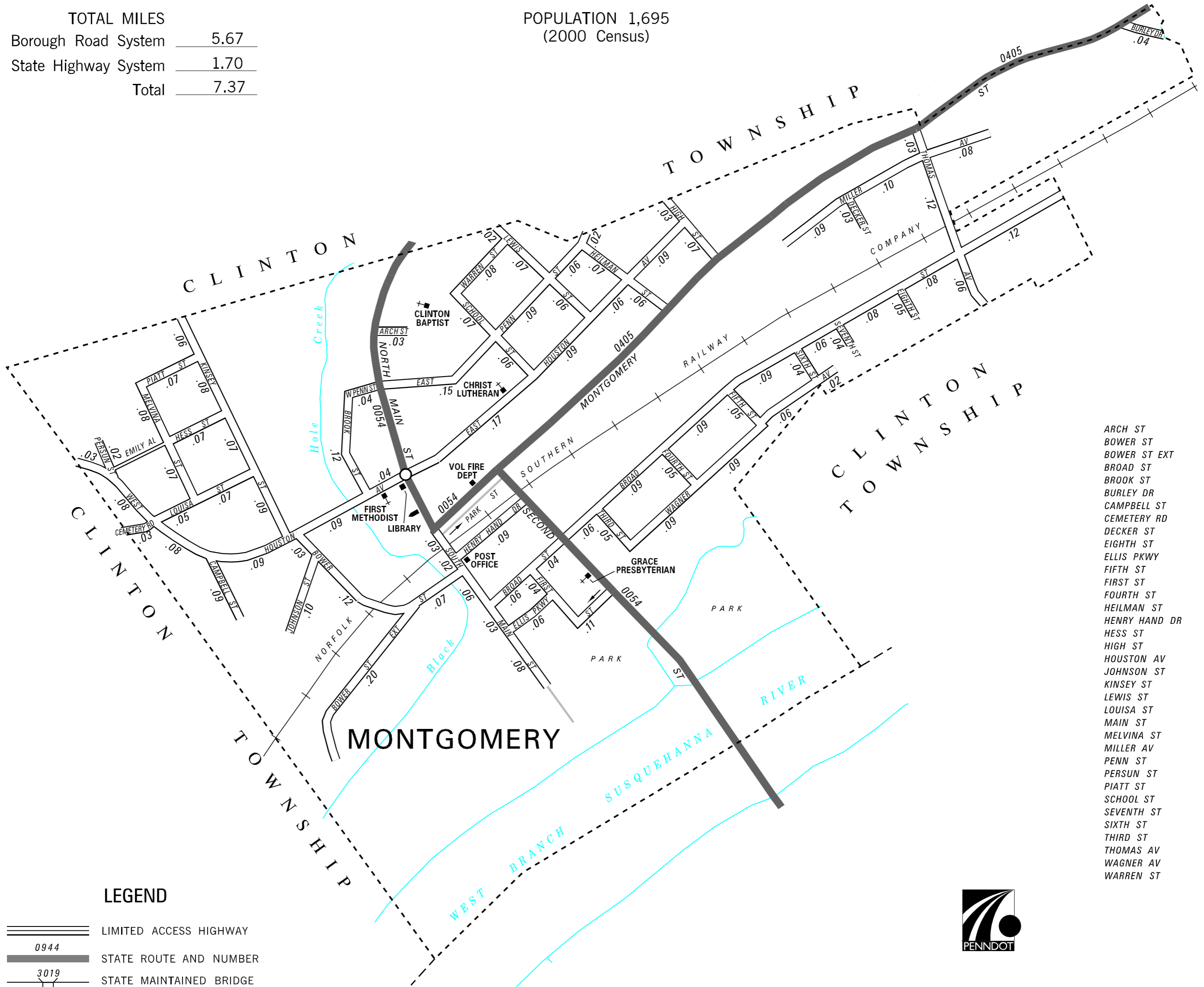

- ARCH ST
- BOWER ST
- BOWER ST EXT
- BROAD ST
- BROOK ST
- BURLEY DR
- CAMPBELL ST
- CEMETERY RD
- DECKER ST
- EIGHTH ST
- ELLIS PKWY
- FIFTH ST
- FIRST ST
- FOURTH ST
- HEILMAN ST
- HENRY HAND DR
- HESS ST
- HIGH ST
- HOUSTON AV
- JOHNSON ST
- KINSEY ST
- LEWIS ST
- LOUISA ST
- MAIN ST
- MELVINA ST
- MILLER AV
- PENN ST
- PERSUN ST
- PIATT ST
- SCHOOL ST
- SEVENTH ST
- SIXTH ST
- THIRD ST
- THOMAS AV
- WAGNER AV
- WARREN ST

LEGEND

- LIMITED ACCESS HIGHWAY
- STATE ROUTE AND NUMBER
- STATE MAINTAINED BRIDGE ON BOROUGH STREET
- BOROUGH STREET NAME AND SEGMENT LENGTH IN MILES
- TURNBACK BOROUGH STREET
- BOROUGH ALLEY
- OTHER ROAD
- RAILROAD
- STATE BOUNDARY
- COUNTY BOUNDARY
- TOWNSHIP BOUNDARY
- CITY BOUNDARY
- BOROUGH BOUNDARY
- MUNICIPAL BUILDING
- SPLIT MILEAGE BETWEEN MUNICIPALITIES
- SCHOOL, COLLEGE OR UNIVERSITY
- POINT OF INTEREST

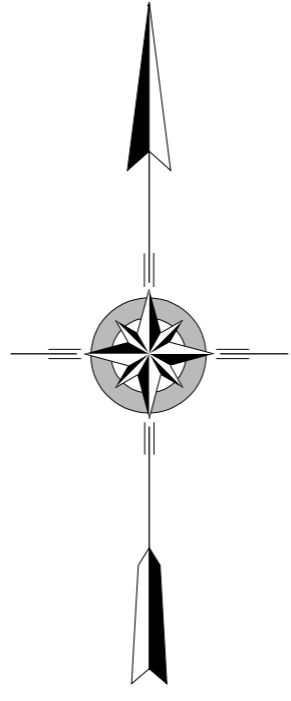

MONTGOMERY BOROUGH

LYCOMING COUNTY

PREPARED BY THE
PENNSYLVANIA DEPARTMENT OF TRANSPORTATION
 BUREAU OF PLANNING AND RESEARCH
 GEOGRAPHIC INFORMATION DIVISION
 IN COOPERATION WITH THE
 U.S. DEPARTMENT OF TRANSPORTATION
 FEDERAL HIGHWAY ADMINISTRATION
 AND
 MUNICIPAL SERVICES DISTRICT 3-0
 MUNICIPAL CODE 41 404
 REVISED PER FORM 990 DATED 2-10-97

