

TOTAL MILES	
Borough Road System	32.56
State Highway System	8.90
Total	41.46

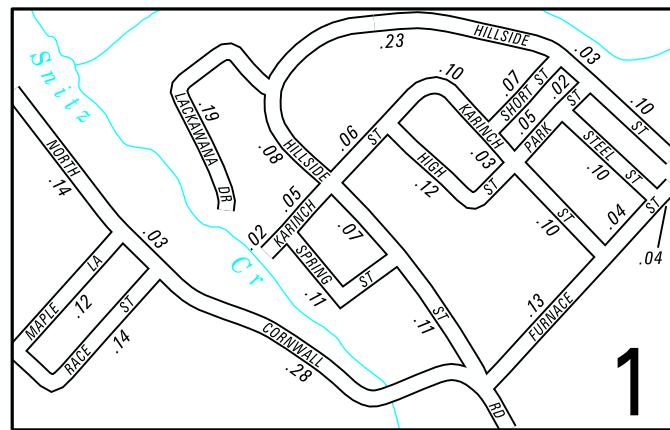

2:1

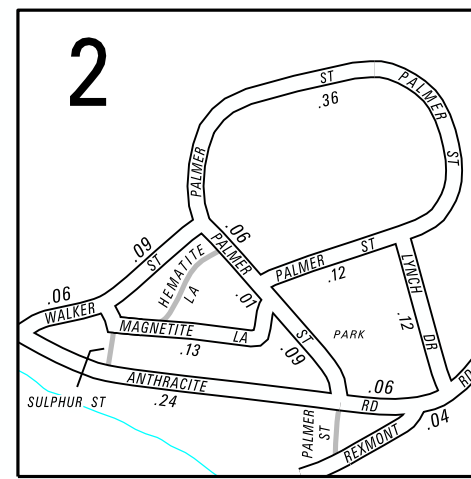

2:1

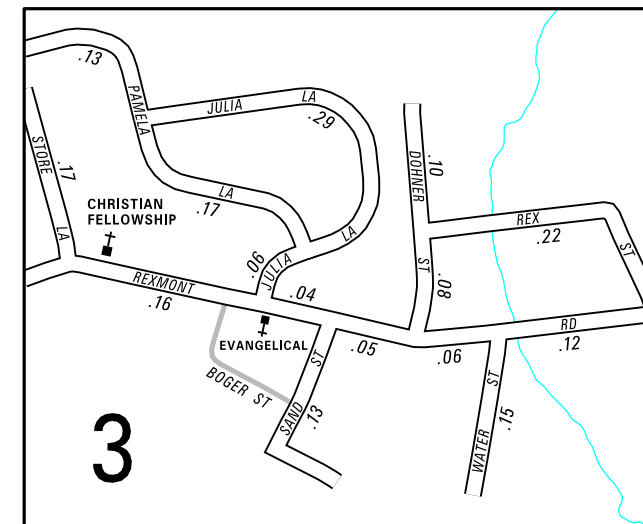

2:1

- ALDEN ST
- ANTHRACITE RD
- ASH LA
- ASPEN LA
- BAYBERRY CT
- BEECH DR
- BOYD ST
- BURD COLEMAN RD
- CEDAR ST
- CHERRY AV
- CORNWALL HILLS DR
- COTTONWOOD DR
- CULVERT ST
- DOGWOOD DR
- DOHNER ST
- DOUGLAS FIR DR
- DOUGLAS FIR CV
- FAIRLANE DR
- FURNACE ST
- GOLD RD
- GRANITE ST
- HEMLOCK LA
- HICKORY DR
- HIGH ST
- HILLSIDE ST
- HOLLY LA
- IRON AL
- IRONMASTER RD
- JULIA LA
- JUNIPER ST
- KARINCH ST
- LACKWANNA DR
- LARCH CIR
- LYNCH DR
- MAGNETITE LA
- MAGNOLIA LA
- MAPLE LA
- MAPLE ST
- NORTH CORNWALL RD
- NORWAY LA
- OAK ST
- OLD FURNACE RD
- PALMER ST
- PAMELA LA
- PARK ST
- PINE ST
- RACE ST
- REX ST
- REXMONT RD
- SAND ST
- SHIRK ST
- SHORT ST
- SPRING ST
- SPRING HILL LA
- SPRUCE ST
- STEEL ST
- STORE LA
- SYCAMORE DR
- TICE LA
- TULIP TREE DR
- WALKER ST
- WATER ST
- WENGER ST
- WHITMAN RD
- WILLOW ST
- ZINNS MILL RD

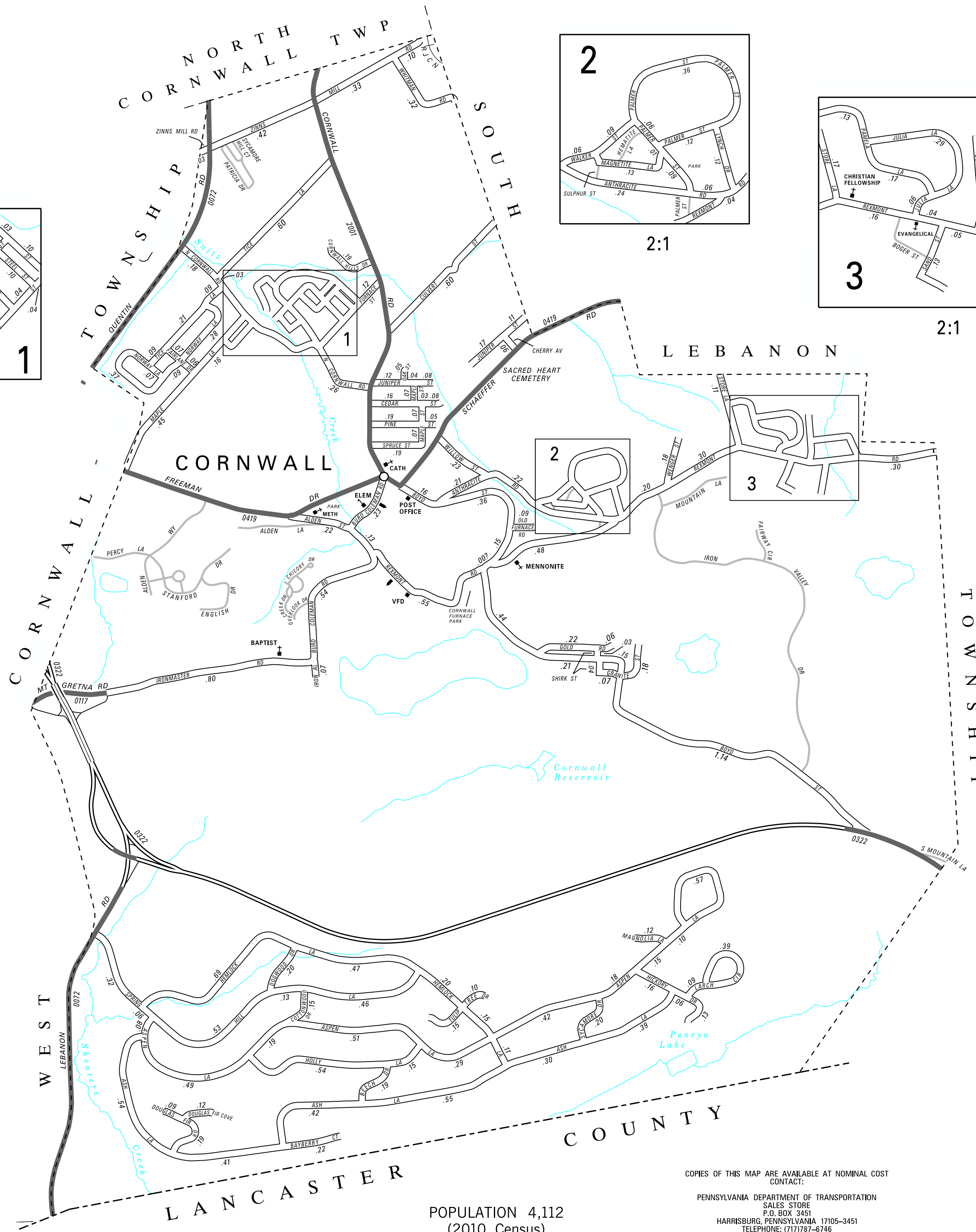

POPULATION 4,112
(2010 Census)

LEGEND

- LIMITED ACCESS HIGHWAY
- STATE ROUTE AND NUMBER
- STATE MAINTAINED BRIDGE ON BOROUGH STREET
- BOROUGH STREET NAME AND SEGMENT LENGTH IN MILES
- TURNBACK BOROUGH STREET
- BOROUGH ALLEY
- OTHER ROAD
- RAILROAD
- STATE BOUNDARY
- COUNTY BOUNDARY
- TOWNSHIP BOUNDARY
- CITY BOUNDARY
- BOROUGH BOUNDARY
- MUNICIPAL BUILDING
- SPLIT MILEAGE BETWEEN MUNICIPALITIES
- SCHOOL, COLLEGE OR UNIVERSITY
- POINT OF INTEREST

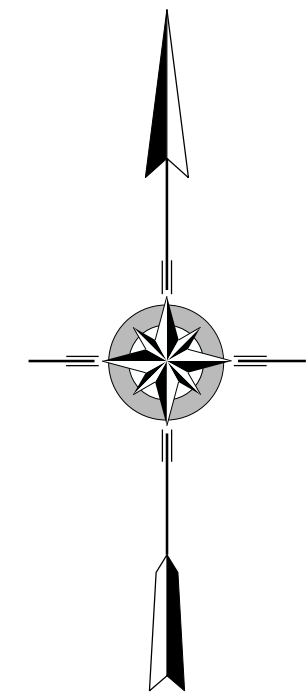

CORNWALL BOROUGH

LEBANON COUNTY

PREPARED BY THE
PENNSYLVANIA DEPARTMENT OF TRANSPORTATION
BUREAU OF PLANNING AND RESEARCH
GEOGRAPHIC INFORMATION DIVISION

IN COOPERATION WITH THE
U.S. DEPARTMENT OF TRANSPORTATION
FEDERAL HIGHWAY ADMINISTRATION

AND
MUNICIPAL SERVICES DISTRICT 8-0
MUNICIPAL CODE 38 402

THIS MAP IS PUBLISHED AS A SUPPLEMENTAL
DOCUMENTATION OF LIQUID FUELS TAX FUND MILEAGES
REVISED PER FORM 990 DATED 10-28-19

SCALE

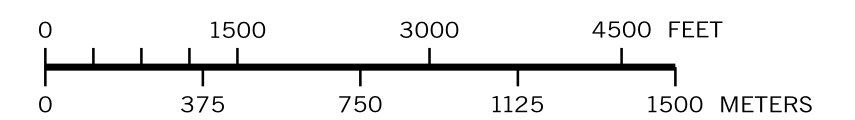

COPIES OF THIS MAP ARE AVAILABLE AT NOMINAL COST
CONTACT:
PENNSYLVANIA DEPARTMENT OF TRANSPORTATION
SALES STORE
P.O. BOX 3451
HARRISBURG, PENNSYLVANIA 17105-3451
TELEPHONE: (717)787-6746