

342 HARTMAN LA  
 343 CREEK RUN LA  
 344 LORI ANN CT  
 401 KATHY CT  
 402 POPLAR ST  
 403 NORTHFIELD DR  
 404 GREYSTONE DR  
 405 FIELDCREST DR  
 406 SPANGLER RD  
 407 TWENTYFIRST ST  
 408 FORNEY RD  
 409 PARK DR  
 410 MILL ST  
 411 ARCH ST  
 412 TWENTY SECOND ST  
 413 MEADOW LA  
 414 DAIRY RD  
 415 CHURCH RD  
 416 NINETEENTH ST  
 417 SHADOW CREEK DR  
 418 EIGHTEENTH ST  
 419 REIST RD  
 420 SEVENTEENTH ST  
 421 BRICKER LA  
 422 TWENTIEITH ST  
 423 WALNUT ST  
 424 WALNUT ST  
 425 CENTER ST  
 426 NORTHWEST DR  
 427 CHESTNUT ST  
 428 NORTH CORNWALL RD  
 429 WASHINGTON ST  
 430 MCARTHUR ST  
 431 QUITTAPAHILLA DR  
 432 HOFFER ST  
 433 LOCUST ST  
 434 SNITZ RD  
 435 HILL CREST RD  
 436 VILLAGE DR  
 437 CROOKED LA  
 438 RIDGEVIEW RD  
 439 CORNER STONE LA  
 440 ROYAL RD  
 441 ROCHERTY RD  
 442 MEADOWOOD CIR  
 443 OAK ST  
 444 TROON WAY  
 445 MILL LINK RD  
 446 QUAIL LA  
 447 NANCY LEE AV  
 448 TUDOR LA  
 449 WHEATFIELD LA  
 450 SIXTEENTH ST  
 451 PENN ST  
 452 MILLER ST  
 453 WHEATLAND CIR  
 454 REX AV  
 455 DAWSON ST  
 456 WOODLAND ST  
 457 CLOVER PL  
 458 TWENTY THIRD ST  
 459 RANCHO AV  
 460 HARVEY JOHN AV  
 461 MEYERLO LA  
 462 DAVIS LA  
 463 CLEONA BLVD  
 464 FISHER LA  
 465 ELM ST  
 466 STONELEIGH DR  
 467 WALDEN RD  
 468 WEST CRESTVIEW DR  
 469 SUMMIT ST  
 470 HAUCK ST  
 471 STONEBRIDGE DR  
 472 DAFFODIL DR  
 473 LILAC LA  
 474 WILSHIRE DR  
 475 STUART ST  
 476 CARLTON DR  
 477 MILLBRIDGE DR  
 478 CATHERINE CT  
 479 OAK KNOLL LA  
 480 MILL RD  
 481 OAK KNOLL CIR  
 482 WHITE OAK CIR  
 483 WHITE OAK CT  
 484 RAMBLEWOOD LA  
 485 LITTLE POND LA  
 486 WATERSIDE CIR  
 487 WATERSIDE CT  
 488 MEADOWVIEW CIR  
 489 CROSS CREEK CT  
 490 GLENWOOD LA  
 491 HEARTSIDE LA  
 493 GREYSTONE CS  
 600 HELEN DR  
 601 WATERFORD WAY  
 602 BENTLEY CT  
 661 UNION ST  
 662 ARBORVITAE ST  
 663 TUCK ST  
 664 SOUTH EIGHTH ST  
 665 KREISER ST  
 666 NOWLEN ST  
 669 WILHELM AV  
 670 COUNTRY CLUB VIEW DR  
 672 WEYMOUTH DR  
 673 MILLVIEW CT  
 674 VILLAGE CT  
 675 FURNACE CT  
 676 NORMAN DR  
 677 ISABEL DR  
 678 RUSSELL DR  
 679 TANGLEWOOD CT  
 680 CART WAY  
 681 CLUB TER  
 682 ON THE GREEN DR  
 683 ACORN DR  
 685 POND SIDE LA  
 686 BROOKSIDE LA  
 687 BROOKSIDE CIR  
 688 CREEKSIDE DR  
 689 FARMSTEAD LANE EXT  
 690 FARMSTEAD LA  
 691 FARMSTEAD CIR  
 692 NORTHWOOD CT  
 693 ACORN CT  
 700 JUNIPER ST  
 701 AUBREY AV  
 702 WHITNEY WAY

TOTAL MILES	
Township Road System	46.38*
State Highway System	8.82
Total	55.20

\* Includes ACT 32 Turnback Mileage of 9.02

POPULATION 8,489  
 (2020 Census)

LEGEND

- LIMITED ACCESS HIGHWAY
- STATE ROUTE AND NUMBER
- STATE MAINTAINED BRIDGE ON TOWNSHIP ROAD
- TOWNSHIP ROAD, NUMBER AND SEGMENT LENGTH IN MILES
- IMPASSABLE TOWNSHIP ROAD
- TURNBACK TOWNSHIP ROAD
- OTHER ROAD
- RAILROAD (IN SERVICE)
- RAILROAD ABANDONED (TRACK RETAINED)
- STATE BOUNDARY
- COUNTY BOUNDARY
- TOWNSHIP BOUNDARY
- CITY OR BOROUGH BOUNDARY
- MUNICIPAL BUILDING
- SPLIT MILEAGE BETWEEN MUNICIPALITIES

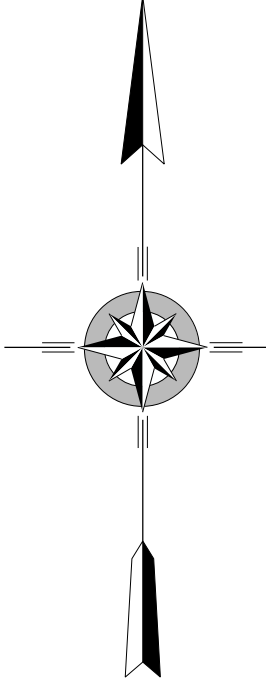
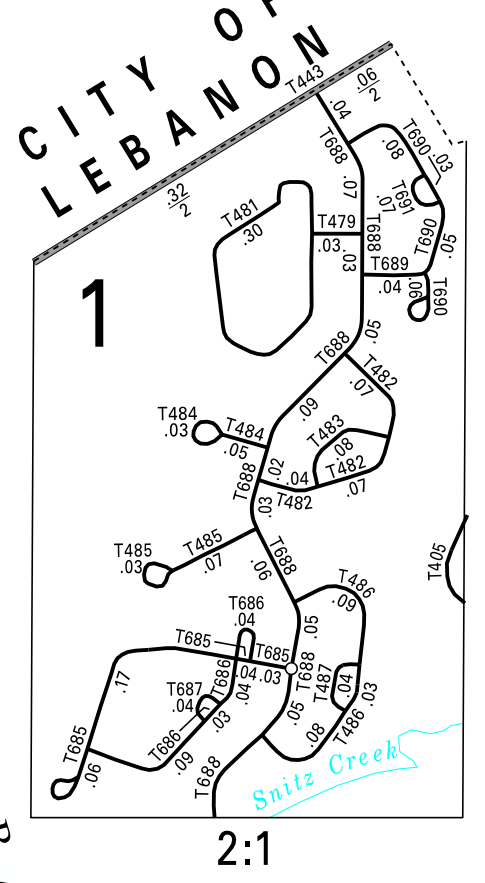
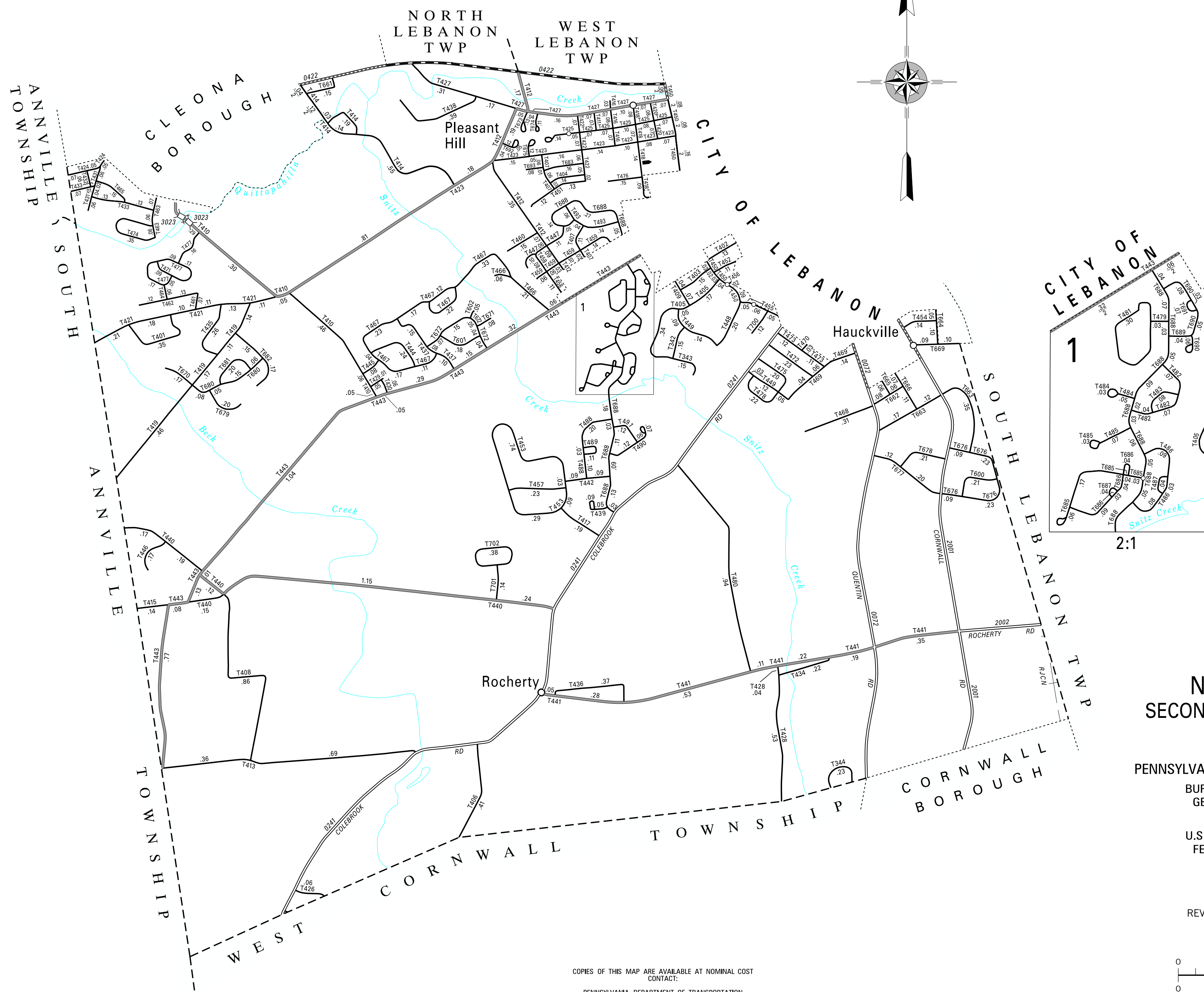

NORTH CORNWALL  
 SECOND CLASS TOWNSHIP MAP  
 LEBANON COUNTY

PREPARED BY THE  
 PENNSYLVANIA DEPARTMENT OF TRANSPORTATION  
 BUREAU OF PLANNING AND RESEARCH  
 GEOGRAPHIC INFORMATION DIVISION  
 IN COOPERATION WITH THE  
 U.S. DEPARTMENT OF TRANSPORTATION  
 FEDERAL HIGHWAY ADMINISTRATION  
 MUNICIPAL CODE 38 208  
 THIS MAP IS PUBLISHED AS A SUPPLEMENTAL  
 DOCUMENTATION OF LIQUID FUELS TAX FUND MILEAGES  
 REVISED PER FORM 990 DATED 9-12-23

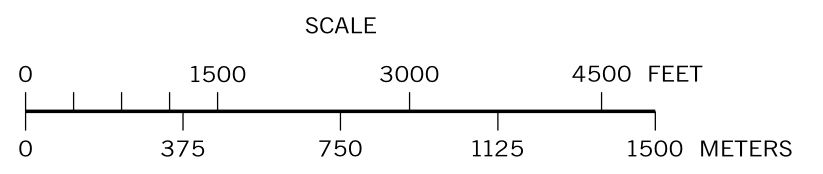

COPIES OF THIS MAP ARE AVAILABLE AT NOMINAL COST  
 CONTACT:  
 PENNSYLVANIA DEPARTMENT OF TRANSPORTATION  
 SALES STORE  
 P.O. BOX 3451  
 HARRISBURG, PENNSYLVANIA 17105-3451  
 TELEPHONE: (717)787-6746