

310 ROUND BARN RD
 311 TEXTER MISSION RD
 313 TEXTER MOUNTAIN RD
 315 COCALICO RD
 317 EAGLES PEAK RD
 355 HACKMAN RD
 359 MEADOW DR
 360 OVERLOOK LA
 361 BETHANY RD
 362 STRICKERSTOWN RD
 363 HOGELAND RD
 364 STRICKERSTOWN LOOP RD
 365 MEMORIAL BLVD
 366 CARDINAL RD
 367 ALUMNI AV
 368 CHERRY LA
 371 CHURCH RD
 373 MARTINS RD
 375 BRICK PLANT RD
 449 GARDEN DR
 600 CHAPEL RD
 601 PERRI AV
 602 RHINE RD
 603 HOWAM ST
 604 DIERWECHTER RD
 605 EVERGREEN WY
 607 STUMP RD
 608 ROD AND GUN RD
 610 RICHLAND RD
 612 KRUMSTOWN RD
 616 SETHERB RD
 620 KALBACH RD
 621 STATION RD
 626 FORT ZELLERS RD
 629 COLVERT RD
 630 STOUCHSBURG RD
 632 SOUTH MOUNTAIN RD
 634 PARISH AV
 635 ASH RD
 639 WOLF ST
 640 SONNENS RD
 643 PARK ST
 644 PEACH ST
 645 CENTRAL DR
 646 MAPLE ST
 647 COTTAGE LA
 648 PINE ST
 650 NEWBURG DR
 651 TREELINE DR
 652 VILLAGE DR
 653 ABBEY LA
 654 PROGRESS DR
 655 EDMONT LA
 660 MORGAN DR
 661 HILLSIDE DR
 662 EAGLE VIEW DR
 663 SWEETWATER LA
 665 LESTER LA

COPIES OF THIS MAP ARE AVAILABLE AT NOMINAL COST
 CONTACT:
 PENNSYLVANIA DEPARTMENT OF TRANSPORTATION
 SALES STORE
 P.O. BOX 3451
 HARRISBURG, PENNSYLVANIA 17105-3451
 TELEPHONE: (717)787-6746

TOTAL MILES	
Township Road System	37.31
State Highway System	18.23
Total	55.54

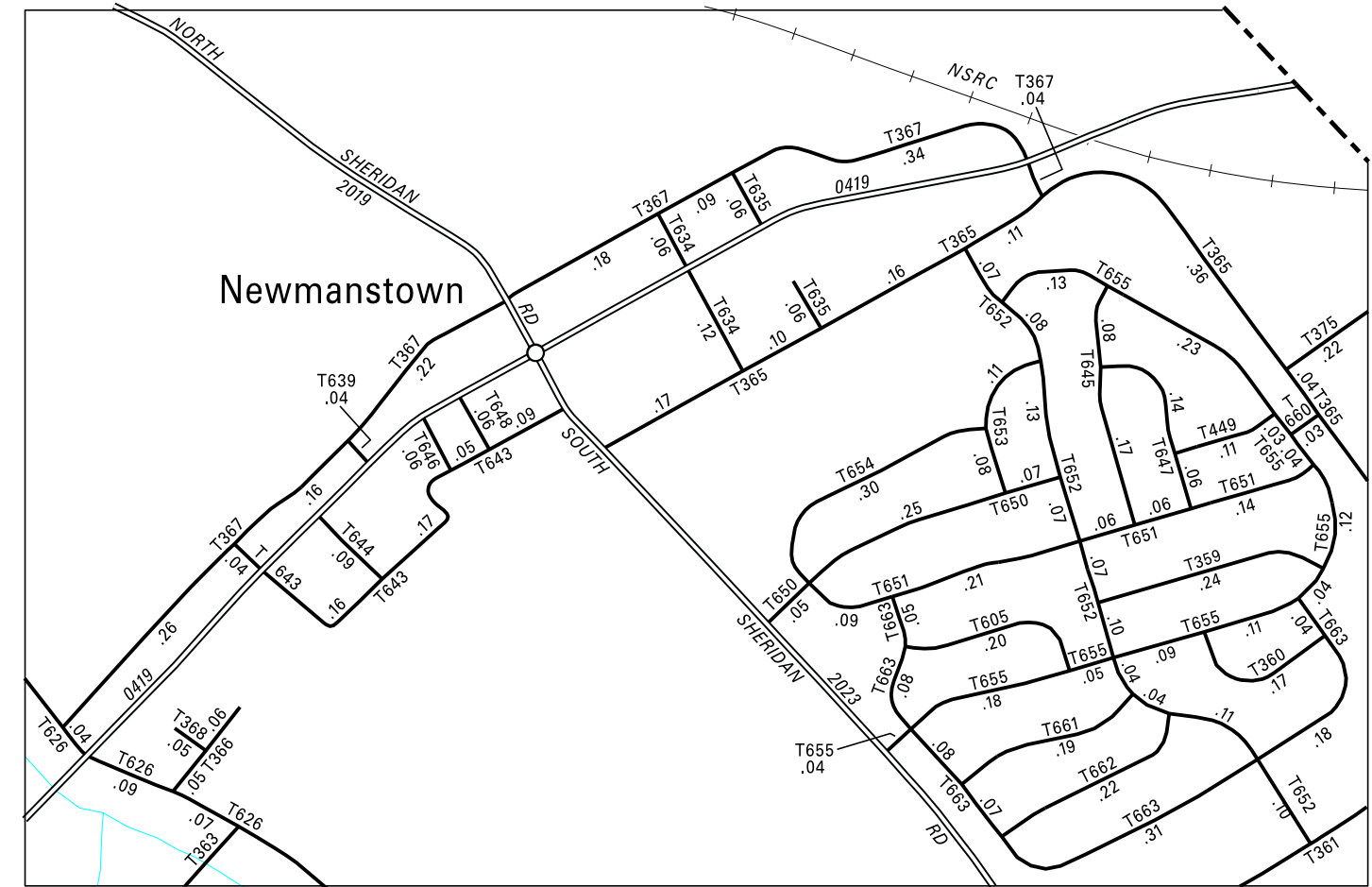
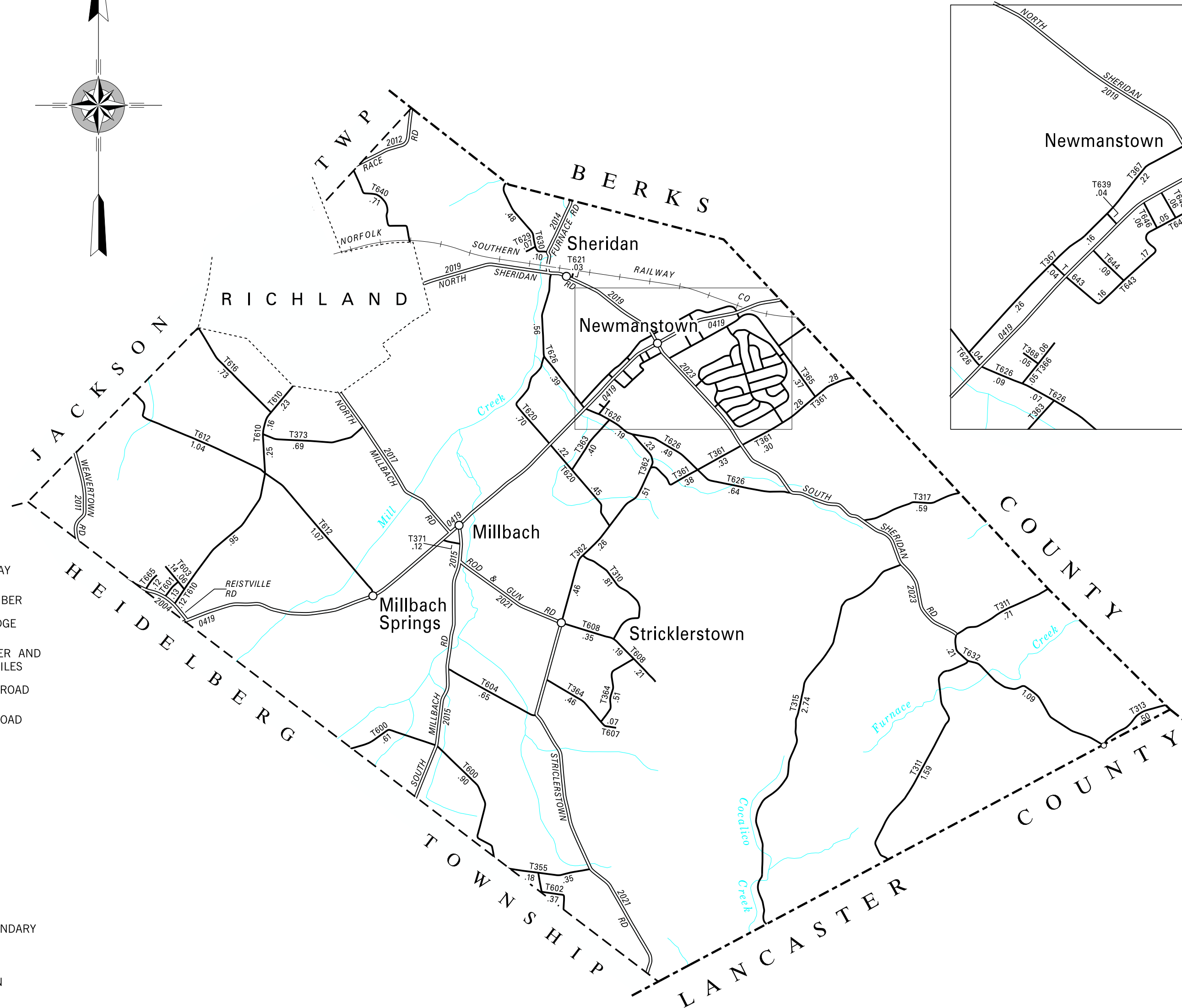
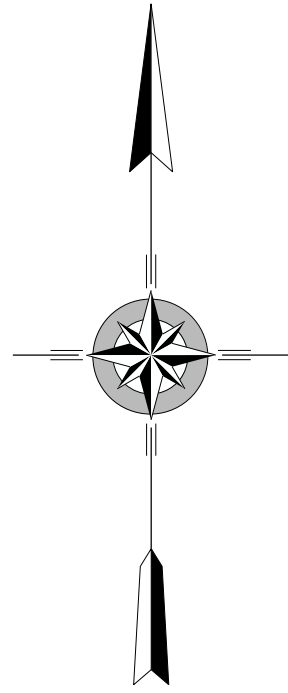

3:1

LEGEND

- LIMITED ACCESS HIGHWAY
- STATE ROUTE AND NUMBER
- STATE MAINTAINED BRIDGE ON TOWNSHIP ROAD
- TOWNSHIP ROAD, NUMBER AND SEGMENT LENGTH IN MILES
- IMPASSABLE TOWNSHIP ROAD
- TURNBACK TOWNSHIP ROAD
- OTHER ROAD
- RAILROAD (IN SERVICE)
- RAILROAD ABANDONED (TRACK RETAINED)
- STATE BOUNDARY
- COUNTY BOUNDARY
- TOWNSHIP BOUNDARY
- CITY OR BOROUGH BOUNDARY
- MUNICIPAL BUILDING
- SPLIT MILEAGE BETWEEN MUNICIPALITIES

**MILLCREEK
 SECOND CLASS TOWNSHIP MAP
 LEBANON COUNTY**

PREPARED BY THE
PENNSYLVANIA DEPARTMENT OF TRANSPORTATION

BUREAU OF PLANNING AND RESEARCH
 GEOGRAPHIC INFORMATION DIVISION

IN COOPERATION WITH THE
**U.S. DEPARTMENT OF TRANSPORTATION
 FEDERAL HIGHWAY ADMINISTRATION**

MUNICIPAL CODE 38 206

THIS MAP IS PUBLISHED AS A SUPPLEMENTAL
 DOCUMENTATION OF LIQUID FUELS TAX FUND MILEAGES
 REVISED PER FORM 990 DATED 3-16-22

