

TOTAL MILES	
Township Road System	12.09
State Highway System	8.29
Total	20.38

POPULATION 989  
(2020 Census)

**LEGEND**

- LIMITED ACCESS HIGHWAY
- STATE ROUTE AND NUMBER
- STATE MAINTAINED BRIDGE ON TOWNSHIP ROAD
- TOWNSHIP ROAD, NUMBER AND SEGMENT LENGTH IN MILES
- IMPASSABLE TOWNSHIP ROAD
- TURNBACK TOWNSHIP ROAD
- OTHER ROAD
- RAILROAD (IN SERVICE)
- RAILROAD ABANDONED (TRACK RETAINED)
- STATE BOUNDARY
- COUNTY BOUNDARY
- TOWNSHIP BOUNDARY
- CITY OR BOROUGH BOUNDARY
- MUNICIPAL BUILDING
- SPLIT MILEAGE BETWEEN MUNICIPALITIES

- 328 GRAHAM AV
- 330 RIVER RD
- 377 SAND BANK RD
- 411 OAKLAND RD
- 414 OWAC RD
- 429 MANSFIELD ST
- 431 ENGLISH HOLLOW RD
- 434 MARTHA ST
- 436 OLD CHEWTON RD
- 496 CENTER AV
- 498 THIRD ST
- 499 SECOND ST
- 500 FOURTH ST
- 502 FIFTH ST
- 504 SIXTH ST
- 506 EIGHTH ST
- 507 LAWRENCE AV
- 508 NINTH ST
- 509 ROOSEVELT AV
- 510 TENTH ST
- 512 ELEVENTH ST
- 514 TWELFTH ST
- 515 CHARLEMONT AV
- 516 THIRTEENTH ST
- 518 FOURTEENTH ST
- 520 FIFTEENTH ST
- 522 SEVENTH ST

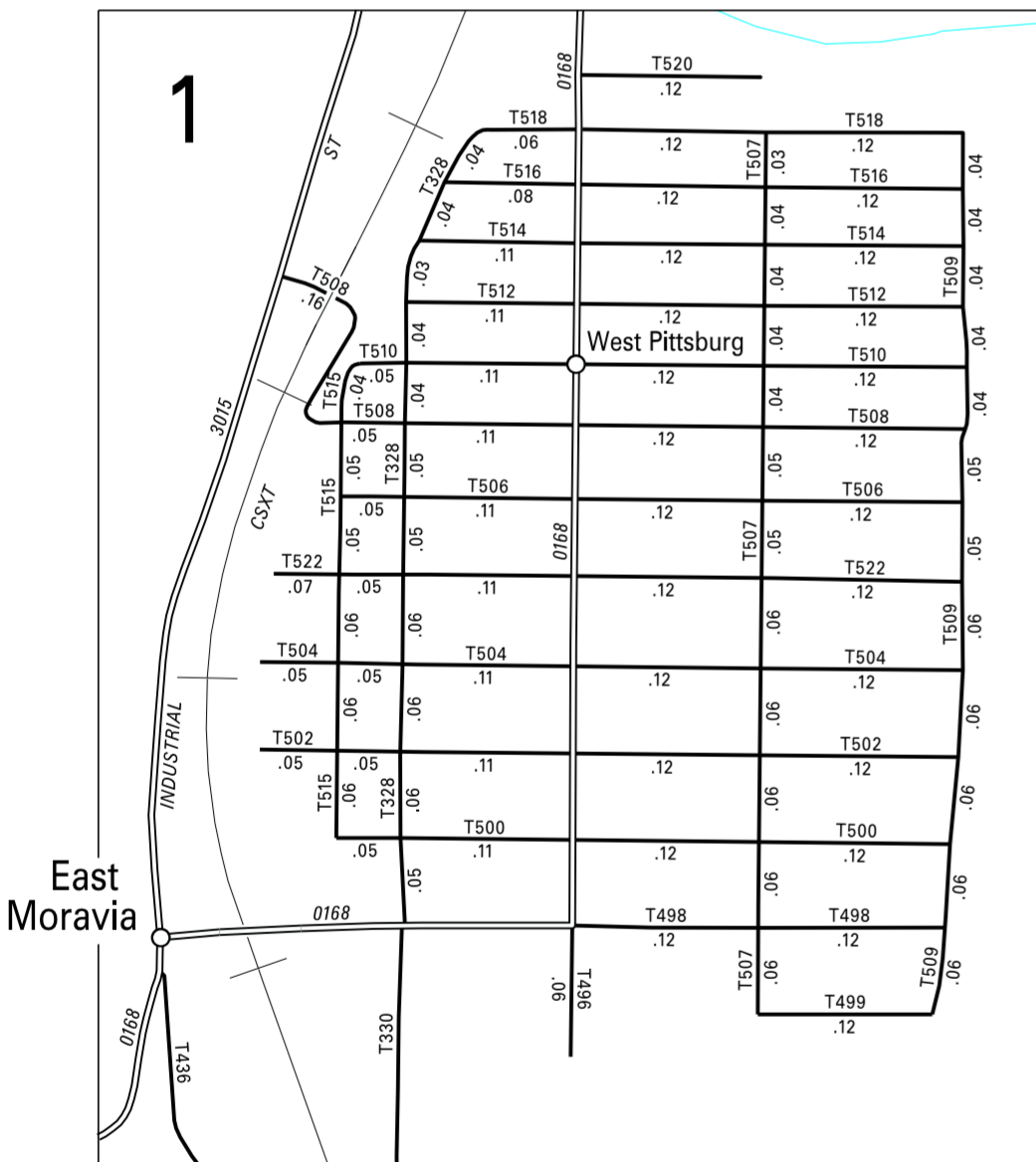
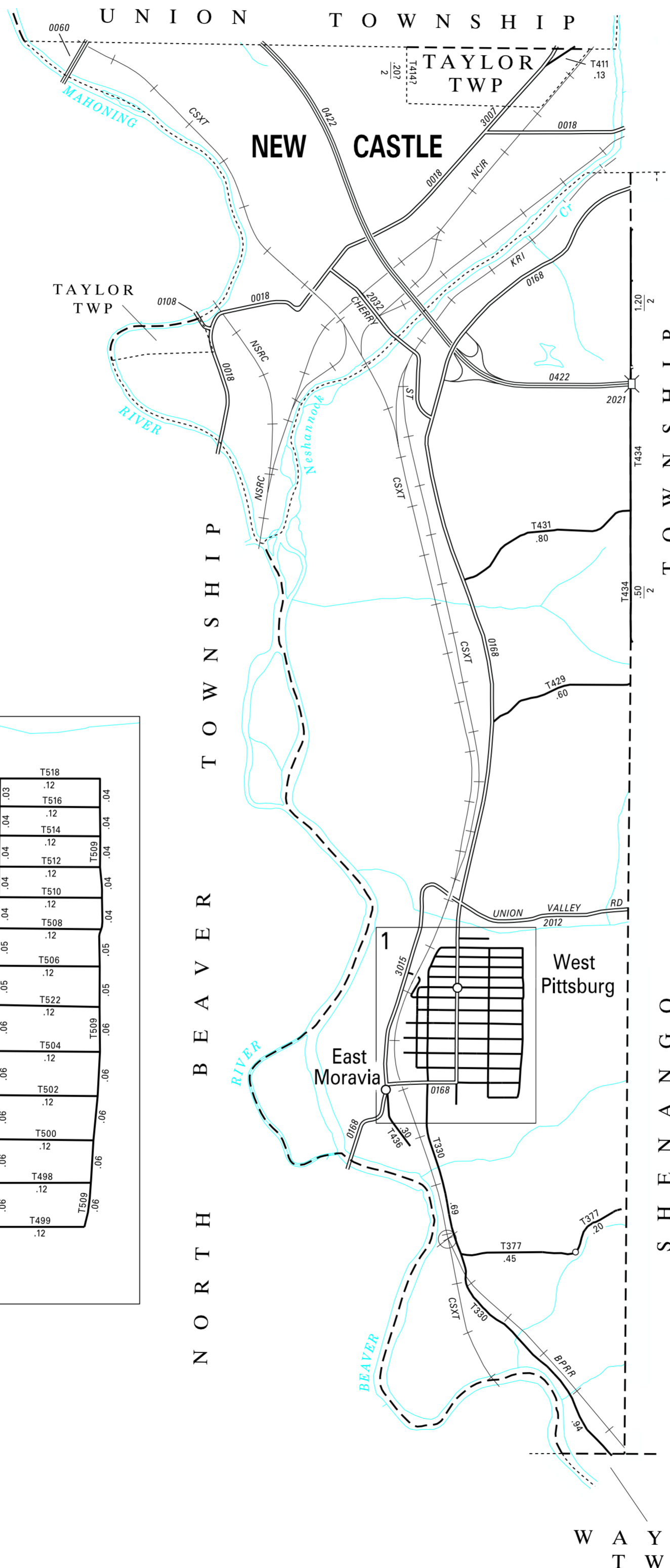

3:1

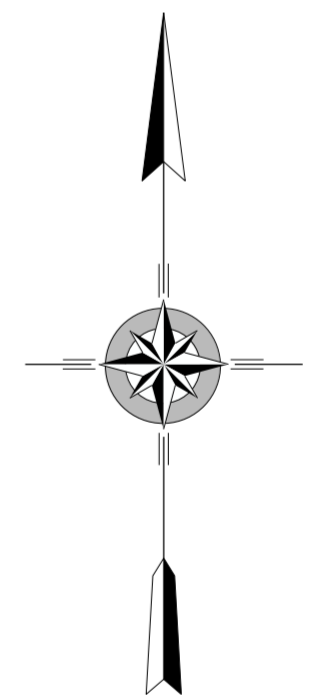

**TAYLOR  
SECOND CLASS TOWNSHIP MAP  
LAWRENCE COUNTY**

PREPARED BY THE  
**PENNSYLVANIA DEPARTMENT OF TRANSPORTATION**  
BUREAU OF PLANNING AND RESEARCH  
GEOGRAPHIC INFORMATION DIVISION  
IN COOPERATION WITH THE  
U.S. DEPARTMENT OF TRANSPORTATION  
FEDERAL HIGHWAY ADMINISTRATION

MUNICIPAL CODE 37 213

THIS MAP IS PUBLISHED AS A SUPPLEMENTAL  
DOCUMENTATION OF LIQUID FUELS TAX FUND MILEAGES  
REVISED PER FORM 990 DATED 3-15-96

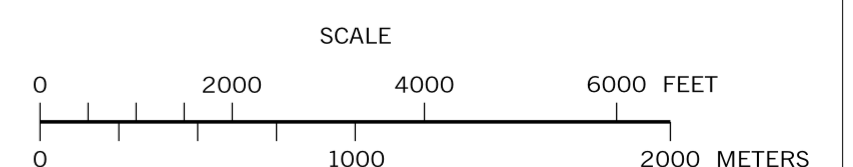

COPIES OF THIS MAP ARE AVAILABLE AT NOMINAL COST  
CONTACT:

PENNSYLVANIA DEPARTMENT OF TRANSPORTATION  
SALES STORE  
P.O. BOX 3451  
HARRISBURG, PENNSYLVANIA 17105-3451  
TELEPHONE: (717)787-6746