

TOTAL MILES	
Township Road System	30.32
State Highway System	25.88
Total	56.20

**LEGEND**

- LIMITED ACCESS HIGHWAY
- STATE ROUTE AND NUMBER
- STATE MAINTAINED BRIDGE ON TOWNSHIP ROAD
- TOWNSHIP ROAD, NUMBER AND SEGMENT LENGTH IN MILES
- IMPASSABLE TOWNSHIP ROAD
- OTHER ROAD
- RAILROAD (IN SERVICE)
- RAILROAD ABANDONED (TRACK RETAINED)
- STATE BOUNDARY
- COUNTY BOUNDARY
- TOWNSHIP BOUNDARY
- CITY OR BOROUGH BOUNDARY
- MUNICIPAL BUILDING
- SPLIT MILEAGE BETWEEN MUNICIPALITIES

SUSQUEHANNA COUNTY

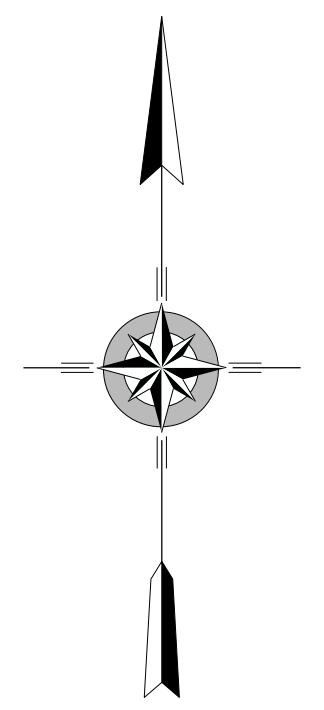
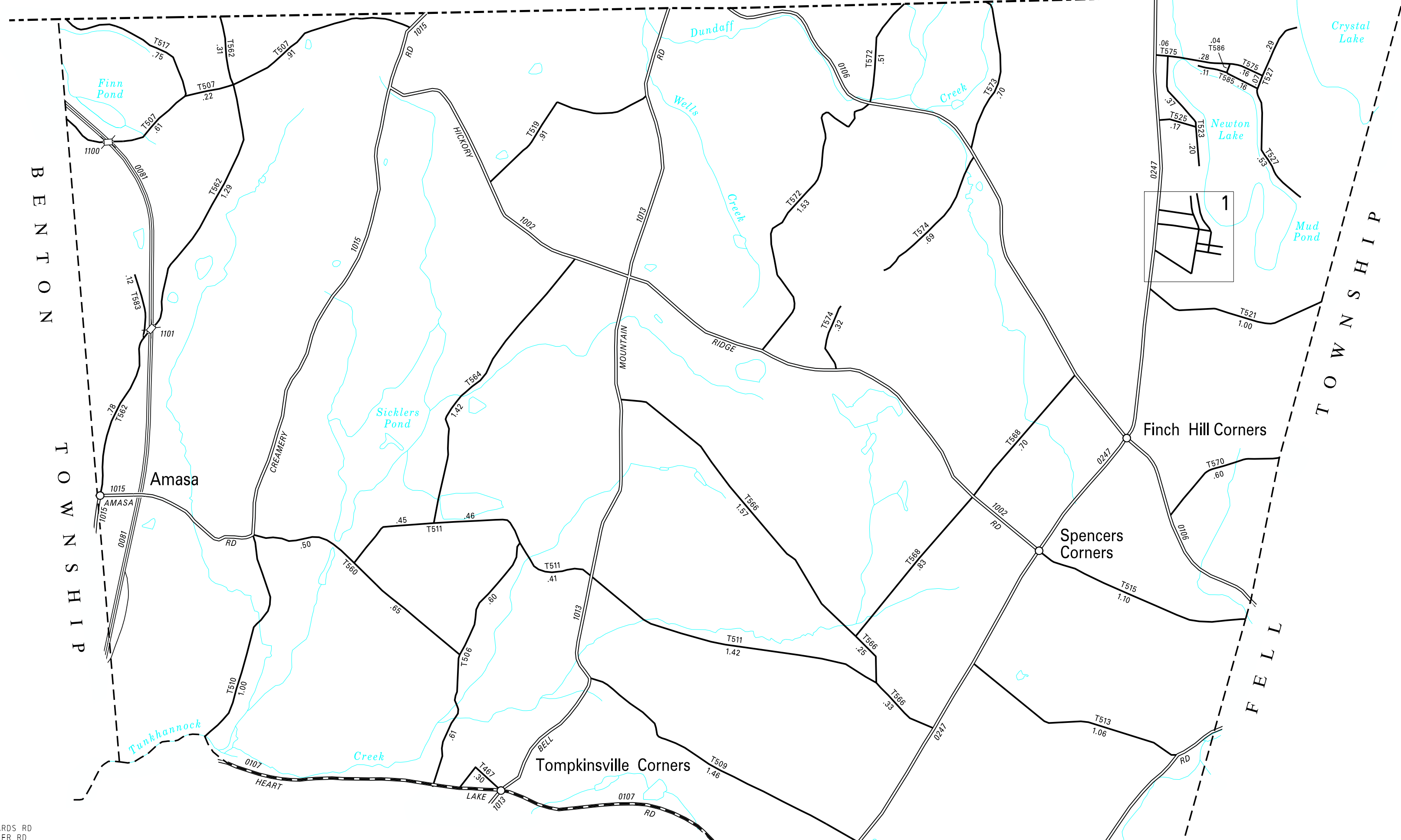

**GREENFIELD  
SECOND CLASS TOWNSHIP MAP  
LACKAWANNA COUNTY**

PREPARED BY THE  
PENNSYLVANIA DEPARTMENT OF TRANSPORTATION  
BUREAU OF PLANNING AND RESEARCH  
GEOGRAPHIC INFORMATION DIVISION  
IN COOPERATION WITH THE  
U.S. DEPARTMENT OF TRANSPORTATION  
FEDERAL HIGHWAY ADMINISTRATION  
MUNICIPAL CODE 35 209

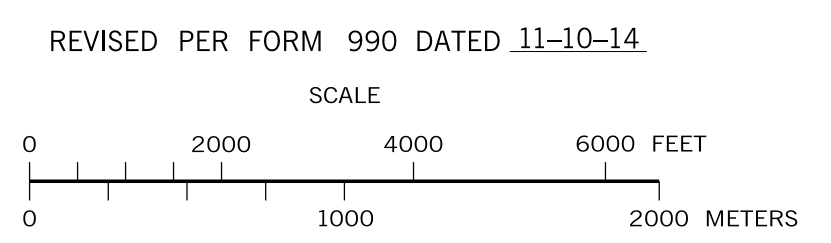

- 467 EDWARDS RD
- 505 MILLER RD
- 506 OPEIL RD
- 507 SPEDDING RD
- 508 WILLARD RD
- 509 WHITE RD
- 510 STILL MEADOW RD
- 511 SICKLER POND RD
- 513 PETRILAK LA
- 515 HICKORY RIDGE RD
- 517 MATTS RD
- 519 WELLS RD
- 521 PIERCE RD
- 522 FRANKLIN AV
- 523 SUNSET AV
- 525 SUNSET ST
- 527 SHADYSIDE DR
- 560 WATTS RD
- 562 NORTH CHURCH RD
- 564 TELEP RD
- 566 ARNOLD RD
- 568 POOR FARM RD
- 570 SHUST RD
- 572 LEE RD
- 573 FLOSSIE RD
- 574 MAILE RD
- 575 LAKEVIEW AV
- 576 WASHINGTON ST
- 577 WAGNER BLVD
- 579 LAKE AV
- 580 LOLIAN RD
- 581 RUTHLAND AV
- 583 TRANS AMERICAN RD
- 584 MORGAN ST
- 585 WILLOW AV
- 586 HANNON AV

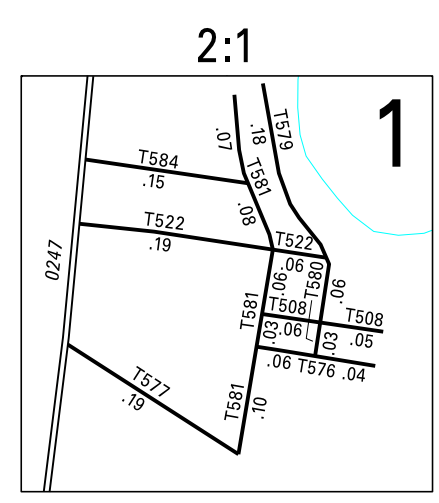

(RECREATED BY GSP 8-11-00) (REVISED: 1-5-15)