

LEGEND

- LIMITED ACCESS HIGHWAY
- STATE ROUTE AND NUMBER
- STATE MAINTAINED BRIDGE ON TOWNSHIP ROAD
- TOWNSHIP ROAD, NUMBER AND SEGMENT LENGTH IN MILES
- IMPASSABLE TOWNSHIP ROAD
- TURNBACK TOWNSHIP ROAD
- OTHER ROAD
- RAILROAD (IN SERVICE)
- RAILROAD ABANDONED (TRACK RETAINED)
- STATE BOUNDARY
- COUNTY BOUNDARY
- TOWNSHIP BOUNDARY
- CITY OR BOROUGH BOUNDARY
- MUNICIPAL BUILDING
- SPLIT MILEAGE BETWEEN MUNICIPALITIES

- 201 SUNSET DR
- 549 MAGNOLIA RD
- 561 ASH RD
- 562 ALMOND RD
- 563 RAILROAD ST
- 564 TEDDY ST
- 565 BEECH RD
- 569 PINE RD
- 570 CEDAR RD
- 571 WALNUT RD
- 573 LINDEN RD
- 574 ASPEN RD
- 575 SUMAC RD
- 577 MAPLE RD
- 579 ELM RD
- 639 STITT RD
- 641 LAUREL RD
- 643 BIRCH RD
- 644 BARR RD
- 645 SPRUCE RD
- 647 BUTTERNUT RD
- 649 HARKEL RD
- 651 APPLE RD
- 653 BUCK RUN RD
- 655 HICKORY RD
- 661 RHODODENDRON ST
- 662 PARKER ST
- 663 SHORT ST
- 664 COE AV
- 670 POPLAR RD
- 677 HAZELT RD
- 678 LEROY RD
- 679 WILLOW RD
- 680 LOCUST RD
- 700 TEAK ST
- 703 OLIVE ST
- 704 REDBUD ST
- 730 TULIP ST
- 760 YEM RD
- 774 QUINCE RD
- 776 FIR RD
- 778 COTTONWOOD RD
- 780 BLACKBERRY LA
- 782 RASPBERRY RD
- 830 HAZLENU RD
- 831 CITY ST
- 832 VANDERBILT ST
- 834 BALSAM RD
- 835 PEAR RD
- 837 HARTMAN RD
- 847 LARCH RD
- 850 CHESTNUT RD
- 852 SMITH ST
- 854 HOLLY RD
- 855 DOUGLAS ST
- 856 MUSSEY ST
- 857 FISHER ST
- 858 CYPRESS RD
- 859 HERRIMAN ST
- 860 BLUEBERRY ST
- 863 LIGHTHOUSE RD
- 864 LOVEJOY RD
- 865 TWOLICK HILL RD
- 914 PALM RD
- 916 ALDER RD
- 917 REDWOOD RD
- 918 MULBERRY RD
- 920 JUNIPER RD
- 921 CHERRY RD
- 922 HAWTHORNE RD
- 923 ZENITH RD
- 924 DOGWOOD RD
- 926 ACORN RD
- 928 HEMLOCK RD
- 929 RICE RD
- 930 CHURCH HILL RD
- 970 SYCAMORE RD

POPULATION 3,414
(2020 Census)

TOTAL MILES
Township Road System 66.26*
State Highway System 65.90
Total 132.16

* Includes ACT 32 Turnback Mileage of 0.10

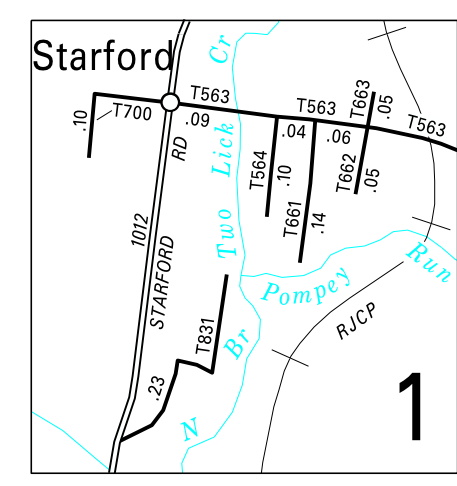
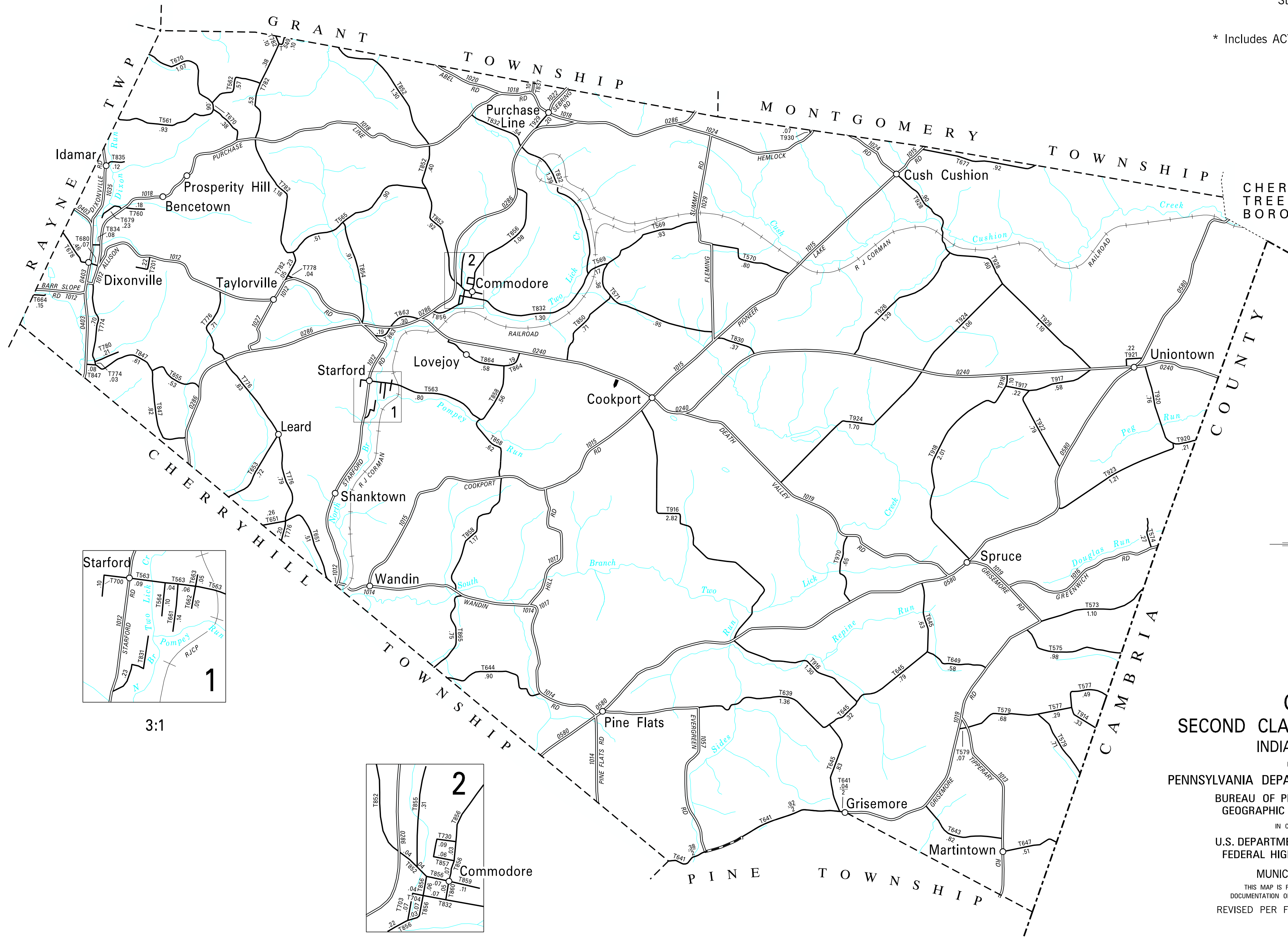

3:1

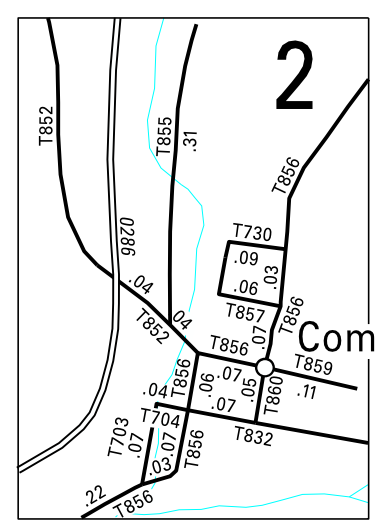

3:1

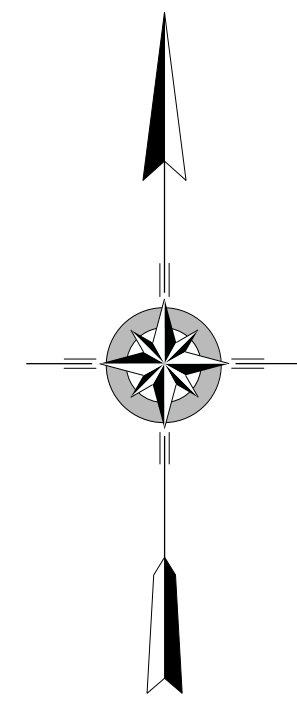

**GREEN
SECOND CLASS TOWNSHIP MAP
INDIANA COUNTY**

PREPARED BY THE
PENNSYLVANIA DEPARTMENT OF TRANSPORTATION
BUREAU OF PLANNING AND RESEARCH
GEOGRAPHIC INFORMATION DIVISION
IN COOPERATION WITH THE
U.S. DEPARTMENT OF TRANSPORTATION
FEDERAL HIGHWAY ADMINISTRATION
MUNICIPAL CODE 32 214
THIS MAP IS PUBLISHED AS A SUPPLEMENTAL
DOCUMENTATION OF LIQUID FUELS TAX FUND MILEAGES
REVISED PER FORM 990 DATED 12-2-20

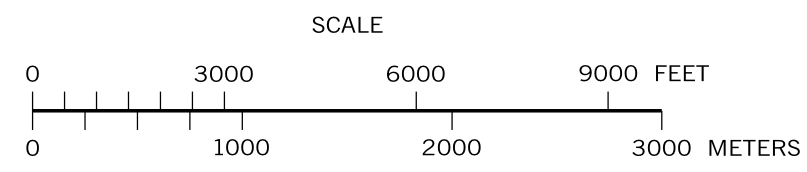

COPIES OF THIS MAP ARE AVAILABLE AT NOMINAL COST CONTACT:

PENNSYLVANIA DEPARTMENT OF TRANSPORTATION
SALES STORE
P.O. BOX 3451
HARRISBURG, PENNSYLVANIA 17105-3451
TELEPHONE: (717)767-6746