

TOTAL MILES  
 Township Road System 56.21\*  
 State Highway System 26.18  
 Total 82.39

POPULATION 5,079  
 (2020 Census)

\* Includes ACT 32 Turnback Mileage of 5.44

LEGEND

- LIMITED ACCESS HIGHWAY
- STATE ROUTE AND NUMBER
- STATE MAINTAINED BRIDGE ON TOWNSHIP ROAD
- TOWNSHIP ROAD, NUMBER AND SEGMENT LENGTH IN MILES
- - - IMPASSABLE TOWNSHIP ROAD
- TURNBACK TOWNSHIP ROAD
- OTHER ROAD
- RAILROAD (IN SERVICE)
- RAILROAD ABANDONED (TRACK RETAINED)
- - - STATE BOUNDARY
- - - COUNTY BOUNDARY
- - - TOWNSHIP BOUNDARY
- - - CITY OR BOROUGH BOUNDARY
- MUNICIPAL BUILDING
- SPLIT MILEAGE BETWEEN MUNICIPALITIES

- 324 CORA WAY
- 325 SPRINGFIELD HOLLOW RD
- 326 SIMPSON RD
- 327 INDIANA ST
- 328 BELL ST
- 329 SANTA AV
- 330 RAILROAD ST
- 331 CIRCLE ST
- 332 CYNTHIA ST
- 333 FRONT (THOMPSON) ST
- 334 HILL (THOMPSON) ST
- 335 COAL ST
- 336 HIGH (THOMPSON) ST
- 337 DEARTH ST
- 338 LAUREN HILL RD
- 339 WEST ST
- 340 EAST (HERBERT) ST
- 341 NORTH (HERBERT) ST
- 342 TROCK ST
- 343 BRAZNEEL RD
- 344 CENTER GAS RD
- 345 MILLER RD
- 346 OLD ROYAL RD
- 347 CLOVER ST
- 348 AIR SHAFT RD
- 349 HAYLES ST
- 350 PINE (BRAZNEEL) ST
- 351 MAIN (ROWES RUN) ST
- 352 SHORT CUT ST
- 353 MAGAZINE LUMBER RD
- 354 HARD RD
- 355 PATTERSON RD
- 356 DAVIS ST
- 357 TREE FARM RD
- 358 VIEW ST
- 359 GREEN ST
- 360 SCARBOROUGH ST
- 361 ABIGAIL ST
- 362 MOTORCYCLE RD
- 363 SHARP RD
- 364 LEGION STREET EXT
- 365 COLONIA, AV
- 366 SHORT (ROWES RUN) ST
- 367 RED HILL RD
- 368 HILLTOP AV
- 369 CIRCLE (ROWES RUN) ST
- 370 PARK ST
- 371 HILL (HERBERT) ST
- 378 SEATONTOWN RD
- 380 GREEN ST
- 381 VESTA ST
- 382 SCHOOL (REPUBLIC) ST
- 383 NORTH (REPUBLIC) ST
- 384 DUNLAP ST
- 385 VAN KIRK ST
- 390 BUNKER HILL RD
- 412 JANA LA
- 422 DAVIDSON RD
- 423 SPERS RD
- 442 COLVIN RUN RD
- 443 COLVIN RUN SPUR
- 445 SHUFF RIDGE RD
- 450 FOX RIDGE RD
- 451 HARTFIELD RD
- 452 NEACMER RD
- 484 TIPPECANOE RD
- 551 RODERICK RD
- 555 OLD ROUTE RD
- 559 UNION ST
- 561 MAIN (REPUBLIC) ST
- 562 FAIRCOURT ST
- 565 REDSTONE ST
- 567 EAGLE ST
- 568 MAIN (BRIER HILL) ST
- 570 HILL (BRIER HILL) ST
- 571 STEEL ST
- 572 MIDDLE ST
- 573 JACKSON RD
- 574 SPRING ST
- 575 FARET ST
- 576 SHORT ST
- 577 STATE ST
- 578 REPUBLIC ST
- 579 MARBLE TER
- 581 HILL ST
- 583 CHESTNUT TREE RD
- 584 BLACK OAK RD
- 585 SHAGBARK RD
- 586 FINE CHERRY RD
- 587 BANK ST
- 588 GREGORY CIR
- 589 ANNA REAL ST
- 601 COPPERS ST
- 603 CLIFTON AV
- 604 CHES ST
- 605 DAVIDSON SIDING RD
- 606 CENTER (FAIRBANK) ST
- 607 MILLER AV
- 608 PINE ST
- 609 SECOND (FILBERT) ST
- 610 OAK (FILBERT) ST
- 611 PALA AV
- 612 FIFTH (FILBERT) ST
- 613 BRIDGE ST
- 614 THIRD (FILBERT) ST
- 618 MOUNTAIN VIEW DR
- 620 MAIN HILLS RD
- 623 STONE CHURCH RD
- 625 GARDEWAY DR
- 630 RECREATION DR
- 700 FIFTH (TOWER) ST
- 702 FIRST (TOWER) ST
- 703 FOURTH (TOWER) ST
- 705 SIXTH (TOWER) ST
- 707 THIRD (TOWER) ST
- 709 SECOND (TOWER) ST
- 725 ALLISON RD
- 726 WALL ST
- 729 BRADWAY ST
- 730 FIRST (ALLISON) ST
- 732 MAIN (ALLISON) ST
- 733 MONVIEW AV
- 734 WALEIGH ST
- 735 LEGION ST
- 736 SECOND (ALLISON) ST
- 737 JOHNSON ST
- 738 THIRD (ALLISON) ST
- 740 CHURCH ST
- 741 McCLAIN ST
- 742 PENNSYLVANIA AV
- 743 ROLLE ST
- 744 HEMPSTEAD AV
- 745 PENN ST
- 746 ANNES ST
- 747 EDNA ST
- 748 KENNEDY ST
- 750 ORIENT MAIN ST
- 751 MOORE ST
- 752 MAIN ST
- 754 THOMAS AV
- 755 THOMAS ST
- 756 HIGH ST
- 760 FIRST (ROWES RUN) ST
- 761 LOCUST ST
- 762 SECOND (ROWES RUN) ST
- 763 MAPLE ST
- 764 THIRD (ROWES RUN) ST
- 765 OAK (ROWES RUN) ST
- 766 FOURTH (ROWES RUN) ST
- 767 WALNUT ST
- 768 FIFTH (ROWES RUN) ST
- 769 HICKORY ST
- 770 SIXTH (ROWES RUN) ST
- 771 CHESTNUT ST
- 772 HILLSIDE AV
- 773 MAPLE TERRACE AV
- 774 CENTER (GRINDSTONE) ST
- 775 GRINDSTONE AV
- 776 FRONT (GRINDSTONE) ST
- 777 VOLK AV
- 778 SECOND ST
- 780 FIRST ST
- 781 FILBERT HEIGHTS RD
- 915 PARK ST
- 916 HILL (REPUBLIC) ST
- 948 PLATEAU BLVD
- 950 MAIN (CARDALE) ST
- 968 SCHOOL (CHESTNUT RIDGE) ST
- 970 MAIN (CHESTNUT RIDGE) ST
- 972 FOURTH (CHESTNUT RIDGE) ST
- 979 THIRD (CHESTNUT RIDGE) ST
- 980 KASOR LA
- 981 SECOND (CHESTNUT RIDGE) ST
- 982 EAST ST
- 983 FIRST (CHESTNUT RIDGE) ST
- 984 EAST ST
- 987 HIGH (CARDALE) ST
- 989 OAK ST
- 990 LINDALE RD
- 991 FIFTH (CARDALE) ST
- 992 FOURTH (CARDALE) ST
- 993 THIRD (CARDALE) ST
- 994 SECOND (CARDALE) ST
- 998 ROBERTS RD

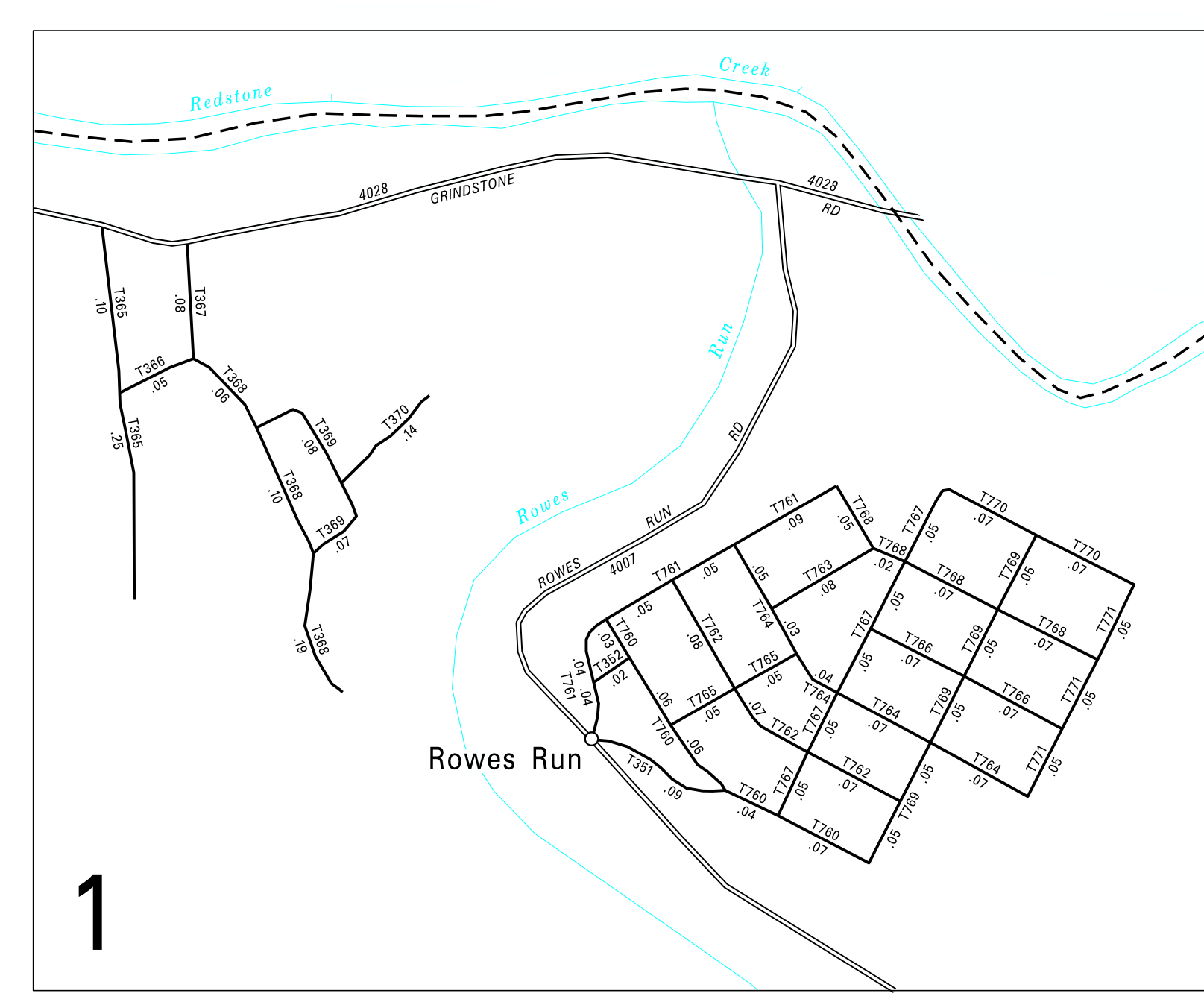
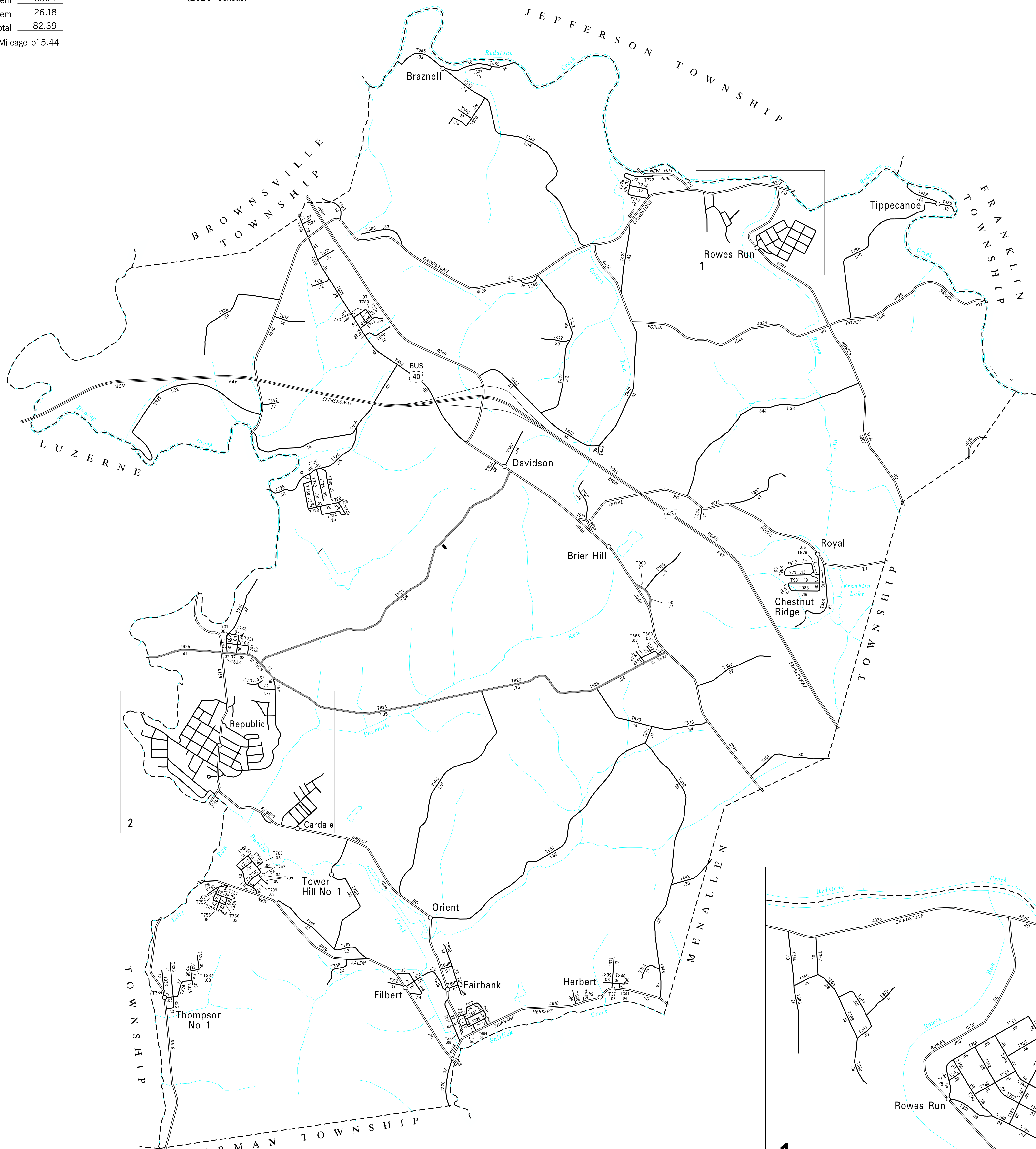

3:1

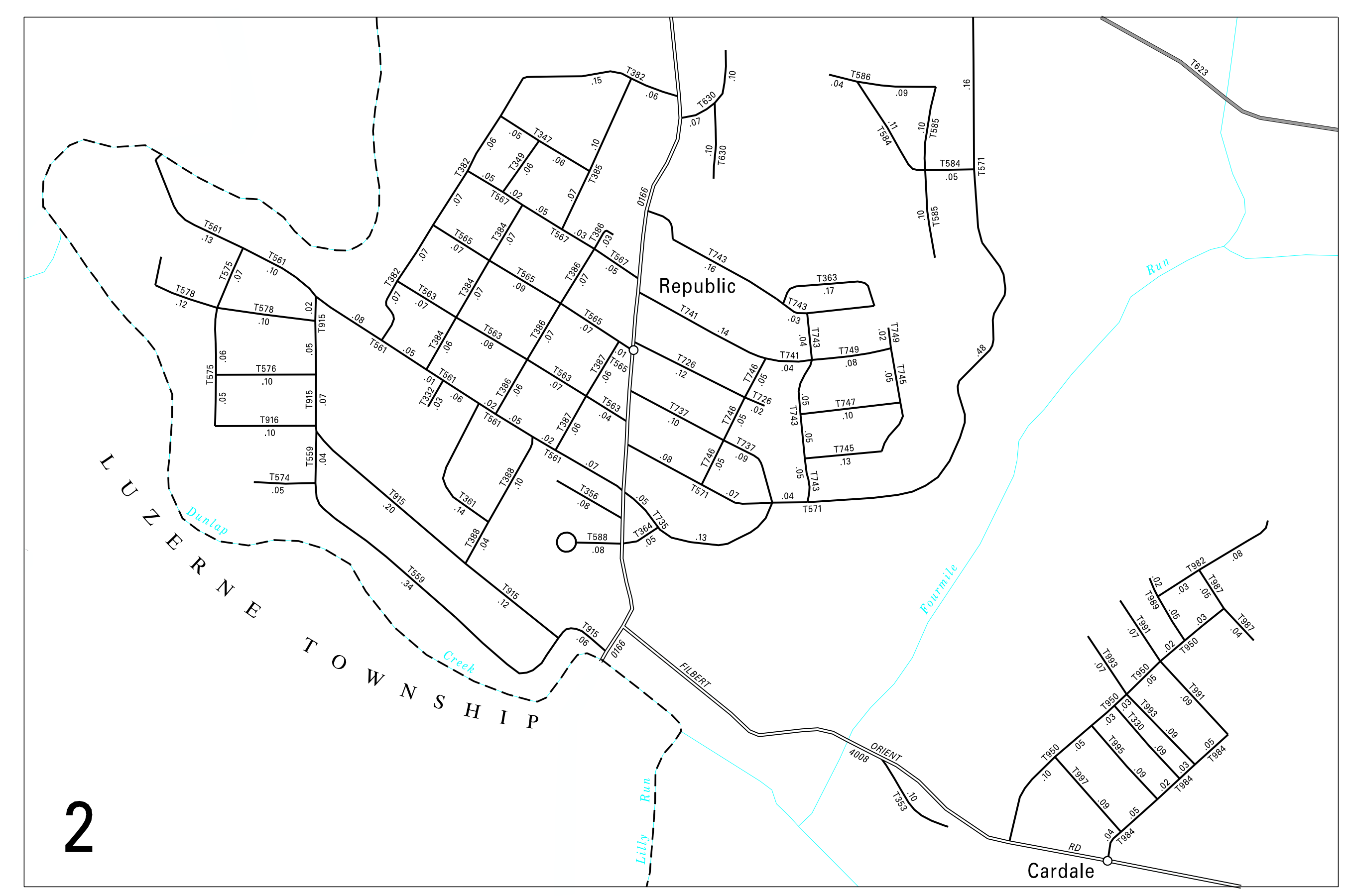

3:1

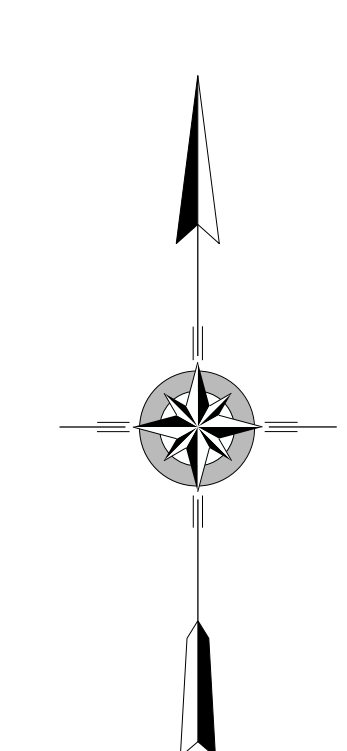

REDSTONE  
 SECOND CLASS TOWNSHIP MAP  
 FAYETTE COUNTY

PREPARED BY THE  
 PENNSYLVANIA DEPARTMENT OF TRANSPORTATION  
 BUREAU OF PLANNING AND RESEARCH  
 GEOGRAPHIC INFORMATION DIVISION  
 IN COOPERATION WITH THE  
 U.S. DEPARTMENT OF TRANSPORTATION  
 FEDERAL HIGHWAY ADMINISTRATION  
 MUNICIPAL CODE 26 216  
 THIS MAP IS PUBLISHED AS A SUPPLEMENTAL  
 DOCUMENTATION OF LIQUID FUELS TAX FUND MILEAGES  
 REVISED PER FORM 990 DATED 9-30-16.

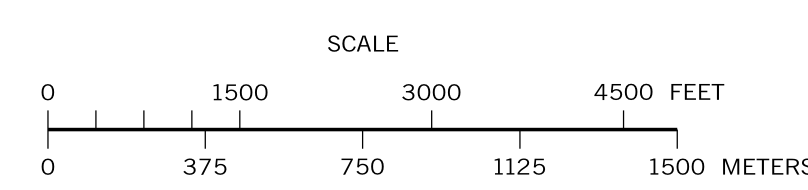

COPIES OF THIS MAP ARE AVAILABLE AT NOMINAL COST  
 CONTACT:  
 PENNSYLVANIA DEPARTMENT OF TRANSPORTATION  
 SALES STORE  
 P.O. BOX 345  
 HARRISBURG, PENNSYLVANIA 17105-345  
 TELEPHONE: (717) 787-6746

CREATED BY JEM 3-9-99 (REVISED 5-18-23)

TYPE B MAP REDSTONE TOWNSHIP FAYETTE COUNTY PENNSYLVANIA