

LEGEND

- LIMITED ACCESS HIGHWAY
- STATE ROUTE AND NUMBER
- STATE MAINTAINED BRIDGE ON TOWNSHIP ROAD
- TOWNSHIP ROAD, NUMBER AND SEGMENT LENGTH IN MILES
- IMPASSABLE TOWNSHIP ROAD
- TURNBACK TOWNSHIP ROAD
- OTHER ROAD
- RAILROAD (IN SERVICE)
- RAILROAD ABANDONED (TRACK RETAINED)
- STATE BOUNDARY
- COUNTY BOUNDARY
- TOWNSHIP BOUNDARY
- CITY OR BOROUGH BOUNDARY
- MUNICIPAL BUILDING
- SPLIT MILEAGE BETWEEN MUNICIPALITIES

- 496 BACK ST
- 498 MAIN ST
- 542 HIGHWAY SUPPLY RD
- 543 GETTYSBURG SCHOOL RD
- 545 DOGWOOD DR
- 546 FOREST DR
- 547 KINGS HILL RD
- 548 SCENIC VIEW RD
- 549 MAPLE ST
- 551 CEDAR ST
- 553 CHESTNUT AL
- 518 CHURCH ST
- 570 GRAVE DIGGER RD
- 580 VINE ST
- 581 AIRWAY INN RD
- 582 RUSSELL ST
- 583 WOODWARD ST
- 584 THIRD ST
- 585 LAUREL LA
- 586 COX BROS RD
- 588 MONARCH ROAD EXT
- 590 SECOND ST
- 591 THIRD ST
- 592 FOURTH ST
- 593 FIFTH ST
- 595 COLLEGE ST
- 596 MAIN ST
- 597 LEISNERING ST
- 598 WEST WOODWAY ST
- 599 STONE ST
- 600 CHURCH ST
- 602 HIGHLAND ST
- 603 CHURCH ST
- 604 BROADWAY ST
- 605 FRONT ST
- 606 SECOND ST
- 607 CONTRA AVENUE EXT
- 609 STONY RD
- 610 CONTRA AV
- 615 BOLIVIAN RD
- 622 JUNIATA RD
- 626 VALLEY RD
- 627 MONARCH RD
- 633 MORRELL ST
- 636 SCARLETT
- 638 STEPHENS ST
- 640 LEECH ST
- 642 BARRON RD
- 644 MONARCH RD
- 671 KURTZ RD
- 672 LORNER SANDY HOLLOW RD
- 673 JUNIATA ST
- 675 HELLERS SCHOOL RD
- 676 LITTLE SUMMIT RD
- 678 RACE PATH RD
- 679 HOLLOW RD
- 681 FRICK HOLLOW RD
- 682 HOLLOW LA
- 683 BEAUFORT RD
- 684 CEDAR DR
- 688 LENEXY RD
- 689 QUICK FORD RD
- 701 SCHOOL RD
- 702 SEASON HILL RD
- 703 MAHONEY RD
- 704 MAHONEY ROAD EXT
- 705 ALPINE LA
- 707 LIMESTONE HILL RD
- 708 UPPER SANDY HOLLOW RD
- 709 LEWINGTON DR
- 710 REVERE DR
- 711 VALLEY FORGE DR
- 712 HIGHLAND RD
- 713 YORKTOWN DR
- 714 HAWKINS RD
- 716 DEWITT AV
- 718 INDEPENDENCE AV
- 720 INDEPENDENCE DR
- 721 MEACHAM
- 723 FURNACE RD
- 727 SHIRT ST
- 729 COPE RD
- 730 SANDY HOLLOW RD
- 731 TRIN OAKS DR
- 732 CANTON RD
- 733 BRICK ROW RD
- 734 MCKINNON FARM RD
- 735 COOPER RD
- 736 SLOUGHACK HOUSE LA
- 737 PINE BLVD
- 738 CHERRY LANE FARM RD
- 740 MAIN DR
- 741 WALNUT GROVE RD
- 742 BELLEVILLE DR
- 743 FRICK LA
- 744 ADLER HILLS DR
- 745 SKYLARK DR
- 746 CLARK ST
- 747 CAMBRIA AV
- 748 FALLS AV
- 749 KIRK ST
- 750 WOOD ST
- 751 BALL PARK RD
- 752 WILSON DR
- 753 HAWKINS RD
- 754 WASHINGTON ST
- 755 PINE HILLS LA
- 756 PAYTON ST
- 757 MONARCH DR
- 758 BROADWAY AV
- 759 STEPHENS ST
- 760 BOYD ST
- 761 LOW LA
- 762 EVERGREEN DR
- 763 FARMERS CIR
- 764 AVON DR
- 765 WILSON LA
- 766 SEVENTEENTH ST
- 767 OLIVE ST
- 770 FRONT STREET GRAMP A RD
- 782 TUCKER RUN RD
- 792 GREEN BRICK RD
- 800 PINE RD
- 812 CONCORD DR
- 840 OGDEN LA
- 846 RIVERSIDE DR
- 848 TROTTER ST
- 860 APPLE ST
- 861 THIRD ST
- 862 WALNUT ST
- 863 DEERFIELD RD
- 864 LOCUST RD
- 865 SECOND AV
- 881 SECOND ST
- 883 MAIN ST
- 890 OUTRICK HILL RD
- 910 SITHA RD
- 911 PINE ST
- 913 GREEN ST
- 918 HAWKINS ST
- 919 CAMBRIA ST
- 920 HAWKINS RD
- 933 HIGH ST
- 935 FRIENDSHIP LA
- 936 KIMBERLY DR
- 937 TOWN RD
- 950 SPRING ST
- 955 FEATHER AV
- 957 OWL HOLLOW RD
- 958 HIGH STREET EXT
- 968 CHELSEA ST
- 969 HOLLOW RD
- 970 MAPLE ST
- 972 MAIN ST
- 974 UNION ST
- 976 MORRELL RD
- 984 ROBINSON ST
- 986 BROOKDALE ST
- 997 WEST PENN AV
- 999 FRANK ST

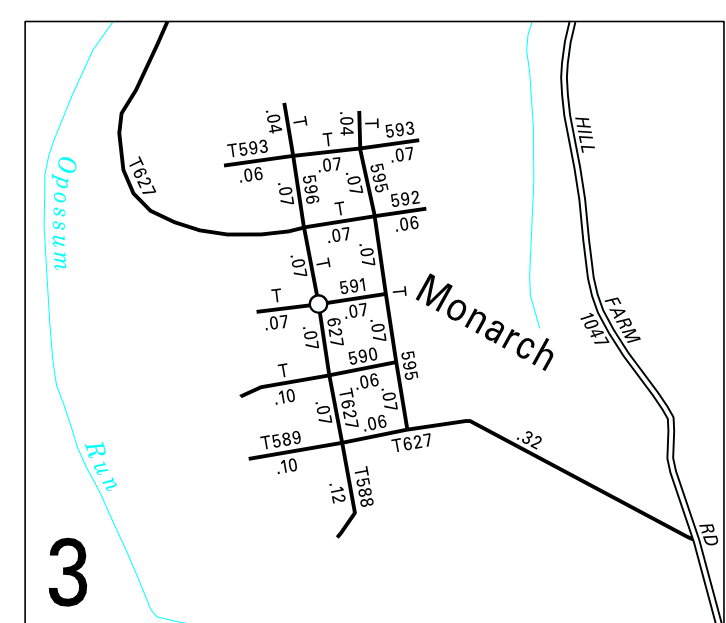

2:1

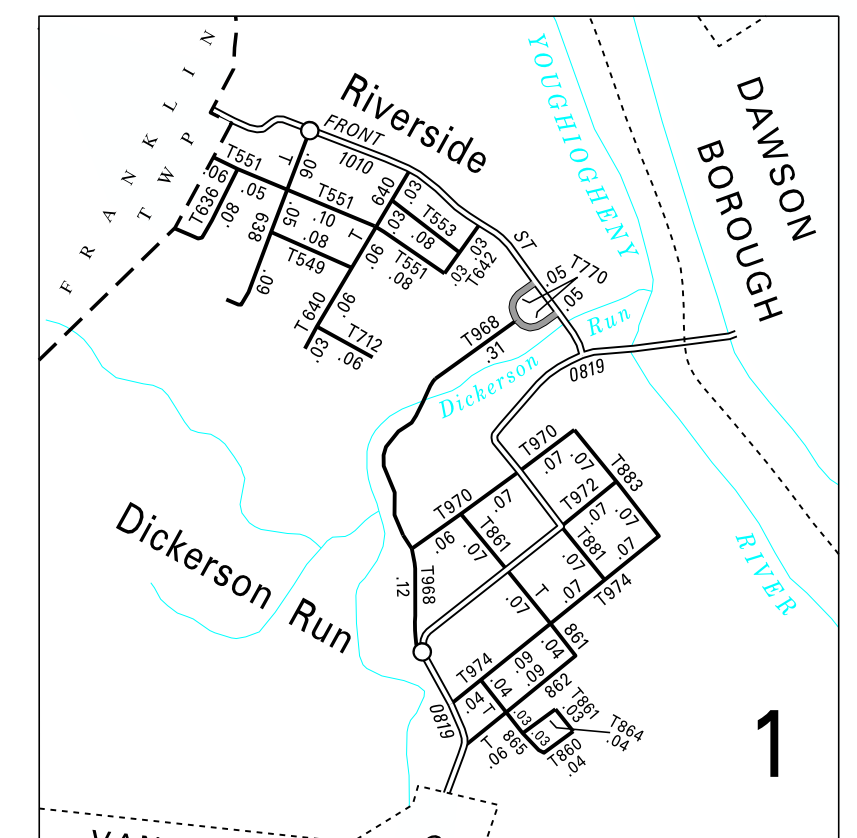

2:1

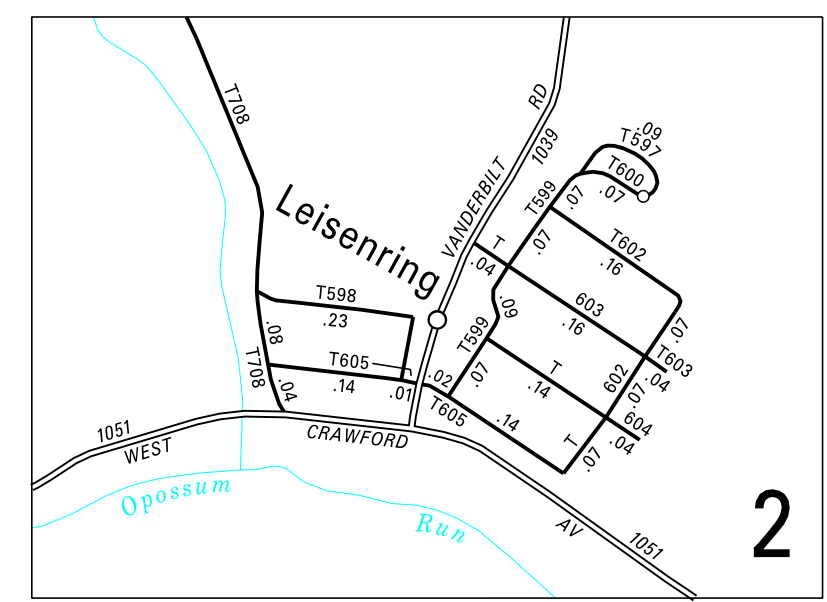

2:1

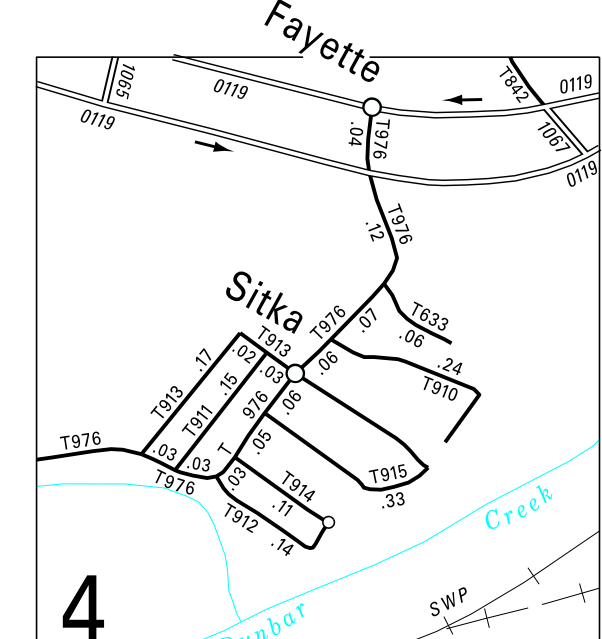

2:1

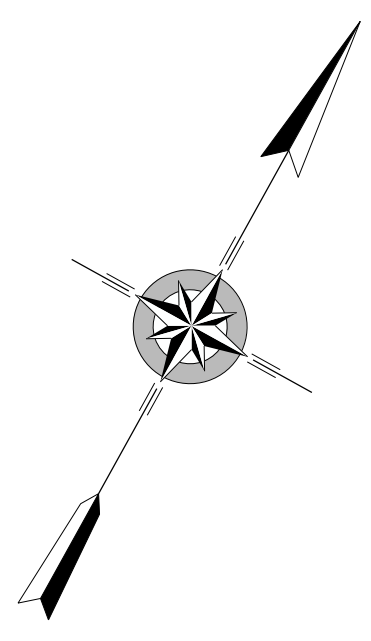

DUNBAR
SECOND CLASS TOWNSHIP MAP
FAYETTE COUNTY
 PREPARED BY THE
PENNSYLVANIA DEPARTMENT OF TRANSPORTATION
BUREAU OF PLANNING AND RESEARCH
GEOGRAPHIC INFORMATION DIVISION
 IN COOPERATION WITH THE
U.S. DEPARTMENT OF TRANSPORTATION
FEDERAL HIGHWAY ADMINISTRATION
MUNICIPAL CODE 26 204
 THIS MAP IS PUBLISHED AS A SUPPLEMENTAL
 DOCUMENTATION OF LIQUID FUELS TAX FUND ALLOCATIONS
 REVISED PER FORM 990 DATED 1-12-24

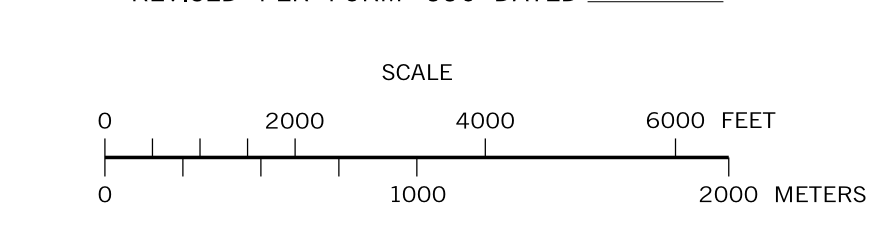

COPIES OF THIS MAP ARE AVAILABLE AT NOMINAL COST
 CONTACT:
 PENNSYLVANIA DEPARTMENT OF TRANSPORTATION
 SALES STORE
 P.O. BOX 3203
 HARRISBURG, PENNSYLVANIA 17105-3203
 TELEPHONE: (717)767-6746

POPULATION 6,672
 (2020 Census)

TOTAL MILES	
Township Road System	66.70*
State Highway System	40.75
Total	107.45

* Includes ACT 32 Turnback Mileage of 0.10