

| | |
|----------------------|-------|
| TOTAL MILES | |
| Township Road System | 6.75* |
| State Highway System | 1.22 |
| Total | 7.97 |

* Includes ACT 32 Turnback Mileage of 0.73

POPULATION 534
(2020 Census)

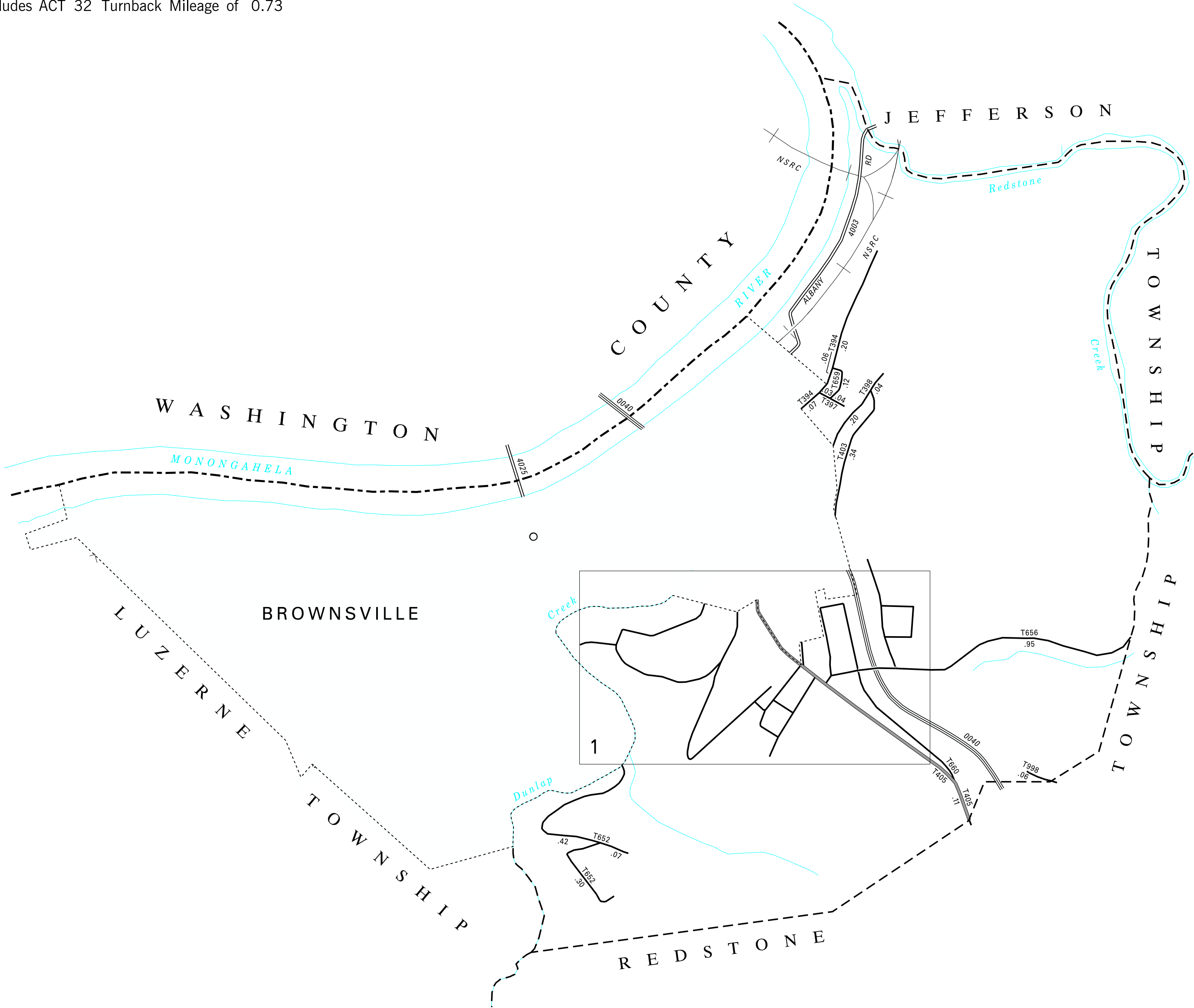

392 MILL RD
393 WILLIAMS ST
394 FIFTH AV
395 GEORGE ST
397 MURRAY AV
398 SHAFFNER AV
399 GLEEN LA
400 SECOND ST
401 PARK ST
402 FIRST ST
403 PLAYFORD AV
404 BARNETT AV
405 EAST NATIONAL PIKE
416 KNOX AV
456 BROWN ST EXT
652 CENTURY RD
653 BROWN ST
654 MCCORMICK ST
655 CENTER RD
656 LYNN RD
657 ANN ST
658 FAIRVIEW ST
659 PEACH ST
660 UNION ST
998 ROBERTS RD

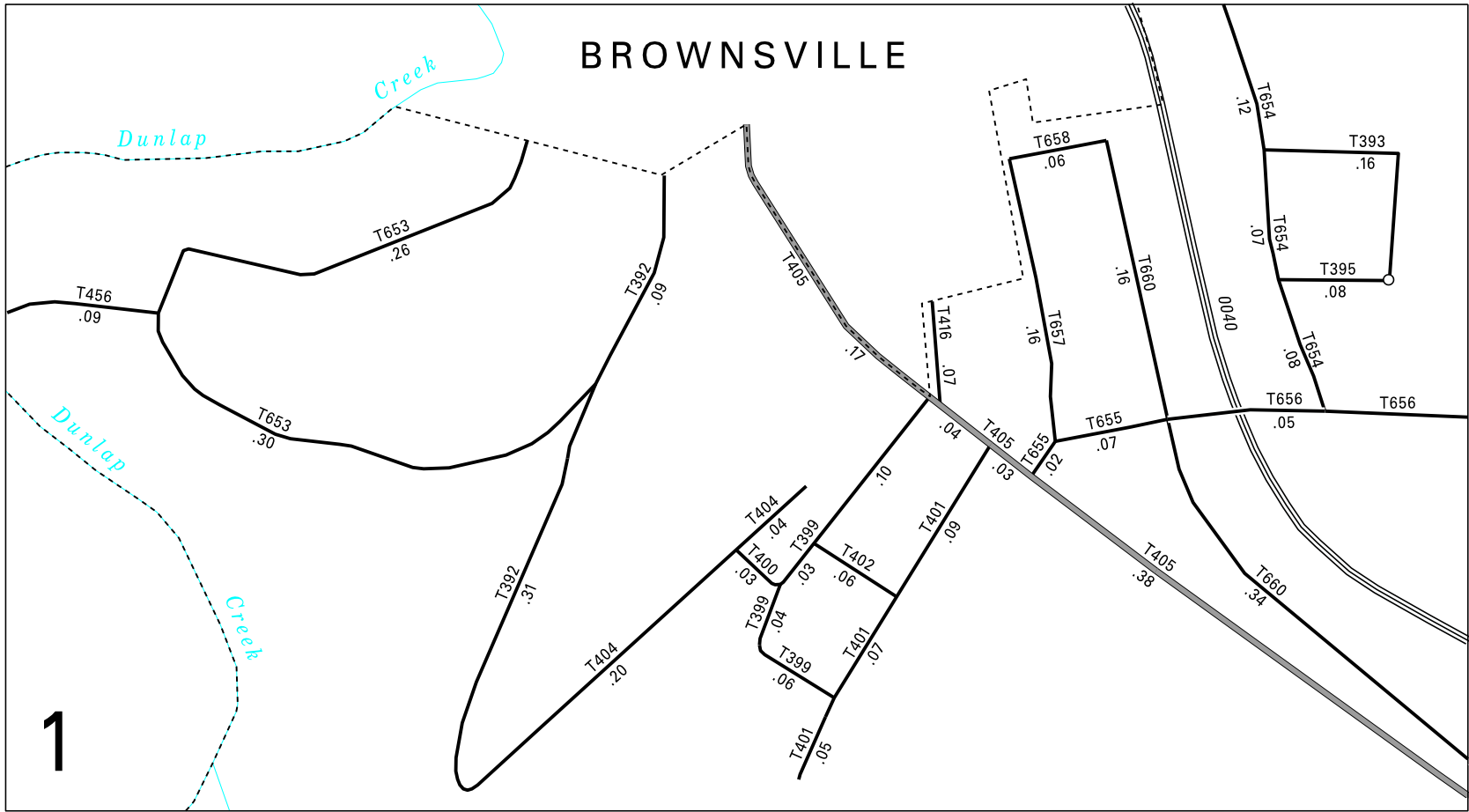

2:1

LEGEND

- LIMITED ACCESS HIGHWAY
- STATE ROUTE AND NUMBER
- STATE MAINTAINED BRIDGE ON TOWNSHIP ROAD
- TOWNSHIP ROAD, NUMBER AND SEGMENT LENGTH IN MILES
- IMPASSABLE TOWNSHIP ROAD
- TURNBACK TOWNSHIP ROAD
- OTHER ROAD
- RAILROAD (IN SERVICE)
- RAILROAD ABANDONED (TRACK RETAINED)
- STATE BOUNDARY
- COUNTY BOUNDARY
- TOWNSHIP BOUNDARY
- CITY OR BOROUGH BOUNDARY
- MUNICIPAL BUILDING
- SPLIT MILEAGE BETWEEN MUNICIPALITIES

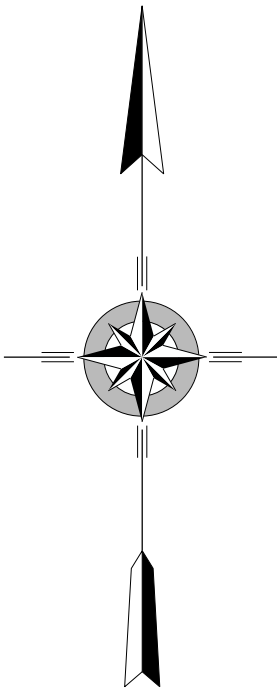

BROWNSVILLE
SECOND CLASS TOWNSHIP MAP
FAYETTE COUNTY

PREPARED BY THE
PENNSYLVANIA DEPARTMENT OF TRANSPORTATION
BUREAU OF PLANNING AND RESEARCH
GEOGRAPHIC INFORMATION DIVISION
IN COOPERATION WITH THE
U.S. DEPARTMENT OF TRANSPORTATION
FEDERAL HIGHWAY ADMINISTRATION
MUNICIPAL CODE 26 201

THIS MAP IS PUBLISHED AS A SUPPLEMENTAL
DOCUMENTATION OF LIQUID FUELS TAX FUND MILEAGES
REVISED PER FORM 990 DATED 10-5-06

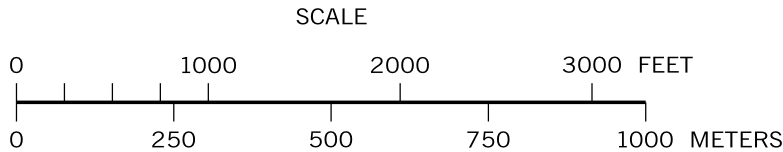

COPIES OF THIS MAP ARE AVAILABLE AT NOMINAL COST
CONTACT:
PENNSYLVANIA DEPARTMENT OF TRANSPORTATION
SALES STORE
P.O. BOX 3451
HARRISBURG, PENNSYLVANIA 17105-3451
TELEPHONE: (717)787-6746