

TOTAL MILES
 City Street System 305.18
 State Highway System 39.52
 Total 344.70
 * Includes ACT 32 Turnback Mileage of 8.77

POPULATION 94,831
 (2020 Census)

LEGEND

- LIMITED ACCESS HIGHWAY
- STATE ROUTE AND NUMBER
- STATE MAINTAINED BRIDGE ON CITY STREET
- CITY STREET NAME AND SEGMENT LENGTH IN MILES
- TURNBACK CITY STREET
- OTHER ROAD
- COUNTY ROAD
- RAILROAD
- STATE BOUNDARY
- COUNTY BOUNDARY
- TOWNSHIP BOUNDARY
- CITY OR BOROUGH BOUNDARY
- MUNICIPAL BUILDING
- SPLIT MILEAGE BETWEEN MUNICIPALITIES

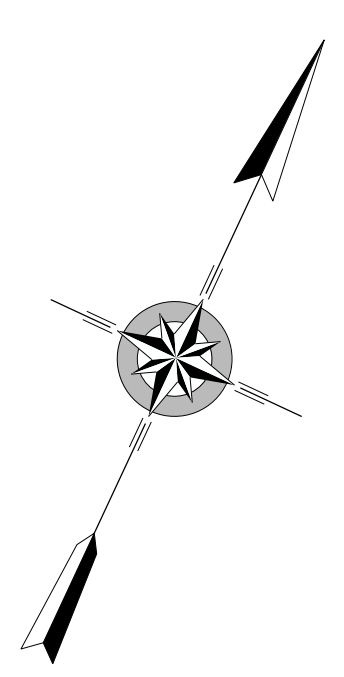
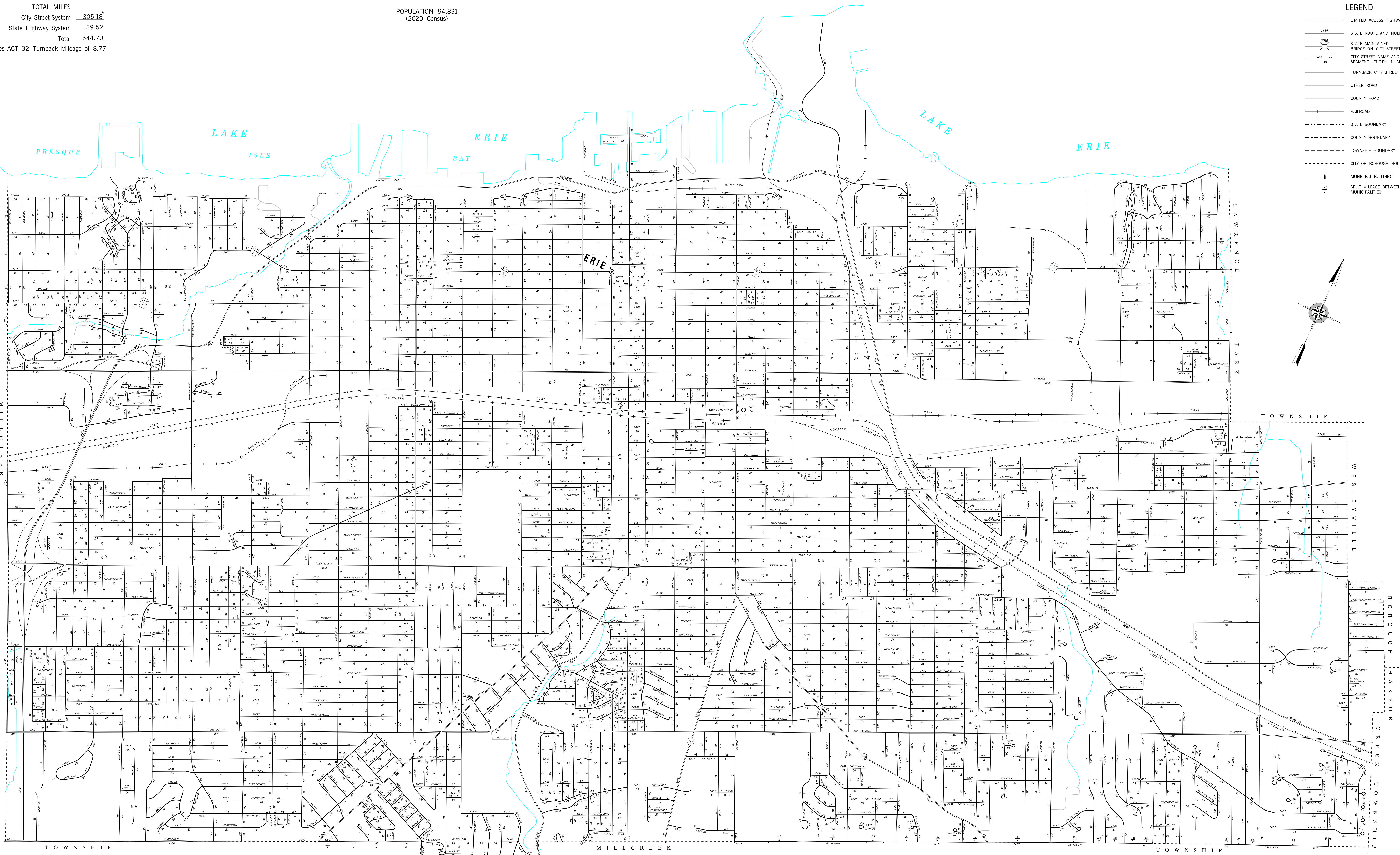

CITY OF ERIE
 ERIE COUNTY

PREPARED BY THE
 PENNSYLVANIA DEPARTMENT OF TRANSPORTATION
 BUREAU OF PLANNING AND RESEARCH
 GEOGRAPHIC INFORMATION DIVISION
 IN COOPERATION WITH THE
 U.S. DEPARTMENT OF TRANSPORTATION
 FEDERAL HIGHWAY ADMINISTRATION
 MUNICIPAL CODE 25 302
 THIS MAP IS PUBLISHED AS A SUPPLEMENTARY
 DOCUMENTATION OF ROAD MILES AND FINE MILEAGES
 REVISED PER FORM 990 DATED 8-5-21

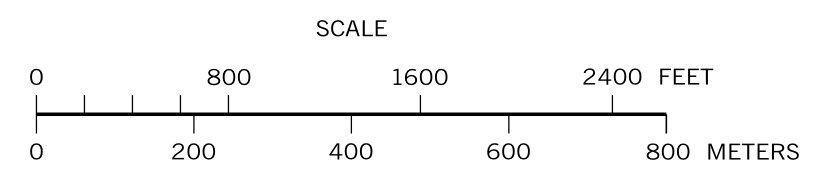

ALLEN ST	ANDERSON PARK BLVD	BURNS AV	COPPER DR	FIFTH ST	GLITCHWOOD BLVD	HOMELAND BLVD	LITCHWOOD ST	MONROE ST	PERKINS BLVD	RYAN ST	STODOL AV	THURGOOD ST	WILSON ST
ALLEN ST	ANDERSON PARK BLVD	BURNS AV	COPPER DR	FIFTH ST	GLITCHWOOD BLVD	HOMELAND BLVD	LITCHWOOD ST	MONROE ST	PERKINS BLVD	RYAN ST	STODOL AV	THURGOOD ST	WILSON ST

COPIES OF THIS MAP ARE AVAILABLE AT NOMINAL COST
 CONTACT:
 PENNSYLVANIA DEPARTMENT OF TRANSPORTATION
 P.O. BOX 300
 HARRISBURG, PENNSYLVANIA 17105-3001
 TELEPHONE: (717) 781-6746