

LEGEND

- LIMITED ACCESS HIGHWAY
- STATE ROUTE AND NUMBER
- STATE MAINTAINED BRIDGE ON TOWNSHIP ROAD
- TOWNSHIP ROAD, NUMBER AND SEGMENT LENGTH IN MILES
- IMPASSABLE TOWNSHIP ROAD
- TURNBACK TOWNSHIP ROAD
- OTHER ROAD
- RAILROAD (IN SERVICE)
- RAILROAD ABANDONED (TRACK RETAINED)
- STATE BOUNDARY
- COUNTY BOUNDARY
- TOWNSHIP BOUNDARY
- CITY OR BOROUGH BOUNDARY
- MUNICIPAL BUILDING
- SPLIT MILEAGE BETWEEN MUNICIPALITIES

POPULATION 985  
(2020 Census)

TOTAL MILES	
Township Road System	31.27*
State Highway System	24.79
Total	56.06

\* Includes ACT 32 Turnback Mileage of 3.46

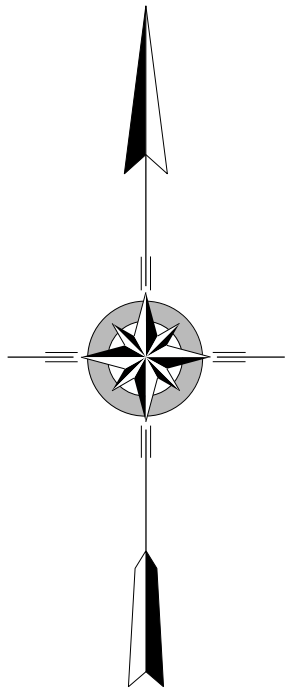
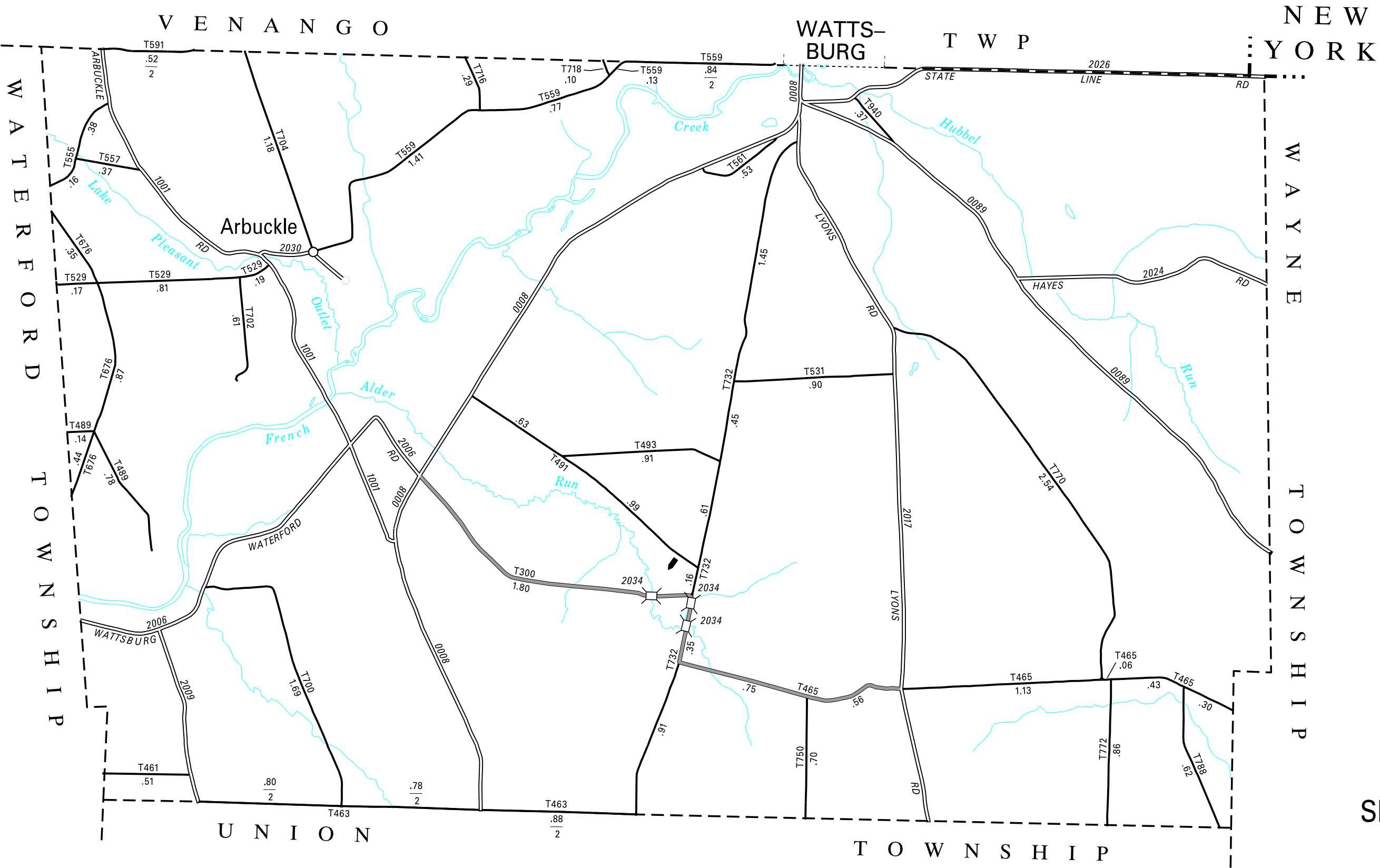

AMITY  
SECOND CLASS TOWNSHIP MAP  
ERIE COUNTY

PREPARED BY THE  
PENNSYLVANIA DEPARTMENT OF TRANSPORTATION  
BUREAU OF PLANNING AND RESEARCH  
GEOGRAPHIC INFORMATION DIVISION  
IN COOPERATION WITH THE  
U.S. DEPARTMENT OF TRANSPORTATION  
FEDERAL HIGHWAY ADMINISTRATION  
MUNICIPAL CODE 25 201  
THIS MAP IS PUBLISHED AS A SUPPLEMENTAL  
DOCUMENTATION OF LIQUID FUELS TAX FUND MILEAGES  
REVISED PER FORM 990 DATED 3-30-09

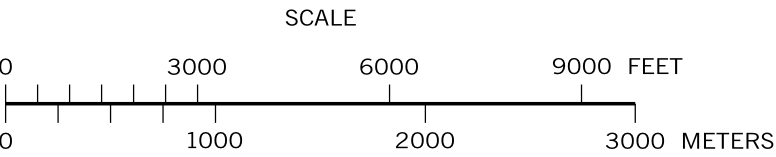

- 300 HATCH HOLLOW RD
- 461 MIDDLETON RD
- 463 UNION AMITY RD
- 465 FENNO RD
- 489 KLEMMER RD
- 491 CASLER RD
- 493 FARMER RD
- 529 WELCH RD
- 531 CHAFFEE RD
- 555 LOWE RD
- 557 BURLINGHAM RD
- 559 HASKELL HILL RD
- 561 PHILLIPS RD
- 591 LEE RD
- 676 JUVA VALLEY RD
- 700 MURRAY RD
- 702 ESTES RD
- 704 HOPSON HILL RD
- 716 MUNSEE RD
- 718 DOOLITTLE RD
- 732 OLD WATTSBURG RD
- 750 HOYT RD
- 770 STEWART HILL RD
- 772 TARBELL RD
- 788 MESSENGER RD
- 940 SAMMONS RD

COPIES OF THIS MAP ARE AVAILABLE AT NOMINAL COST  
CONTACT:  
PENNSYLVANIA DEPARTMENT OF TRANSPORTATION  
SALES STORE  
P.O. BOX 3451  
HARRISBURG, PENNSYLVANIA 17105-3451  
TELEPHONE: (717)787-6746