

**LEGEND**

- LIMITED ACCESS HIGHWAY
- STATE ROUTE AND NUMBER
- STATE MAINTAINED BRIDGE ON TOWNSHIP ROAD
- TOWNSHIP ROAD, NUMBER AND SEGMENT LENGTH IN MILES
- IMPASSABLE TOWNSHIP ROAD
- OTHER ROAD
- RAILROAD (IN SERVICE)
- RAILROAD ABANDONED (TRACK RETAINED)
- STATE BOUNDARY
- COUNTY BOUNDARY
- TOWNSHIP BOUNDARY
- CITY OR BOROUGH BOUNDARY
- MUNICIPAL BUILDING
- SPLIT MILEAGE BETWEEN MUNICIPALITIES

COPIES OF THIS MAP ARE AVAILABLE AT NOMINAL COST CONTACT:

PENNSYLVANIA DEPARTMENT OF TRANSPORTATION  
SALES STORE  
P.O. BOX 3451  
HARRISBURG, PENNSYLVANIA 17105-3451  
TELEPHONE: (717)787-6746

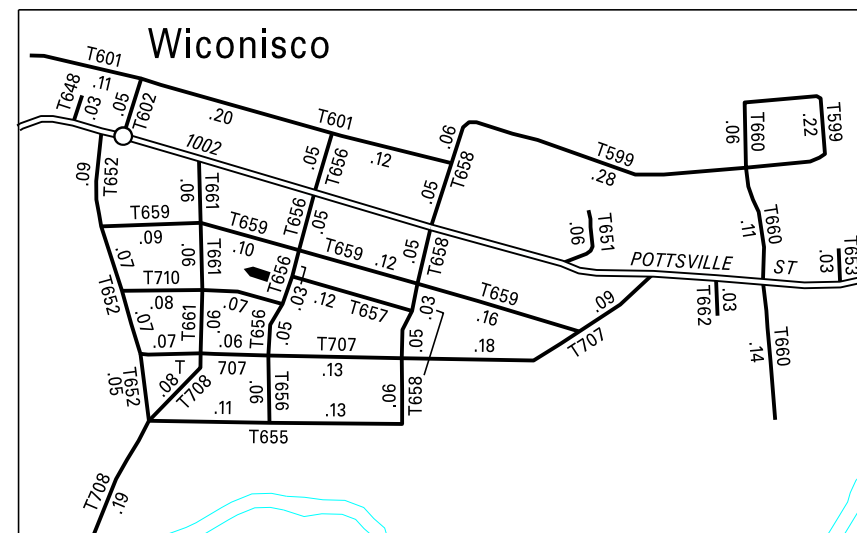

2:1

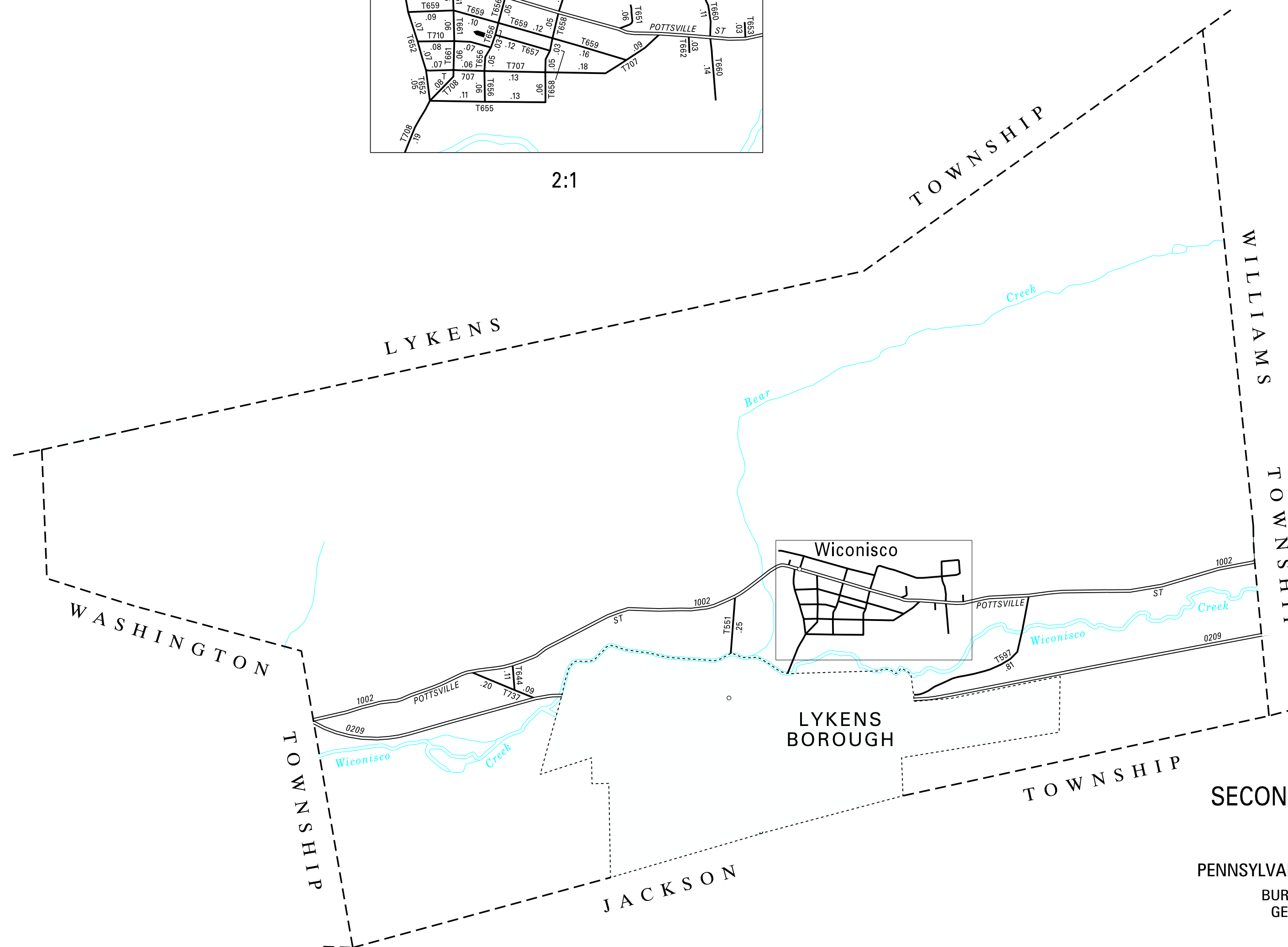
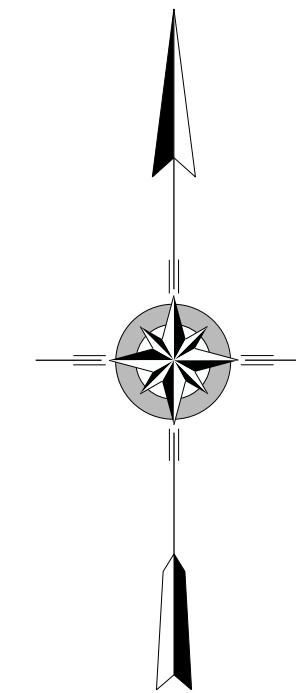

POPULATION 1,159  
(2020 Census)

TOTAL MILES	
Township Road System	5.71
State Highway System	6.85
Total	12.56

**WICONISCO  
SECOND CLASS TOWNSHIP MAP  
DAUPHIN COUNTY**

PREPARED BY THE  
PENNSYLVANIA DEPARTMENT OF TRANSPORTATION  
BUREAU OF PLANNING AND RESEARCH  
GEOGRAPHIC INFORMATION DIVISION  
IN COOPERATION WITH THE  
U.S. DEPARTMENT OF TRANSPORTATION  
FEDERAL HIGHWAY ADMINISTRATION

MUNICIPAL CODE 22 220

THIS MAP IS PUBLISHED AS A SUPPLEMENTAL  
DOCUMENTATION OF LIQUID FUELS TAX FUND MILEAGES  
REVISED PER FORM 990 DATED 6-28-10

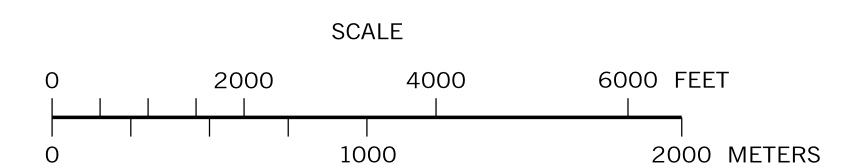

- 551 MARKET ST
- 597 MACHAMER AV
- 599 MOUNTAIN ST
- 601 WICONISCO ST
- 602 ZEALOT ST
- 644 SCHOOL ST
- 648 CHESTNUT ST
- 651 EAST ST
- 652 PLANE ST
- 653 POPLAR ST
- 655 SOUTH ST
- 656 STONE ST
- 657 RAILROAD ST
- 658 SPRING ST
- 659 WALNUT ST
- 660 MAPLE ST
- 661 ROCK ST
- 662 CEMETERY RD
- 707 CENTER ST
- 708 ARCH ST
- 710 OAK ST
- 737 HILL ST