

TOTAL MILES	
Township Road System	57.60*
State Highway System	28.33
Total	85.93

* Includes ACT 32 Turnback Mileage of 3.12

LEGEND

- LIMITED ACCESS HIGHWAY
- STATE ROUTE AND NUMBER
- STATE MAINTAINED BRIDGE ON TOWNSHIP ROAD
- TOWNSHIP ROAD, NUMBER AND SEGMENT LENGTH IN MILES
- IMPASSABLE TOWNSHIP ROAD
- TURNBACK TOWNSHIP ROAD
- OTHER ROAD
- RAILROAD (IN SERVICE)
- RAILROAD ABANDONED (TRACK RETAINED)
- STATE BOUNDARY
- COUNTY BOUNDARY
- TOWNSHIP BOUNDARY
- CITY OR BOROUGH BOUNDARY
- MUNICIPAL BUILDING
- SPLIT MILEAGE BETWEEN MUNICIPALITIES

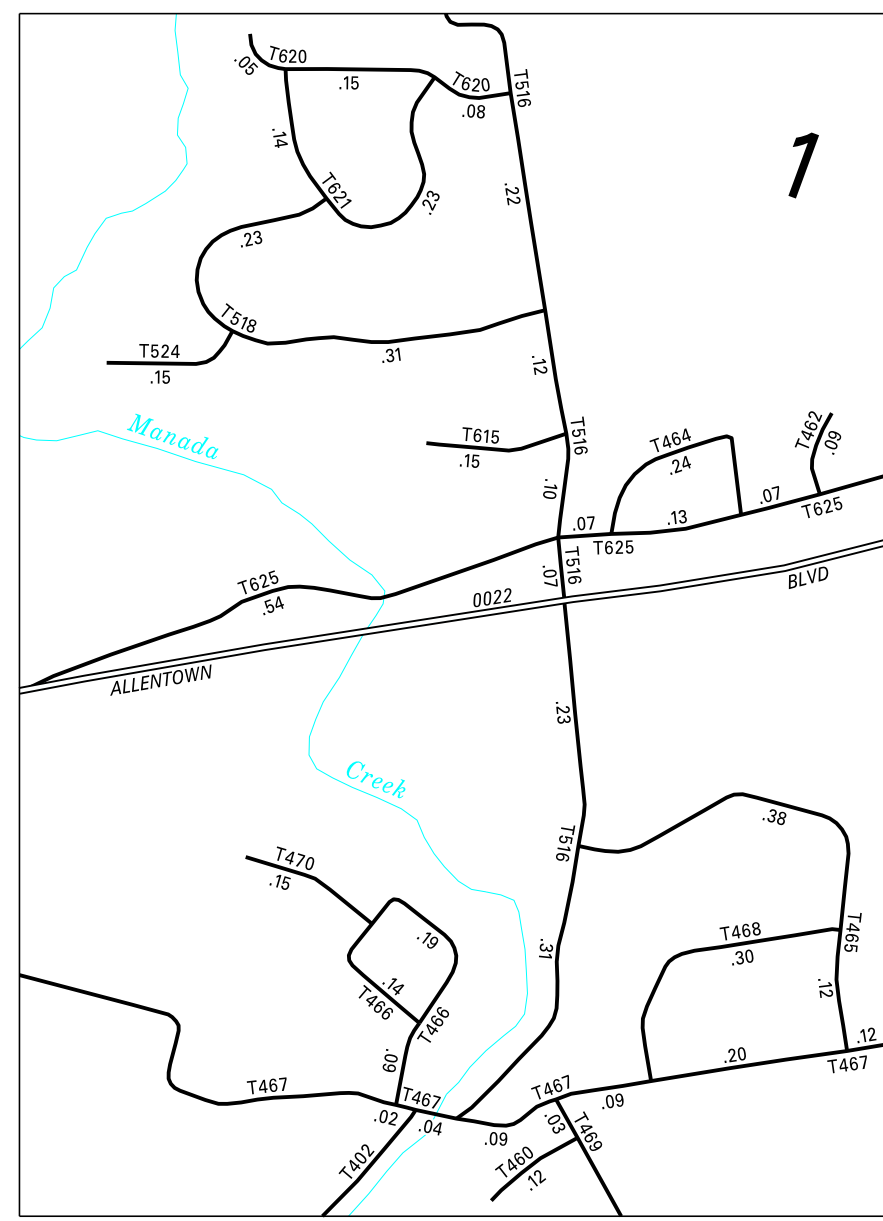
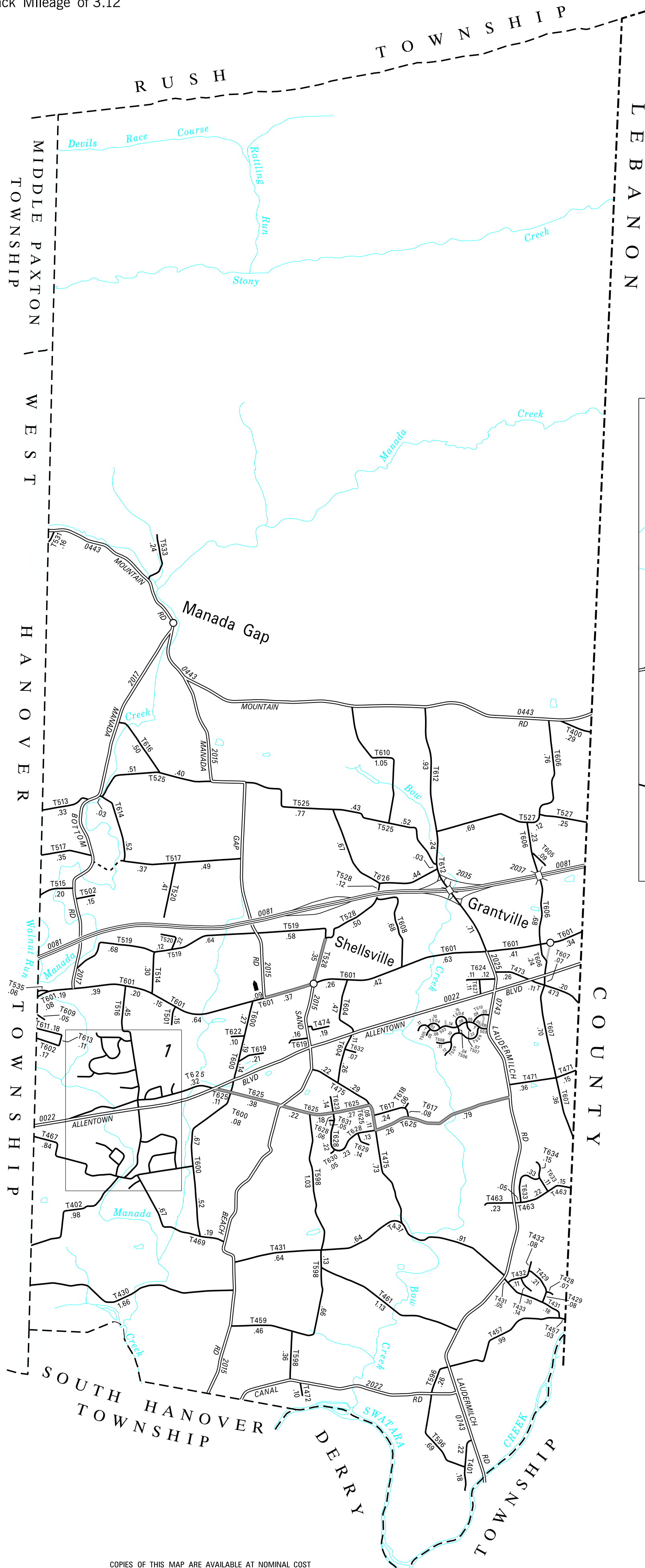

3:1

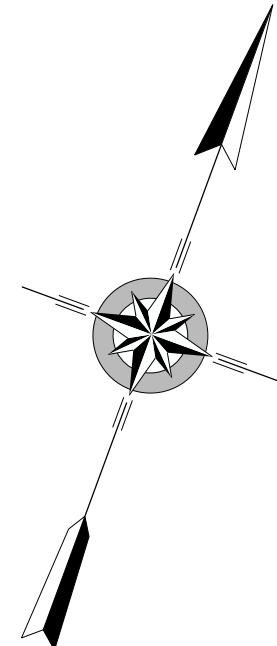

**EAST HANOVER
SECOND CLASS TOWNSHIP MAP
DAUPHIN COUNTY**

PREPARED BY THE
PENNSYLVANIA DEPARTMENT OF TRANSPORTATION
BUREAU OF PLANNING AND RESEARCH
GEOGRAPHIC INFORMATION DIVISION

IN COOPERATION WITH THE
U.S. DEPARTMENT OF TRANSPORTATION
FEDERAL HIGHWAY ADMINISTRATION

MUNICIPAL CODE 22 203

THIS MAP IS PUBLISHED AS A SUPPLEMENTAL
DOCUMENTATION OF LIQUID FUELS TAX FUND MILEAGES
REVISED PER FORM 990 DATED 9-22-16

SCALE

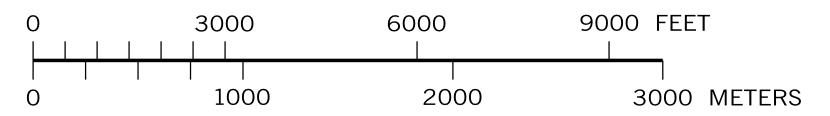

- 400 ANGLE RD
- 401 OLD LAUDERMILCH RD
- 402 DOUGLAS RD
- 428 HOLLYBERRY CIR
- 429 TANNENBAUM WAY
- 430 DEVONSHIRE HEIGHTS RD
- 431 EARLYS MILL RD
- 432 PINEVIEW DR
- 433 EVERGREEN LA
- 457 PINE RD
- 459 LEVEL RD
- 460 ULRICH CT
- 461 SHADY LA
- 462 SAMANTHA CT
- 463 DAIRY LA
- 464 CIRCLE DR
- 465 SYCAMORE LA
- 466 MONDALE CIR
- 467 CARLSON RD
- 468 CHESTNUT PL
- 469 CROOKED HILL RD
- 470 CARTER DR
- 471 COLT DR
- 472 AMOR DR
- 473 FAITH RD
- 474 SAN JO DR
- 475 PHEASANT RD
- 501 DORLEE CT
- 502 BROOKSMILL RD
- 503 CREEK VIEW DR
- 504 SILVERLEAF LA
- 505 BOXWOOD COVE
- 506 STONEFORD LA
- 507 ASHMEADOW COVE
- 508 FOX HAVEN LA
- 509 BLUE HERON LA
- 510 PRESERVE LA
- 513 MOYER RD
- 514 RED HILL RD
- 515 CAMP KIWANIS RD
- 516 MILL RD
- 517 RABBIT LA
- 518 RED FOX LA
- 519 DRY RUN RD
- 520 FAIRLANE RD
- 524 STEEPCHASE LA
- 525 RIDGE RD
- 527 FOX RUN RD
- 528 SHELLS CHURCH RD
- 531 APPLEBY RD
- 533 McLEAN RD
- 535 FOX MILL RD
- 596 HIGH DR
- 598 TRAIL RD
- 600 CRAWFORD RD
- 601 JONESTOWN RD
- 602 MANADA VIEW DR
- 604 HILL DR
- 605 OLE LA
- 606 FIREHOUSE RD
- 607 COUNTYLINE RD
- 608 SPRING RD
- 609 REDSTONE DR
- 610 GOLF LA
- 611 YELLOWSTONE DR
- 612 BOW CREEK RD
- 613 BERRY DR
- 614 CLIFF RD
- 615 CAMPBELL CT
- 616 FURNACE RD
- 617 BUNNY LA
- 618 HIGHLAND CIR
- 619 CAREN DR
- 620 HUNTER LA
- 621 STIRRRUP LA
- 622 SHIRKS LA
- 623 LORA LA
- 624 KELLEY CT
- 625 MEADOW LA
- 626 STATION RD
- 627 HERR RD
- 628 TIMBER RIDGE RD
- 629 CRABAPPLE CT
- 630 EASTWOOD CIR
- 631 HUNTER CIR
- 632 SUNSET DR
- 633 SUNFLOWER LA
- 634 DAISY LA

COPIES OF THIS MAP ARE AVAILABLE AT NOMINAL COST
CONTACT:

PENNSYLVANIA DEPARTMENT OF TRANSPORTATION
SALES STORE
P.O. BOX 3451
HARRISBURG, PENNSYLVANIA 17105-3451
TELEPHONE: (717)787-6746