

LEGEND

- LIMITED ACCESS HIGHWAY
- 0944 STATE ROUTE AND NUMBER
- 3019 STATE MAINTAINED BRIDGE ON BOROUGH STREET
- BOROUGH STREET NAME AND SEGMENT LENGTH IN MILES
- TURNBACK BOROUGH STREET
- BOROUGH ALLEY
- OTHER ROAD
- RAILROAD
- STATE BOUNDARY
- COUNTY BOUNDARY
- TOWNSHIP BOUNDARY
- CITY BOUNDARY
- BOROUGH BOUNDARY
- MUNICIPAL BUILDING
- .70 2 SPLIT MILEAGE BETWEEN MUNICIPALITIES
- 1 SCHOOL, COLLEGE OR UNIVERSITY
- POINT OF INTEREST

POPULATION 3,070
(2010 Census)

- ARNOLD ST

BEACH FARM RD

BRENTWOOD RD

CAMPBELL PL

CHESTNUT ST

CRESTWOOD DR

DIANE CIR

ECHO RD

EDNA ST

ELM ST

ERFORD RD

FERRY ST

FOURTH AV

FOXGROFT DR

GLEN RD

GRANDVIEW AV

GRANT DR

GREENWOOD CIR

HALDEMAN ST

HILLCREST RD

HILLSIDE CIR

HILLSIDE DR

HOLMES ST
- HOUCK ST

KEVIN CT

LOCUST ST

MAPLE ST

MARKET ST

MEADOW DR

OAKWOOD DR

OLD ORCHARD CIR

OLD ORCHARD LA

OLIVE ST

PINE ST

POPLAR ST

PORSHA TER

RIVER ST

RUPLEY RD

SECOND ST

SOUTH TERRACE RD

THIRD AV

THIRD ST

THOMAS RD

WEST LAWN CIR

YVERDON DR

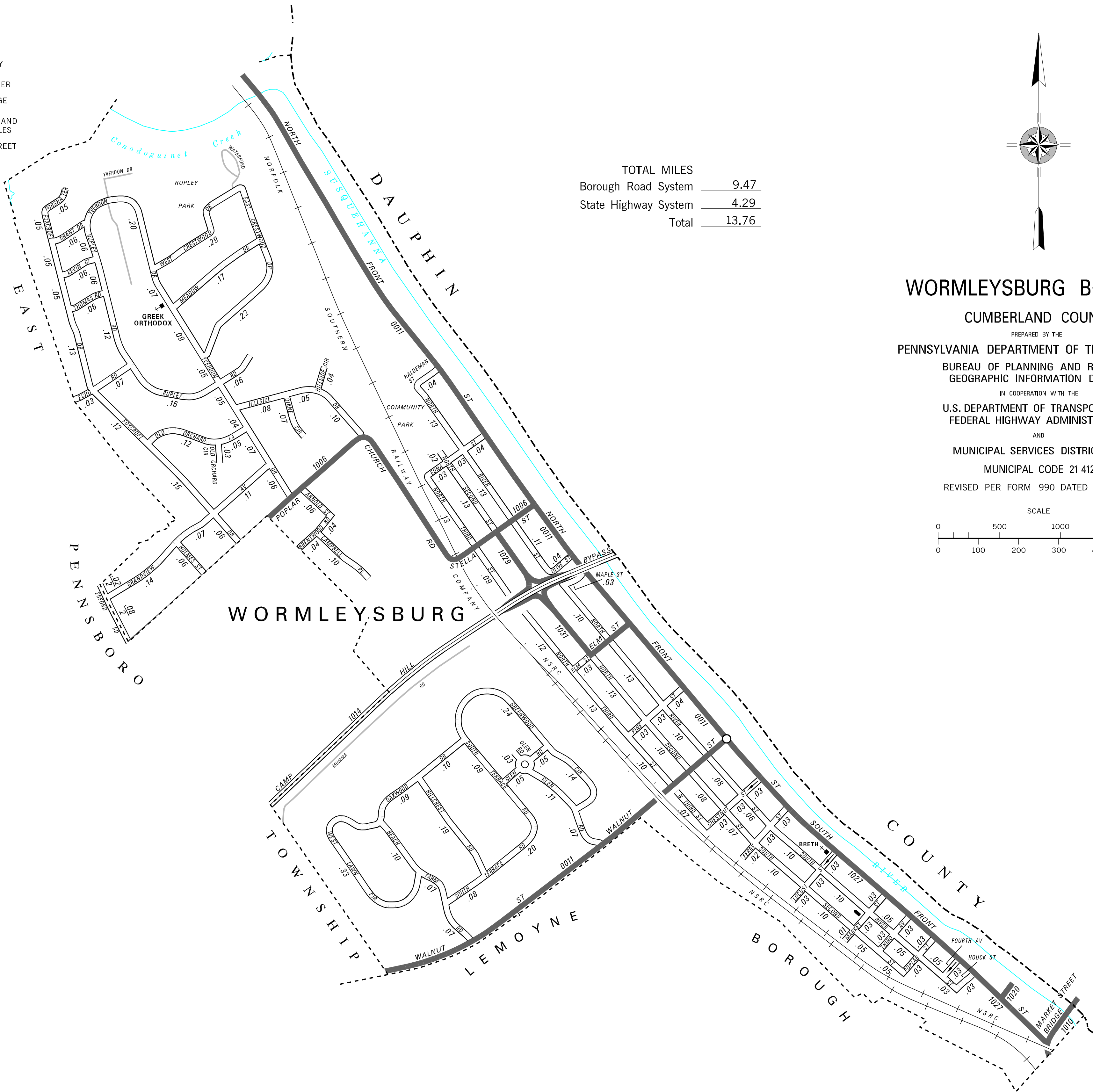

TOTAL MILES	
Borough Road System	9.47
State Highway System	4.29
Total	13.76

WORMLEYSBURG BOROUGH
CUMBERLAND COUNTY

PREPARED BY THE
PENNSYLVANIA DEPARTMENT OF TRANSPORTATION
BUREAU OF PLANNING AND RESEARCH
GEOGRAPHIC INFORMATION DIVISION
IN COOPERATION WITH THE
U.S. DEPARTMENT OF TRANSPORTATION
FEDERAL HIGHWAY ADMINISTRATION
AND
MUNICIPAL SERVICES DISTRICT 8-0
MUNICIPAL CODE 21 412
REVISED PER FORM 990 DATED 6-10-11

