

TOTAL MILES	
Borough Road System	<u>9.43</u>
State Highway System	<u>1.39</u>
Total	<u>10.82</u>

LEGEND

- | | |
|--|--|
| | LIMITED ACCESS HIGHWAY |
| | STATE ROUTE AND NUMBER |
| | STATE MAINTAINED BRIDGE
ON BOROUGH STREET |
| | BOROUGH STREET NAME AND
SEGMENT LENGTH IN MILES |
| | TURNBACK BOROUGH STREET |
| | BOROUGH ALLEY |
| | OTHER ROAD |
| | RAILROAD |
| | STATE BOUNDARY |
| | COUNTY BOUNDARY |
| | TOWNSHIP BOUNDARY |
| | CITY BOUNDARY |
| | BOROUGH BOUNDARY |
| | MUNICIPAL BUILDING |
| | SPLIT MILEAGE BETWEEN
MUNICIPALITIES |
| | SCHOOL, COLLEGE OR
UNIVERSITY |
| | POINT OF INTEREST |

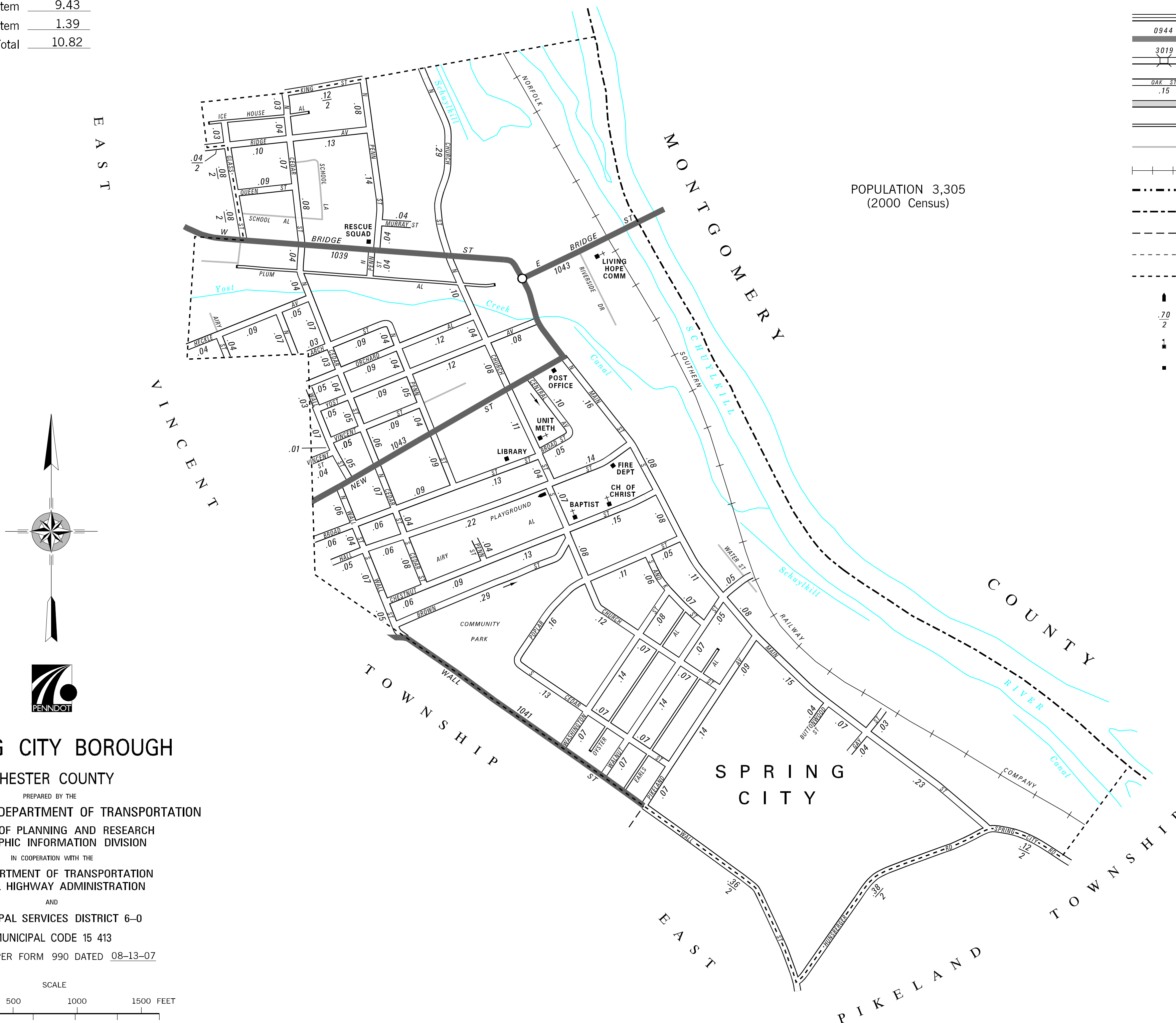

SPRING CITY BOROUGH

CHESTER COUNTY

PREPARED BY THE

PENNSYLVANIA DEPARTMENT OF TRANSPORTATION

BUREAU OF PLANNING AND RESEARCH
GEOGRAPHIC INFORMATION DIVISION

IN COOPERATION WITH THE

U.S. DEPARTMENT OF TRANSPORTATION
FEDERAL HIGHWAY ADMINISTRATION

AND

MUNICIPAL SERVICES DISTRICT 6-0

MUNICIPAL CODE 15 413

REvised PER FORM 990 DATED 08-13-07

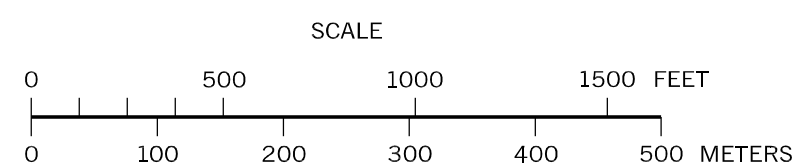

(CREATED BY MSK 07-18-07)