

LEGEND

- LIMITED ACCESS HIGHWAY
- STATE ROUTE AND NUMBER
- STATE MAINTAINED BRIDGE ON TOWNSHIP ROAD
- TOWNSHIP ROAD, NUMBER AND SEGMENT LENGTH IN MILES
- IMPASSABLE TOWNSHIP ROAD
- TURNBACK TOWNSHIP ROAD
- OTHER ROAD
- RAILROAD (IN SERVICE)
- RAILROAD ABANDONED (TRACK RETAINED)
- STATE BOUNDARY
- COUNTY BOUNDARY
- TOWNSHIP BOUNDARY
- CITY OR BOROUGH BOUNDARY
- MUNICIPAL BUILDING
- SPLIT MILEAGE BETWEEN MUNICIPALITIES

TOTAL MILES	
Township Road System	46.95*
State Highway System	24.15
Total	71.10

* Includes ACT 32 Turnback Mileage of 4.59

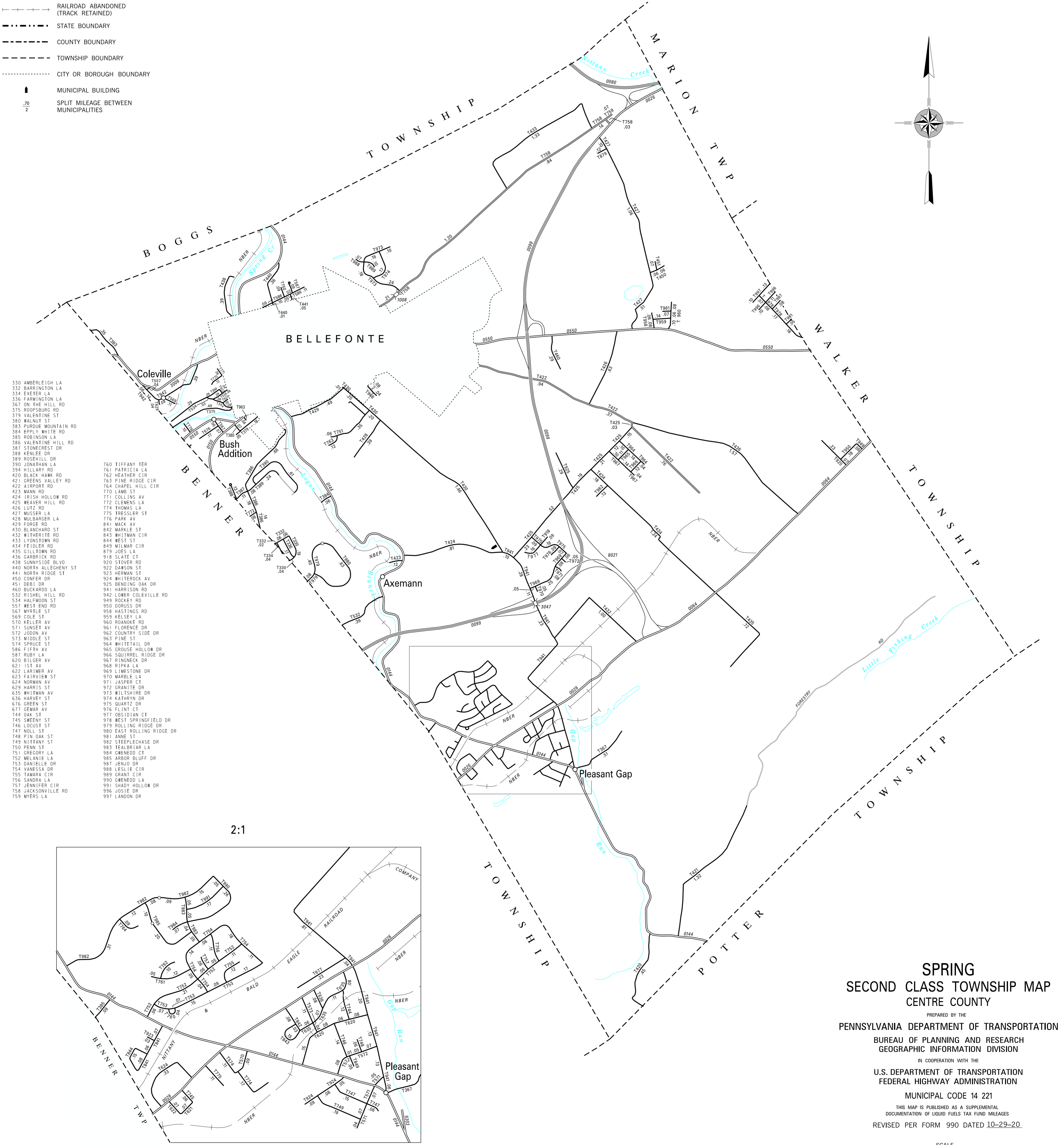
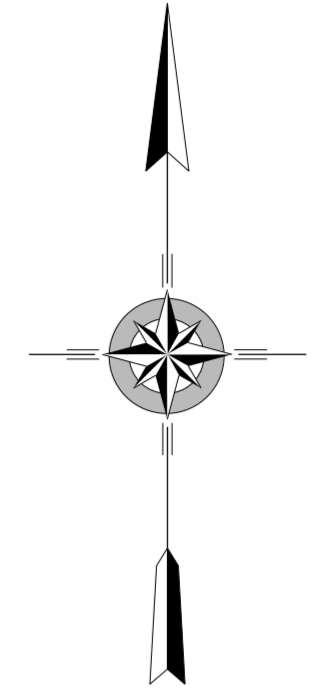

- 330 AMBERLEIGH LA
- 332 BARRINGTON LA
- 334 EXETER LA
- 336 FARMINGTON LA
- 367 ON THE HILL RD
- 375 ROOPSBURG RD
- 379 VALENTINE ST
- 380 WALNUT ST
- 383 PURDUE MOUNTAIN RD
- 384 SPPLY WHITE RD
- 385 ROBINSON LA
- 386 VALENTINE HILL RD
- 387 STONECREST DR
- 388 KENLEE DR
- 389 ROSEHILL DR
- 390 JONATHAN LA
- 394 HILLARY RD
- 420 BLACK HAWK RD
- 421 GREENS VALLEY RD
- 422 AIRPORT RD
- 423 MANN RD
- 424 IRISH HOLLOW RD
- 425 HEASER HILL RD
- 426 LEFZ RD
- 427 MUSSER LA
- 428 MILDARGER LA
- 429 FORGE RD
- 430 BLANCHARD ST
- 432 WITHERIE RD
- 433 LYONSTOWN RD
- 434 FEIDLER RD
- 435 CILLTOWN RD
- 436 GARRICK RD
- 438 SUNNYSIDE BLVD
- 440 NORTH ALLEGHENY ST
- 441 NORTH RIDGE ST
- 450 CONFER DR
- 451 DEBI DR
- 460 BUCKAROD LA
- 532 RISHILL HILL RD
- 534 HALFMOON ST
- 557 WEST END RD
- 567 MYRTLE ST
- 569 COLE ST
- 570 KELLER AV
- 571 SUNSET AV
- 572 JODON AV
- 573 MIDDLE ST
- 574 SPRUCE ST
- 586 FIFTH AV
- 587 RUBY LA
- 620 BILDER AV
- 621 1ST AV
- 622 LARIMER AV
- 623 FAIRVIEW ST
- 624 NORMAN AV
- 629 HARRIS ST
- 635 WHITMAN AV
- 636 HARVEY ST
- 677 GEWAR AV
- 744 OAK ST
- 745 SWEENEY ST
- 747 NOLL ST
- 748 PIN OAK ST
- 749 NITTANY ST
- 750 PENN ST
- 751 CREGORY LA
- 752 MELANIE LA
- 753 DANIELLE DR
- 754 VANESSA DR
- 755 TAMARA CIR
- 756 SANDRA LA
- 757 JENNIFER CIR
- 758 JACKSONVILLE RD
- 759 MYERS LA
- 760 TIFFANY TER
- 761 PATRICIA LA
- 762 HEATHER CIR
- 763 PINE RIDGE CIR
- 764 CHAPEL HILL CIR
- 770 LAMB ST
- 771 COLLINS AV
- 772 CLEMENS LA
- 774 THOMAS LA
- 775 IRESSLER ST
- 776 PARK AV
- 841 MACK AV
- 842 MARKLE ST
- 843 WHITMAN CIR
- 844 WEST ST
- 849 WILMAR CIR
- 879 JOES LA
- 918 SLATE CT
- 920 STOVER RD
- 922 DAWSON ST
- 923 HERMAN ST
- 924 WHITEROCK AV
- 925 BENDING OAK DR
- 941 HARRISON RD
- 942 LOWER COLEVILLE RD
- 949 HOCKEY RD
- 950 DORRUS DR
- 958 HASTINGS RD
- 959 KELSEY LA
- 960 ROANOK DR
- 961 FLORENCE DR
- 962 COUNTRY SIDE DR
- 963 PINE ST
- 964 WHITTAIL DR
- 965 GROUSE HOLLOW DR
- 966 SQUIRREL RIDGE DR
- 967 RINGNECK DR
- 968 RIPKA LA
- 969 LIMESTONE DR
- 970 MARBLE LA
- 971 JASPER CT
- 972 GRANITE DR
- 973 WILTSHIRE DR
- 974 KATHRYN DR
- 975 QUARTZ DR
- 976 FLINT CT
- 977 OBSIDIAN CT
- 978 WEST SPRINGFIELD DR
- 979 ROLLING RIDGE DR
- 980 EAST ROLLING RIDGE DR
- 981 ANNE ST
- 982 STEEPLCHASE DR
- 983 TEALBRIAR LA
- 984 CRENEED CT
- 985 ARBOR BLUFF DR
- 987 JENJO DR
- 988 LESLIE CIR
- 989 GRANT CIR
- 990 CRENEED LA
- 991 SHADD HOLLOW DR
- 996 JOSIE DR
- 997 LONDON DR

2:1

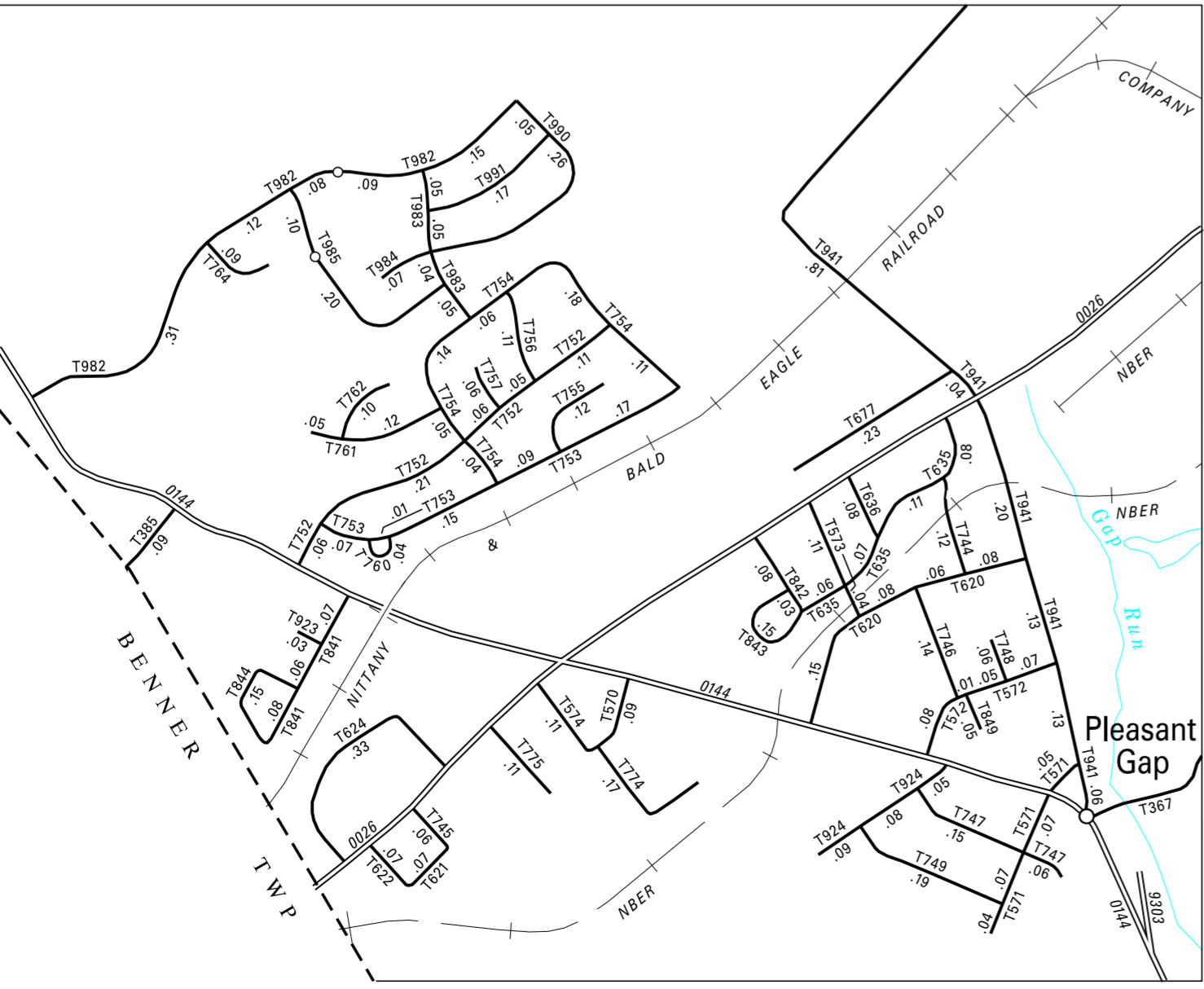

SPRING
SECOND CLASS TOWNSHIP MAP
CENTRE COUNTY
 PREPARED BY THE
PENNSYLVANIA DEPARTMENT OF TRANSPORTATION
 BUREAU OF PLANNING AND RESEARCH
 GEOGRAPHIC INFORMATION DIVISION
 IN COOPERATION WITH THE
U.S. DEPARTMENT OF TRANSPORTATION
FEDERAL HIGHWAY ADMINISTRATION
 MUNICIPAL CODE 14 221
 THIS MAP IS PUBLISHED AS A SUPPLEMENTAL
 DOCUMENTATION OF LIQUID FUELS TAX FUND MILEAGES
 REVISED PER FORM 990 DATED 10-29-20

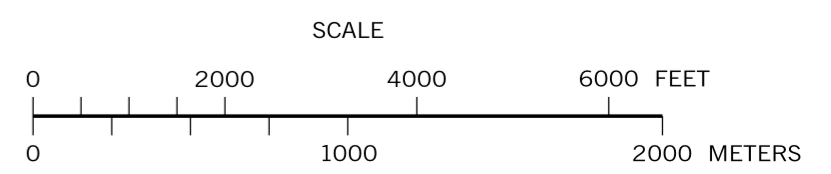

COPIES OF THIS MAP ARE AVAILABLE AT NOMINAL COST
 CONTACT:
 PENNSYLVANIA DEPARTMENT OF TRANSPORTATION
 SALES STORE
 P.O. BOX 3451
 HARRISBURG, PENNSYLVANIA 17105-3451
 TELEPHONE: (717) 797-6746