

TOTAL MILES
 Borough Road System 19.13
 State Highway System 10.95
 Total 30.08

COPIES OF THIS MAP ARE AVAILABLE AT NOMINAL COST
 CONTACT:
 PENNSYLVANIA DEPARTMENT OF TRANSPORTATION
 SALES STORE
 P.O. BOX 3451
 HARRISBURG, PENNSYLVANIA 17105-3451
 TELEPHONE: (717)787-6746

POPULATION 4,781
 (2010 Census)

LEGEND

- LIMITED ACCESS HIGHWAY
- STATE ROUTE AND NUMBER
- STATE MAINTAINED BRIDGE ON BOROUGH STREET
- BOROUGH STREET NAME AND SEGMENT LENGTH IN MILES
- TURNBACK BOROUGH STREET
- BOROUGH ALLEY
- OTHER ROAD
- RAILROAD
- STATE BOUNDARY
- COUNTY BOUNDARY
- TOWNSHIP BOUNDARY
- CITY BOUNDARY
- BOROUGH BOUNDARY
- MUNICIPAL BUILDING
- SPLIT MILEAGE BETWEEN MUNICIPALITIES
- SCHOOL, COLLEGE OR UNIVERSITY
- POINT OF INTEREST

CANAL ST
 CARBON AV
 CEDAR AV
 CENTER AV
 CENTER ST
 CHAPMAN ST
 CHERRY AV
 CHESTNUT AV
 CHIPMUNK TR
 CYPRESS ST
 EIGHTH ST
 ELEVENTH ST
 FAIRVIEW ST
 FERN ST
 FIFTH ST
 FLAGSTAFF RD
 FOURTH ST
 FRONT ST
 GERMANTOWN RD
 HIGH ST
 HILL RD
 LAUREL ST
 LEHIGH ST
 MAIN ST
 MAPLE AV
 MAPLE ST
 MAUCH CHUNK LA
 NINTH ST
 NORTH AV
 NORTH ST
 OAK ST
 PACKER HILL RD
 PINE AV
 PINE ST
 POPLAR AV
 QUARRY ST
 RACE ST
 RIVER RD
 RIVER ST
 SCHOOL ST
 SECOND ST
 SEVENTH ST
 SILK ST
 SIXTH ST
 SNYDER ST
 SOUTH AV
 SOUTH ST
 SPRING ST
 SPRUCE AV
 SUSQUEHANNA ST
 TENTH ST
 THIRD ST
 THIRTEENTH ST
 WALNUT AV
 WHITE LA

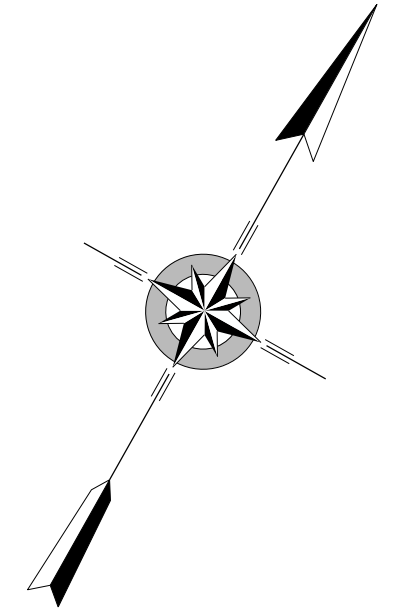
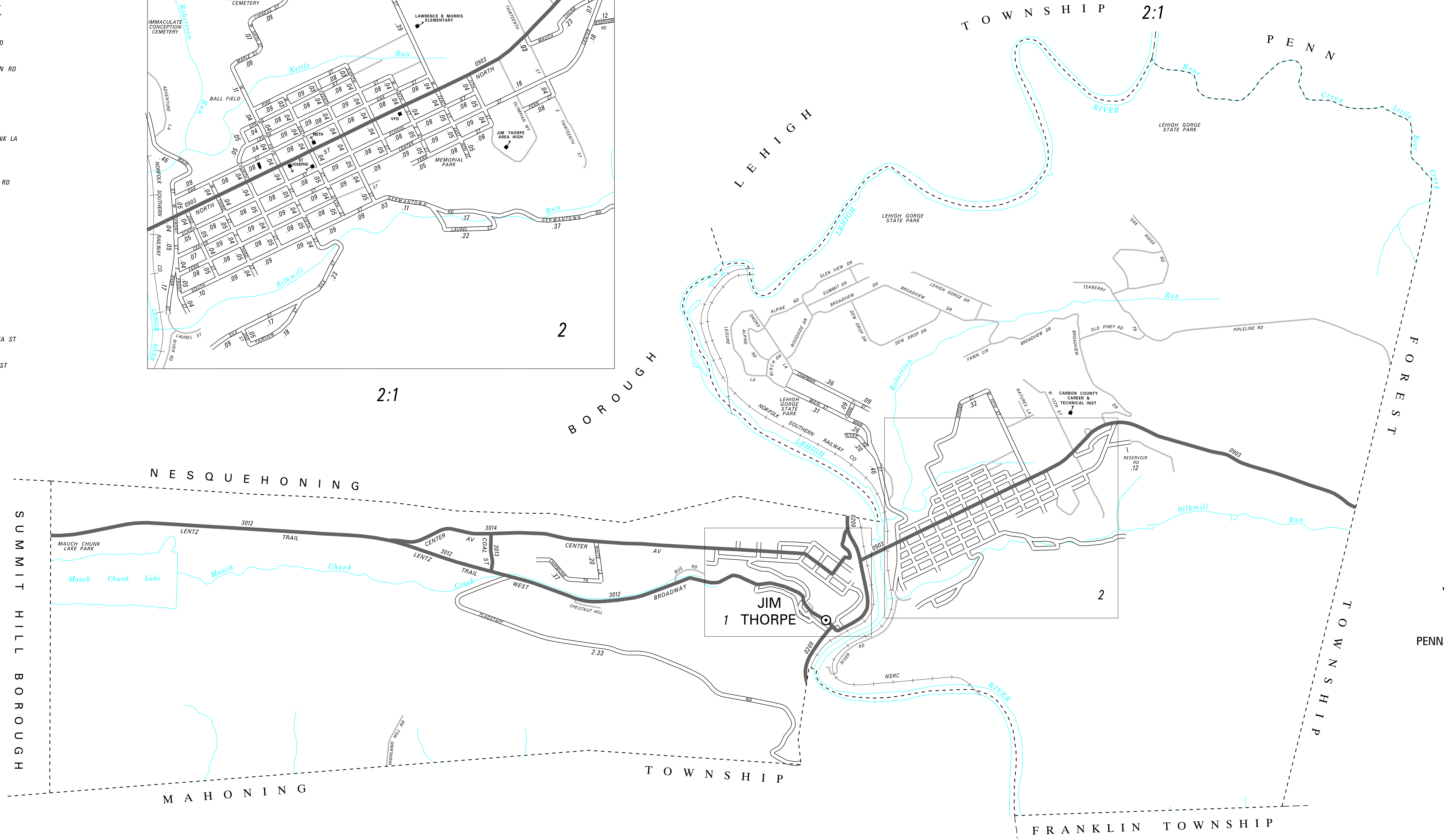
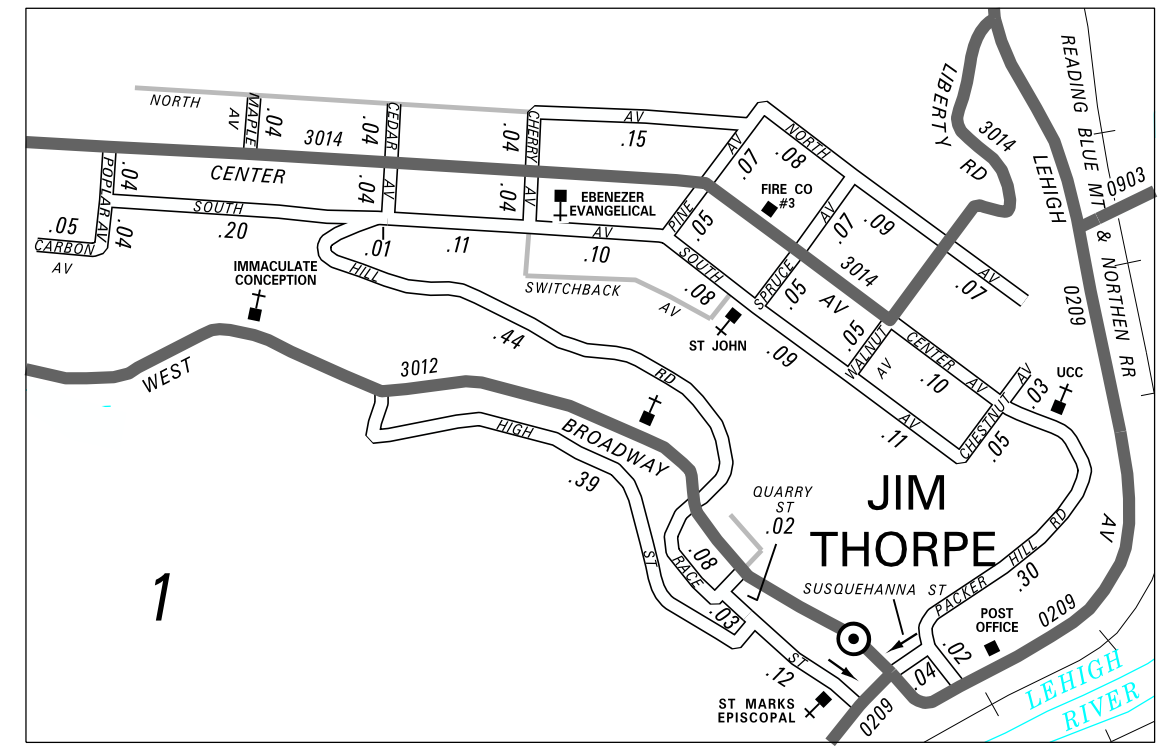
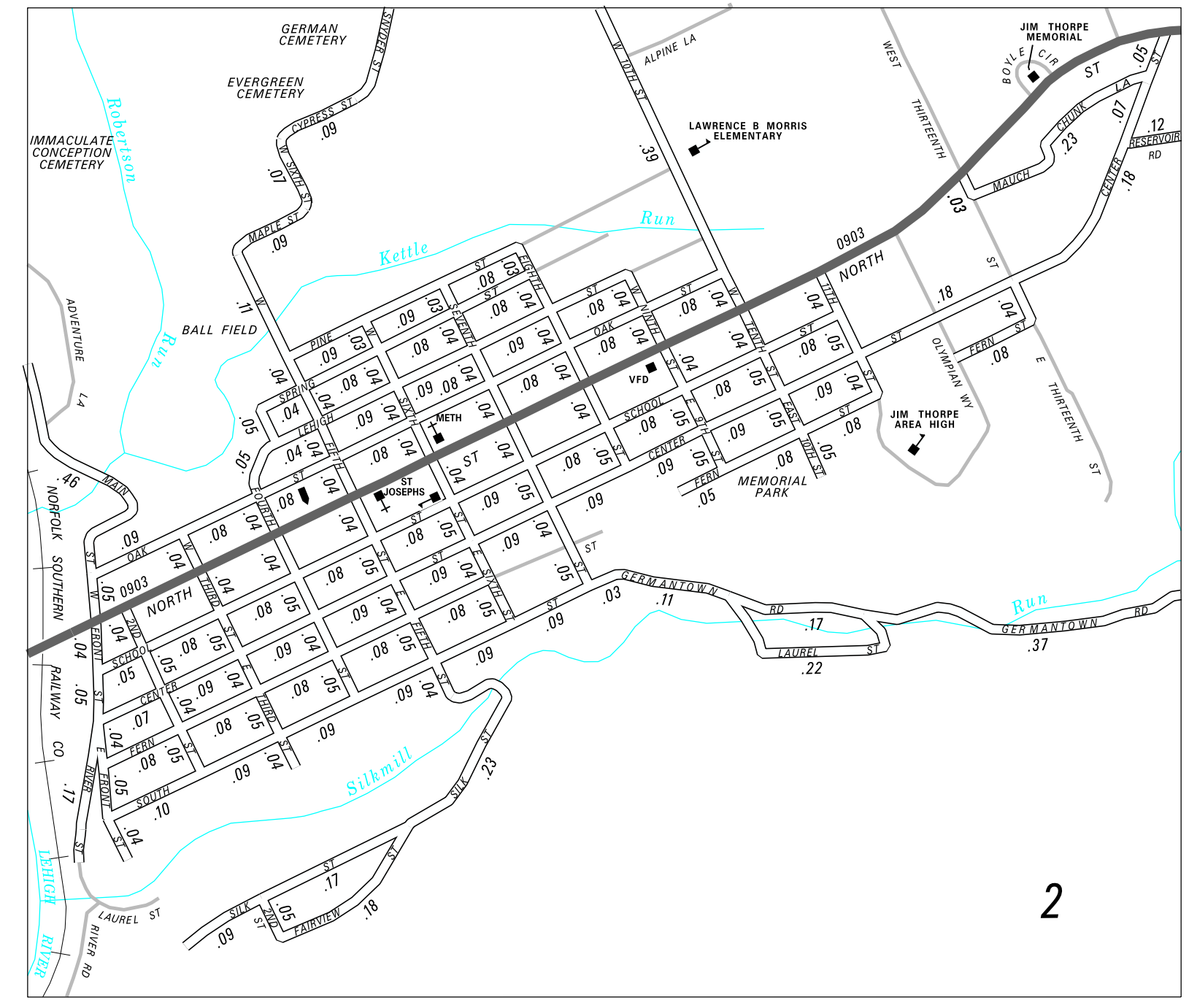

JIM THORPE BOROUGH
CARBON COUNTY
 PREPARED BY THE
PENNSYLVANIA DEPARTMENT OF TRANSPORTATION
 BUREAU OF PLANNING AND RESEARCH
 GEOGRAPHIC INFORMATION DIVISION
 IN COOPERATION WITH THE
 U.S. DEPARTMENT OF TRANSPORTATION
 FEDERAL HIGHWAY ADMINISTRATION
 AND
 MUNICIPAL SERVICES DISTRICT 5-0
 MUNICIPAL CODE 13 404
 THIS MAP IS PUBLISHED AS A SUPPLEMENTAL
 DOCUMENTATION OF LIQUID FUELS TAX FUND MILEAGES
 REVISED PER FORM 990 DATED 12-6-18

