

LEGEND

- LIMITED ACCESS HIGHWAY
- STATE ROUTE AND NUMBER
- STATE MAINTAINED BRIDGE ON TOWNSHIP ROAD
- TOWNSHIP ROAD, NUMBER AND SEGMENT LENGTH IN MILES
- IMPASSABLE TOWNSHIP ROAD
- TURNBACK TOWNSHIP ROAD
- OTHER ROAD
- RAILROAD (IN SERVICE)
- RAILROAD ABANDONED (TRACK RETAINED)
- STATE BOUNDARY
- COUNTY BOUNDARY
- TOWNSHIP BOUNDARY
- CITY OR BOROUGH BOUNDARY
- MUNICIPAL BUILDING
- SPLIT MILEAGE BETWEEN MUNICIPALITIES

TOTAL MILES	
Township Road System	28.65
State Highway System	24.01
Total	52.66

POPULATION 3,046
(2020 Census)

2:1

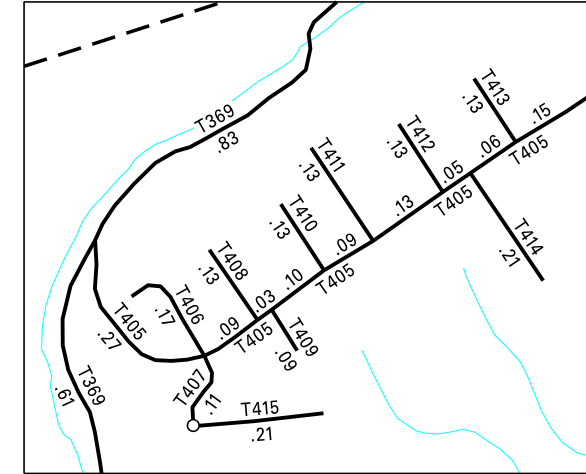

- 349 STONEY RIDGE RD
- 351 GOLF RD
- 353 CLUB RD
- 355 HEMLOCK ST
- 357 FIRELINE RD
- 358 SUNNY REST DR
- 359 BOYER FARM RD
- 360 DAIRY RD
- 361 WALNUT DR
- 363 DRIFT RD
- 364 MAPLE DR
- 365 HILL RD
- 366 HAZLEWOOD RD
- 367 HOLLOW RD
- 368 OAK ST
- 369 SPRUCE RD
- 370 SPRING RD
- 371 LOCUST DR
- 372 WINTERGREEN RD
- 373 GAP RD
- 374 HICKORY RD
- 375 SUNSET TERRACE DR
- 376 COVERED BRIDGE RD
- 377 KENNETH LA
- 378 FIFTYSEVEN RD
- 379 MENDELSON DR
- 380 LONESOME LA
- 382 MILL RD
- 384 RED HILL DR
- 400 PINE ST
- 401 LOWER ST
- 402 LESHER ST
- 403 BOULDER OAK DR
- 404 SPRINGHOUSE LA
- 405 FOREST DR
- 406 BALSAM WY
- 407 ASPEN RD
- 408 CEDAR WY
- 409 DOGWOOD WY
- 410 FIG WY
- 411 CINKGO WY
- 412 HAWTHORNE WY
- 413 JUNIPER RD
- 414 IRONWOOD RD
- 415 WOODS RD
- 416 DOUGLAS LA
- 528 SAND QUARRY RD
- 575 LA MONTAGE DR

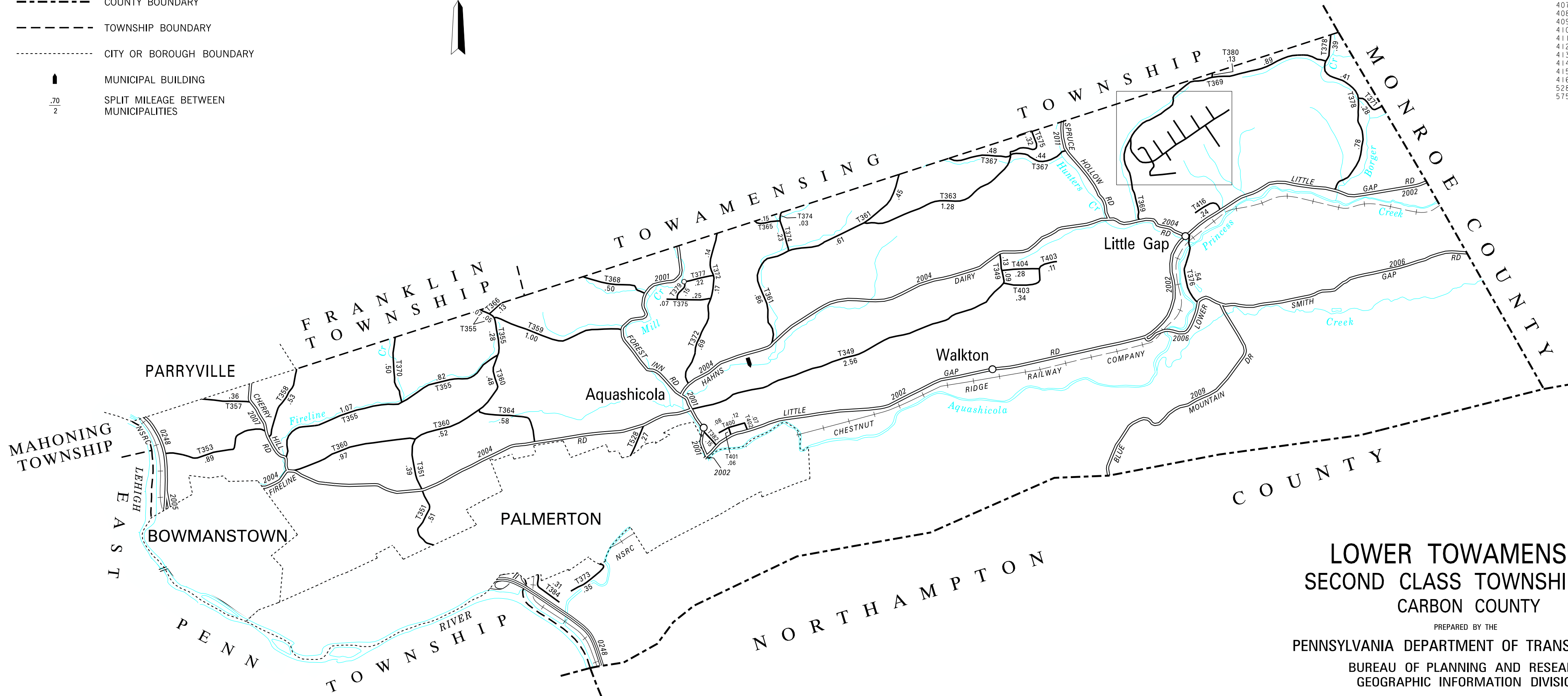

LOWER TOWAMENSING
SECOND CLASS TOWNSHIP MAP
CARBON COUNTY

PREPARED BY THE
PENNSYLVANIA DEPARTMENT OF TRANSPORTATION
BUREAU OF PLANNING AND RESEARCH
GEOGRAPHIC INFORMATION DIVISION
IN COOPERATION WITH THE
U.S. DEPARTMENT OF TRANSPORTATION
FEDERAL HIGHWAY ADMINISTRATION
MUNICIPAL CODE 13 207
THIS MAP IS PUBLISHED AS A SUPPLEMENTAL
DOCUMENTATION OF LIQUID FUELS TAX FUND MILEAGES
REVISED PER FORM 990 DATED 11-29-10

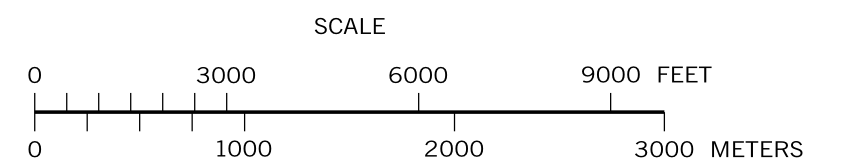

COPIES OF THIS MAP ARE AVAILABLE AT NOMINAL COST
CONTACT:
PENNSYLVANIA DEPARTMENT OF TRANSPORTATION
SALES STORE
P.O. BOX 3451
HARRISBURG, PENNSYLVANIA 17105-3451
TELEPHONE: (717)787-6746