

CHESTNUT ST  
 CHURCH ST  
 CLINTON ST  
 DEERPATH RD  
 DRIFTWOOD AV  
 FOURTH ST  
 IVY ST  
 KARTHaus MOUNTAIN RD  
 PINE ST  
 SECOND ST  
 VINE ST  
 WATER ST  
 WYE ST

POPULATION 67  
 (2010 Census)

TOTAL MILES  
 Borough Road System 2.53  
 State Highway System 2.48  
 Total 5.01

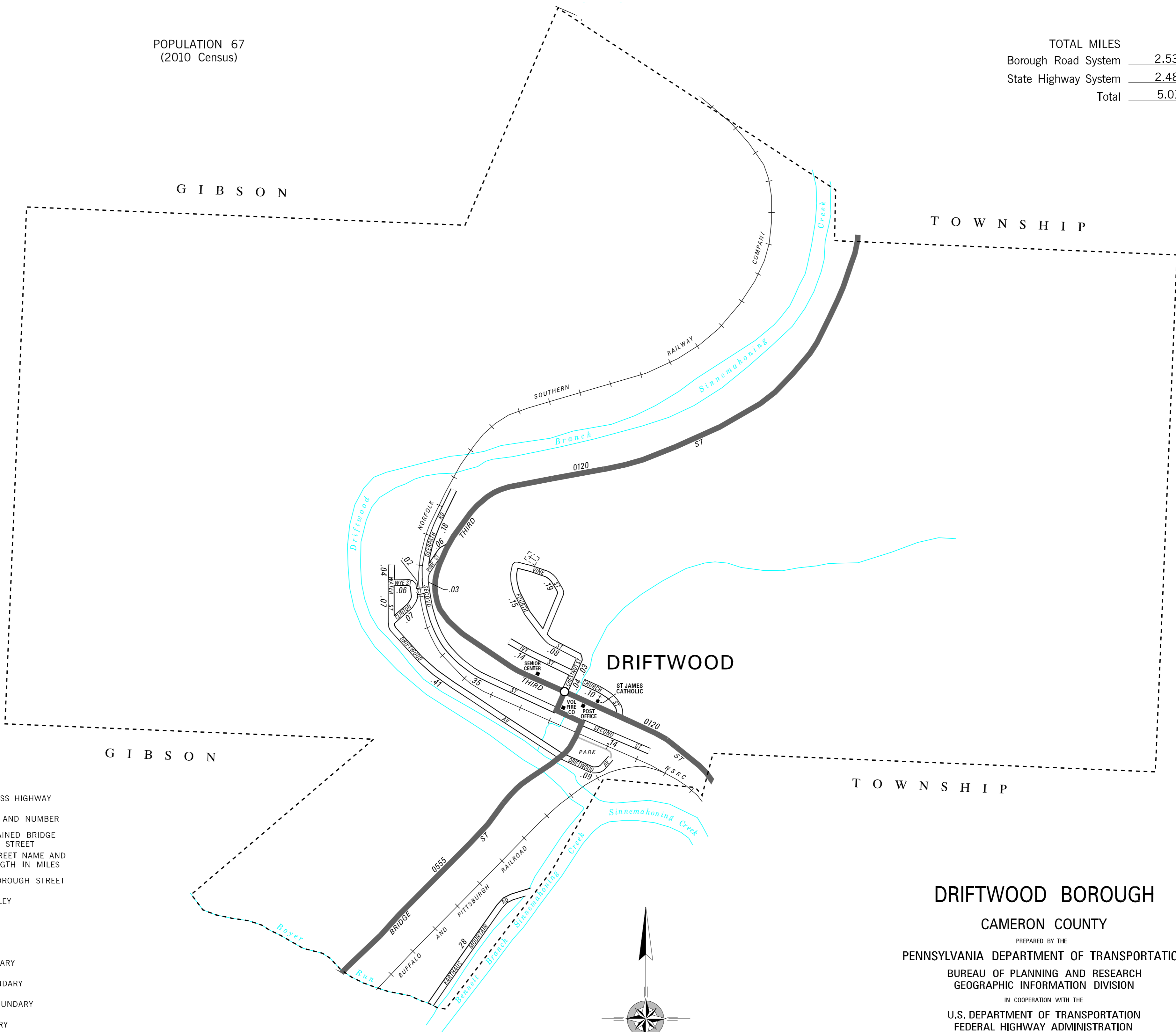

**LEGEND**

- LIMITED ACCESS HIGHWAY
- STATE ROUTE AND NUMBER
- STATE MAINTAINED BRIDGE ON BOROUGH STREET
- BOROUGH STREET NAME AND SEGMENT LENGTH IN MILES
- TURNBACK BOROUGH STREET
- BOROUGH ALLEY
- OTHER ROAD
- RAILROAD
- STATE BOUNDARY
- COUNTY BOUNDARY
- TOWNSHIP BOUNDARY
- CITY BOUNDARY
- BOROUGH BOUNDARY
- MUNICIPAL BUILDING
- SPLIT MILEAGE BETWEEN MUNICIPALITIES
- SCHOOL, COLLEGE OR UNIVERSITY
- POINT OF INTEREST

**DRIFTWOOD BOROUGH**

CAMERON COUNTY

PREPARED BY THE  
 PENNSYLVANIA DEPARTMENT OF TRANSPORTATION  
 BUREAU OF PLANNING AND RESEARCH  
 GEOGRAPHIC INFORMATION DIVISION  
 IN COOPERATION WITH THE  
 U.S. DEPARTMENT OF TRANSPORTATION  
 FEDERAL HIGHWAY ADMINISTRATION  
 AND  
 MUNICIPAL SERVICES DISTRICT 2-0  
 MUNICIPAL CODE 12 401  
 REVISED PER FORM 990 DATED 4-13-11

