

TOTAL MILES
 Township Road System 56.81
 State Highway System 25.97
 Total 82.78

COPIES OF THIS MAP ARE AVAILABLE AT NOMINAL COST
 CONTACT:
 PENNSYLVANIA DEPARTMENT OF TRANSPORTATION
 SALES STORE
 P.O. BOX 3403
 HARRISBURG, PENNSYLVANIA 17105-3451
 TELEPHONE: (717) 787-6146

POPULATION 5,752
 (2020 Census)

LEGEND

- LIMITED ACCESS HIGHWAY
- STATE ROUTE AND NUMBER
- STATE MAINTAINED BRIDGE ON TOWNSHIP ROAD
- TOWNSHIP ROAD, NUMBER AND SEGMENT LENGTH IN MILES
- IMPASSABLE TOWNSHIP ROAD
- TURNBACK TOWNSHIP ROAD
- OTHER ROAD
- RAILROAD (IN SERVICE)
- RAILROAD ABANDONED (TRACK RETAINED)
- STATE BOUNDARY
- COUNTY BOUNDARY
- TOWNSHIP BOUNDARY
- CITY OR BOROUGH BOUNDARY
- MUNICIPAL BUILDING
- SPLIT MILEAGE BETWEEN MUNICIPALITIES

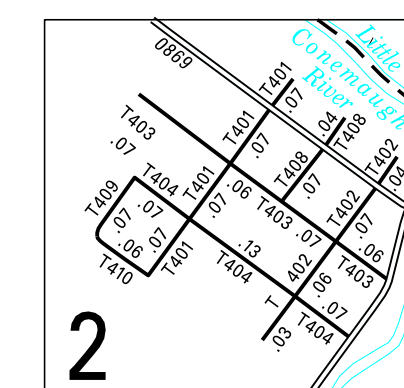

2:1

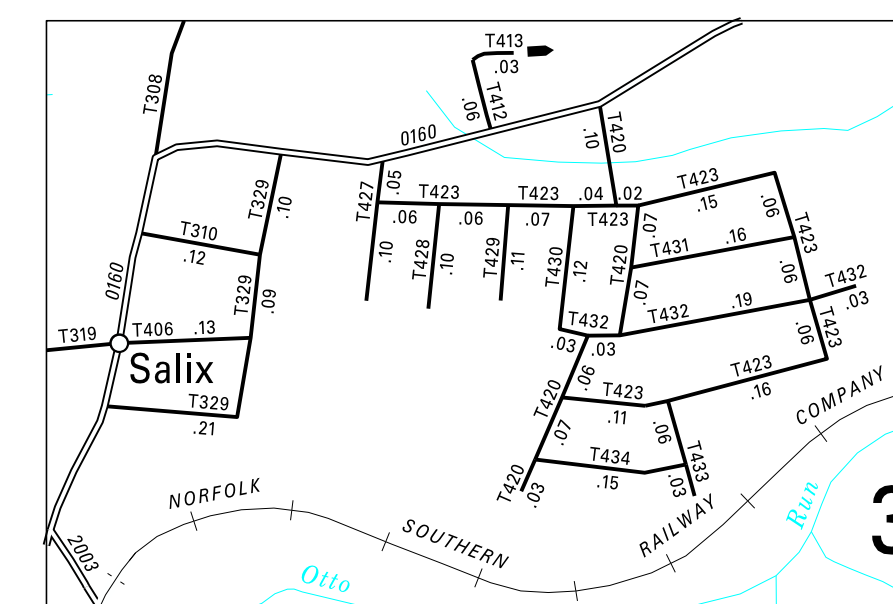

2:1

- 300 WINE 42 RD
- 301 PETIA RD
- 302 MT ARRY RD
- 303 OLD BEDFORD PK
- 304 PIPELINE RD
- 305 10TH ST
- 308 WPA RD
- 309 COULTER ST
- 310 SCHOOL ST
- 316 PALESTINE RD
- 319 OAKRIDGE RD
- 320 MT HOPE RD
- 321 GRAM LINTON RD
- 322 WATER DAM RD
- 323 WEAVER RD
- 324 HELSEL RD
- 325 WIM DR
- 326 KRAYON RD
- 327 HUB LA
- 328 SADDLE CLUB RD
- 329 WISSINGER ST
- 330 SEBESTOWN RD
- 331 PITCAIRN AV
- 332 BLUE RD
- 333 BUNMARDNER RD
- 334 RAILROAD ST
- 335 CLUB RD
- 338 DONOHUE ST
- 340 RIBBERTS AV
- 341 CHEVY LA
- 342 CEDAR PRESS RD
- 344 TOPPER RD
- 345 FIFTY ACRE RD
- 348 ROCK DUMP RD
- 350 WISDOM ST
- 351 BEAGLE CLUB RD
- 358 RHODES CROSS RD
- 379 HOLLOW RD
- 380 COUNTRY INN RD
- 381 AMSTIE RD
- 382 MAIN ST
- 383 HARLEY ST
- 384 LIBERTY PARK RD
- 401 GROVE ST
- 402 MEADOW ST
- 403 CHURCH ST
- 404 CROWN ST
- 405 WOLF ST
- 406 CENTER ST
- 407 FIRST ST
- 408 MAPLE ST
- 409 PARK ST
- 410 HILL ST
- 411 SHERRY ST
- 412 MARY DR
- 413 WAXINE DR
- 420 ADAMS DR
- 423 BEAUTYLINE DR
- 427 MAPLE CT
- 428 PINE CT
- 429 SPRUCE CT
- 430 WILLOW DR
- 431 POPLAR DR
- 432 HICKORY DR
- 433 REDWOOD DR
- 434 LOCUST DR
- 435 CATHERINE DR
- 500 RIDGEVIEW DR
- 501 CRESVIEW DR
- 502 GARDNER AV
- 503 BALOW AV
- 504 SECOND ST
- 508 PINE ST
- 509 BEACH ST
- 510 OAK ST
- 511 LUTHER ST
- 512 HEMLOCK ST
- 513 MAPLE PARK ST
- 514 WOOD ST
- 515 WILDER RD
- 516 WILDER LA
- 600 LAKE AV
- 601 PARKWAY AV
- 602 STATION ST
- 603 MARKET ST
- 604 BRIDGE ST
- 605 FRANKLIN ST
- 606 FIRST ST
- 607 WATER AV
- 608 SCHOOL RD
- 609 MARYLAND AV
- 610 HILLSIDE AV
- 612 CRESO AV
- 613 FOURTH ST
- 614 FIFTH ST
- 615 SIXTH ST
- 616 FOX DR
- 617 CHAPEL ST
- 618 NEALYN DR
- 620 KELLY DR
- 631 CLARITH DR
- 635 GLORY RD
- 640 BRENDA LN LA
- 641 LYN LA
- 642 BOYD LA
- 643 KIM LA
- 644 USHAD LA
- 645 WINE 42 RD EXT
- 763 LLOYD ST
- 764 ODULA ST

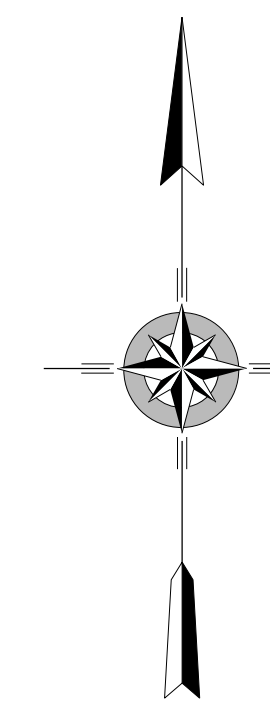

ADAMS
 SECOND CLASS TOWNSHIP MAP
 CAMBRIA COUNTY

PREPARED BY THE
 PENNSYLVANIA DEPARTMENT OF TRANSPORTATION
 BUREAU OF PLANNING AND RESEARCH
 GEOGRAPHIC INFORMATION DIVISION

IN COOPERATION WITH THE
 U.S. DEPARTMENT OF TRANSPORTATION
 FEDERAL HIGHWAY ADMINISTRATION

MUNICIPAL CODE 11 201
 THIS MAP IS PUBLISHED AS A SUPPLEMENTAL
 DOCUMENTATION OF LIQUID FUELS TAX FUND MILEAGES
 REVISED PER FORM 990 DATED 6-17-11

