

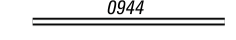

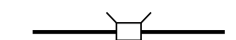

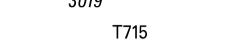

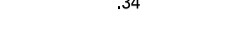



TOTAL MILES
 Township Road System 41.19
 State Highway System 29.85
 Total 71.04

POPULATION 6,585
 (2020 Census)

LEGEND

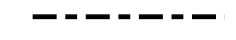
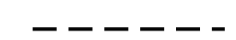
-  LIMITED ACCESS HIGHWAY
-  STATE ROUTE AND NUMBER
-  STATE MAINTAINED BRIDGE ON TOWNSHIP ROAD
-  TOWNSHIP ROAD, NUMBER AND SEGMENT LENGTH IN MILES
-  IMPASSABLE TOWNSHIP ROAD
-  TURNBACK TOWNSHIP ROAD
-  OTHER ROAD
-  RAILROAD (IN SERVICE)
-  RAILROAD ABANDONED (TRACK RETAINED)
-  STATE BOUNDARY
-  COUNTY BOUNDARY
-  TOWNSHIP BOUNDARY
-  CITY OR BOROUGH BOUNDARY
-  MUNICIPAL BUILDING
-  SPLIT MILEAGE BETWEEN MUNICIPALITIES

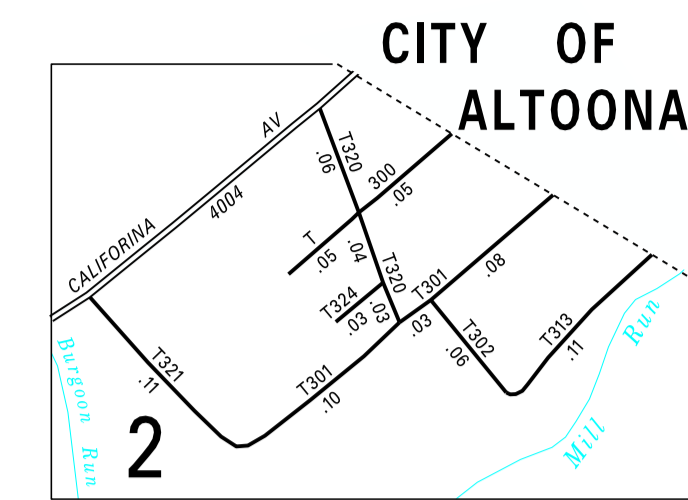

3:1

- 300 OHIO AV
- 301 MARYLAND AV
- 302 FIFTYNINTH ST
- 303 SHORT ST
- 304 BRIDGE LA
- 305 HUMMINGBIRD LA
- 306 WILLIAMS DR
- 307 HILLTOP DR
- 308 SPRANGL AV
- 309 WOODS ST
- 310 SUNBROOK DR
- 311 BRIAN AV
- 312 SCOTT ST
- 313 KENTUCKY AV
- 314 GILDA DR
- 315 FURNACE RD
- 316 PICKAWANTAS RD
- 317 BARD ST
- 320 HOWDY'S MOUNTAIN RD
- 321 ELLENBERGER DR
- 322 POUND LA
- 323 CARSON HEIGHTS RD
- 324 WEST AV
- 325 LEHIGH DR
- 326 SCENIC PINE DR
- 360 HICKORY LA
- 380 TINDLES DR
- 384 FOOT OF TEN RD
- 386 DRY RUN RD
- 388 COUNTRAIL DR
- 401 WASHINGTON ST
- 402 LARSON ST
- 406 MILL RD
- 410 MASON DR
- 411 BEAR HOLLOW RD
- 412 VISION DR
- 413 LEGATY LA
- 414 MAPLE HOLLOW RD
- 415 KUNN LA
- 416 CARSON VALLEY RD
- 417 KNEE LA
- 420 PLETCHER DR
- 421 LAUREL RD
- 424 LONGVIEW DR
- 425 WEST CARSON VALLEY RD
- 426 SPENCER CREEK DR
- 428 HEALY DR
- 431 EMERALD DR
- 432 BURNS AV
- 433 CHURCH RD
- 437 YOUNGS CROSSING RD
- 438 FOREVER DR
- 440 MILE HILL RD
- 442 OSBORN LA
- 443 SIXTYFIFTH ST
- 446 MUNICIPAL DR
- 448 CHERRY DR
- 450 WATER ST
- 451 BEACON ST
- 452 FRUIT ST
- 454 THEATER DR
- 455 GOLFVIEW DR
- 461 OAK AV
- 462 VIFOND ST
- 463 TREE LA
- 464 ELM LA
- 465 DOGWOOD LA
- 466 HENWOOD LA
- 467 ASPEN LA
- 554 HARMONY DR
- 556 MOUNTAIN AV
- 557 MARBLE ST
- 558 LIMESTONE ST
- 559 WERTZ AV
- 560 FRANKMONT DR
- 561 DEERFIELD AV
- 562 PIONEER DR
- 564 CAMPBELL DR
- 565 RAIBLE DR
- 566 SPRING MEADOW DR
- 570 TOWNHOUSE DR
- 571 PIEDMONT DR
- 572 CRESTVIEW DR
- 573 WILWOOD DR
- 574 APPLE ST
- 575 SYLVAN CREST DR
- 576 ESTATE DR
- 577 ELKVIEW DR
- 580 AUTUMN DR
- 581 WINDVALE DR
- 582 STARLIGHT DR
- 583 TIMBERLAKE LA
- 584 SELLERS DR
- 585 COGAN DR
- 586 COCHRAN DR
- 587 CHICKEN RUN DR
- 588 FOX HOLLOW DR
- 589 RED FOX DR
- 591 HUNTERS PASS DR
- 592 FOX CHASE DR
- 593 HOLLOW RUN TRAIL
- 594 PADDOCK CIR
- 595 LIXTON RD
- 596 HIDDEN VALLEY DR
- 597 DEER TRACK RD
- 598 STIRRUP CIR

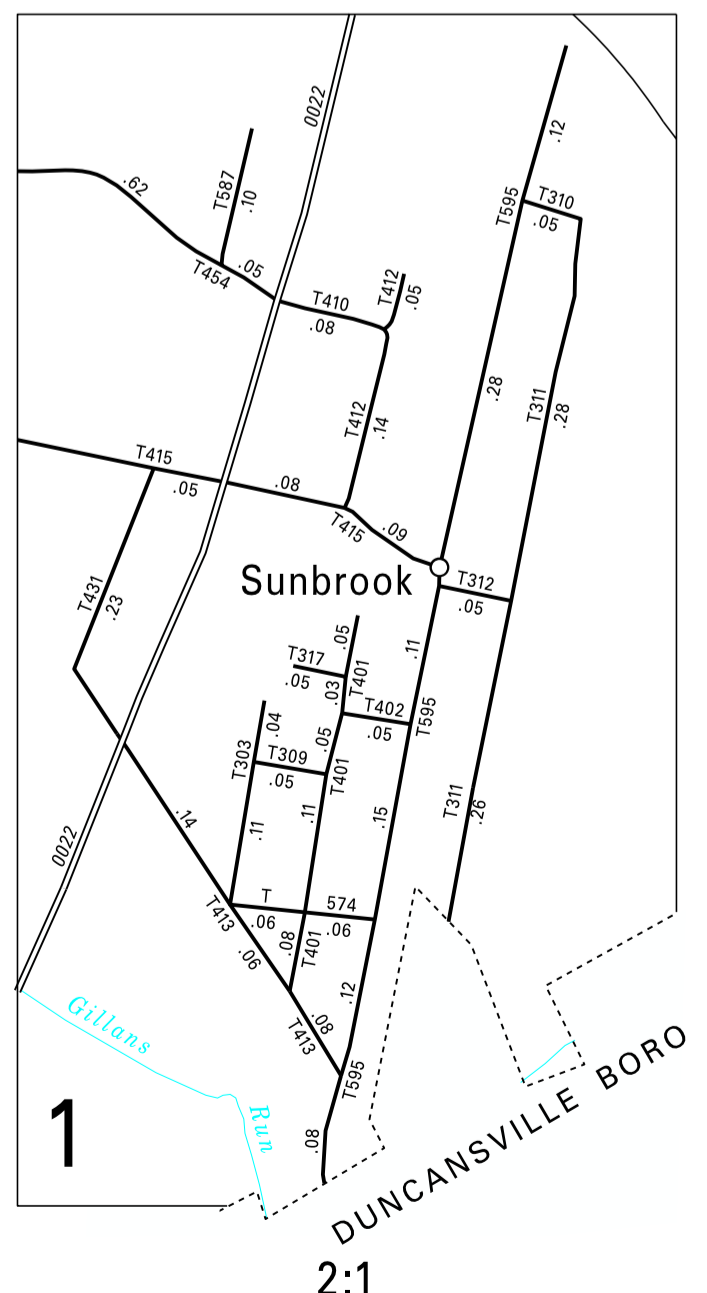

2:1

COPIES OF THIS MAP ARE AVAILABLE AT NOMINAL COST
 CONTACT:
 PENNSYLVANIA DEPARTMENT OF TRANSPORTATION
 SALES STORE
 P.O. BOX 345
 HARRISBURG, PENNSYLVANIA 17105-345
 TELEPHONE: (717) 787-6746

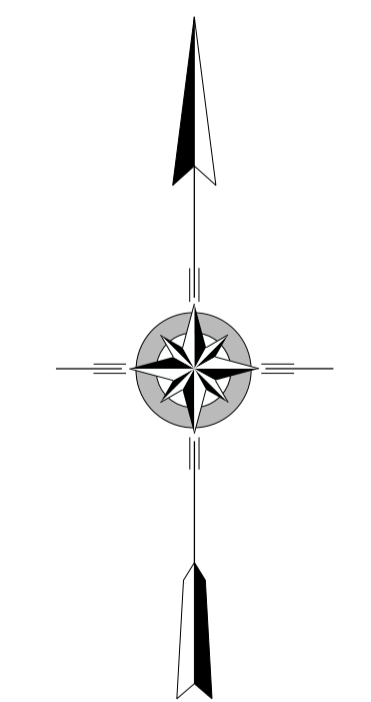

ALLEGHENY
 SECOND CLASS TOWNSHIP MAP
 BLAIR COUNTY

PREPARED BY THE
 PENNSYLVANIA DEPARTMENT OF TRANSPORTATION
 BUREAU OF PLANNING AND RESEARCH
 GEOGRAPHIC INFORMATION DIVISION
 IN COOPERATION WITH THE
 U.S. DEPARTMENT OF TRANSPORTATION
 FEDERAL HIGHWAY ADMINISTRATION
 MUNICIPAL CODE 07 201
 THIS MAP IS PUBLISHED AS A SUPPLEMENTAL
 DOCUMENTATION OF LIQUID FUELS TAX FUND MILEAGES
 REVISED PER FORM 990 DATED 6-13-19

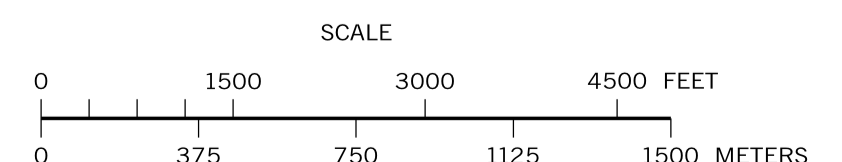

SCALE
 TYPE 5 MAP ALLEGHENY TOWNSHIP BLAIR COUNTY PENNSYLVANIA