

TOTAL MILES	
Borough Road System	8.17
State Highway System	1.60
Total	9.77

POPULATION 2,036  
(2000 Census)

LEGEND

- LIMITED ACCESS HIGHWAY
- STATE ROUTE AND NUMBER
- STATE MAINTAINED BRIDGE ON BOROUGH STREET
- BOROUGH STREET NAME AND SEGMENT LENGTH IN MILES
- TURNBACK BOROUGH STREET
- BOROUGH ALLEY
- OTHER ROAD
- RAILROAD
- STATE BOUNDARY
- COUNTY BOUNDARY
- TOWNSHIP BOUNDARY
- CITY BOUNDARY
- BOROUGH BOUNDARY
- MUNICIPAL BUILDING
- SPLIT MILEAGE BETWEEN MUNICIPALITIES
- SCHOOL, COLLEGE OR UNIVERSITY
- POINT OF INTEREST

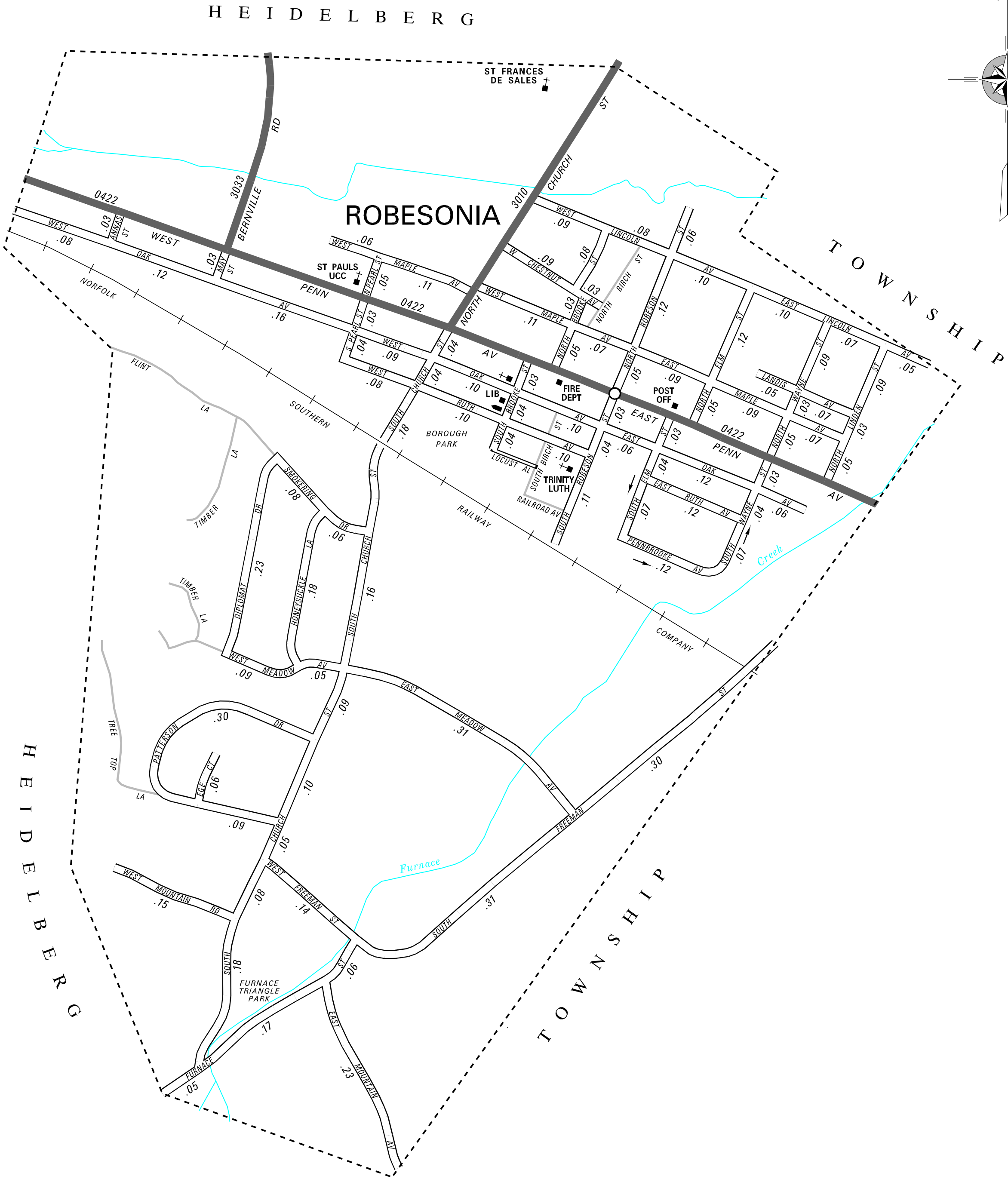
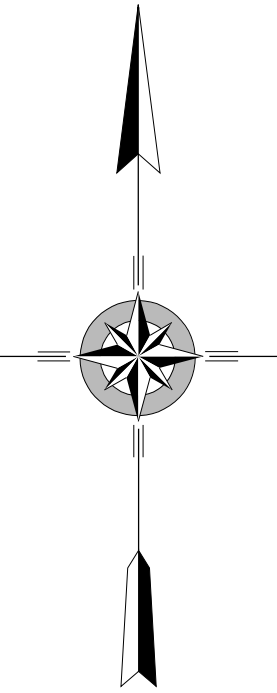

- ANNAS ST
- BROOKE ST
- CHESTNUT AV
- CHURCH ST
- DIPLOMAT DR
- EGE CT
- ELM ST
- FREEMAN ST
- FURNACE ST
- HONEYSUCKLE LA
- LANDIS AV
- LINCOLN AV
- LINDEN ST
- MAPLE AV
- MAY ST
- MEADOW AV
- MOUNTAIN AV
- MOUNTAIN RD
- OAK AV
- PATTERSON DR
- PEARL ST
- PENN BROOKE AV
- ROBESON ST
- RUTH AV
- SMOKING DR
- WAYNE ST



ROBESONIA BOROUGH

BERKS COUNTY

PREPARED BY THE  
PENNSYLVANIA DEPARTMENT OF TRANSPORTATION  
BUREAU OF PLANNING AND RESEARCH  
GEOGRAPHIC INFORMATION DIVISION  
IN COOPERATION WITH THE  
U.S. DEPARTMENT OF TRANSPORTATION  
FEDERAL HIGHWAY ADMINISTRATION  
AND  
MUNICIPAL SERVICES DISTRICT 5-0  
MUNICIPAL CODE 06 416  
REVISED PER FORM 990 DATED 10-27-95

