

TOTAL MILES	
Borough Road System	2.27
State Highway System	1.29
Total	3.56

POPULATION 478  
(2010 Census)

LEGEND

- LIMITED ACCESS HIGHWAY
- 0944 STATE ROUTE AND NUMBER
- 3019 STATE MAINTAINED BRIDGE ON BOROUGH STREET
- OAK ST .15 BOROUGH STREET NAME AND SEGMENT LENGTH IN MILES
- TURNBACK BOROUGH STREET
- BOROUGH ALLEY
- OTHER ROAD
- RAILROAD
- STATE BOUNDARY
- COUNTY BOUNDARY
- TOWNSHIP BOUNDARY
- CITY BOUNDARY
- BOROUGH BOUNDARY
- MUNICIPAL BUILDING
- .70  
2 SPLIT MILEAGE BETWEEN MUNICIPALITIES
- SCHOOL, COLLEGE OR UNIVERSITY
- POINT OF INTEREST

ASH ST  
BIRCH ST  
BROCK ST  
HUNTER ST  
KEMP ST  
MAIN ST  
MAPLE ST  
MILL ST  
NORTH RAILROAD ST  
PARK AV  
PENN ST  
PINE ST  
SOUTH RAILROAD ST  
STOLTZ ST  
WILLOW ST

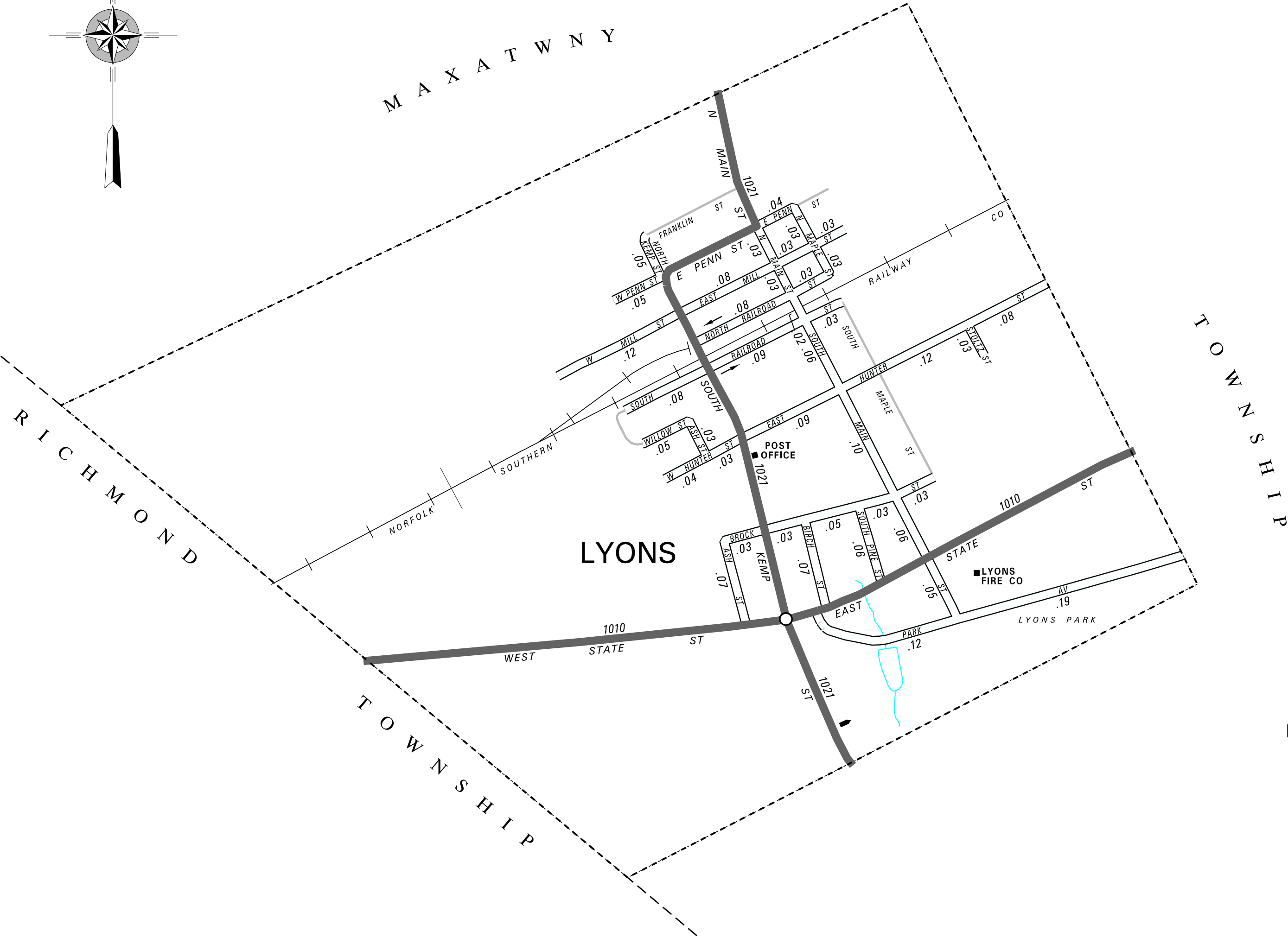

LYONS BOROUGH

BERKS COUNTY

PREPARED BY THE  
PENNSYLVANIA DEPARTMENT OF TRANSPORTATION  
BUREAU OF PLANNING AND RESEARCH  
GEOGRAPHIC INFORMATION DIVISION  
IN COOPERATION WITH THE  
U.S. DEPARTMENT OF TRANSPORTATION  
FEDERAL HIGHWAY ADMINISTRATION  
AND  
MUNICIPAL SERVICES DISTRICT 5-0  
MUNICIPAL CODE 06 413  
THIS MAP IS PUBLISHED AS A SUPPLEMENTAL  
DOCUMENTATION OF LIQUID FUELS TAX FUND MILEAGES  
REVISED PER FORM 990 DATED 1-26-07

COPIES OF THIS MAP ARE AVAILABLE AT NOMINAL COST  
CONTACT:  
PENNSYLVANIA DEPARTMENT OF TRANSPORTATION  
SALES STORE  
P.O. BOX 3451  
HARRISBURG, PENNSYLVANIA 17105-3451  
TELEPHONE: (717) 787-6746

