

TOTAL MILES  
 Township Road System 64.91\*  
 State Highway System 27.80  
 Total 92.71

\* Includes ACT 32 Turnback Mileage of 2.65

POPULATION 13,396  
 (2020 Census)

LEGEND

- LIMITED ACCESS HIGHWAY
- STATE ROUTE AND NUMBER
- STATE MAINTAINED BRIDGE ON TOWNSHIP ROAD
- TOWNSHIP ROAD, NUMBER AND SEGMENT LENGTH IN MILES
- IMPASSABLE TOWNSHIP ROAD
- TURNBACK TOWNSHIP ROAD
- OTHER ROAD
- RAILROAD (IN SERVICE)
- RAILROAD ABANDONED (TRACK RETAINED)
- STATE BOUNDARY
- COUNTY BOUNDARY
- TOWNSHIP BOUNDARY
- CITY OR BOROUGH BOUNDARY
- MUNICIPAL BUILDING
- SPLIT MILEAGE BETWEEN MUNICIPALITIES

- |                         |                      |                            |
|-------------------------|----------------------|----------------------------|
| 355 TOWNSHIP LINE RD    | 665 ASPEN CT         | 721 VERDURE LA             |
| 414 HILLVIEW RD         | 666 HILL DR          | 722 WINDMEAD LA            |
| 443 MONACOY HILL RD     | 667 RIGA LA          | 723 ROSEWYN LA             |
| 444 MORLATON RD         | 668 FAIR MEADOW DR   | 724 POSTAL RD              |
| 458 VALLEY RD           | 669 ROSEWOOD DR      | 725 POSTAL ST              |
| 460 GULDIN RD           | 670 FERRY CT         | 726 OLD PHILADELPHIA PK    |
| 462 WALNUT LA           | 671 PINWOOD DR       | 727 NORTH MONACOY CREEK RD |
| 463 GEIGER DR           | 672 ROSEWOOD CT      | 728 CHEFIELD CT            |
| 464 HILL RD             | 673 SOUTH PINWOOD DR | 729 OXFORD CIR             |
| 465 MEETING HOUSE RD    | 674 NORTH PINWOOD DR | 730 BERKSHIRE DR           |
| 466 BROWNS HILL RD      | 675 DOCKWOOD DR      | 731 ASHFORD DR             |
| 468 AMITY PARK RD       | 676 REDWOOD DR       | 732 YORKSHIRE DR           |
| 469 BLACKSMITH RD       | 677 LILAC LA         | 733 LOYALSOCK DR           |
| 470 GILDE RD            | 678 ASH CT           | 734 ANTIETAM DR            |
| 471 LEVENWOOD RD        | 679 SPRUCE CT        | 735 SMATARA CIR            |
| 474 BIEBER LA           | 680 LILAC CT         | 736 GRAYS RUN LA           |
| 476 PINE LA             | 681 IVY CT           | 737 KETTLE LA              |
| 478 MACHAMER RD         | 682 AGATA DR         | 738 LEIORT LA              |
| 479 WORMAN RD           | 683 ARROWHEAD DR     | 739 WOODBRIDGE LA          |
| 484 SUNRISE LA          | 684 SHARON DR        | 740 FARMINGDALE DR         |
| 515 GOLLIUS DR          | 685 PINE LANE CT     | 741 SPRING VIEW DR         |
| 604 SHADYBROOKE DR      | 686 HEATHER CT       | 742 LONGFIELD DR           |
| 605 HIGHMEADOW DR       | 688 WOODBROOKE DR    | 743 TIMBERLINE DR          |
| 606 PEACH BLOSSOM DR    | 689 STEPHENS WAY     | 744 ORCHARD VIEW DR        |
| 607 SUMMER MEADOW DR    | 690 GALAHAD LA       | 745 HIGHLAND CT            |
| 608 MEADOWSIDE DR       | 691 COUNTRY LA       | 746 MARTIN LA              |
| 609 GREEN MEADOW DR     | 692 LEIMANN DR       | 747 PLEASANT VIEW DR       |
| 610 PHEASANT RUN CT     | 693 MULBERRY PL      | 748 CLARION DR             |
| 611 SCHOOLHOUSE CT      | 694 ELWOOD LA        | 749 WOODBRIDGE CT          |
| 612 OVERLOOK POINTE RD  | 695 BALSAM DR        | 750 SLATE RUN RD           |
| 613 THORNBURY CIR       | 696 LINDEN PL        | 751 INDIAN RUN DR          |
| 614 RISING SUN DR       | 697 MILLER DR        | 752 BRAMBLEWOOD LA         |
| 615 ROSECLIFF DR        | 698 EMILIO DR        | 753 MAPLE LA               |
| 616 BUCKHEAD LA         | 699 COLERGO DR       | 754 LEAF CREEK CT          |
| 617 PEPPER LA           | 700 YELLOWHOUSE DR   | 755 RODALE DR              |
| 618 AMITY AV            | 701 RIDGE DR         |                            |
| 619 CHARCOAL DR         | 702 FINE THORN DR    |                            |
| 620 ANVIL DR            | 703 THALIA LA        |                            |
| 621 FANCY HILL RD       | 704 NO NAME          |                            |
| 622 SPOTTS MILL RD      | 705 BRAMBLEWOOD DR   |                            |
| 623 WOODS EDGE DR       | 706 MIMOSA CIR       |                            |
| 624 HARMONY LA          | 707 WINDING CREEK DR |                            |
| 625 SERENITY CT         | 709 SENECA CT        |                            |
| 626 PENNSYLVANIA AV     | 710 WEAVERTOWN RD    |                            |
| 627 SERENITY DR         | 711 WEAVERTOWN LA    |                            |
| 628 SHORE AV            | 712 PENNS LA         |                            |
| 629 FIRST ST            | 713 BATTIENKILL DR   |                            |
| 630 FARM VIEW CT        | 714 CEDAR RUN DR     |                            |
| 631 THIRD ST            | 715 CAMERON DR       |                            |
| 632 FOURTH ST           | 716 KINGSTON DR      |                            |
| 633 QUEEN ANNE CIR      | 717 BRISTOL CT       |                            |
| 634 CRESTWOOD CT        | 718 MEADOWCREST LA   |                            |
| 635 AIRPORT RD          | 719 AVIEMORE LA      |                            |
| 636 GRIFFITH DR         | 720 FELWICK LA       |                            |
| 637 NICHOLSON AV        |                      |                            |
| 638 MERRITT AV          |                      |                            |
| 639 RICHARDS AV         |                      |                            |
| 640 VICTORIA DR         |                      |                            |
| 641 BRITTON ST          |                      |                            |
| 642 MAPLEWOOD CT        |                      |                            |
| 643 BRIARWOOD DR        |                      |                            |
| 644 FERNWOOD AV         |                      |                            |
| 645 ELLIOTT CT          |                      |                            |
| 646 HICKORY LA          |                      |                            |
| 647 JUNIPER DR          |                      |                            |
| 648 WELSH CT            |                      |                            |
| 649 WELSH DR            |                      |                            |
| 650 LAURELWOOD DR       |                      |                            |
| 651 HOLLY DR            |                      |                            |
| 652 ELLIOTT DR          |                      |                            |
| 653 PLEASANT MEADOWS DR |                      |                            |
| 654 MAPLEWOOD CT        |                      |                            |
| 655 POPLAR DR           |                      |                            |
| 656 MAGNOLIA DR         |                      |                            |
| 657 RUSSELL AV          |                      |                            |
| 658 GLENWOOD DR         |                      |                            |
| 659 WILLOWWOOD DR       |                      |                            |
| 660 APPLEWOOD DR        |                      |                            |
| 661 LAKE DR             |                      |                            |
| 662 BIRCHWOOD CT        |                      |                            |
| 663 MAGNOLIA CT         |                      |                            |
| 664 WILLOWWOOD CT       |                      |                            |

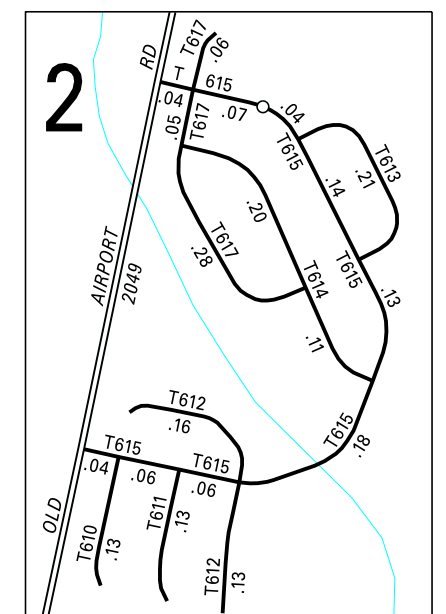
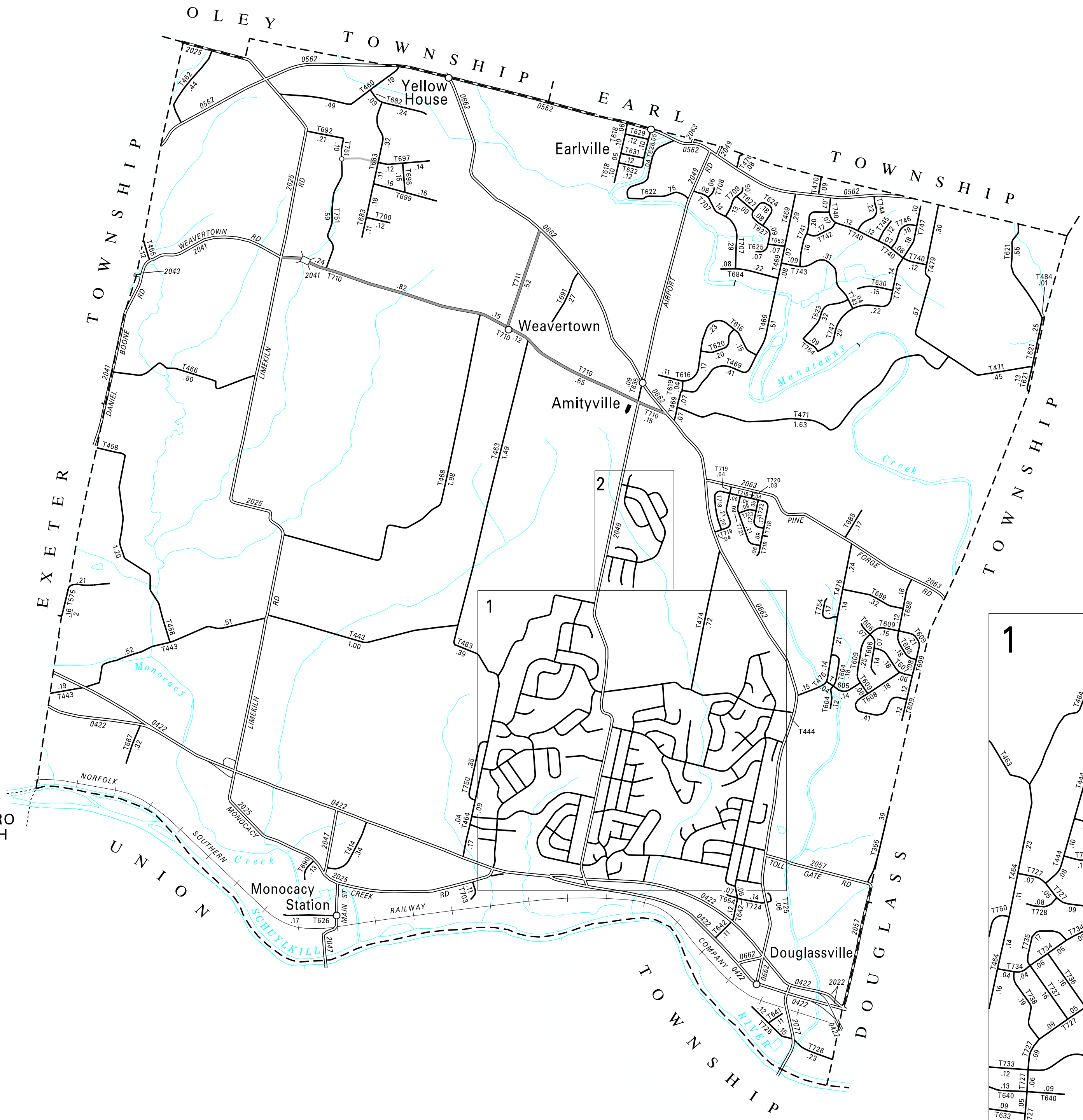

2:1

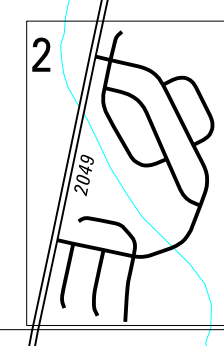

2:1

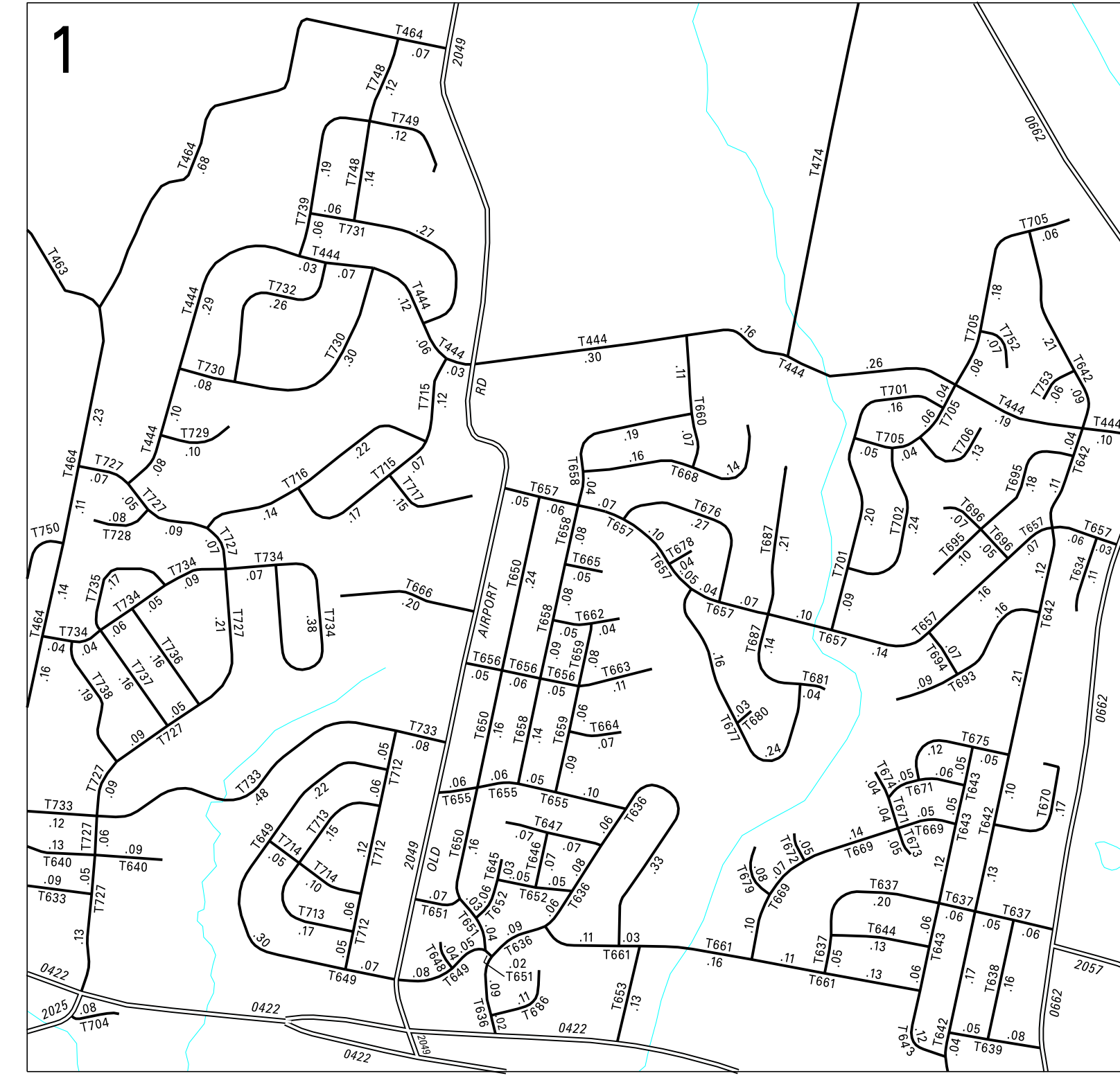

1

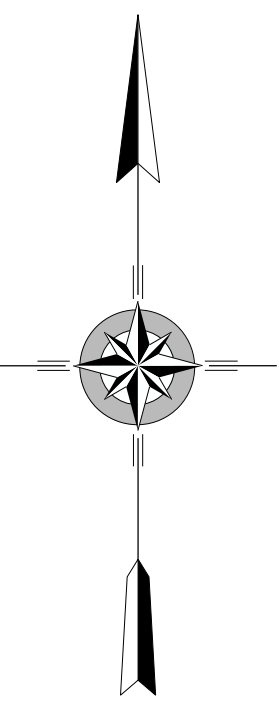

**AMITY**  
**SECOND CLASS TOWNSHIP MAP**  
**BERKS COUNTY**

PREPARED BY THE  
**PENNSYLVANIA DEPARTMENT OF TRANSPORTATION**  
 BUREAU OF PLANNING AND RESEARCH  
 GEOGRAPHIC INFORMATION DIVISION  
 IN COOPERATION WITH THE  
**U.S. DEPARTMENT OF TRANSPORTATION**  
 FEDERAL HIGHWAY ADMINISTRATION  
 MUNICIPAL CODE 06 203  
 THIS MAP IS PUBLISHED AS A SUPPLEMENTAL  
 DOCUMENTATION OF LIQUID FUELS TAX FUND MILEAGES  
 REVISED PER FORM 990 DATED 12-7-20

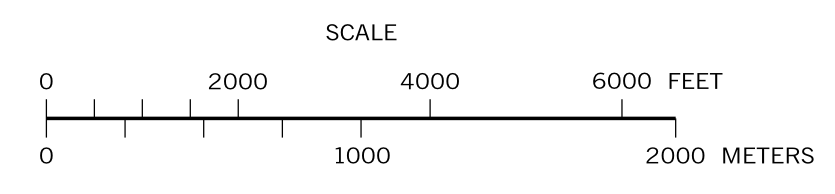

COPIES OF THIS MAP ARE AVAILABLE AT NOMINAL COST CONTACT:  
 PENNSYLVANIA DEPARTMENT OF TRANSPORTATION  
 SALES STORE  
 P.O. BOX 3451  
 HARRISBURG, PENNSYLVANIA 17105-3451  
 TELEPHONE: (717)787-6746