

TOTAL MILES	
Township Road System	20.61
State Highway System	15.86
Total	36.47

POPULATION 1,179  
(2020 Census)

LEGEND

- LIMITED ACCESS HIGHWAY
- STATE ROUTE AND NUMBER
- STATE MAINTAINED BRIDGE ON TOWNSHIP ROAD
- TOWNSHIP ROAD, NUMBER AND SEGMENT LENGTH IN MILES
- IMPASSABLE TOWNSHIP ROAD
- TURNBACK TOWNSHIP ROAD
- OTHER ROAD
- RAILROAD (IN SERVICE)
- RAILROAD ABANDONED (TRACK RETAINED)
- STATE BOUNDARY
- COUNTY BOUNDARY
- TOWNSHIP BOUNDARY
- CITY OR BOROUGH BOUNDARY
- MUNICIPAL BUILDING
- SPLIT MILEAGE BETWEEN MUNICIPALITIES

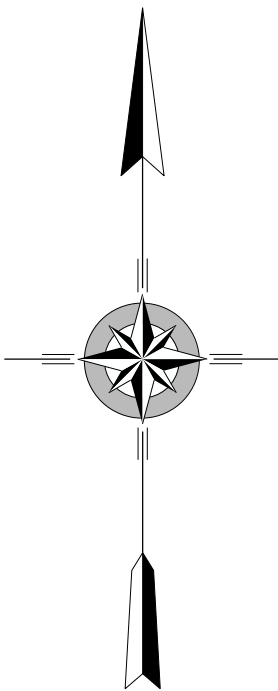
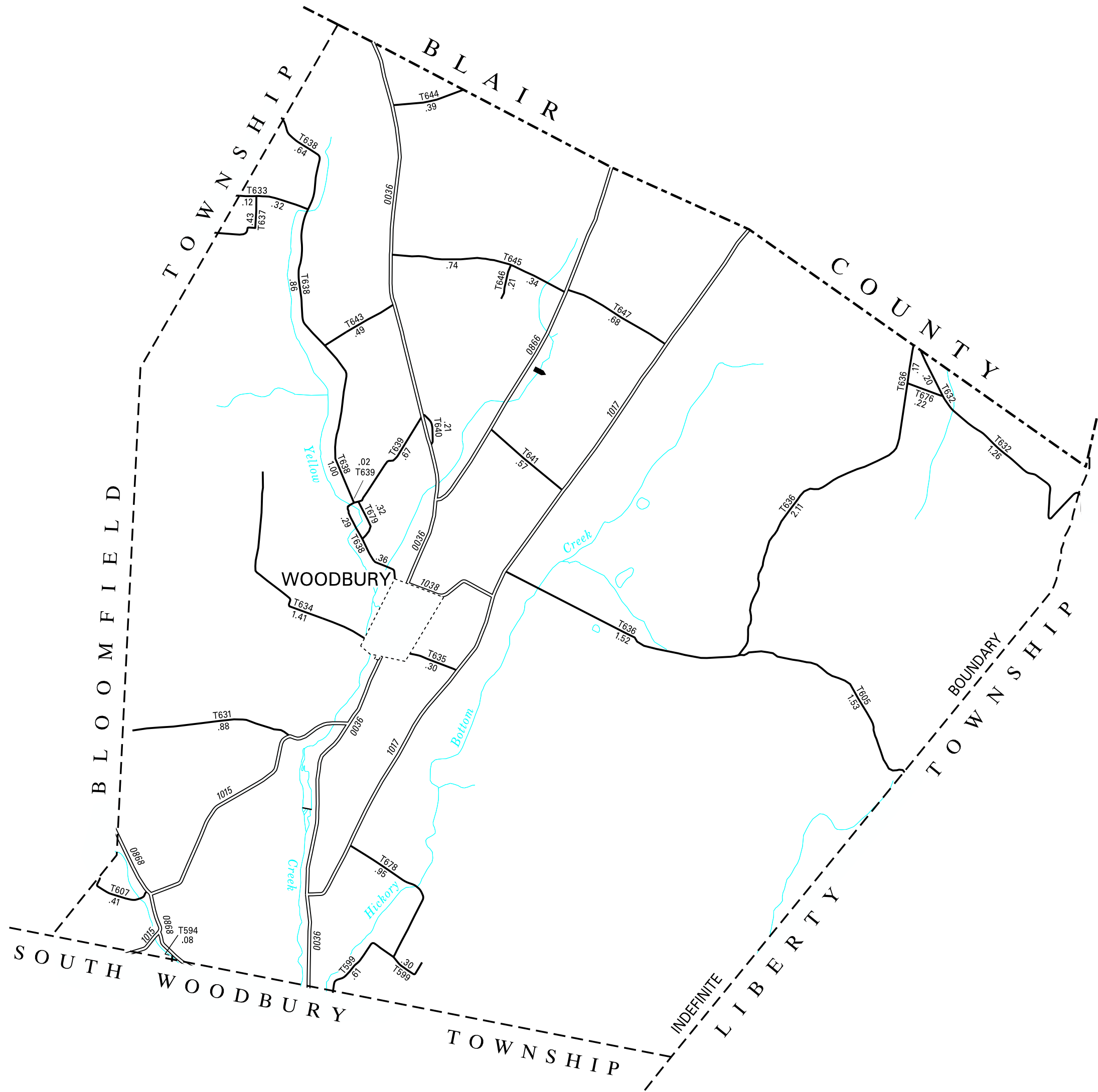

WOODBURY  
SECOND CLASS TOWNSHIP MAP  
BEDFORD COUNTY

PREPARED BY THE  
PENNSYLVANIA DEPARTMENT OF TRANSPORTATION  
BUREAU OF PLANNING AND RESEARCH  
GEOGRAPHIC INFORMATION DIVISION  
IN COOPERATION WITH THE  
U.S. DEPARTMENT OF TRANSPORTATION  
FEDERAL HIGHWAY ADMINISTRATION  
MUNICIPAL CODE 05 228  
THIS MAP IS PUBLISHED AS A SUPPLEMENTAL  
DOCUMENTATION OF LIQUID FUELS TAX FUND MILEAGES  
REVISED PER FORM 990 DATED 9-7-04

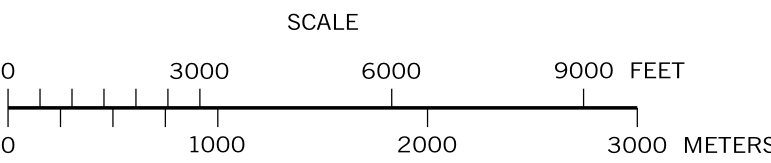

TYPE 5 MAP    WOODBURY TOWNSHIP    BEDFORD COUNTY PENNSYLVANIA

- 594 NORTH RD
- 599 HIPPLES CAVE RD
- 605 MAPLE RUN RD
- 607 MILLBROOK RD
- 631 KELLY RD
- 632 HENRIETTA MT RD
- 633 OAK LEAF LA
- 634 CLUBHOUSE RD
- 635 MILL ST
- 636 PULPIT RD
- 637 DEER RUN DR
- 638 FROSTY HOLLOW RD
- 639 CEMETERY RD
- 640 OLD PIKE RD
- 641 HERSHBERGER RD
- 643 ERB RD
- 644 DRAKE RD
- 645 OVER RD
- 646 FREDERICK RD
- 647 REPLIOLE RD
- 676 WOODLING RD
- 678 SMITH RD
- 679 SPRINGS RIDGE RD

CREATED BY RPL 10-29-98 (REVISED 7-27-23)

COPIES OF THIS MAP ARE AVAILABLE AT NOMINAL COST  
CONTACT:  
PENNSYLVANIA DEPARTMENT OF TRANSPORTATION  
SALES STORE  
P.O. BOX 3451  
HARRISBURG, PENNSYLVANIA 17105-3451  
TELEPHONE: (717)787-6746